

June 18, 2019

Version 2

Warranty Extension: 2016-18 Civic 1.5L: DTC P0300, P0301, P0302, P0303, P0304, or P0172; Whirling Noise from EngineSupersedes 19-038, dated April 5, 2019, to revise the information highlighted in **yellow**.**AFFECTED VEHICLES**

| Year | Model | Trim | VIN Range |
|---------|-------|----------------------|------------------------------------------|
| 2016-18 | Civic | ALL with 1.5L Engine | Check the iN VIN status for eligibility. |

REVISION SUMMARY

- Under **BACKGROUND**, information was updated.
- Under **CORRECTIVE ACTION**, information was updated.
- Under **WARRANTY CLAIM INFORMATION**, information was added.

BACKGROUND

Under certain circumstances, the vehicle may experience driveability issues, which may result in DTCs P0300 (random misfire detected), P0301 (No. 1 cylinder misfire detected), P0302 (No. 2 cylinder misfire detected), P0303 (No. 3 cylinder misfire detected), P0304 (No. 4 cylinder misfire detected), or P0172 (fuel system too rich) or a whirling noise coming from the engine compartment.

NOTE

Check the VIN of the vehicle to see if S/B 18-137 applies. If it applies and the repair has not been completed, complete the appropriate repair under S/B 18-137 before continuing.

To ensure customer confidence in our product, Honda is extending the powertrain warranty from the original 5 years/60,000 miles to 6 years with unlimited mileage from the original sale date. This warranty extension applies to any engine components, such as camshafts, rocker arm assemblies, and spark plugs, requiring repair due to damage resulting from those concerns identified in the first paragraph. Vehicles registered and operated in certain states, spark plugs may be covered beyond 6 years under the vehicle's emissions warranty. Check page 2 for details.

This warranty extension will not apply to any vehicle that has ever been declared a total loss or sold for salvage by a financial institution or insurer, or has a branded or similar title under any state's law. This does not affect emission warranties.

POSSIBLE CAUSE

Based on certain driving patterns and environmental factors, the DTC's stated above may be set or a whirling noise may occur.

CUSTOMER INFORMATION: The information in this bulletin is intended for use only by skilled technicians who have the proper tools, equipment, and training to correctly and safely maintain your vehicle. These procedures should not be attempted by "do-it-yourselfers," and you should not assume this bulletin applies to your vehicle, or that your vehicle has the condition described. To determine whether this information applies, contact an authorized Honda automobile dealer.

CORRECTIVE ACTION

If S/B 18-137 applies to this vehicle, complete the repairs under that bulletin first. **If, after completing S/B 18-137, misfire (P0300, P0301, P0302, P0303, P0304) or fuel system too rich (P0172) DTCs are set, do REPAIR PROCEDURE A.** If there is a whirling noise coming from the engine compartment, do REPAIR PROCEDURE B.

WARRANTY CLAIM INFORMATION

NOTE

- DTC is required with claim submission.

NOTES

- Check emission table on iN to verify the applicable emissions coverage for each vehicle.

Powertrain and Emissions Warranty Coverage Inquiry

| | | | |
|----------------------------|------------------------------|----------------|------------------|
| Identification VAT0017 | | | |
| Inquiry Information | | | |
| VIN | Customer State NY - New York | | |
| Description CIVIC HATCH EX | Year 2018 | Model FK7H5JJW | Emission Type KL |

| Item | Part Number | Description | Powertrain Warranty (Months/Miles) | Emission Warranty (Months/Miles) |
|------|---------------|---------------------|------------------------------------|----------------------------------|
| 1 | 12290-5PA-A01 | S/PLG (ILZKAR8J8SY) | NOT A POWERTRAIN PART | 180/ 150,000 |

- Use the appropriate operation number for the applicable warranty coverage (emissions warranty or extended powertrain warranty)

Use the information below if the warranty information is covered by the emission warranty of 15 years or 150,000 miles.

| Operation Number | Description | Flat Rate Time | Defect Code | Symptom Code | Template ID | Failed Part Number |
|------------------|---------------------------------------------------------------------|----------------|-------------|--------------|-------------|--------------------|
| 1175A4 | Spark plugs (All except Si). (Inspect and replace) (Admin Included) | 0.3 hr | 03214 | 03217 | A19038K | 12290-5PA-A01 |

NOTE

Use the following template if the **spark plugs** were replaced.

| Operation Number | Description | Flat Rate Time | Defect Code | Symptom Code | Template ID | Failed Part Number |
|------------------|----------------------------------------------------------------------------------|----------------|-------------|--------------|-------------|--------------------|
| 1175A3 | Spark plugs (All except Si). (Inspection only) (Admin Included) | 0.3 hr | 6D800 | E4C00 | A19038A | 12290-5PA-A01 |

| Operation Number | Description | Flat Rate Time | Defect Code | Symptom Code | Template ID | Failed Part Number |
|------------------|----------------------------------------------------------------------------|----------------|-------------|--------------|-------------|--------------------|
| 1175A3 | Spark plugs (Si only). (Inspection only) (Admin Included) | 0.3 hr | 6D800 | E4C00 | A19038B | 12290-5PA-A01 |

| Operation Number | Description | Flat Rate Time | Defect Code | Symptom Code | Template ID | Failed Part Number |
|------------------|--------------------------------------------------------------------------------------|----------------|-------------|--------------|-------------|--------------------|
| 1175A3 | Spark plugs (All except Si). (Inspect and replace) (Admin Included) | 0.3 hr | 6D800 | E4C00 | A19038C | 12290-5PA-A01 |

| Operation Number | Description | Flat Rate Time | Defect Code | Symptom Code | Template ID | Failed Part Number |
|------------------|--------------------------------------------------------------------------------|----------------|-------------|--------------|-------------|--------------------|
| 1175A3 | Spark plugs (Si only). (Inspect and replace) (Admin Included) | 0.3 hr | 6D800 | E4C00 | A19038D | 12290-5PA-A01 |

NOTE

Use the following template if the **camshafts** were only inspected.

| Operation Number | Description | Flat Rate Time | Defect Code | Symptom Code | Template ID | Failed Part Number |
|------------------|-------------------------------------------------------------------------------|----------------|-------------|--------------|-------------|--------------------|
| 1105C1 | Remove valve cover and inspect camshafts. (No replacement required.) | 0.7 hr | 6D800 | E4C00 | A19038E | 37805-5PA-A85 |

NOTE

Use the following template if the **camshafts** and **rocker arm assembly** were replaced.

Civic (2-Door, 4-Door) (All Except Si)

| Operation Number | Description | Flat Rate Time | Defect Code | Symptom Code | Template ID | Failed Part Number |
|------------------|------------------------------------------------------------------------------------------------------|----------------|-------------|--------------|-------------|--------------------|
| 1105C1 | Remove valve cover and inspect camshafts. | 0.7 hr | 6D800 | E4C00 | A19038F | 37805-5PA-A85 |
| A | Replace camshafts and rocker arm assembly. (Pre-approval needed, see iN parts catalog for ordering.) | 4.9 hr | | | | |

Civic Si (2-Door, 4-Door)

| Operation Number | Description | Flat Rate Time | Defect Code | Symptom Code | Template ID | Failed Part Number |
|------------------|------------------------------------------------------------------------------------------------------|----------------|-------------|--------------|-------------|--------------------|
| 1105C1 | Remove valve cover and inspect camshafts. | 0.7 hr | 6D800 | E4C00 | A19038H | 37805-5PA-A85 |
| A | Replace camshafts and rocker arm assembly. (Pre-approval needed, see iN parts catalog for ordering.) | 4.9 hr | | | | |

Civic Hatchback (5-Door)

| Operation Number | Description | Flat Rate Time | Defect Code | Symptom Code | Template ID | Failed Part Number |
|------------------|------------------------------------------------------------------------------------------------------|----------------|-------------|--------------|-------------|--------------------|
| 1105C1 | Remove valve cover and inspect camshafts. | 0.7 hr | 6D800 | E4C00 | A19038J | 37805-5PA-A85 |
| A | Replace camshafts and rocker arm assembly. (Pre-approval needed, see iN parts catalog for ordering.) | 4.9 hr | | | | |

Skill Level: Repair Technician

PARTS INFORMATION

| Part Name | Part Number | Quantity |
|----------------------------|---------------|----------|
| Spark Plug (All except Si) | 12290-59B-003 | 4 |
| Spark Plug (Si only) | 12290-5PA-A01 | 4 |

REPAIR PROCEDURE A

1. In some cases, the misfire DTCs may return. If this happens, inspect the spark plugs.



- If the spark plugs are OK, the procedure is complete. Continue with normal troubleshooting.
 - If the spark plugs are fouled, go to step 2.
2. Replace the spark plugs per service information and check for stored DTCs.

NOTE

Make sure to write down the stored DTCs on the R.O.

- If the applicable DTCs do not return, the procedure is complete.
- If the applicable DTCs return, this bulletin does not apply. Continue with normal troubleshooting.

REPAIR PROCEDURE B

If there is a whirling noise coming from the engine, follow the procedure below.

1. Warm up the engine by increasing the engine speed to **3,000 rpm** for two fan cycles.
2. After the warm-up procedure is completed, let the car return to idle for **10 seconds**.
3. After **10 seconds**, slowly increase the engine speed up to **3500 rpm** (this should take at least **20 seconds**).
4. Once the engine speed reaches **3500 rpm**, release the accelerator pedal and let the engine speed return to idle.
5. With the hood closed and inside the cabin, compare the audio file [here](#) to the noise heard.
 - If the noise is similar, continue to step 6.
 - If the noise is not similar, this bulletin does not apply. Continue with normal system troubleshooting.
6. Remove the cylinder head cover. See service information for additional instructions.
7. Compare the appearance of the camshaft lobes to the photo below.

 GOOD



 NO GOOD

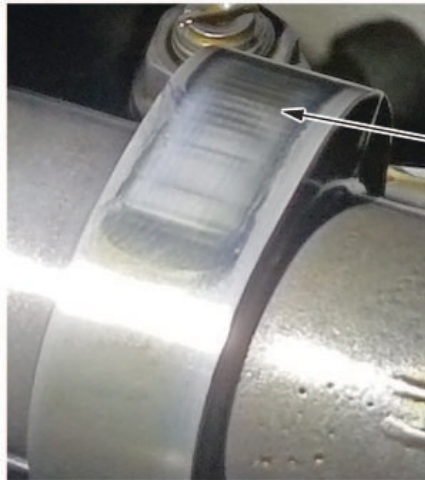

The cam surface has ridges and a "cloudy" appearance.

- If the camshafts appear similar to the no good photo, go to step 8.
 - If the camshafts appear similar to the good photo, this bulletin does not apply. Continue with normal system troubleshooting.
8. Take a photo of the cam lobe, then follow the directions in the parts catalog when ordering the necessary parts.

NOTE

Please send photos of failed camshafts to PART_RELEASE@AHM.HONDA.COM to receive approval and release parts.

The following instructions are for replacement of the intake and exhaust camshafts and all rocker arm assemblies. This is only if you have been approved by following the instructions in the parts catalog.

1. Relieve the fuel pressure and remove the high pressure fuel pump. Refer to the service information for additional instructions.
2. Set the crankshaft to top dead center (TDC) for No. 1 cylinder. Refer to step 4 of the Camshaft Timing Inspection in the service information.
3. Mark the timing chain at the punch marks on the exhaust and intake camshaft sprocket and VTC actuator as seen below.

Mark the cam chain at the punch marks on the sprocket.

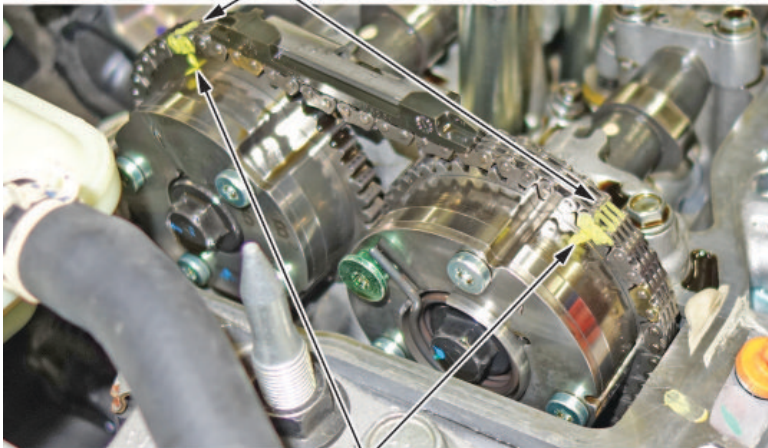

PUNCH MARKS

4. Raise the vehicle on a lift.
5. Remove the right front wheel and the engine undercover.
6. Remove the cam chain auto-tensioner (chain case) cover.
7. Slightly rotate the crankshaft counterclockwise to compress the auto-tensioner. Line up the hole in the lock and auto-tensioner, then insert a 1.2 mm diameter lock pin.

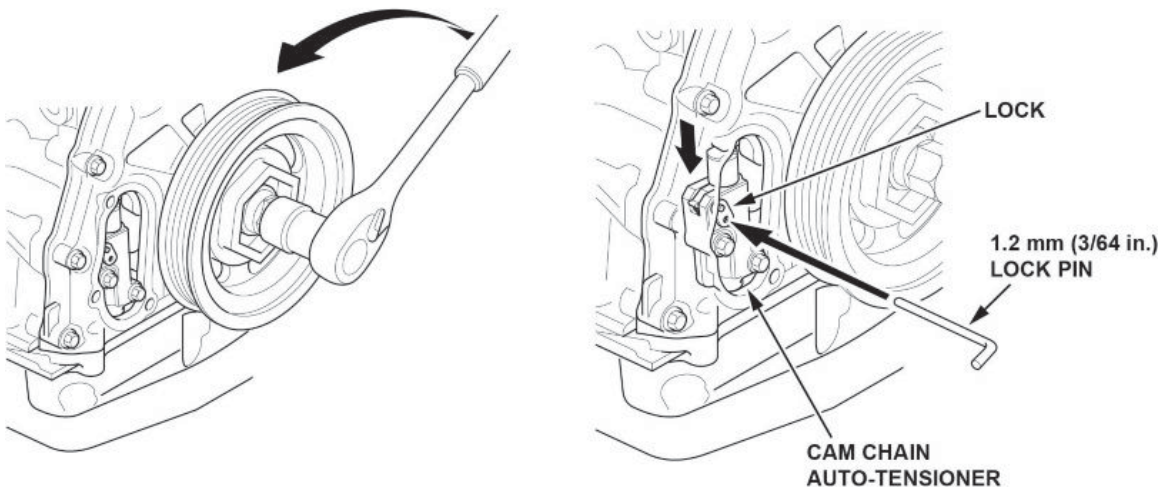

8. Rotate the crankshaft clockwise back to TDC on the No. 1 cylinder to secure the lock pin in place.

9. Remove the camshaft chain auto-tensioner with the lock pin inserted.

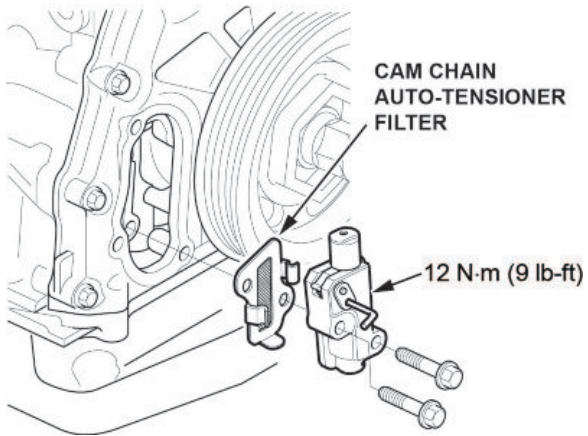

10. Lower the vehicle.

11. Loosen the locknuts and adjusting screws.

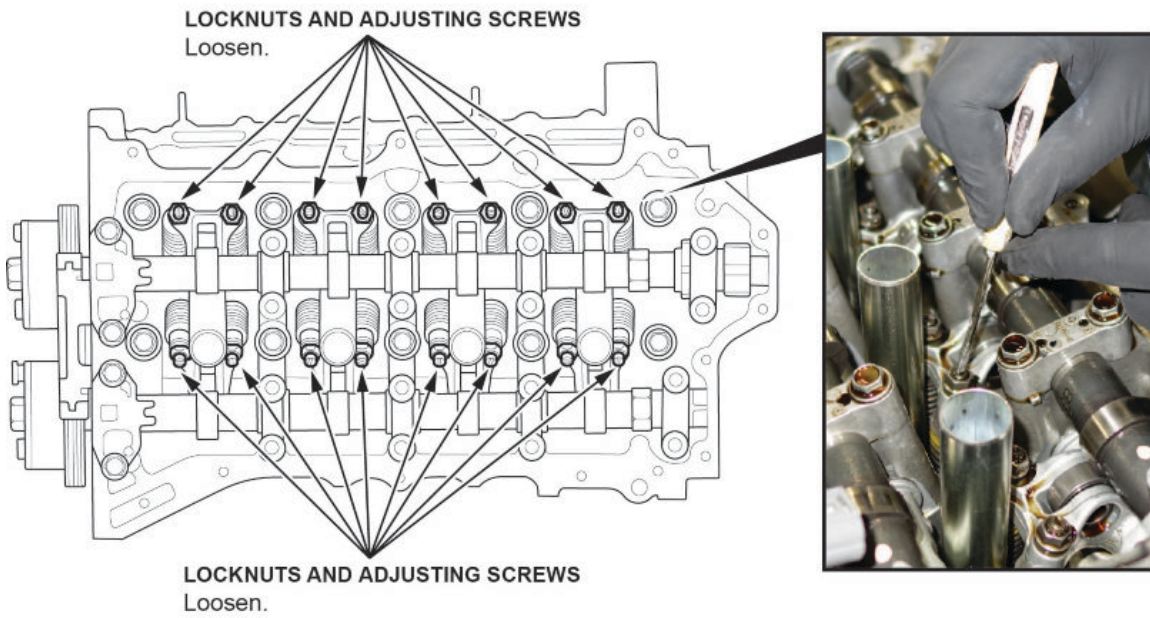

12. Remove the high pressure fuel pump base.

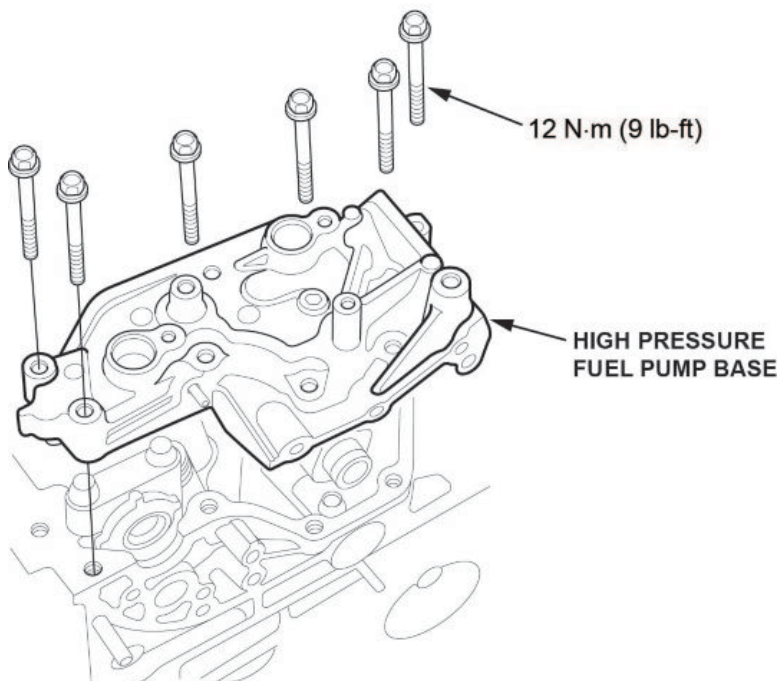

13. Remove the camshaft holder bolts, then remove the camshaft holders. To prevent damaging the camshafts, loosen the bolts in sequence, two turns at a time.

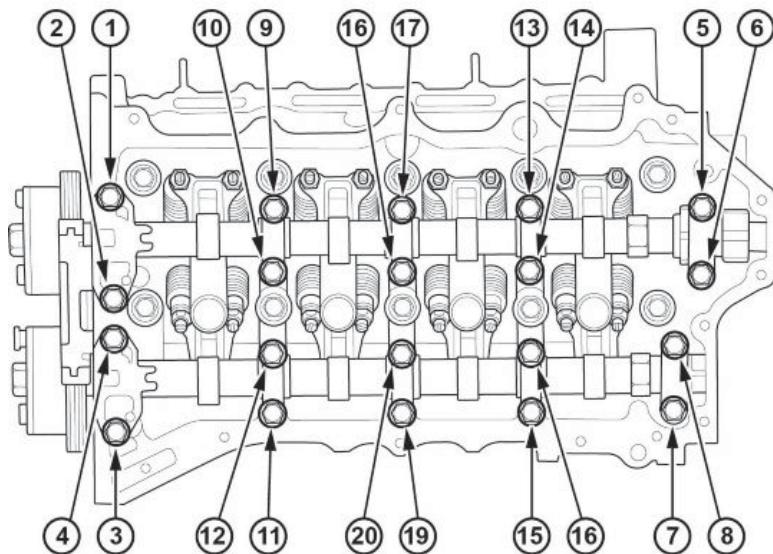

14. Lift up the cam chain, then carefully remove the intake camshaft followed by the exhaust camshaft. You must maintain tension on the cam chain while you do this.

Lift up the cam chain and carefully slip the camshaft out.

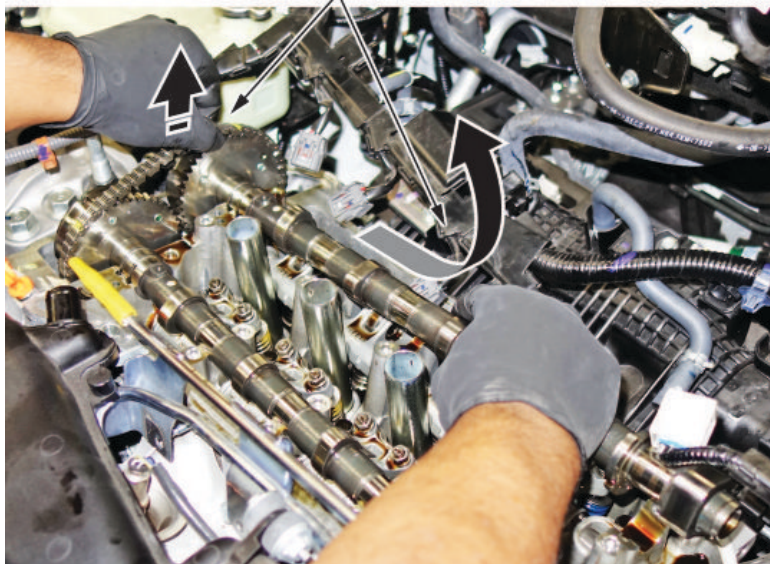

15. Use a bungee cord to hold tension on the cam chain while you are replacing the camshafts.

BUNGEE CORD



BUNGEE HOOK

CAM CHAIN

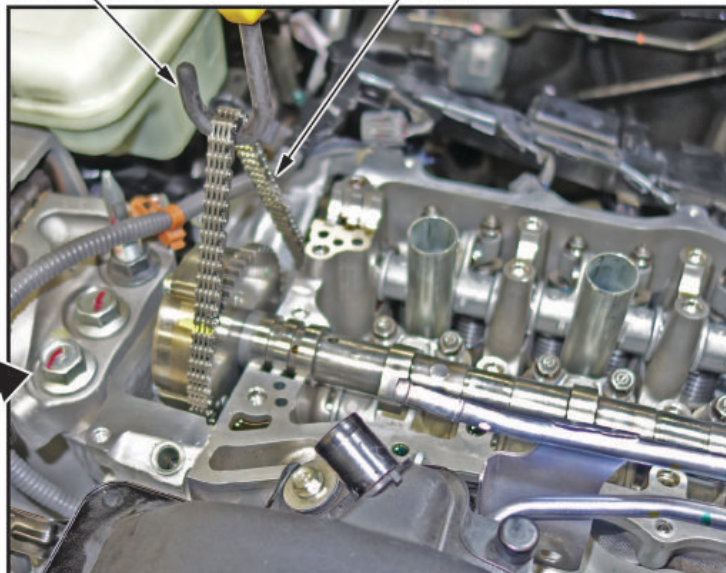

16. When removing the camshaft holders, cam chain guide, and intake and exhaust camshaft, make sure to place them in order of installation on a clean, padded workbench.

17. Remove the rocker arm assembly, and install the new set. Refer to the service information for additional instructions.

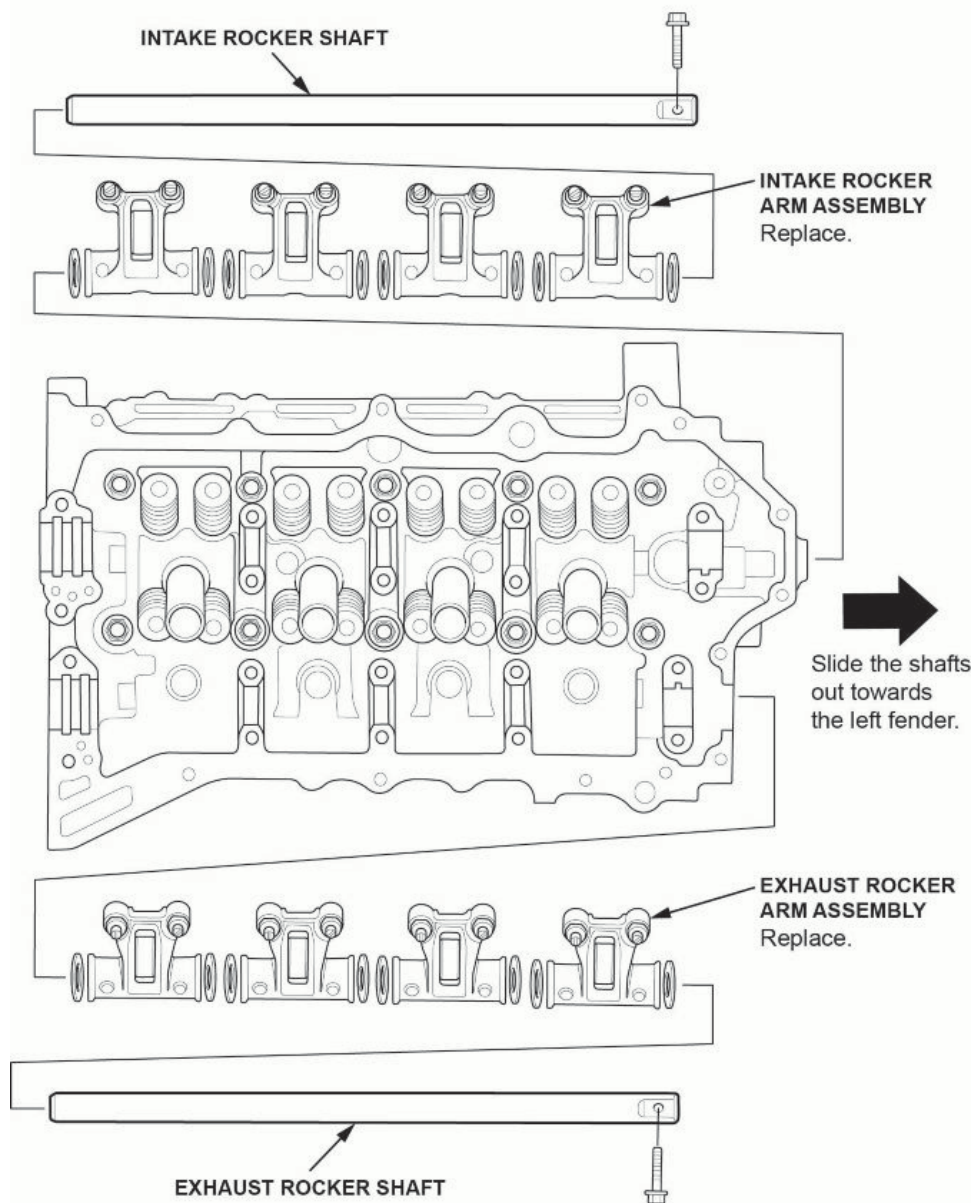

18. With the camshafts out of the engine, hold them with an open-end wrench and loosen the VTC actuator mounting bolts on both camshafts.
19. Install the VTC actuators on the new camshafts.

NOTE

You may need an assistant to help you with this procedure.

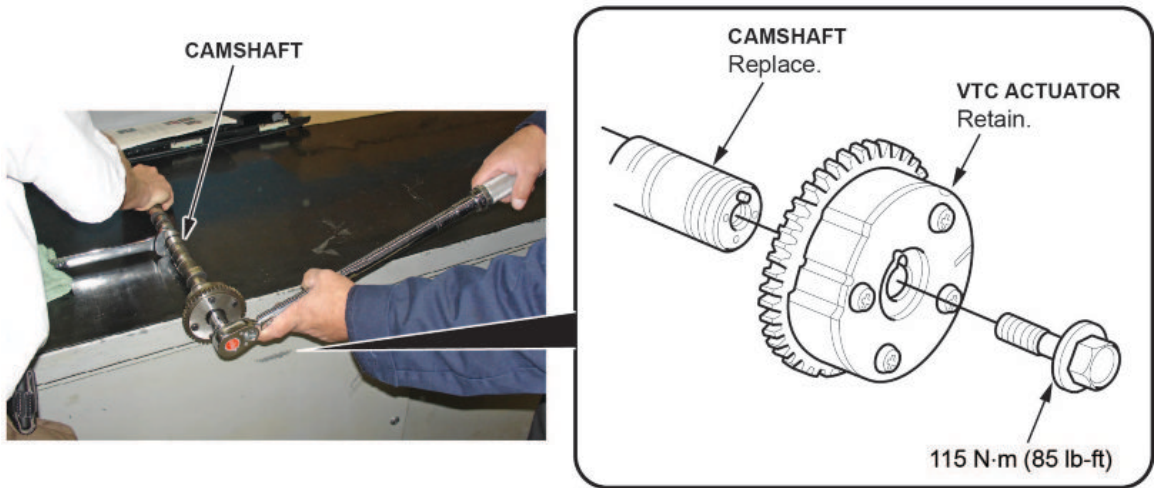

20. Apply fresh engine oil to the new camshafts, and install.



21. When installing the new camshafts, ensure the previously made marks on the VTC actuator and cam chain line up.



As the camshaft is installed, line up the marks made in step 3.

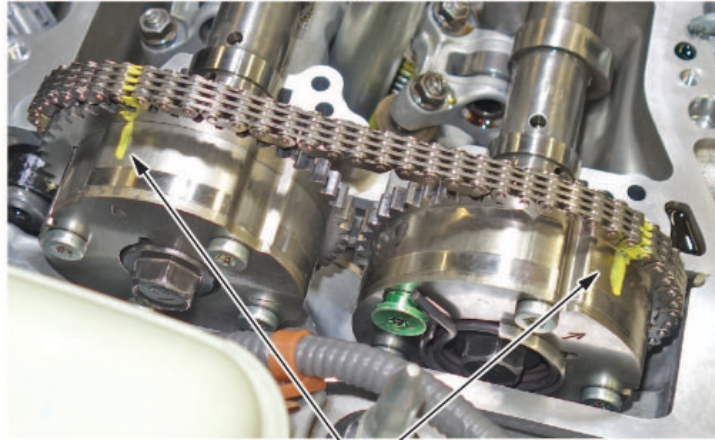

MARKS

- 22. Install the camshaft holders and the cam chain guide, then torque them to specification.
- 23. Install the camshaft chain tensioner and release the lock pin.
- 24. Install the new cam chain auto-tensioner (chain case) cover.

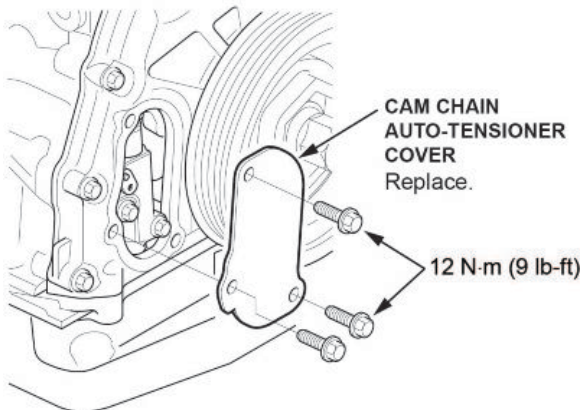

- 25. To check the camshaft timing, rotate the crankshaft in the direction of engine rotation (clockwise) two full turns, then stop at the TDC mark. Refer to step 4 of the Camshaft Timing Inspection in the service information.
- 26. Do a valve adjustment.

27. Install the high pressure fuel pump base and new camshaft holder cover. Refer to step 6 of the installation section of the Camshaft and VTC Actuator Removal, Installation, and Inspection (1.5L Engine) in the service information.

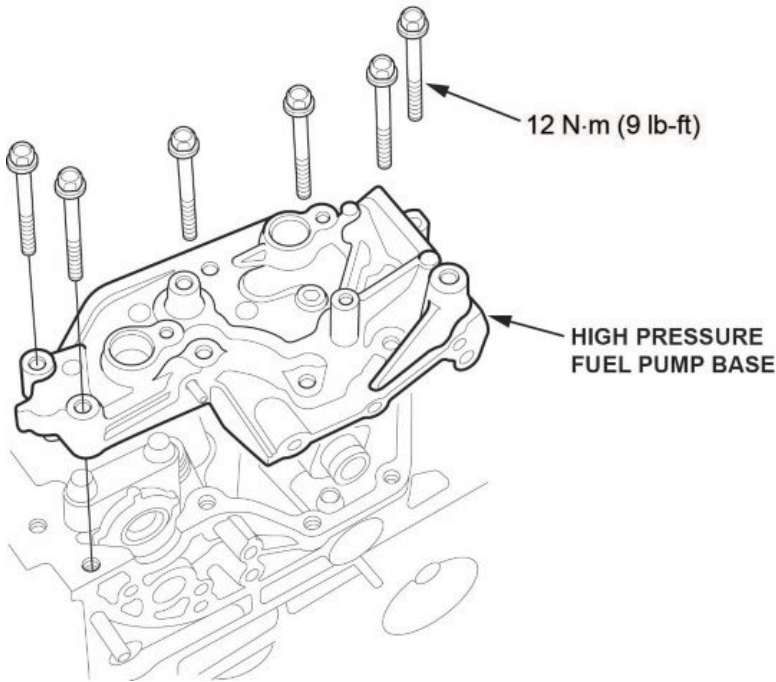

28. Install the cylinder head cover. Refer to the service information for additional instructions.
29. Install the high pressure fuel pump with the new o-ring and fuel joint pipe. Refer to the service information for additional information.
30. Install the engine undercover and any other remaining parts.
31. During the first start up, check for DTCs set or abnormal noises. Refer to service information for additional instructions.
32. Reset the throttle position learned values by referencing the throttle body removal and installation in the service information, then do the PCM idle learn procedure. Refer to service information for additional instructions.

NOTE

For more information on the PCM idle learn procedure, see the *Tech2Tech*[®] video, "A Look at PCM Idle Learn".

END