

**June 18, 2019**

Version 2

## **Warranty Extension: 2016-18 Civic 1.5L: Software Update with A/C Control Unit Replacement; DTC P0300, P0301, P0302, P0303, P0304, or P0172; Whirling Noise from Engine**

Supersedes 19-033, dated April 5, 2019, to revise the information highlighted in **yellow**.

### **AFFECTED VEHICLES**

Year	Model	Trim	VIN Range
2016-18	Civic	ALL with 1.5L Engine	Check the iN VIN status for eligibility.

### **REVISION SUMMARY**

- Under **BACKGROUND**, information was updated.
- Under **WARRANTY CLAIM INFORMATION**, information was deleted.

### **BACKGROUND**

Under certain circumstances, the vehicle may experience driveability issues, which may result in DTCs P0300 (random misfire detected), P0301 (No. 1 cylinder misfire detected), P0302 (No. 2 cylinder misfire detected), P0303 (No. 3 cylinder misfire detected), P0304 (No. 4 cylinder misfire detected), or P0172 (fuel system too rich) or a whirling noise coming from the engine compartment.

#### **NOTE**

Check to see if the vehicle was repaired as stated in S/B 19-012. If a repair was completed as stated in S/B 19-012, see **CORRECTIVE ACTION** to determine if further action is necessary.

To ensure customer confidence in our product, Honda is extending the powertrain warranty from the original 5 years/60,000 miles to 6 years with unlimited mileage from the original sale date. This warranty extension applies to any engine components, such as camshafts, rocker arm assemblies, or spark plugs, requiring repair due to damage resulting from those concerns identified in the first paragraph. The ECU and TCM software is covered under the vehicle's emissions warranty beyond 6 years. Check page 5 for further details.

This warranty extension will not apply to any vehicle that has ever been declared a total loss or sold for salvage by a financial institution or insurer, or has a branded or similar title under any state's law. This does not affect emission warranties.

### **POSSIBLE CAUSE**

Based on certain driving patterns and environmental factors, the DTC's stated above may be set or a whirling noise may occur.

**CUSTOMER INFORMATION:** The information in this bulletin is intended for use only by skilled technicians who have the proper tools, equipment, and training to correctly and safely maintain your vehicle. These procedures should not be attempted by "do-it-yourselfers," and you should not assume this bulletin applies to your vehicle, or that your vehicle has the condition described. To determine whether this information applies, contact an authorized Honda automobile dealer.

## CORRECTIVE ACTION

If misfire (P0300, P0301, P0302, P0303, P0304) or fuel system too rich (P0172) DTCs are set, do REPAIR PROCEDURE A. If there is a whirling noise coming from the engine compartment, do REPAIR PROCEDURE B.

In some cases, misfire DTCs may return. If that happens, go to SPARK PLUG INSPECTION PROCEDURE.

## WARRANTY CLAIM INFORMATION

### NOTES

- DTC is required with claim submission.
- Since the templates below do not include oil, Non-Bulk oil and Bulk oil dealers must add the correct information into the Required Material section of your claim.

Operation Number	Description	Flat Rate Time	Defect Code	Symptom Code	Template ID	Failed Part Number
1245B5	Reset the maintenance minder. Update the PGM-FI and TCM software. Replace the oil and do a throttle position reset and PCM idle learn procedure <b>(A/C control unit replacement not necessary)</b> .	0.6 hr	03214	03217	A19033A	37805-5PA-A85

Operation Number	Description	Flat Rate Time	Defect Code	Symptom Code	Template ID	Failed Part Number
1245B6	Reset the maintenance minder. Update the PGM-FI and TCM software. Replace the oil and do a throttle position reset and PCM idle learn procedure. Replace the A/C control unit <b>(Dual Zone)</b> .	0.8 hr	03214	03217	A19033B	37805-5PA-A85

Operation Number	Description	Flat Rate Time	Defect Code	Symptom Code	Template ID	Failed Part Number
1245B6	Reset the maintenance minder. Update the PGM-FI and TCM software. Replace the oil and do a throttle position reset and PCM idle learn procedure. Replace the A/C control unit <b>(Non Dual Zone)</b> .	0.8 hr	03214	03217	A19033C	37805-5PA-A85

**NOTE**

Use the following template if the **spark plugs** were replaced.

Since the templates below do not include oil, Non-Bulk oil and Bulk oil dealers must add the correct information into the Required Material section of your claim.

Operation Number	Description	Flat Rate Time	Defect Code	Symptom Code	Template ID	Failed Part Number
1245B6	Reset the maintenance minder. Update the PGM-FI and TCM software. Replace the oil and do a throttle position reset and the PCM idle learn procedure. Replace the A/C control unit ( <b>Dual Zone</b> ).	0.8 hr	03214	03217	A19033D	37805-5PA-A85
A	Spark plugs ( <b>All except Si</b> )(inspection or replacement).	0.2 hr				

Operation Number	Description	Flat Rate Time	Defect Code	Symptom Code	Template ID	Failed Part Number
1245B6	Reset the maintenance minder. Update the PGM-FI and TCM software. Replace the oil and do a throttle position reset and the PCM idle learn procedure. Replace the A/C control unit ( <b>Dual Zone</b> ).	0.8 hr	03214	03217	A19033E	37805-5PA-A85
A	Spark plugs ( <b>Si only</b> ) (inspection or replacement).	0.2 hr				

Since the templates below do not include oil, Non-Bulk oil and Bulk oil dealers must add the correct information into the Required Material section of your claim.

Operation Number	Description	Flat Rate Time	Defect Code	Symptom Code	Template ID	Failed Part Number
1245B6	Reset the maintenance minder. Update the PGM-FI and TCM software. Replace the oil and do a throttle position reset and PCM idle learn procedure. Replace the A/C control unit ( <b>Non Dual Zone</b> ).	0.8 hr	03214	03217	A19033F	37805-5PA-A85
A	Spark plugs (inspection or replacement).	0.2 hr				

Operation Number	Description	Flat Rate Time	Defect Code	Symptom Code	Template ID	Failed Part Number
1245B5	Reset the maintenance minder. Update the PGM-FI and TCM software. Replace the oil and do a throttle position reset and PCM idle learn procedure. ( <b>A/C control unit replacement not necessary</b> ).	0.6 hr	03214	03217	A19033G	37805-5PA-A85
A	Spark plugs (inspection or replacement).	0.2 hr				

## NOTES

- Check emission table on iN to verify the applicable emissions coverage for each vehicle.

### Powertrain and Emissions Warranty Coverage Inquiry

Identification VAT0004				
Inquiry Information				
VIN	Customer State CA - California			
Description CIVIC 1.5T 4D TOURING	Year 2018	Model FC1F9JKNW	Emission Type KL	
Item	Part Number	Description	Powertrain Warranty (Months/Miles)	Emission Warranty (Months/Miles)
1	12290-5PA-A01	S/PLG (ILZKAR8J8SY)	NOT A POWERTRAIN PART	180/ 150,000

- Use the appropriate operation number for the applicable warranty coverage (emissions warranty or extended powertrain warranty)

Use the information below if the warranty information is covered for 6 years and unlimited mileage under the warranty extension.

Operation Number	Description	Flat Rate Time	Defect Code	Symptom Code	Template ID	Failed Part Number
1175A5	Spark plugs ( <b>All except Si</b> ). (Inspection only) ( <b>Admin</b> Included)	0.3 hr	6D800	D4D00	A19033J	12290-5PA-A01

Operation Number	Description	Flat Rate Time	Defect Code	Symptom Code	Template ID	Failed Part Number
1175A5	Spark plugs ( <b>Si only</b> ). (Inspection only) ( <b>Admin</b> Included)	0.3 hr	6D800	D4D00	A19033K	12290-5PA-A01

Use information below if the warranty information is covered 15 years or 150,000 miles.

Operation Number	Description	Flat Rate Time	Defect Code	Symptom Code	Template ID	Failed Part Number
1175A4	Spark plugs ( <b>All except Si</b> ). (Inspect and replace) ( <b>Admin</b> Included)	0.3 hr	03214	03217	A19033L	12290-5PA-A01

Use information below if the warranty information is covered for 6 years and unlimited mileage under the warranty extension.

Operation Number	Description	Flat Rate Time	Defect Code	Symptom Code	Template ID	Failed Part Number
1175A5	Spark plugs ( <b>All except Si</b> ). (Inspect and replace) ( <b>Admin</b> Included)	0.3 hr	6D800	D4D00	A19033M	12290-5PA-A01

Operation Number	Description	Flat Rate Time	Defect Code	Symptom Code	Template ID	Failed Part Number
1175A5	Spark plugs ( <b>Si only</b> ). (Inspect and replace) ( <b>Admin</b> Included)	0.3 hr	6D800	D4D00	A19033N	12290-5PA-A01

**NOTE**

Use the following template if the **camshafts** were only inspected.

Operation Number	Description	Flat Rate Time	Defect Code	Symptom Code	Template ID	Failed Part Number
1105C2	Remove valve cover and inspect camshafts. ( <b>No replacement required.</b> )	0.7 hr	6D800	D4D00	A19033P	37805-5PA-A85

**NOTE**

Use the following template if the **camshafts** and **rocker arm assembly** were replaced.

Since the templates below do not include oil, Non-Bulk oil and Bulk oil dealers must add the correct information into the Required Material section of your claim.

**Civic (2-Door, 4-Door) (All Except Si)**

Operation Number	Description	Flat Rate Time	Defect Code	Symptom Code	Template ID	Failed Part Number
1105C2	Remove valve cover and inspect camshafts.	0.7 hr	6D800	D4D00	A19033Q	37805-5PA-A85
A	Replace camshafts and rocker arm assembly. (Pre-approval needed, see iN parts catalog for ordering.)	4.9 hr				

**Civic Si (2-Door, 4-Door)**

Operation Number	Description	Flat Rate Time	Defect Code	Symptom Code	Template ID	Failed Part Number
1105C2	Remove valve cover and inspect camshafts.	0.7 hr	6D800	D4D00	A19033R	37805-5PA-A85
A	Replace camshafts and rocker arm assembly. (Pre-approval needed, see iN parts catalog for ordering.)	4.9 hr				

**Civic Hatchback (5-Door)**

Operation Number	Description	Flat Rate Time	Defect Code	Symptom Code	Template ID	Failed Part Number
1105C2	Remove valve cover and inspect camshafts.	0.7 hr	6D800	D4D00	A19033S	37805-5PA-A85
A	Replace camshafts and rocker arm assembly. (Pre-approval needed, see iN parts catalog for ordering.)	4.9 hr				

Skill Level: Repair Technician

**PARTS INFORMATION**

Part Name	Part Number	Quantity
Auto Air Conditioner CPU Assembly (A/C control unit) ( <b>Non-Dual Zone</b> Automatic Climate Control)	79610-TBA-A51	1
Auto Air Conditioner CPU Assembly (A/C control unit) ( <b>Dual-Zone</b> Automatic Climate Control)	79610-TBC-A51	1
Drain Plug Washer (14 mm)	94109-14000	1

**NOTE**These parts are needed if replacing the **spark plugs**.

Part Name	Part Number	Quantity
Spark Plug (All except Si)	12290-59B-003	4
Spark Plug (Si only)	12290-5PA-A01	4

## REQUIRED MATERIAL

### NOTE

For Non-Bulk oil and Bulk oil dealers, add the correct information into the Required Material section of your claim.

Part Name	Part Number	Quantity
0W-20 (Non-Bulk Oil Participants) (quarts)	08798-9063	4
0W-20 (Bulk Oil Participants) (gallons)	FS020-BAS-N0L	1

## SOFTWARE INFORMATION

### NOTE

Unnecessary or incorrect repairs resulting from a failure to update the i-HDS are not covered under warranty.

i-HDS Software Version: **1.004.064 or later**

J2534 Software Information:

- PC Application Version **1.1.0.6 or later**
- Database update **12-MAR-2019 or later**

**Before beginning the repair, make sure that both the i-HDS and J2534 software are updated as listed above.**

**Do only the update listed in this service bulletin.**

To update the software, you must use the MVCI or the DST-i interface in conjunction with the J2534 Rewrite PC application on the i-HDS.

For more information about updating the i-HDS, the MVCI, and vehicle systems, refer to service bulletin 01-023, *Updating Control Units/Modules*.

Year/Model	Emission Code	Software System	Program ID (or later)	Program P/N (or later)
2016 Civic (EX with CVT 2-Door, 4-Door)	KA	PGM-FI	AAA580	37805-5AA-A58
		TCM	CGA080	28101-5CG-A08
2016 Civic (Touring with CVT 2-Door, 4-Door)	KA	PGM-FI	AAA680	37805-5AA-A68
		TCM	CGA080	28101-5CG-A08
2016 Civic (EX with CVT 2-Door, 4-Door)	KL	PGM-FI	AAL590	37805-5AA-L59
		TCM	CGA080	28101-5CG-A08
2016 Civic (Touring with CVT 2-Door, 4-Door)	KL	PGM-FI	AAL690	37805-5AA-L69
		TCM	CGA080	28101-5CG-A08
2017 Civic (EX with M/T 2-Door, 4-Door)	KA	PGM-FI	AAA070	37805-5AA-A07
2017 Civic (EX with CVT 2-Door, 4-Door)	KA	PGM-FI	AAA580	37805-5AA-A58
		TCM	CGA080	28101-5CG-A08
2017 Civic (EX with CVT 2-Door, 4-Door)	KL	PGM-FI	AAL590	37805-5AA-L59
		TCM	CGA080	28101-5CG-A08



Year/Model	Emission Code	Software System	Program ID (or later)	Program P/N (or later)
2017 Civic (Touring with CVT 2-Door, 4-Door)	KA	PGM-FI	AAA680	37805-5AA-A68
		TCM	CGA080	28101-5CG-A08
2017 Civic (Touring with CVT 2-Door, 4-Door)	KL	PGM-FI	AAL690	37805-5AA-L69
		TCM	CGA080	28101-5CG-A08
2017 Civic (Si 2-Door, 4-Door)	KA	PGM-FI	AMA050	37805-5AM-A05
2017 Civic (LX with M/T 5-Door)	KA	PGM-FI	ANA040	37805-5AN-A04
2017 Civic (LX with CVT 5-Door)	KA	PGM-FI	ANA540	37805-5AN-A54
		TCM	CKA040	28101-5CK-A04
2017 Civic (LX w/Honda Sensing 5-Door)	KA	PGM-FI	ANA750	37805-5AN-A75
		TCM	CKA150	28101-5CK-A15
2017 Civic (LX with CVT 5-Door)	KL	PGM-FI	ANL540	37805-5AN-L54
		TCM	CKA040	28101-5CK-A04
2017 Civic (EX, EX-L 5-Door)	KL	PGM-FI	AN9540	37805-5AN-954
		TCM	CKA040	28101-5CK-A04
2017 Civic (EX, EX-L 5-Door)	KA	PGM-FI	ANB540	37805-5AN-B54
		TCM	CKA040	28101-5CK-A04
2017 Civic (Sport with M/T 5-Door)	KA	PGM-FI	ANA150	37805-5AN-A15
2017 Civic (Sport with CVT 5-Door)	KA	PGM-FI	ANA640	37805-5AN-A64
		TCM	CKC040	28101-5CK-C04
2017 Civic (Sport with CVT 5-Door)	KL	PGM-FI	ANL640	37805-5AN-L64
		TCM	CKC040	28101-5CK-C04
2017 Civic (Sport Touring 5-Door)	KA	PGM-FI	ANA850	37805-5AN-A85
		TCM	CKC150	28101-5CK-C15
2018 Civic (Si 2-Door, 4-Door)	KA	PGM-FI	AMA050	37805-5AM-A05
2018 Civic (EX 2-Door) (EX-T 4-Door) (M/T)	KA	PGM-FI	AAA110	37805-5AA-A11
2018 Civic (EX 2-Door) (EX-T 4-Door)	KA	PGM-FI	AAA720	37805-5AA-A72
		TCM	GCA820	28101-5GC-A82
2018 Civic (EX 2-Door) (EX-T 4-Door)	KL	PGM-FI	AAL720	37805-5AA-L72
		TCM	GCA820	28101-5GC-A82

<b>Year/Model</b>	<b>Emission Code</b>	<b>Software System</b>	<b>Program ID (or later)</b>	<b>Program P/N (or later)</b>
2018 Civic (Touring 2-Door) (EX-T w/ Honda Sensing 4-Door)	KA	PGM-FI	AAA820	37805-5AA-A82
		TCM	GCA820	28101-5GC-A82
2018 Civic (Touring 2-Door) (EX-T w/ Honda Sensing 4-Door)	KL	PGM-FI	AAL820	37805-5AA-L82
		TCM	GCA820	28101-5GC-A82
2018 Civic (EX-A with CVT 4-Door)	KA	PGM-FI	BAA510	37805-5BA-A51
		TCM	GCA820	28101-5GC-A82
2018 Civic (EX-A with CVT 4-Door)	KL	PGM-FI	BAL410	37805-5BA-L41
		TCM	GCA820	28101-5GC-A82
2018 Civic (EX w/ Honda Sensing with CVT 4-Door)	KA	PGM-FI	AJA620	37805-5AJ-A62
		TCM	GCA820	28101-5GC-A82
2018 Civic (EX w/ Honda Sensing with CVT 4-Door)	KL	PGM-FI	AJL620	37805-5AJ-L62
		TCM	GCA820	28101-5GC-A82
2018 Civic (EX Navigation with CVT 4-Door)	KA	PGM-FI	AJA520	37805-5AJ-A52
		TCM	GCA820	28101-5GC-A82
2018 Civic (EX Navigation with CVT 4-Door)	KL	PGM-FI	AJL520	37805-5AJ-L52
		TCM	GCA820	28101-5GC-A82
2018 Civic (LX with M/T 5-Door)	KA	PGM-FI	ANA040	37805-5AN-A04
2018 Civic (LX with CVT 5-Door)	KA	PGM-FI	ANA540	37805-5AN-A54
		TCM	CKA040	28101-5CK-A04
2018 Civic (LX with CVT 5-Door)	KL	PGM-FI	ANL540	37805-5AN-L54
		TCM	CKA040	28101-5CK-A04
2018 Civic (LX w/ Honda Sensing 5-Door)	KA	PGM-FI	ANA750	37805-5AN-A75
		TCM	CKA150	28101-5CK-A15
2018 Civic (LX w/ Honda Sensing 5-Door)	KL	PGM-FI	ANL750	37805-5AN-L75
		TCM	CKA150	28101-5CK-A15
2018 Civic (EX, EX-L 5-Door)	KA	PGM-FI	AN9540	37805-5AN-954
		TCM	CKA040	28101-5CK-A04
2018 Civic (EX, EX-L 5-Door)	KL	PGM-FI	ANB540	37805-5AN-B54
		TCM	CKA040	28101-5CK-A04

Year/Model	Emission Code	Software System	Program ID (or later)	Program P/N (or later)
2018 Civic (EX w/ Honda Sensing 5-Door)	KA	PGM-FI	ANA950	37805-5AN-A95
		TCM	CKA150	28101-5CK-A15
2018 Civic (EX w/ Honda Sensing 5-Door)	KL	PGM-FI	ANL950	37805-5AN-L95
		TCM	CKA150	28101-5CK-A15
2018 Civic (Sport with M/T 5-Door)	KA	PGM-FI	ANA150	37805-5AN-A15
2018 Civic (Sport with CVT 5-Door)	KA	PGM-FI	ANA640	37805-5AN-A64
		TCM	CKC040	28101-5CK-C04
2018 Civic (Sport with CVT 5-Door)	KL	PGM-FI	ANL640	37805-5AN-L64
		TCM	CKC040	28101-5CK-C04
2018 Civic (Sport Touring with CVT 5-Door)	KA	PGM-FI	ANA850	37805-5AN-A95
		TCM	CKC150	28101-5CK-C15
2018 Civic (Sport Touring with CVT 5-Door)	KL	PGM-FI	ANL850	37805-5AN-L85
		TCM	CKC150	28101-5CK-C15

## REPAIR PROCEDURE A

- Reset maintenance minder main code A. Refer to the service information.
- Drain and refill the engine oil (3.4 quarts). Do not replace the oil filter.
- Connect the i-HDS and click on the **Body Electrical**. From there, select **HVAC** and open **Data List/Snapshot** to check if the A/C control unit has been replaced. One of three options will appear: **Not Complete**, **Completed**, or **Not Applicable**.
  - If it reads **Completed** or **Not Applicable**, skip to step 5.
  - If it reads **Not Complete**, go to step 4.
- Replace the climate control unit.
  - Remove the climate control unit and replace with the new unit. See service information for additional instructions.
  - Install all parts in reverse order.
  - Run the self-diagnostics procedure with the i-HDS to make sure there are no problems in the system and clear any HVAC system DTCs that might appear.
- With the i-HDS, check to see if the PGM-FI and TCM software has been updated by using the J2534 rewrite application.
  - If they are up to date, the procedure is complete.
  - If not, go to step 6.

6. Update the PGM-FI and TCM software using the i-HDS J2534 rewrite software with the MVCI or DST-i. Refer to Service Bulletin 01-023, *Updating Control Units/Modules*.

#### NOTES

- Connect a fully charged jumper battery and leave it connected during the entire procedure to maintain steady voltage.
  - Never turn the ignition to OFF or ACCESSORY during the update. If there is a problem with the update, leave the ignition turned to ON.
  - To prevent control unit damage, do not operate anything electrical (headlights, audio system, brakes, A/C power windows, door locks, etc.) during the update.
  - Do not use the MongoosePro VCI tool.
7. Reset the throttle position learned values by referencing the throttle body removal and installation in the service information, then do the PCM idle learn procedure. Refer to service information for additional instructions.

#### NOTE

For more information on the PCM idle learn procedure, see the *Tech2Tech®* video, "A Look at PCM Idle Learn".

### SPARK PLUG INSPECTION PROCEDURE

1. In some cases, the DTCs may return. If this happens, inspect the spark plugs.



- If the spark plugs are OK, the procedure is complete. Continue with normal troubleshooting.
  - If the spark plugs are fouled, go to step 2.
2. Replace the spark plugs per service information and check for stored DTCs.

#### NOTE

Make sure to write down the stored DTCs on the R.O.

- If the applicable DTCs do not return, the procedure is complete.
- If the applicable DTCs return, this bulletin does not apply. Continue with normal troubleshooting.

## REPAIR PROCEDURE B

If there is a whirling noise coming from the engine, follow the procedure below.

1. Warm up the engine by increasing the engine speed to **3,000 rpm** for two fan cycles.
2. After the warm-up procedure is completed, let the car return to idle for **10 seconds**.
3. After **10 seconds**, slowly increase the engine speed up to **3500 rpm** (this should take at least **20 seconds**).
4. Once the engine speed reaches **3500 rpm**, release the accelerator pedal and let the engine speed return to idle.
5. With the hood closed and inside the cabin, compare the audio file [here](#) to the noise heard.
  - If the noise is similar, continue to step 6.
  - If the noise is not similar, this bulletin does not apply. Continue with normal system troubleshooting.
6. Remove the cylinder head cover. See service information for additional instructions.
7. Compare the appearance of the camshaft lobes to the photo below.

 **GOOD**



 **NO GOOD**

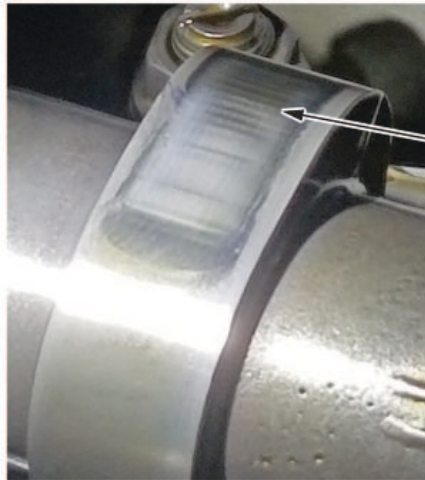

The cam surface has ridges and a "cloudy" appearance.

- If the camshafts appear similar to the no good photo, go to step 8.
  - If the camshafts appear similar to the good photo, this bulletin does not apply. Continue with normal system troubleshooting.
8. Take a photo of the cam lobe, then follow the directions in the parts catalog when ordering the necessary parts.

### NOTE

Please send photos of failed camshafts to [PART\\_RELEASE@AHM.HONDA.COM](mailto:PART_RELEASE@AHM.HONDA.COM) to receive approval and release parts.

The following instructions are for replacement of the intake and exhaust camshafts and all rocker arm assemblies. This is only if you have been approved by following the instructions in the parts catalog.

1. Relieve the fuel pressure and remove the high pressure fuel pump. Refer to the service information for additional instructions.
2. Set the crankshaft to top dead center (TDC) for No. 1 cylinder. Refer to step 4 of the Camshaft Timing Inspection in the service information.
3. Mark the timing chain at the punch marks on the exhaust and intake camshaft sprocket and VTC actuator as seen below.

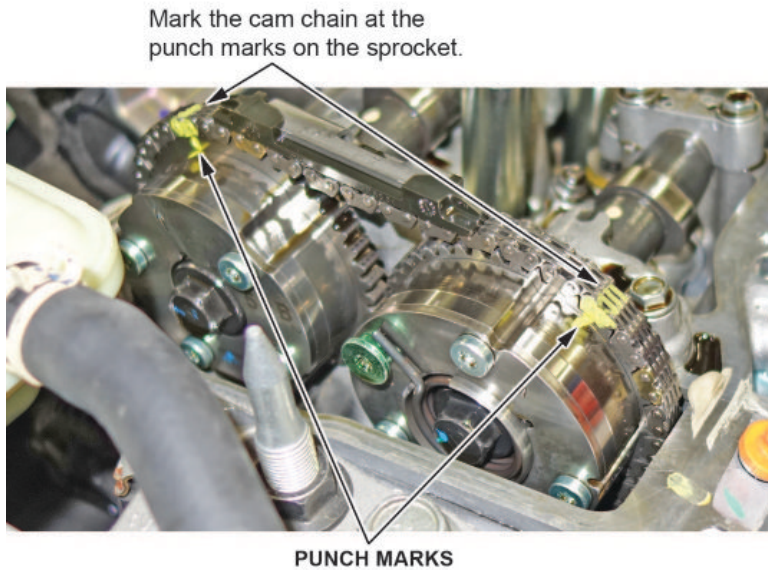

4. Raise the vehicle on a lift.
5. Remove the right front wheel and the engine undercover.
6. Remove the cam chain auto-tensioner (chain case) cover.
7. Slightly rotate the crankshaft counterclockwise to compress the auto-tensioner. Line up the hole in the lock and auto-tensioner, then insert a 1.2 mm diameter lock pin.

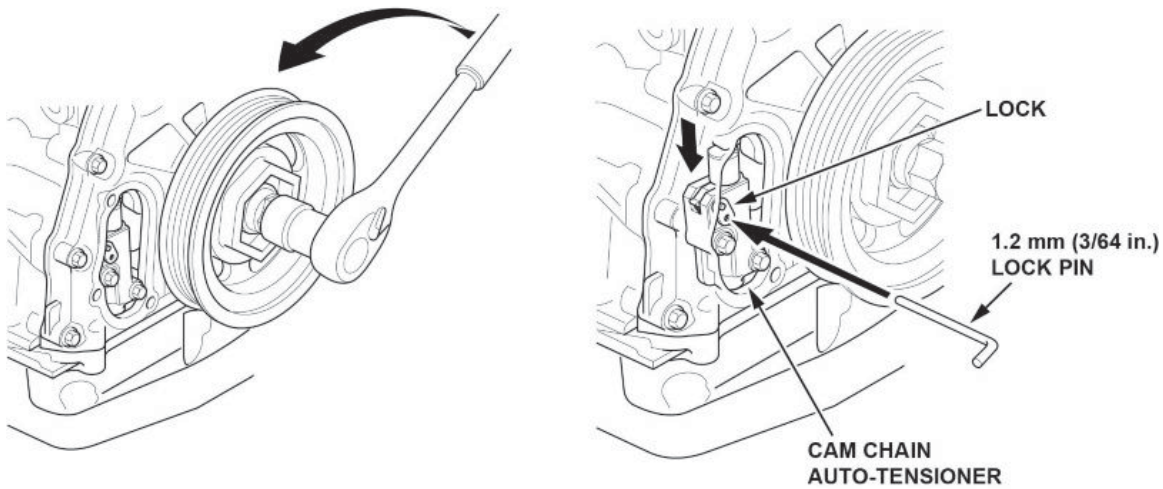

8. Rotate the crankshaft clockwise back to TDC on the No. 1 cylinder to secure the lock pin in place.
9. Remove the camshaft chain auto-tensioner with the lock pin inserted.

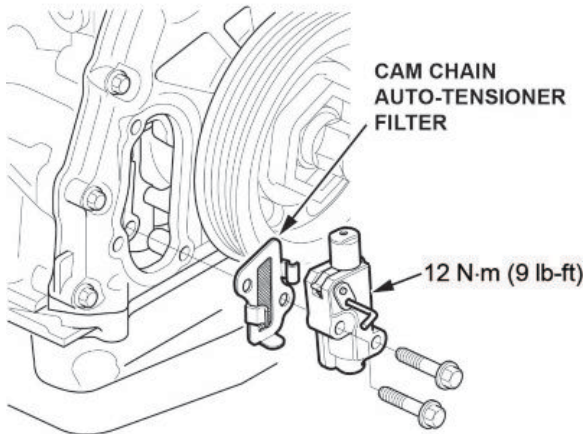



10. Lower the vehicle.
11. Loosen the locknuts and adjusting screws.

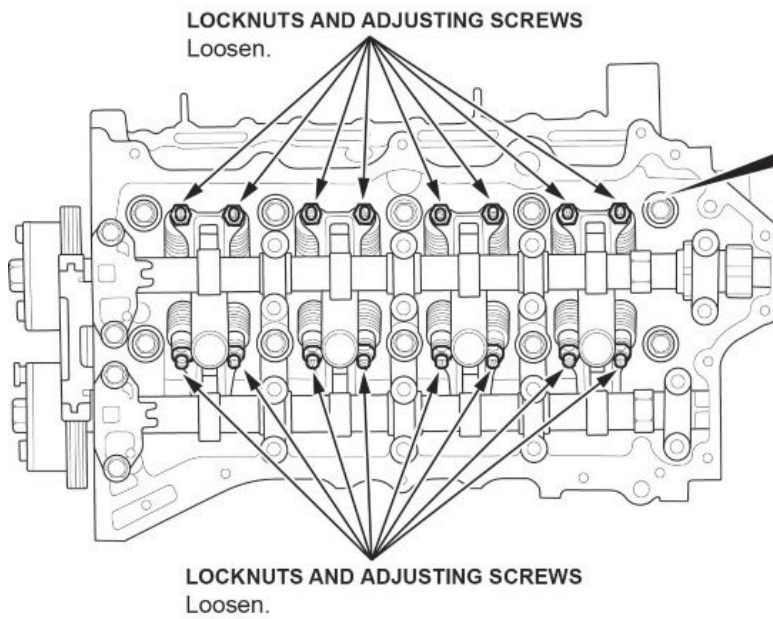



12. Remove the high pressure fuel pump base.

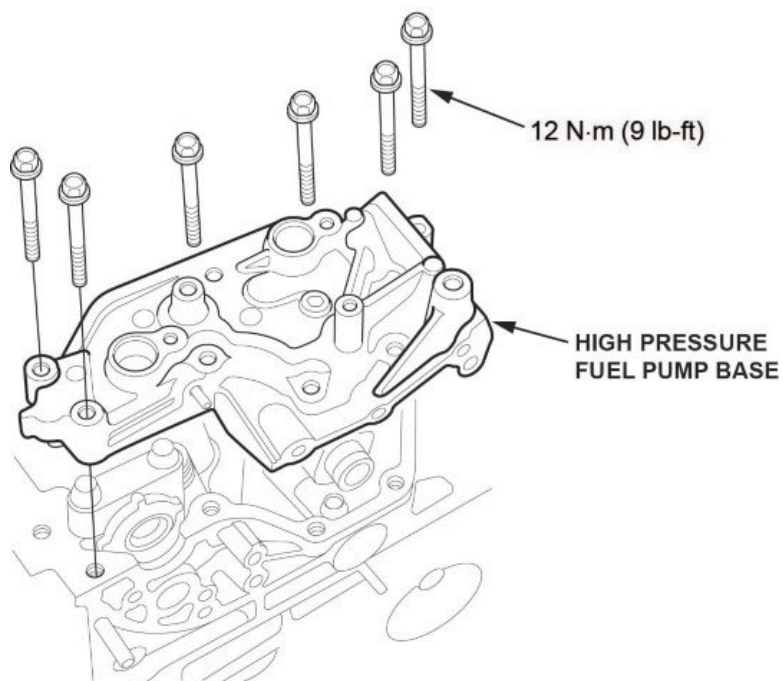

13. Remove the camshaft holder bolts, then remove the camshaft holders. To prevent damaging the camshafts, loosen the bolts in sequence, two turns at a time.

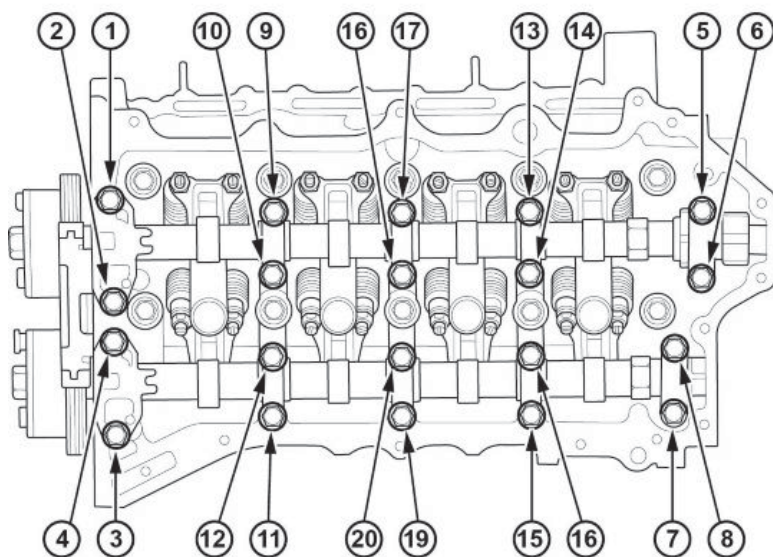

14. Lift up the cam chain, then carefully remove the intake camshaft followed by the exhaust camshaft.

**NOTE**

You must maintain tension on the cam chain while you do this.

Lift up the cam chain and  
carefully slip the camshaft out.

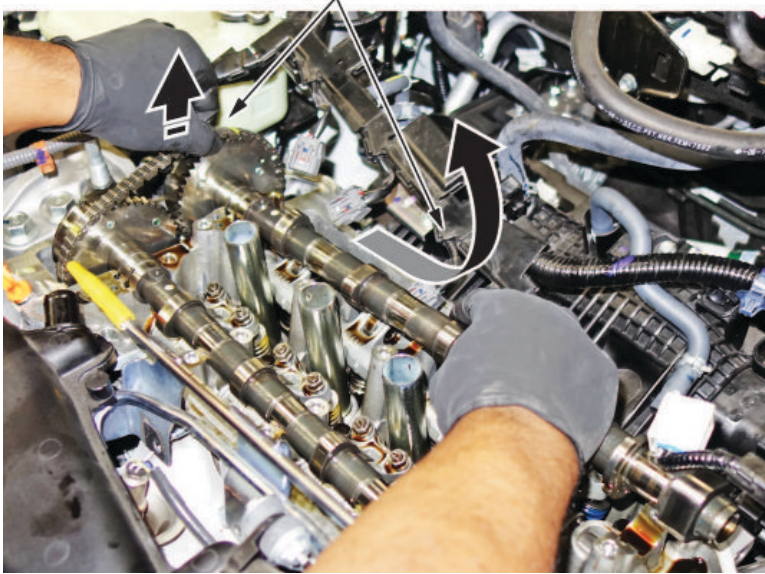

15. Use a bungee cord to hold tension on the cam chain while you are replacing the camshafts.

**BUNGEE CORD**



**BUNGEE HOOK**

**CAM CHAIN**

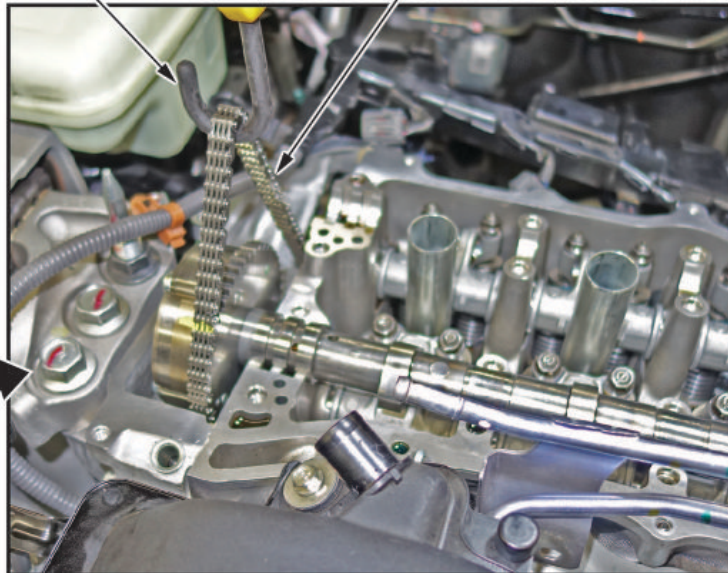

16. When removing the camshaft holders, cam chain guide, and intake and exhaust camshaft, make sure to place them in order of installation on a clean, padded workbench.

17. Remove the rocker arm assembly, and install the new set. Refer to the service information for additional instructions.

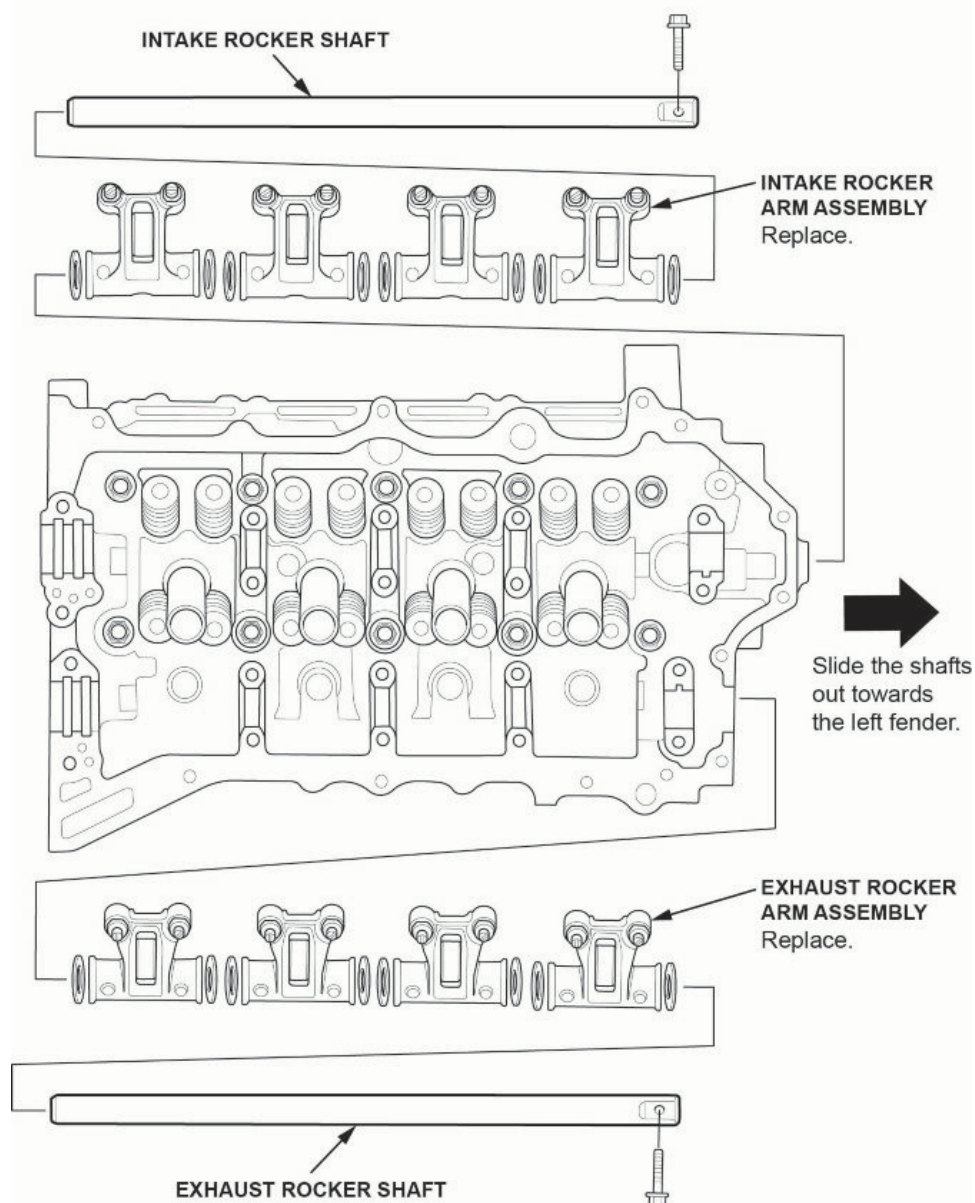



18. With the camshafts out of the engine, hold them with an open-end wrench and loosen the VTC actuator mounting bolts on both camshafts.
19. Install the VTC actuators on the new camshafts.

**NOTE**

You may need an assistant to help you with this procedure.

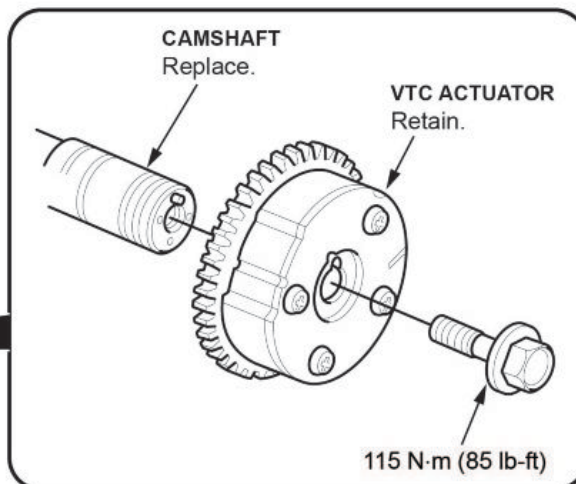
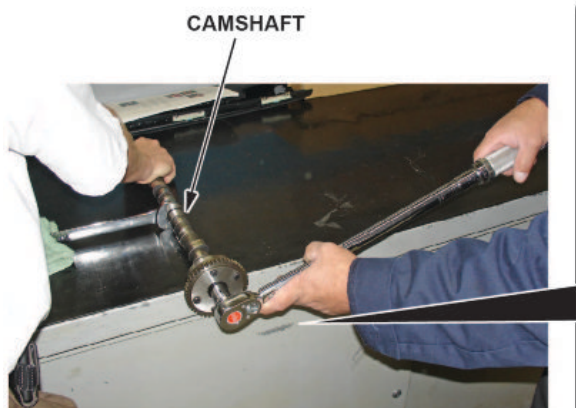

20. Apply fresh engine oil to the new camshafts, and install.



21. When installing the new camshafts, ensure the previously made marks on the VTC actuator and cam chain line up.



As the camshaft is installed,  
line up the marks made in step 3.

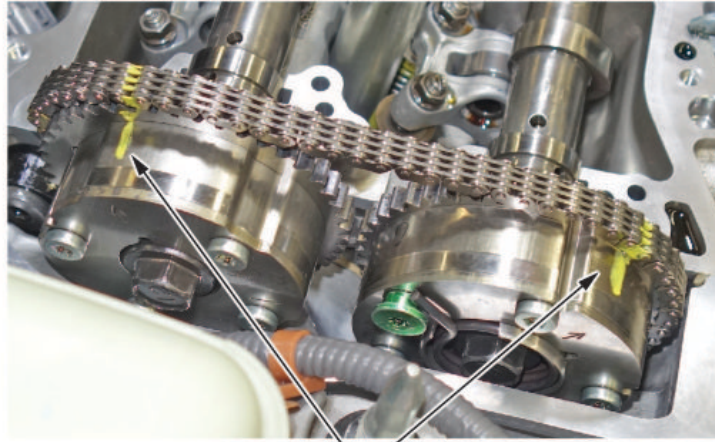

MARKS

22. Install the camshaft holders and the cam chain guide, then torque them to specification.

23. Install the camshaft chain tensioner and release the lock pin.

24. Install the new cam chain auto-tensioner (chain case) cover.

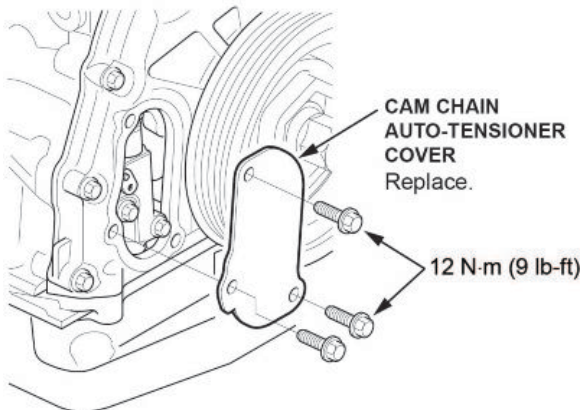

25. To check the camshaft timing, rotate the crankshaft in the direction of engine rotation (clockwise) two full turns, then stop at the TDC mark. Refer to step 4 of the Camshaft Timing Inspection in the service information.

26. Do a valve adjustment.

27. Install the high pressure fuel pump base and new camshaft holder cover. Refer to step 6 of the installation section of the Camshaft and VTC Actuator Removal, Installation, and Inspection (1.5L Engine) in the service information.

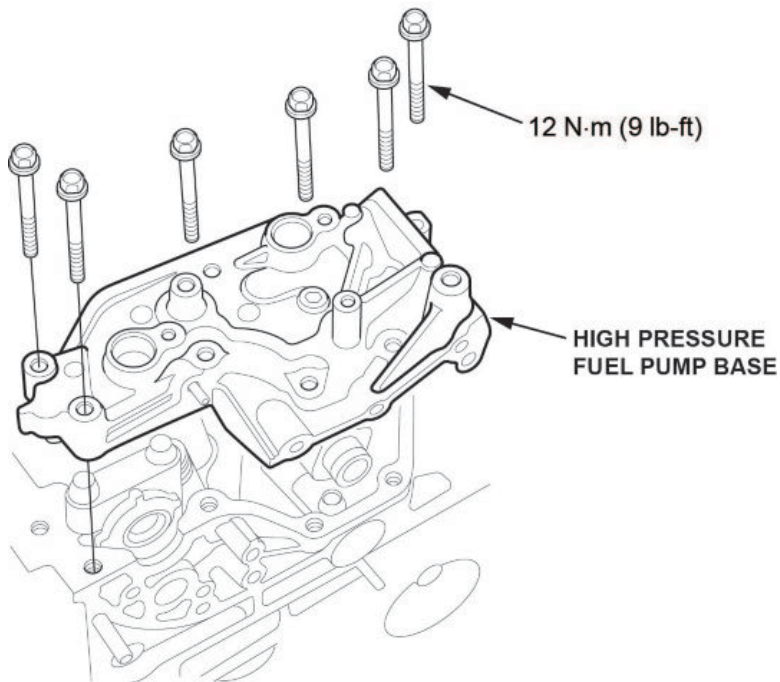

28. Install the cylinder head cover. Refer to the service information for additional instructions.
29. Install the high pressure fuel pump with the new o-ring and fuel joint pipe. Refer to the service information for additional information.
30. Install the engine undercover and any other remaining parts.
31. During the first start up, check for DTCs set or abnormal noises. Refer to service information for additional instructions.
32. Connect the i-HDS and click on the **Body Electrical**. From there, select **HVAC** and open **Data List/Snapshot** to check if the A/C control unit has been replaced. One of three options will appear: **Not Complete**, **Completed**, or **Not Applicable**.
- If it reads **Completed** or **Not Applicable**, skip to step 34.
  - If it reads **Not Complete**, go to step 33.
33. Replace the climate control unit.
- 33.1. Remove the climate control unit and replace with the new unit. See service information for additional instructions.
- 33.2. Install all parts in reverse order.
- 33.3. Run the self-diagnostics procedure with the i-HDS to make sure there are no problems in the system and clear any HVAC system DTCs that might appear.
34. Reset maintenance minder main code A. Refer to the service information.
35. Drain and refill the engine oil (3.4 quarts). Do not replace the oil filter.
36. With the i-HDS, check to see if the PGM-FI and TCM software has been updated by using the J2534 rewrite application.
- If updated, the procedure is complete.
  - If not, continue with step 37.

37. Update the PGM-FI and TCM software using the i-HDS J2534 rewrite software with the MVCI or DST-i. Refer to Service Bulletin 01-023, *Updating Control Units/Modules*.

#### NOTES

- Connect a fully charged jumper battery and leave it connected during the entire procedure to maintain steady voltage.
  - Never turn the ignition to OFF or ACCESSORY during the update. If there is a problem with the update, leave the ignition turned to ON.
  - To prevent control unit damage, do not operate anything electrical (headlights, audio system, brakes, A/C power windows, door locks, etc.) during the update.
  - Do not use the MongoosePro VCI tool.
38. Reset the throttle position learned values by referencing the throttle body removal and installation in the service information, then do the PCM idle learn procedure. Refer to service information for additional instructions.

#### NOTE

For more information on the PCM idle learn procedure, see the *Tech2Tech®* video, "A Look at PCM Idle Learn".

END