 HYUNDAI Technical Service Bulletin	GROUP Fuel System	NUMBER 19-FL-003H
	DATE April, 2019	MODEL(S) All 2005MY or later Hyundai Vehicles
SUBJECT ECM AND PCM VIN WRITING DURING CONTROL MODULE REPLACEMENT		

This TSB supersedes TSB# 04-36-019 to update the service procedure.

Description: This bulletin provides the procedure to write the Vehicle Identification Number (VIN) during the replacement of the Engine Control Module (ECM) or Powertrain Control Module (PCM). Once the VIN has been programmed to the ECM/PCM, it cannot be removed or overwritten.

- All vehicles are shipped with the VIN pre-programmed into the ECM/PCM. If either the ECM/PCM needs to be replaced, the VIN must be programmed to the new module.
- A new ECM/PCM requires that this function be performed following installation. Failure to perform this function will result in a check engine light with DTC P0630 (VIN not programmed or mismatch).

Applicable Vehicles: All 2005 or later model year Hyundai vehicles

⚠ WARNING

Input of incorrect VIN during the writing procedure requiring the purchase of a new ECM/PCM is non warrantable.

⚠ CAUTION

Do not exchange an ECM/PCM from another vehicle as a permanent repair. If the module has to be replaced, a new service replacement control module must be used, and the VIN must be programmed into the new control module.

Service Procedure:

1. Select “S/W Management” utilizing the GDS-Mobile.

NOTICE

Ensure the GDS Mobile and VCI II has the latest software update prior to the procedure.

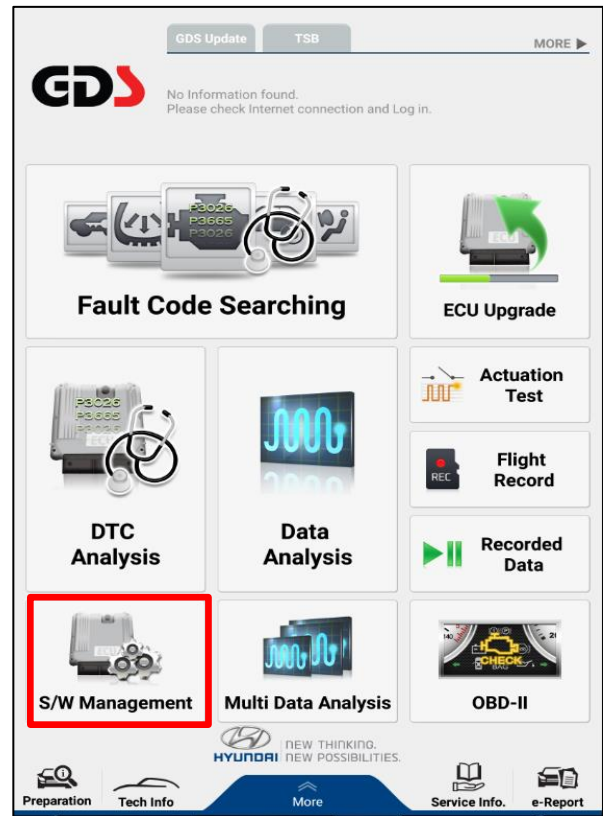

2. Select “Write VIN” from the “Engine Control” drop down menu.

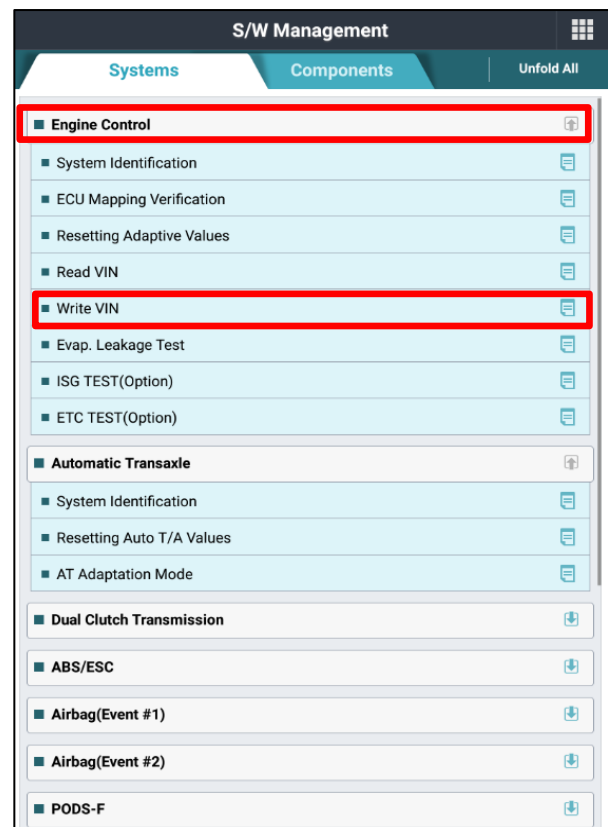

3. Select "OK" to continue.

NOTICE

Ensure that the engine is "OFF" and the ignition switch/push button is in "ON" position prior to continuing.

S/W Management

• Write VIN

Purpose	To write the VIN.
Enable Condition	1.Engine Off 2.Ignition Switch On
Concerned Component	PCM/ECM
Concerned DTC	P0630
Fail Safe	Warning Lamp On
Etc	- A new ECM requires that this function be performed following installation. Failure to perform this function will result in MIL illumination with DTC P0630. - After confirming the written VIN, the ECU will erase the fault code and MIL.

OK

4. Manually input the VIN number located on the vehicle.

S/W Management

■ Write VIN

• [Write VIN]

This function is used to write the VIN into the ECM's memory.

A new ECM requires that this function be performed following installation. Failure to perform this function will result in MIL illumination with DTC P0630. After confirming the written VIN, ECU will erase the fault code and MIL.

• [Condition]
IG. On (Engine Off)

Press [OK] button, after typing the number.

VIN :

OK Cancel

- The VIN plate is usually located on the driver's side dashboard (viewable from the windshield) and the driver's side door sill or the inner rear lower edge of the drivers side door (on a sticker).



5. Once the VIN has been inputted, select "OK" to program the VIN number to the new ECM/PCM.

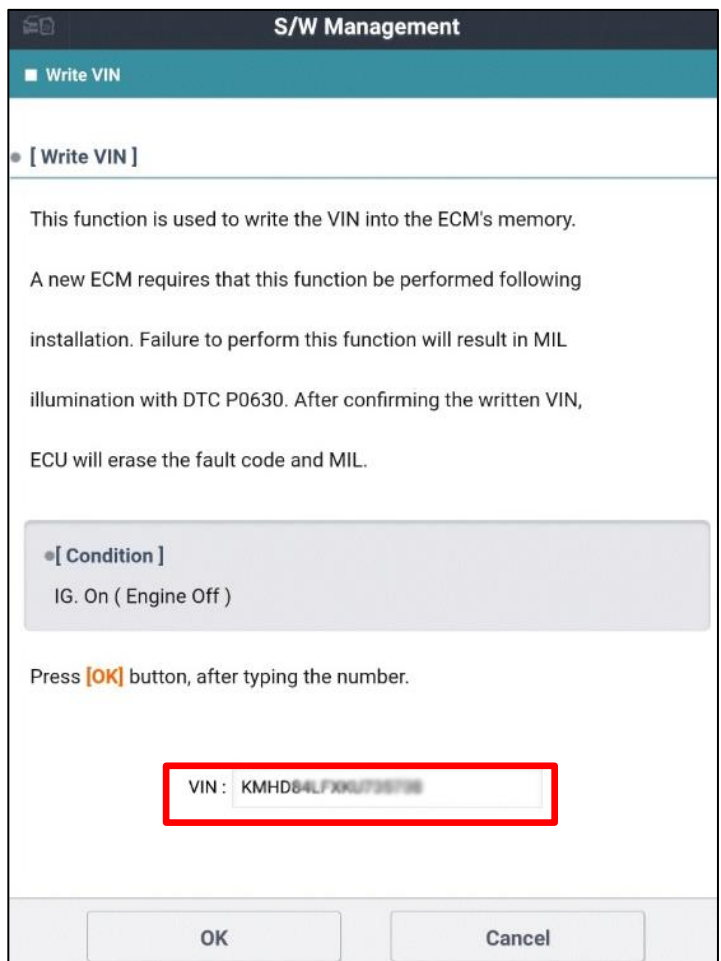

⚠ WARNING

Confirm the inputted VIN number carefully before selecting "OK". Once the VIN has been written, it cannot be modified.

6. Select "OK" to confirm the VIN number to the vehicle on the next screen.

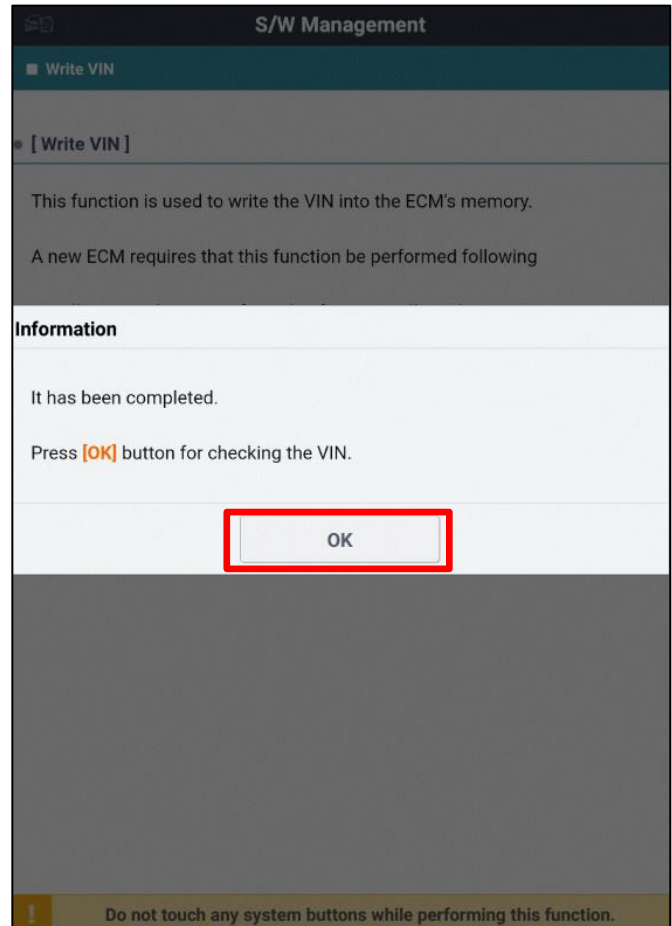

7. Check for DTCs and erase any DTCs.
8. Erase the DTC in the BlueLink system according to TSB 12-BE-005-2.
9. Confirm normal vehicle operation.
10. The service procedure is now complete.