



Special Tools Bulletin

TITLE:

Newsletter 81: Mandatory Tools

| | | | |
|-------------------|-------------------------|--|-------------|
| NO: 231 | ISSUE DATE: 2019-02-14 | CAR MARKET: United States and Canada | Page 1 of 3 |
| | STATUS DATE: 2019-02-14 | | |

“Right first time in Time”

All tools have been classified as required, and will be allocated and billed to all U.S. and Canadian retailers by Volvo.

All tool allocations and tool orders are being handled by the Volvo Parts Operations and the Volvo Parts Distribution Centers.

Overview of content:

| <u>Art No.</u> | <u>Description</u> | <u>Standard</u> |
|----------------|---------------------------|-----------------|
| 9513124 | BOB Inlay Kit | C1 |
| 9997687 | Hydraulic Hole Cylind.10T | C1 |
| 9997693 | Gauge | C1 |
| 9997695 | Drift | C1 |
| 9997696 | Drift | C1 |

9513124

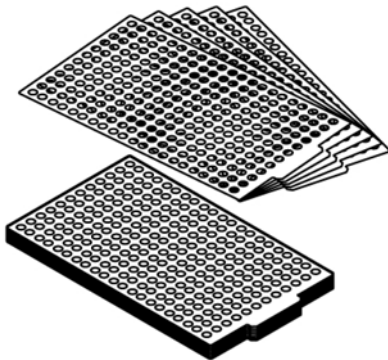

BOB Inlay Kit

Overlay Schedule to Measurement Box 9513088.
Contains Overlay for 9513109, 9513110, 9513111, 9513112, 9513113 and 9513118.

| | |
|----------------------|----------------|
| Tool standard | C1 |
| Tool group | 39.0 |
| Tool bulletin | 413 |
| Model | Various models |
| Tool board | 39 |

| Service Personnel: Read and initial | SERVICE MANAGER | PARTS MANAGER | WORKSHOP FOREMAN | SERVICE TECHNICIANS | | | | | | | | | |
|--|-----------------|---------------|------------------|---------------------|--|--|--|--|--|--|--|--|--|
| | | | | | | | | | | | | | |



9997687

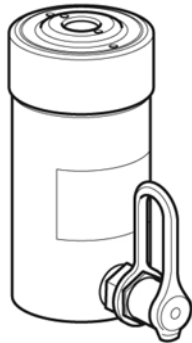

Hydraulic Hole Cylind.10T

Hydraulic hole cylinder for push and pull operations. The hydraulic cylinder has a pressure and tensile force of 10 tonnes.

The hydraulic cylinder works with the Hydraulic Pump 9512566.

| | |
|----------------------|------|
| Tool standard | C1 |
| Tool group | 65.0 |
| Tool bulletin | 412 |
| Model | All |
| Tool board | 65 |

9997693

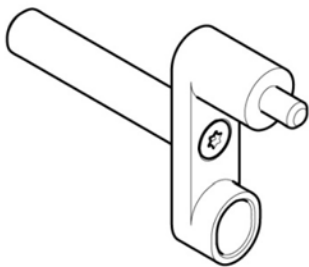

Gauge

Gauge for control of Whiplash, rear-end protection device. The Gauge checks whether activation has taken place.

| | |
|----------------------|-------|
| Tool standard | C1 |
| Tool group | 88.00 |
| Tool bulletin | 412 |
| Model | XC40 |
| Tool board | 80 |

9997695

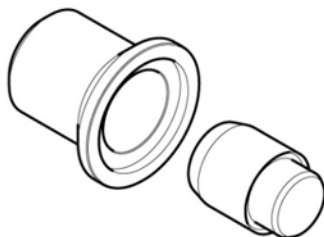

Drift

Used when mounting drive shaft seal, left side.

| | |
|----------------------|--------------|
| Tool standard | C1 |
| Tool group | 43.0 |
| Tool bulletin | 412 |
| Model | XC40, 7 DCTH |
| Tool board | 43 |



9997696

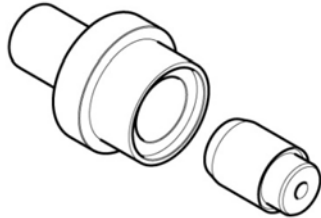

Drift

Used when mounting drive shaft, right side.

| | |
|----------------------|--------------|
| Tool standard | C1 |
| Tool group | 43.0 |
| Tool bulletin | 412 |
| Model | XC40, 7 DCTH |
| Tool board | 43 |

| C1 | |
|----------|---------------------------|
| 33300318 | |
| 9513124 | BOB Inlay kit |
| 9997687 | Hydraulic Hole Cylind.10T |
| 9997693 | Gauge |
| 9997695 | Drift |
| 9997696 | Drift |