



Service Bulletin

Bulletin No.: 17-NA-113

Date: January, 2019

TECHNICAL

Subject: HVAC Temperature Control Inoperative or Notable Variance in Temperature Performance

Brand:	Model:	Model Year:		Date Breakpoint:		Engine:	Transmission:
		from	to	from	to		
Chevrolet	Trax (Country '3' VIN pos 1, Plant 'L' VIN pos 11)	2016	2018	SOP 2016	Prior to January 2018	All	All

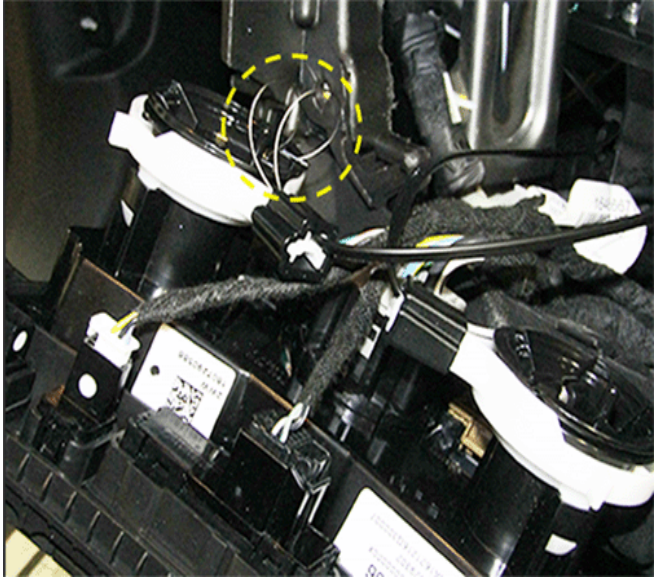
Involved Region or Country	North America
Additional Options (RPOs)	HVAC SYSTEM-AIR CONDITIONER FRT, MAN CONTROLS — (RPO C60)
Condition	Some customers may comment that the temperature control is inoperative or a notable variance in HVAC temperature performance.
Cause	 <p style="text-align: right;">4694290</p> <p>The cause of the condition may be that the wiring on the control cable may have sprung loose from the pulley and lost tension.</p>

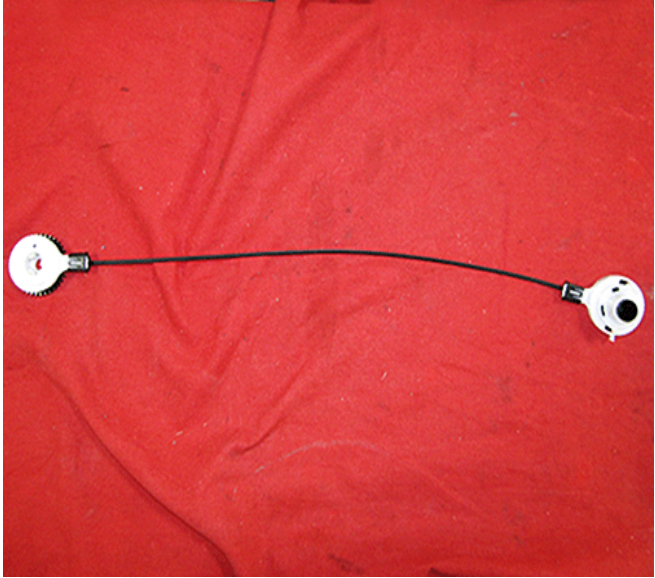
<p>Correction</p>	 <p>4694298</p> <p>Replace the HVAC temperature control cable.</p>
-------------------	--

Service Procedure

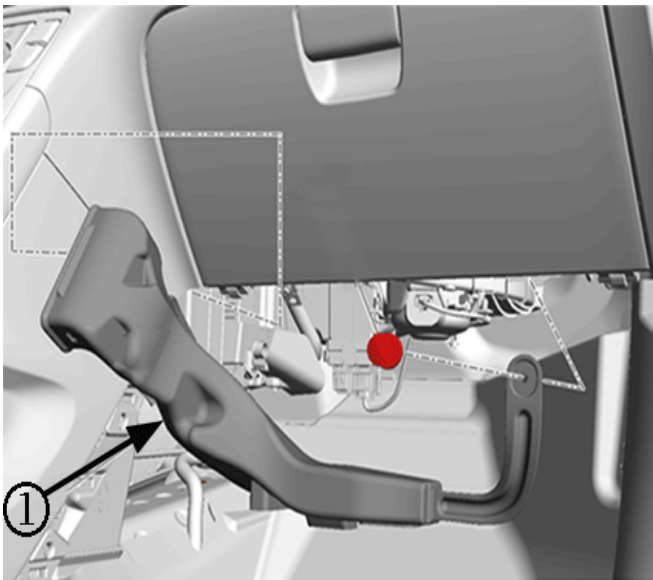

4694303

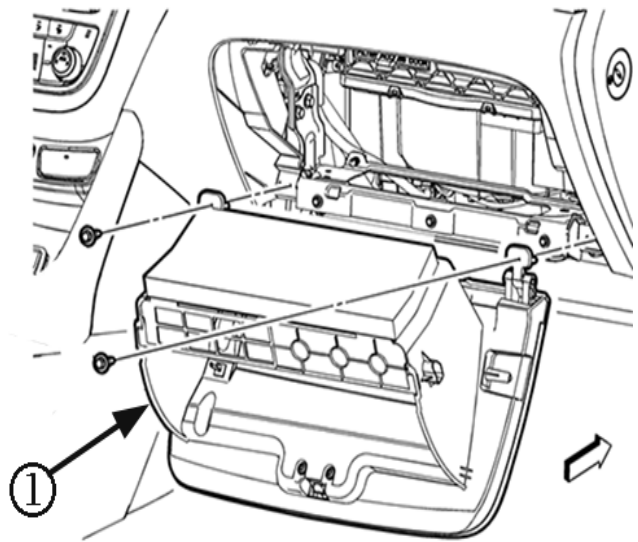

4694308

1. Remove the right side floor air outlet duct (1). Refer to *Floor Front Air Outlet Duct Replacement - Right Side* in SI.

2. Remove the I/P compartment (1). Refer to *Instrument Panel Compartment Replacement* in SI.

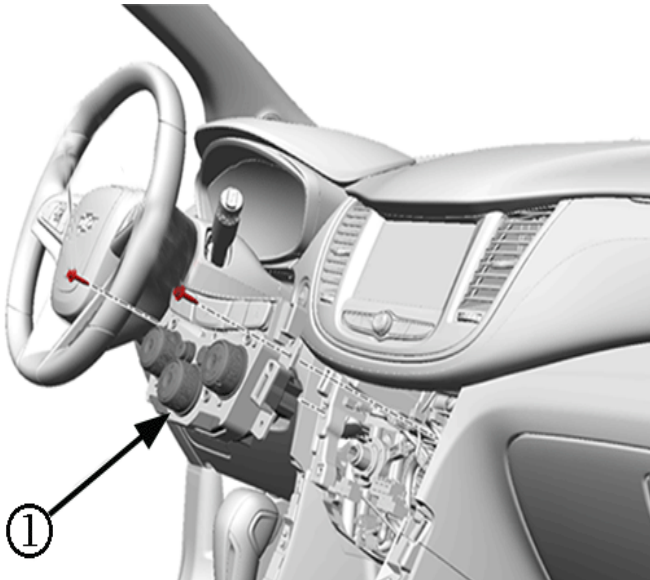

4694313

3. Remove the heater and air conditioning control with cable control (1). Refer to *Heater and Air Conditioning Control with Cable Control Replacement* in SI.

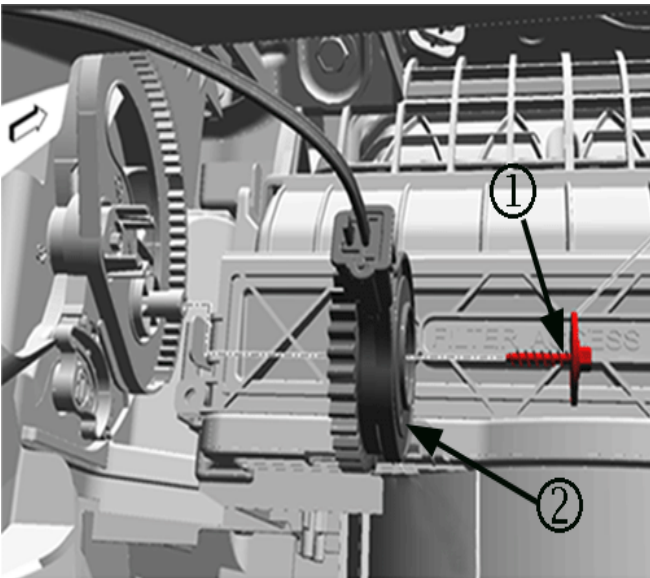

4694319

4. Remove the temperature control cable retaining screw (1) and the temperature control cable (2) from the heater and air conditioning evaporator and blower module.
5. Maneuver the temperature control cable out from behind the tie bar and the instrument panel.

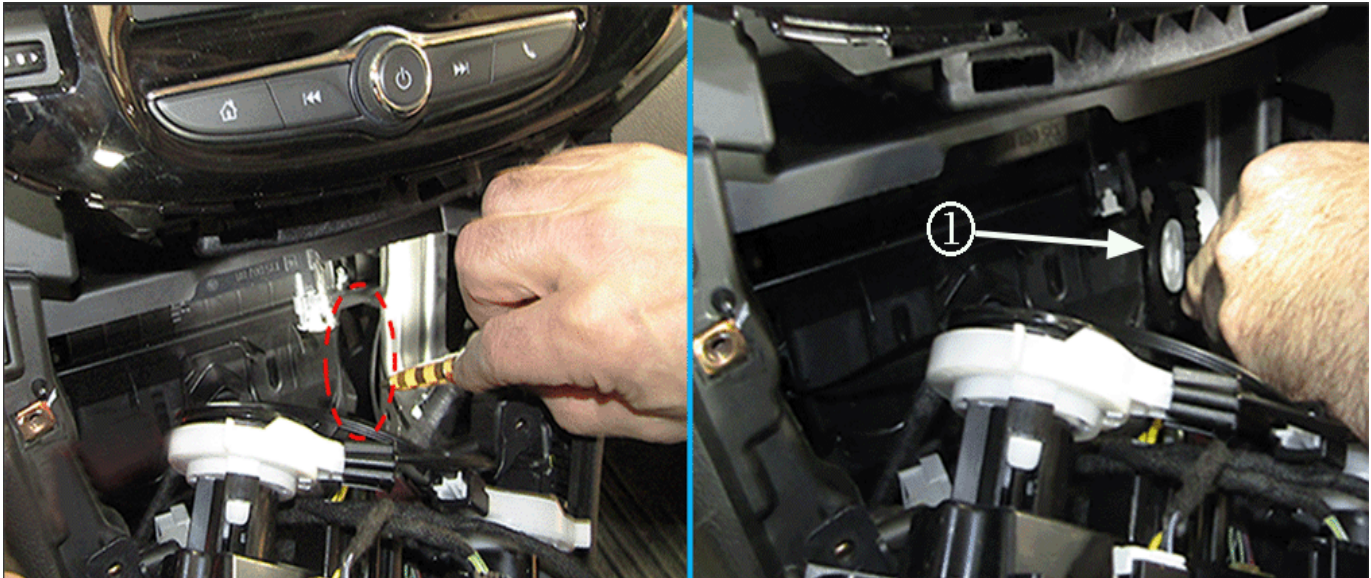

4694323

6. Start the routing of the new control cable by passing the cable pulley through the opening shown circled at the pointer in the graphic above. Pass the pulley through the opening, in the orientation shown (1) (with gear facing the driver side), and ensure the cable does not twist or kink during the routing.

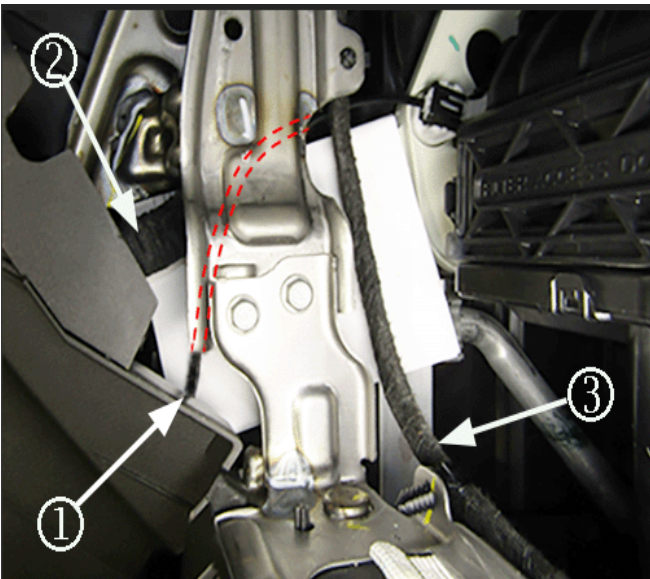

4694333

Note: To improve visibility of the cable and harnesses, a sheet of white paper was placed behind the tie bar in the graphic above. The cable end is also shown secured in position.

7. Route the temperature control cable (1) behind the instrument panel and the tie bar, then upward between the "V" formed by harness (2) and harness (3).

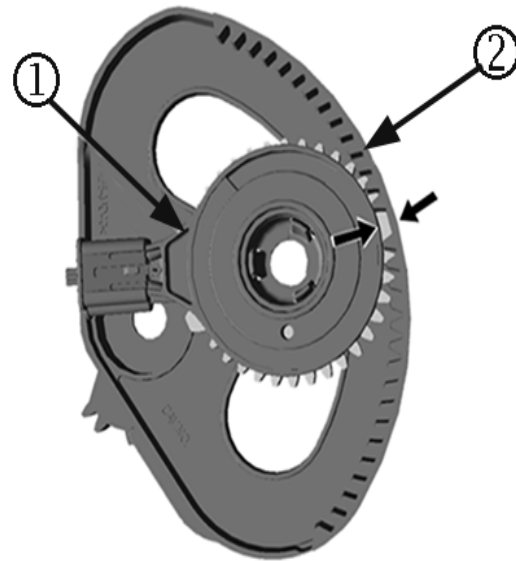

4694339

8. For proper alignment during installation, index the temperature valve gear (1) large female tooth to temperature control cable gear (2) large male tooth, as indicated by the arrows.

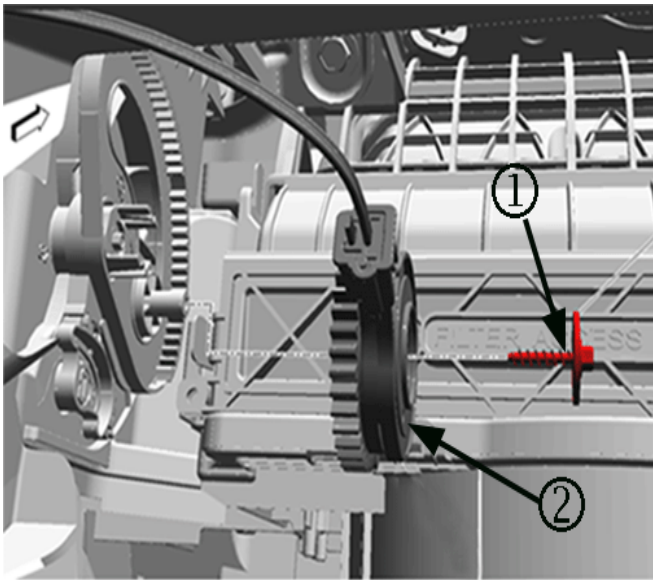

4694319

9. Install the temperature control cable retaining screw (1) and the temperature control cable (2) onto the heater and air conditioning evaporator and blower module. Tighten the screw to **2 Y (18 lb in)**.

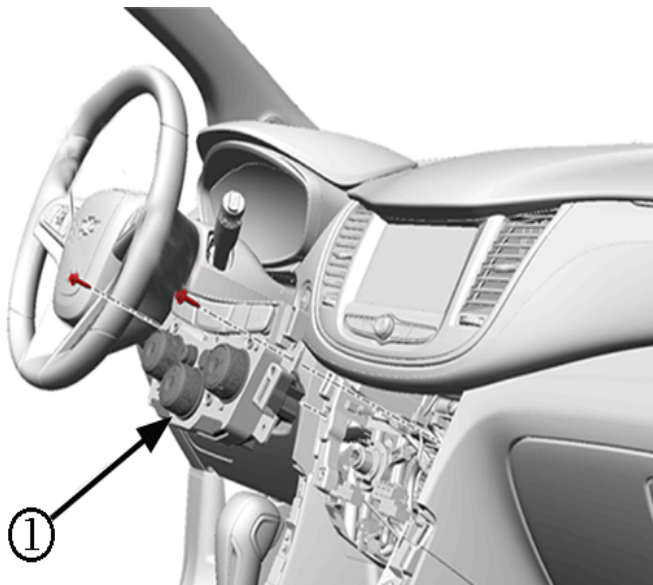

4694313

Important: Prior to final installation of the console and I/P trim, ensure smooth/proper operation of the temperature control knob by completing several rapid rotations of the knob.

10. Install the heater and air conditioning control with cable control (1). Refer to *Heater and Air Conditioning Control with Cable Control Replacement* in SI.

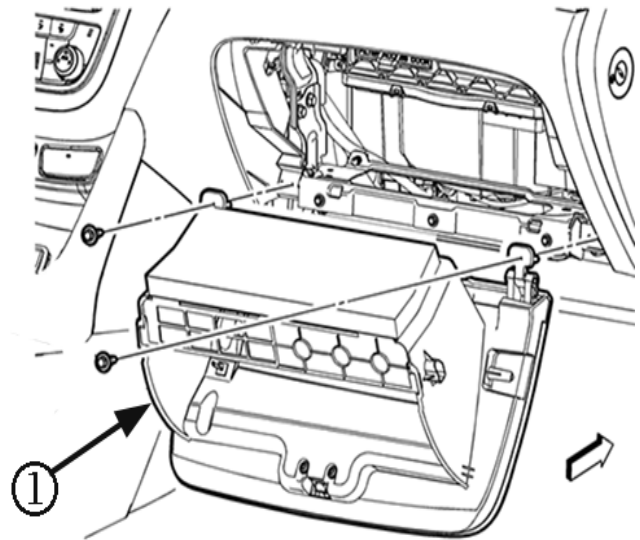

4694308

11. Install the I/P compartment. Refer to *Instrument Panel Compartment Replacement* in SI.

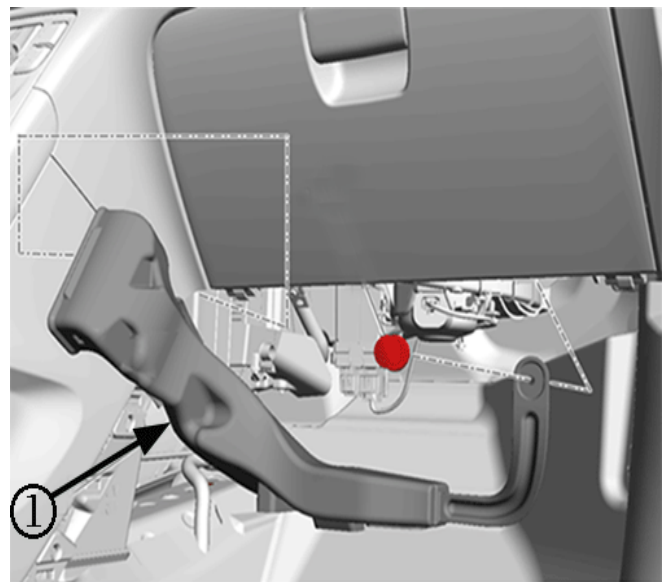

4694303

12. Install the right side floor air outlet duct. Refer to *Floor Front Air Outlet Duct Replacement - Right Side* in SI.

Parts Information

Causal Part	Description	Part Number	Qty
X	CABLE ASM- TEMP CONT	95476706	1

Warranty Information

Labor Operation	Description	Labor Time
4430470	Temperature Control Cable Replacement	Use Published Labor Operation Time

Version	2
Modified	January 25, 2019 – Added the 2018 Model Year and updated the Breakpoint date.

