

2019 LX570 Pre-Delivery Service (PDS)

Service Category General

Section Pre-Delivery Service

Market USA

Lexus Supports
ASE Certification 

Applicability

YEAR(S)	MODEL(S)	ADDITIONAL INFORMATION
2019	LX570	

REVISION NOTICE

December 12, 2018 Rev1:

- The D/C Cut Fuse Installation section has been updated.
- Any previous printed versions of this bulletin should be discarded.

Introduction

This bulletin contains the vehicle specific pre-delivery services for 2019 model year LX570 vehicles. Additionally, refer to the applicable Pre-Delivery Service (PDS) Check Sheet for services to be performed.

Warranty Information

OP CODE	DESCRIPTION	TIME	OFF	T1	T2
N/A	Not Applicable to Warranty	—	—	—	—

Procedures

- Front License Plate and Mounting Bracket Installation 2
- D/C Cut Fuse Installation 4
- Roof Rack Cross Bar and Leg Cover Installation 5
- Towing Wire Harness Connector Installation 7

2019 LX570 Pre-Delivery Service (PDS)

Front License Plate and Mounting Bracket Installation

The front license plate mounting bracket and two self-tapping screws for the 2019 model year LX570 are stored in the rear cargo area of the vehicle. For states that require front license plate, install the license plate and mounting bracket during PDS.

1. Remove the two radiator grille moldings by disengaging the three claws on each.

Figure 1.

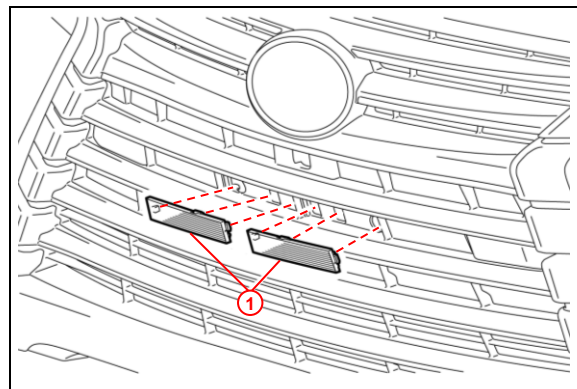

1	Radiator Grille Molding
---	-------------------------

2. Attach the hooks of the front license plate mounting bracket to the air intake of the radiator grille and hold in place.
3. Align holes "A" of the mounting bracket with the installation holes on the radiator grille.

NOTE

- Holes "A" are used to install the mounting bracket to the bumper cover.
- Holes "B" are used to install the front license plate to the mounting bracket.

Figure 2.

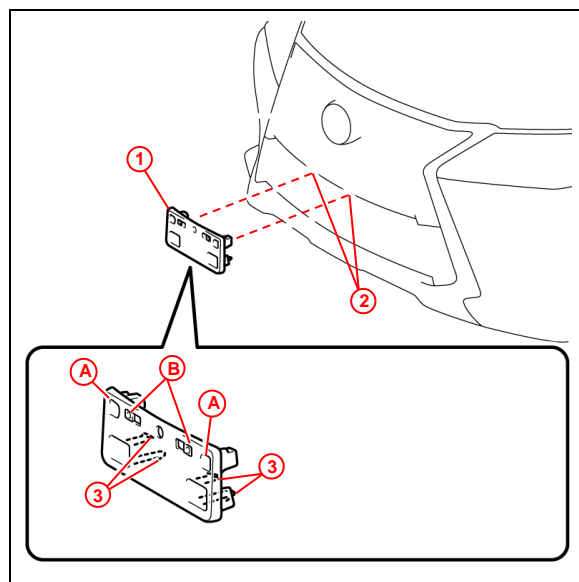

1	Mounting Bracket
---	------------------

2	Installation Hole
---	-------------------

3	Hook
---	------

2019 LX570 Pre-Delivery Service (PDS)

Front License Plate and Mounting Bracket Installation (continued)

4. Install the mounting bracket to the radiator grille using the two self-tapping screws provided.

NOTICE

Do NOT overtighten the self-tapping screws.

Figure 3.

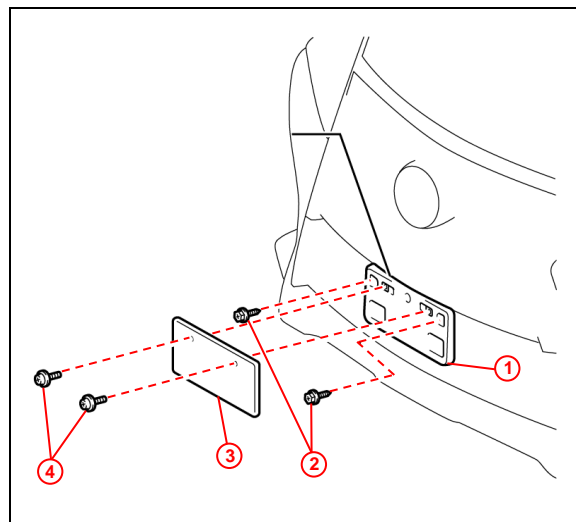

1	Mounting Bracket
2	Self-tapping Screw
3	License Plate
4	Bolt

5. Install the front license plate using two noncorroding bolts with the following dimensions:

Nominal Length: 15.0 mm (0.59 in.)

Diameter: 6.0 mm (0.24 in.)

Figure 4.

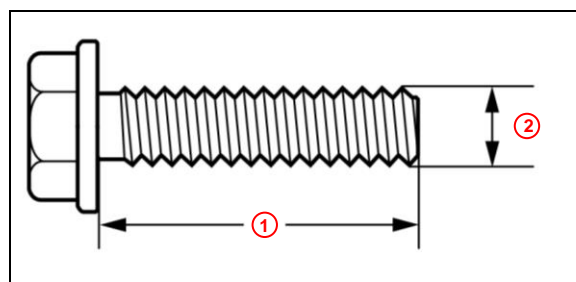

1	Nominal Length
2	Diameter

2019 LX570 Pre-Delivery Service (PDS)

D/C Cut Fuse Installation

To minimize battery discharge during transportation and storage, the D/C cut fuse (30A) has been removed at the assembly plant and temporarily stored in the blank space of the relay block in the engine compartment. During PDS, reinstall the D/C cut fuse (30A) into its original location and confirm ALL related Diagnostic Trouble Codes (DTCs) are cleared.

Remove the D/C cut fuse (30A) from the blank space of the relay block in the engine compartment and install the D/C cut fuse (30A) in the relay block as shown.

Figure 5.

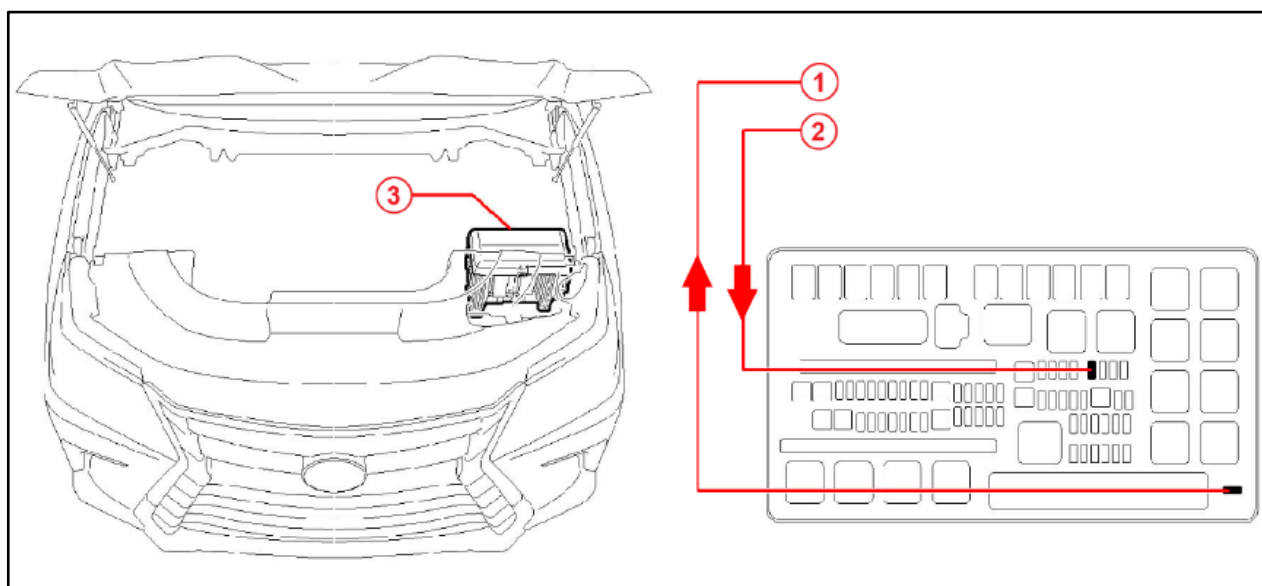

1	Remove D/C Cut Fuse (30A)
2	Install D/C Cut Fuse (30A) Here (Original Location)

3	Relay Block
----------	-------------

2019 LX570 Pre-Delivery Service (PDS)

Roof Rack Cross Bar and Leg Cover Installation

To avoid damage during transportation, the 2019 model year LX570 roof rack cross bars have been placed inside the vehicle at the assembly plant.

Install the roof rack cross bars and leg covers during PDS using the following procedure.

1. Loosen the adjustment knobs on each cross bar joint.

Figure 6.

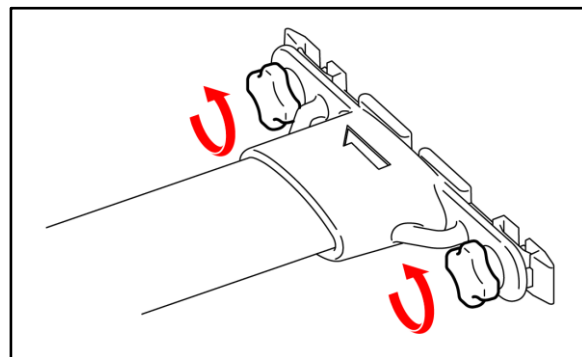

2. Slide the cross bar joints into the grooves of the right and left roof rack rails with the arrow mark on each cross bar joint facing forward.

NOTE

There is a possibility that the cross bars will create wind noise if they are installed backwards.

Figure 7.

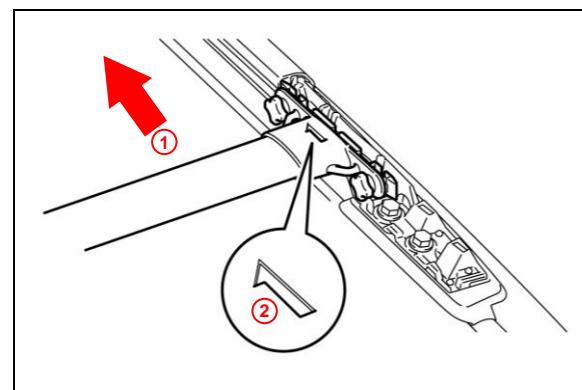

1	Front
2	Arrow Mark

2019 LX570 Pre-Delivery Service (PDS)

Roof Rack Cross Bar and Leg Cover Installation (continued)

3. Position the front and rear cross bars so that they are parallel to each other.
4. Securely tighten the knobs on each cross bar (A = A', B = B').

AREA	MEASUREMENT
A	250 mm (9.84 in.)
B	295 mm (11.60 in.)

NOTICE

If the knobs are NOT tightened securely, the knobs may come loose and rattle or possibly fall off the vehicle.

Figure 8.

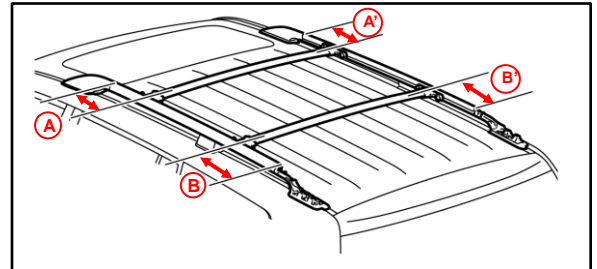

5. Install the right and left rear roof rack leg covers in the following sequence (labeled as shown):
 - A. Insert the tab at the front of the cover into the roof rack rail.
 - B. Place the cover on the leg and align the rear part of the cover. Do NOT press down.
 - C. Press the cover claws facing the outside of the vehicle into place.
 - D. Press the cover claws facing the inside of the vehicle into place.

NOTICE

Do NOT press on the claws facing the outside of the vehicle at the same time as pressing on the claws facing the inside. This may damage the leg cover.

Figure 9.

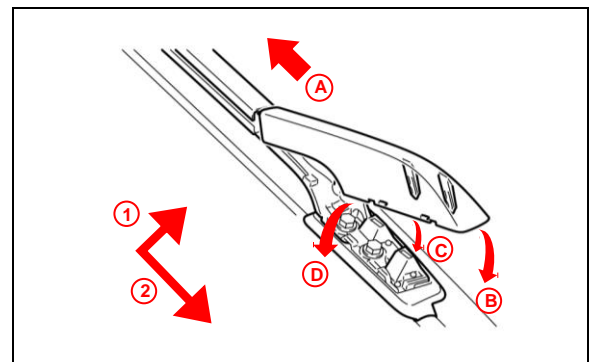

1	Outside
2	Rear

6. Check that the covers are installed securely.

2019 LX570 Pre-Delivery Service (PDS)

Towing Wire Harness Connector Installation

The towing wire harness connector set (towing wire harness connector assembly and two bolts) is loaded in the vehicle at the assembly plant to avoid damage in transit.

During PDS, use the following procedure to install the towing wire harness connector to the vehicle.

1. Connect the towing wire harness connectors.
 - A. Remove the water-resistant caps from the two frame wire harness connectors.
 - B. Connect the two frame wire harness connectors and two towing wire harness connectors.

Figure 10.

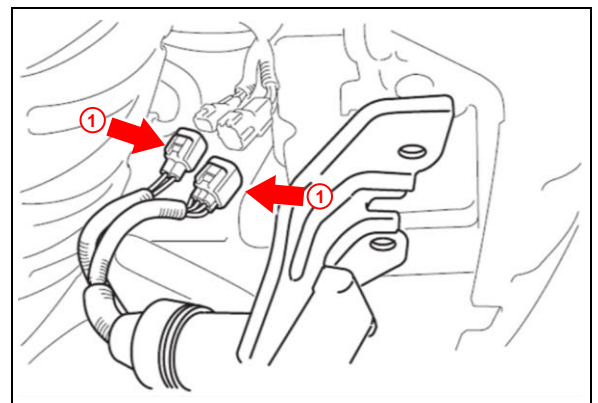

1 Towing Wire Harness Connector

2. Install the towing wire harness assembly bracket on the frame bracket using the two bolts provided.

Torque: 19.5 N*m (199 kgf*cm, 14 ft*lb)

Figure 11.

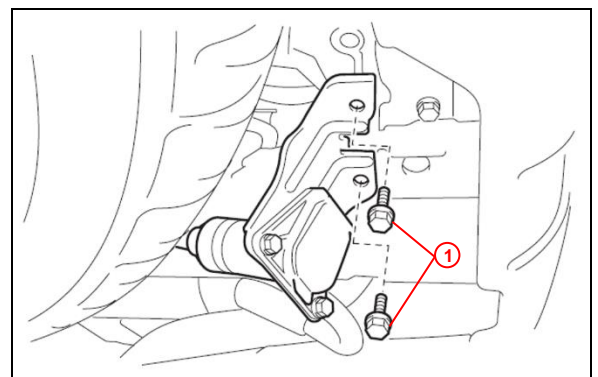

1 Bolt