



# SERVICE BULLETIN

Classification: BT18-016	Reference: NTB18-074	Date: November 6, 2018
-----------------------------	-------------------------	---------------------------

## 2018 KICKS; HIGH-MOUNTED STOP LAMP REMOVAL AND INSTALLATION

**APPLIED VEHICLES:** 2018 Kicks (P15)

### SERVICE INFORMATION

The high-mounted stop lamp assembly, that is located at the top of the inside surface of the back door, can be removed or reinstalled with the following service procedure.

**IMPORTANT:** The high-mounted stop lamp assembly will be damaged if the following procedure is not followed.

### SERVICE PROCEDURE

1. Open the back door.
2. Locate the high-mounted stop lamp assembly (stop lamp).
  - See Figure 1 and Figure 2.

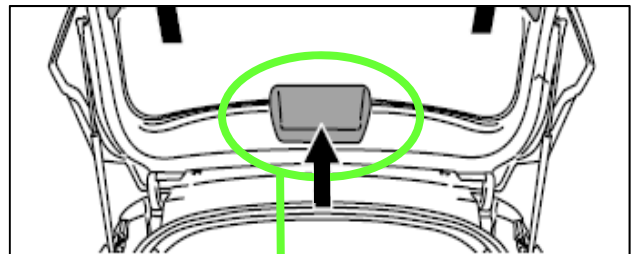

Figure 1

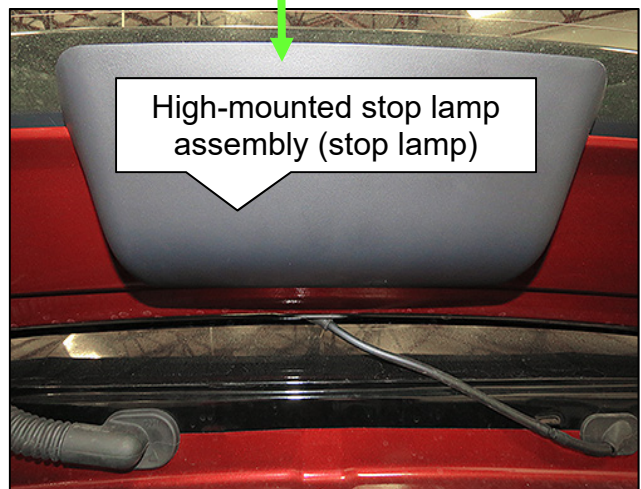

Figure 2

Nissan Bulletins are intended for use by qualified technicians, not 'do-it-yourselfers'. Qualified technicians are properly trained individuals who have the equipment, tools, safety instruction, and know-how to do a job properly and safely. NOTE: If you believe that a described condition may apply to a particular vehicle, DO NOT assume that it does. See your Nissan dealer to determine if this applies to your vehicle.

**NOTE:**

- Figure 3 shows the bottom of the stop lamp, and is an example of a tab and a retainer spring.
- Having a visual of the tabs and retainer springs will help in the next steps.

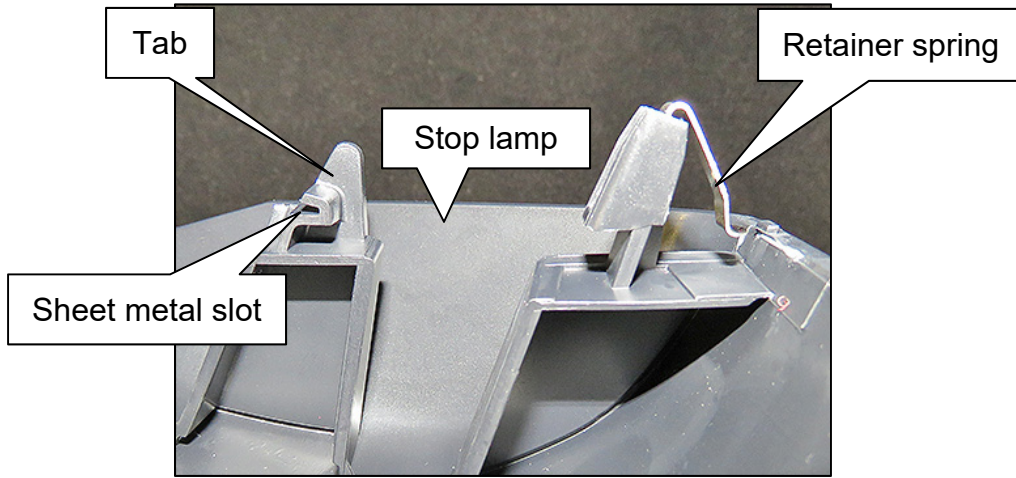

Figure 3

3. With the tips of your fingers, carefully push the stop lamp in the direction shown in Figure 4 (parallel to the back door).
- Push the stop lamp with enough force to compress the retainer springs and disengage the tabs.

**NOTE:** Approximate location of the tabs and retainer springs are shown.

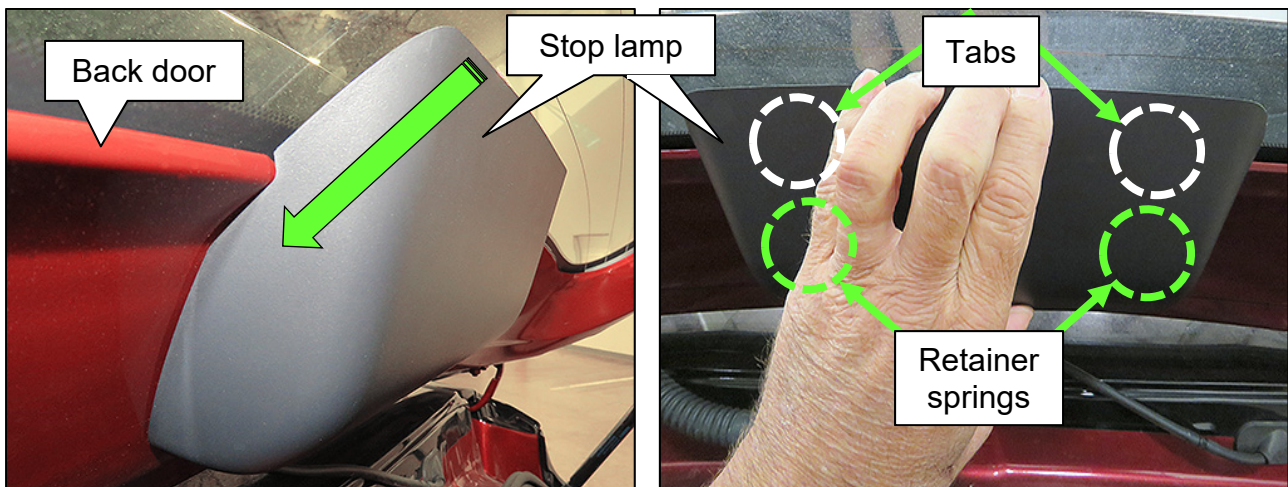

Figure 4

4. While maintaining downward pressure, rotate the top edge of the stop lamp away from the backdoor.
  - If the tabs are completely disengaged, the stop lamp will rotate easily away from the back door.

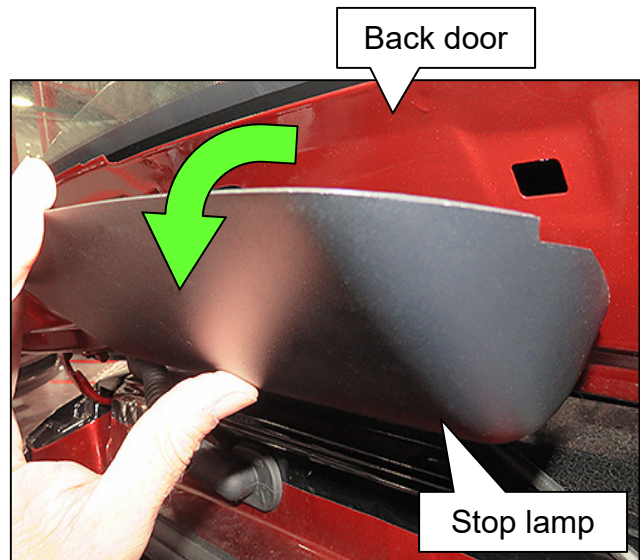

Figure 5

5. After rotating the stop lamp, gently pull the retainer springs from the back door.

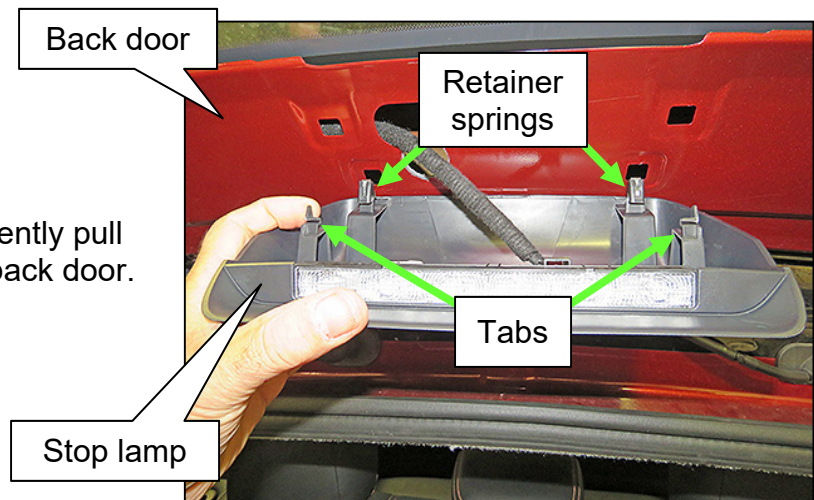

Figure 6

6. The stop lamp can be reinstalled in the reverse order of removal.

## AMENDMENT HISTORY

PUBLISHED DATE	REFERENCE	DESCRIPTION
November 6, 2018	NTB18-074	Original bulletin published

