



GROUP
ELE

MODEL
2019MY
Optima (JFa)

NUMBER
153

DATE
November 2018

TECHNICAL SERVICE BULLETIN

SUBJECT: SERVICE ACTION: POWER WINDOW SWITCH
ASSEMBLY REPLACEMENT (SA354)

This bulletin provides the procedure to replace the main power window switch assembly on some 2019MY Optima (JFa) vehicles, produced from May 22, 2018 through August 30, 2018, which may experience a non-functioning “auto-up” window switch. Follow the procedure outlined in this bulletin to replace the main power window switch assembly.

Kia is requesting the completion of this Service Action on all affected vehicles in dealer stock, prior to delivery. Before conducting the procedure, verify that the vehicle is included in the list of affected VINs.



* NOTICE

A Service Action is a repair program without customer notification that is performed during the warranty period. Any dealer requesting to perform this repair outside the warranty period will require DPSM approval.

Repair status for a VIN is provided on WebDCS (Service → Warranty Coverage → Warranty Coverage Inquiry → Campaign Information). Not completed Recall / Service Action reports are available on WebDCS (Consumer Affairs → Not Completed Recall → Recall VIN → Select Report), which includes a list of affected vehicles.

This issue number is SA354.

File Under: <Electrical>

Circulate To: General Manager Service Manager Parts Manager
 Service Advisors Technicians Body Shop Manager Fleet Repair

Replacement Procedure:

1. Remove the main power window switch assembly (A) by referring to the “Body Electrical System → Power Windows → Power Window Switch → Repair procedures” chapter in the applicable Shop Manual on KGIS.

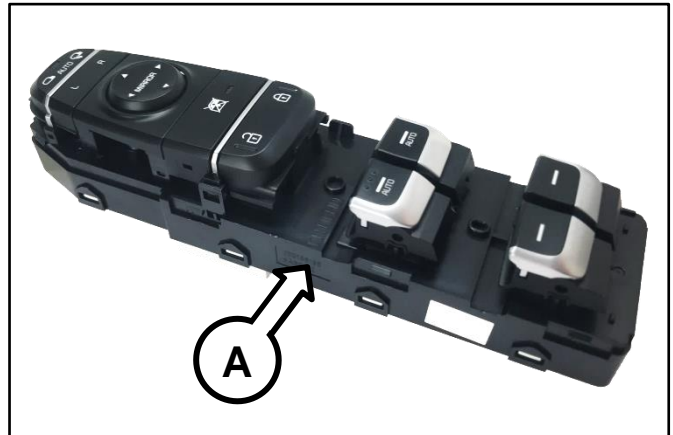

2. Detach the new main power window switch (B) from the new switch and bezel assembly and install the new switch into the existing bezel.

Discard the new bezel (C) after removal of the switch (B).

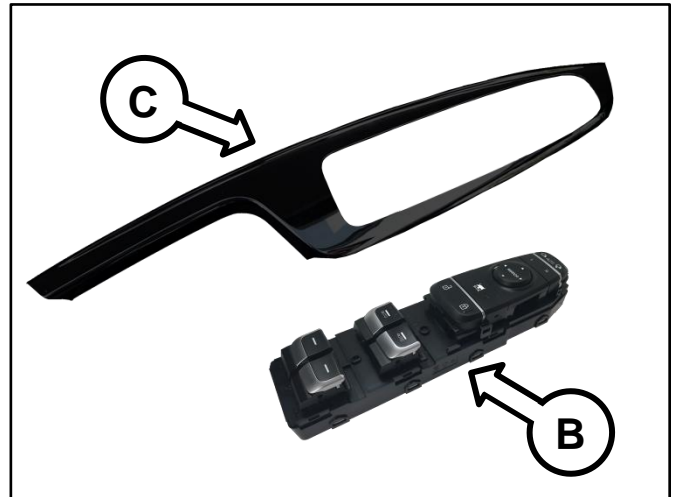

3. Reinstall all removed components in the reverse order of removal and confirm proper functions of main window switch.

SUBJECT:

SERVICE ACTION: POWER WINDOW SWITCH ASSEMBLY REPLACEMENT (SA354)

AFFECTED VEHICLE RANGE:

Model	Production Date Range
Optima (JFa)	May 22, 2018 through August 30, 2018

REQUIRED PART:

Part Name	Part Number	Figure	Comments
Main Power Window Switch Assembly	93570 D5AH0QQK		Auto-shipped to Affected Dealers Only.
	93570 D5370QQK		Parts Order <u>Not</u> Necessary.

WARRANTY INFORMATION:

N Code: N99 C Code: C99

Claim Type	Causal P/N	Qty.	Repair Description	Labor Op Code	Op Time	Replacement P/N	Qty.
V	93571 D5170	0	(SA354) Power Window Switch Assembly Replacement	180A19R0	0.4 M/H	93570 D5AH0QQK 93570 D5370QQK	1

* NOTICE

VIN inquiry data for this repair is provided for tracking purposes only. Kia retailers should reference SA354 when accessing the WebDCS system.