

**MODEL:** Karma Revero**DATE:** October 2018**TITLE:** AC pressure switch inspection**First Release****PRIORITY:** All Vehicles at time of service**APPLICABILITY:** MY18 Revero**MARKET REGION:** North America**PURPOSE:** To ensure correct torque on the AC pressure switch.

Inspection of the torque setting (17Nm +/- 1.7) on the Pressure Sensor (C131130202000) should be performed the next time a a vehicle is in for service.

If leaks are found at the sensor, replace with a new sensor and torque the sensor as directed, recharge the AC system as required and claim R&R for the sensor.

**Tool required:**

- 19mm wrench (slim tyle)
- torque wrench
- 24mm crow's foot socket wrench or deep socket

**Overview:**

1. Place vehicle on lift
2. Raise vehicle
3. Locate sensor
4. Use one (mm) wrench to hold firm the hard line
5. Use another wrench to torque the sensor in place to 17Nm +/- 1.7Nm
6. If leaks were present proceed to recharge the system, create a TSS case

Karma Automotive Bulletins and service documents are intended for use by experienced and trained Technicians. If you lack the skills, tools, equipment and a suitable workshop for any procedure described in this document, we suggest you leave such repairs to a Karma retailer and service provider. See your service provider for advice on whether your vehicle may benefit from the information contained within this document. The information contained in the Karma Bulletin is accurate at the date of publication. However, Karma Automotive regularly updates technical information. Please check with your Karma Automotive Retailer and Karma Automotive service provider that the bulletin you intend to use contains the latest available information.

**MODEL: Karma Revero****DATE: October 2018****First Release****TITLE: AC pressure switch inspection**

The pressure switch is located below the power steering pump (fig.1).  
Unbolting this to set it aside is one method of reaching the switch.



fig. 1

It is recommended to access the switch from below as in the image (fig.2).  
the switch is located above the coolant hose.



fig. 2

Karma Automotive Bulletins and service documents are intended for use by experienced and trained Technicians. If you lack the skills, tools, equipment and a suitable workshop for any procedure described in this document, we suggest you leave such repairs to a Karma retailer and service provider. See your service provider for advice on whether your vehicle may benefit from the information contained within this document. The information contained in the Karma Bulletin is accurate at the date of publication. However, Karma Automotive regularly updates technical information. Please check with your Karma Automotive Retailer and Karma Automotive service provider that the bulletin you intend to use contains the latest available information.

**MODEL: Karma Revero****DATE: October 2018****First Release****TITLE: AC pressure switch inspection**

In the image below (fig.3) the switch can be seen without interference. In image below (fig. 3b) the drawing view displays the sensor on the purple colored AC lines. This should help guide you to the next page.

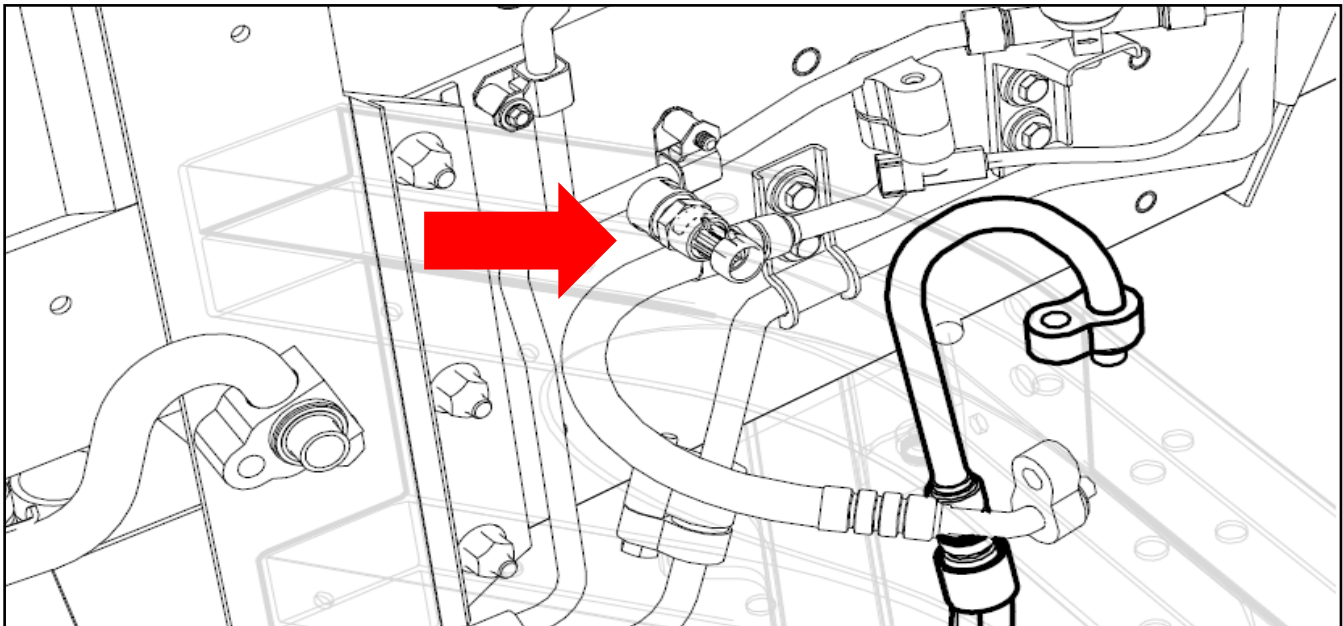

fig. 3a

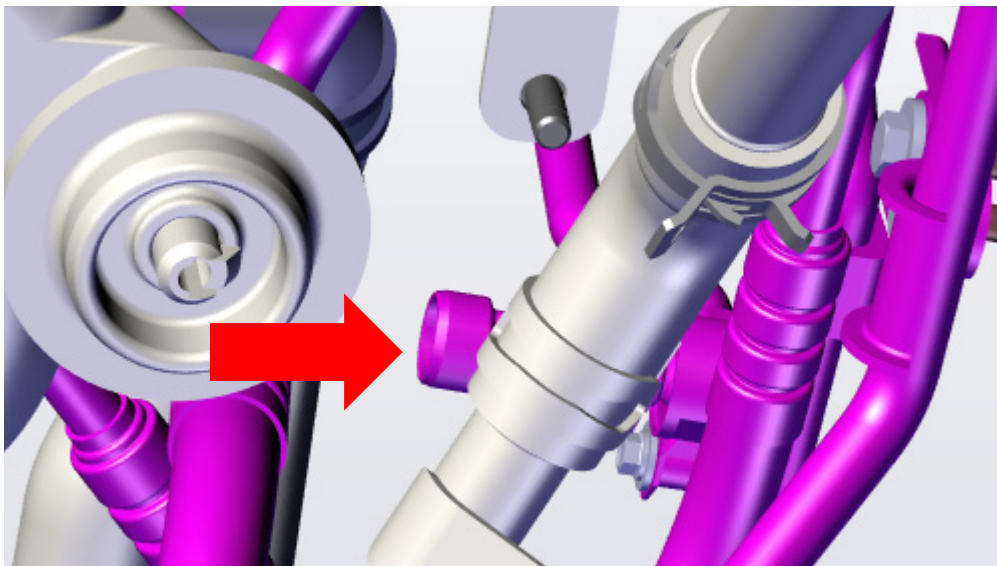

fig. 3b

Karma Automotive Bulletins and service documents are intended for use by experienced and trained Technicians. If you lack the skills, tools, equipment and a suitable workshop for any procedure described in this document, we suggest you leave such repairs to a Karma retailer and service provider. See your service provider for advice on whether your vehicle may benefit from the information contained within this document. The information contained in the Karma Bulletin is accurate at the date of publication. However, Karma Automotive regularly updates technical information. Please check with your Karma Automotive Retailer and Karma Automotive service provider that the bulletin you intend to use contains the latest available information.

**MODEL:** Karma Revero

**DATE:** October 2018

**First Release**

**TITLE:** AC pressure switch inspection

Place one slim 19mm wrench on the AC line side, the slots can be seen in (fig.4). Use this to stabilize the line so as not to tear off the switch mount from the hard line. Disconnect the harness and check the sensor fastening torque, use a 24mm wrench on this side as seen in (fig.5), torque is verified at this location. (17Nm +/-1.7)

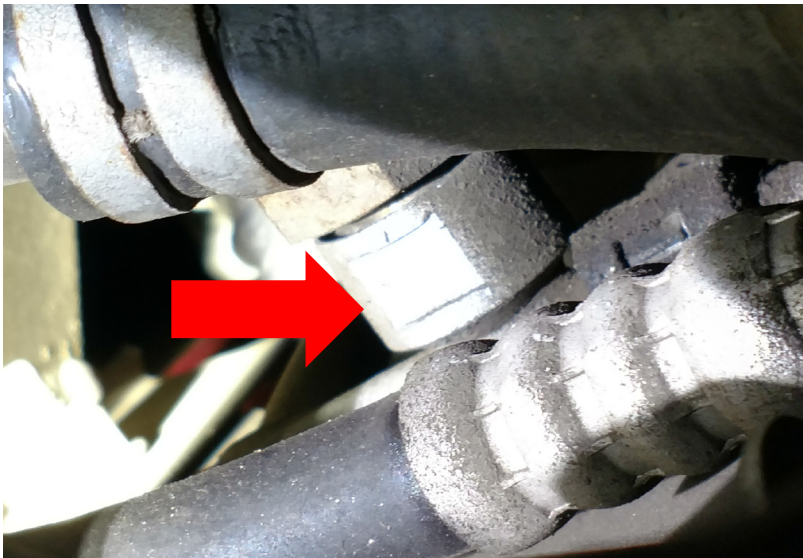

fig.4



fig.5

Not stabilizing the AC line can result in breakage as see below! (fig .6)

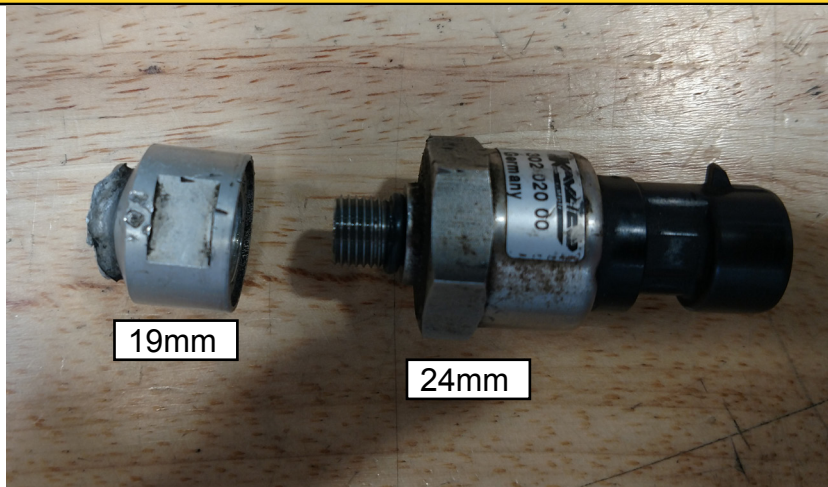

fig.6

Karma Automotive Bulletins and service documents are intended for use by experienced and trained Technicians. If you lack the skills, tools, equipment and a suitable workshop for any procedure described in this document, we suggest you leave such repairs to a Karma retailer and service provider. See your service provider for advice on whether your vehicle may benefit from the information contained within this document. The information contained in the Karma Bulletin is accurate at the date of publication. However, Karma Automotive regularly updates technical information. Please check with your Karma Automotive Retailer and Karma Automotive service provider that the bulletin you intend to use contains the latest available information.



# Technical Service Bulletin

**TB-18-30-02**

**MODEL:** Karma Revero

**DATE:** October 2018

**First Release**

**TITLE:** AC pressure switch inspection

**PARTS IF REQUIRED:**

PART NUMBER	DESCRIPTION	QTY
N/A	N/A	1

**SHOP SUPPLIES:**

PART NUMBER	DESCRIPTION	QTY
N/A	N/A	

**SPECIAL TOOLS:**

DESCRIPTION

**CAUSAL PART:**

PART NUMBER	DESCRIPTION
C131130202000	AC Pressure Sensor (High Pressure)

**LABOR CODES:**

CODE	DESCRIPTION	TIME	DEFECT CODE
30-60-02-05	AC Pressure Sensor Inspection	0.6	30-60-02-64

**SUBLET:**

CODE	DESCRIPTION	AMOUNT
N/A		

**WARRANTY DISPOSITION:** This repair is covered under the New Vehicle Limited Warranty, in effect for five (5) years from the in-service date with no mileage limitation.

Karma Automotive Bulletins and service documents are intended for use by experienced and trained Technicians. If you lack the skills, tools, equipment and a suitable workshop for any procedure described in this document, we suggest you leave such repairs to a Karma retailer and service provider. See your service provider for advice on whether your vehicle may benefit from the information contained within this document. The information contained in the Karma Bulletin is accurate at the date of publication. However, Karma Automotive regularly updates technical information. Please check with your Karma Automotive Retailer and Karma Automotive service provider that the bulletin you intend to use contains the latest available information.