



LAND ROVER

LTB01064NAS2

TECHNICAL BULLETIN

28 AUG 2008

© Jaguar Land Rover North America, LLC

NOTE: The information in Technical Bulletins is intended for use by trained, professional Technicians with the knowledge, tools, and equipment required to do the job properly and safely. It informs these Technicians of conditions that may occur on some vehicles, or provides information that could assist in proper vehicle service. The procedures should not be performed by 'do-it-yourselfers'. If you are not a Retailer, do not assume that a condition described affects your vehicle. Contact an authorized Land Rover service facility to determine whether this bulletin applies to a specific vehicle.

INFORMATION

This reissue replaces all previous versions. Please destroy all previous versions.

SECTION:

205-02

SUBJECT/CONCERN:

Judder From Active On-Demand Coupling

AFFECTED VEHICLE RANGE:

MODEL:	MODEL YEAR:	VIN:	APPLICABILITY:
Discovery Sport (LC)	2016 Onwards	613684 Onwards	Vehicles With: Active On-Demand Coupling

MODEL:	MODEL YEAR:	VIN:	APPLICABILITY:
Range Rover Evoque (LV)	2016-2017	143755-241619	Vehicles With: Active On-Demand Coupling

MARKETS:

NORTH AMERICA

CONDITION SUMMARY:

SITUATION:

A judder from the vehicle at low speeds when steering may be evident.

CAUSE:

This may be caused by water ingress through the Active On-Demand Coupling breather, allowing water to contaminate the oil in the Active On-Demand Coupling.

ACTION:

Should a Customer express this concern, follow the Workshop Procedure below.

PARTS:

PART NUMBER	DESCRIPTION	QUANTITY
LR019450	Valve	1
LR051347	Oil seal kit	1
FB108076	Bolt M8 x 35 mm	9
LR001193	Driveshaft bolt M8 X 45 mm	6
LR054941	Active On-Demand Coupling - Statoil - SL01-301	3

TOOLS:

Refer to Workshop Manual for any required special tools.

WARRANTY:**NOTES:**

- Repair procedures are under constant review, and therefore times are subject to change; those quoted here must be taken as guidance only. Always refer to JLR claims submission system to obtain the latest repair time.
- The JLR Claims Submission System requires the use of causal part numbers. Labor only claims must show the causal part number with a quantity of zero.

DESCRIPTION	SRO	TIME (HOURS)	CONDITION CODE	CAUSAL PART
Active On-Demand Coupling - Clean	44.24.89.44	1.5	49	LR073538

NOTE:

Normal Warranty procedures apply.

WORKSHOP PROCEDURE:

- 1 Raise the vehicle on a ramp (see TOPIx Workshop Manual section 100-02: Jacking and Lifting - Lifting).
- 2 Remove the exhaust system (see TOPIx Workshop Manual section 309-00: Exhaust System - Removal and Installation).

3

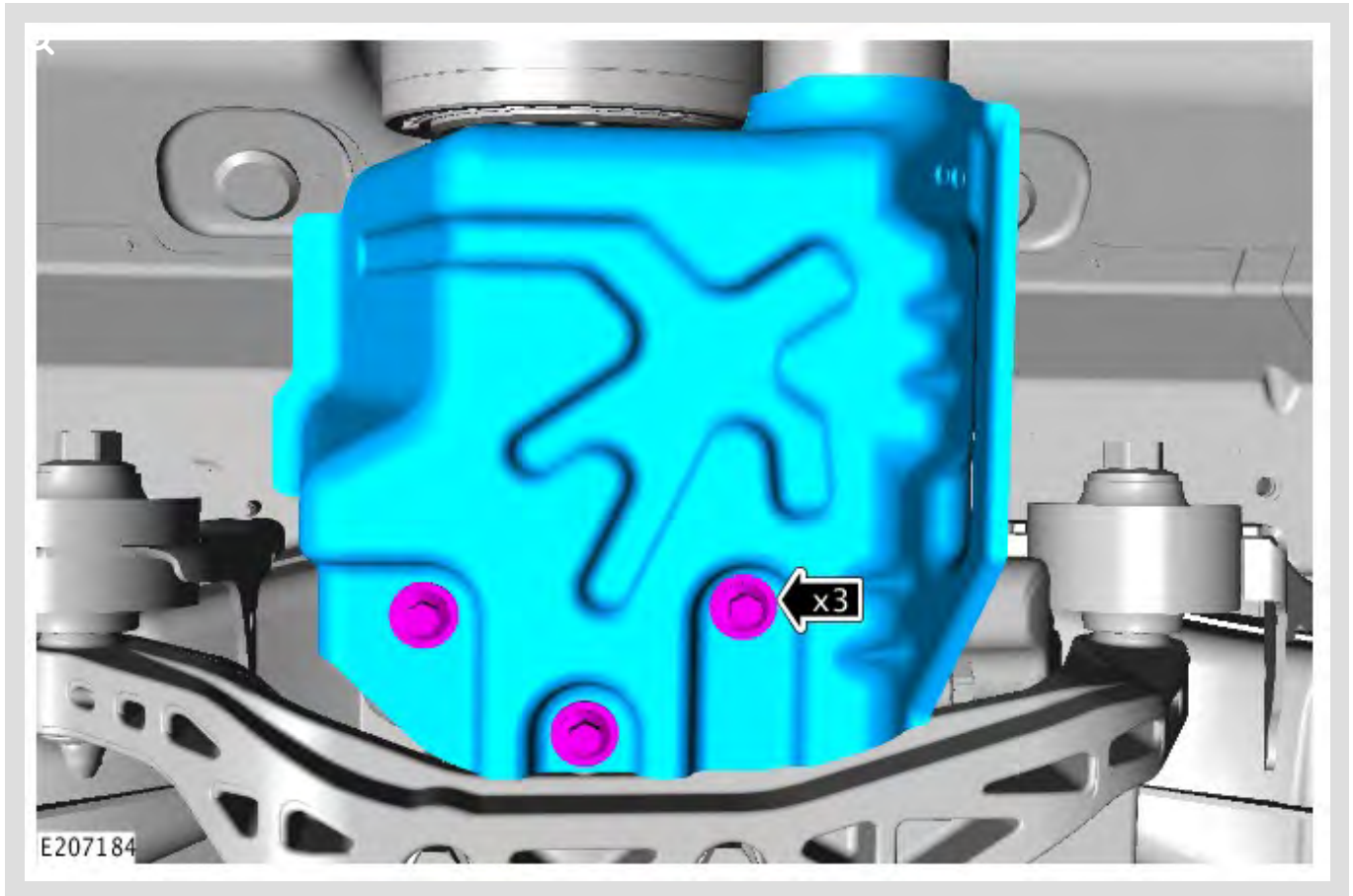

Remove the Rear Drive Unit (RDU) heat shield.

- Torque: **10 Nm**,

4

ⓘ CAUTIONS:

- Mark the position of the driveshaft flange in relation to the drive pinion flange.
- To avoid damage to the joint or gaiter, do not allow the driveshaft to hang.
- Make sure that the driveshaft is supported with suitable retaining straps.

⚠ NOTE:

Discard the bolts.

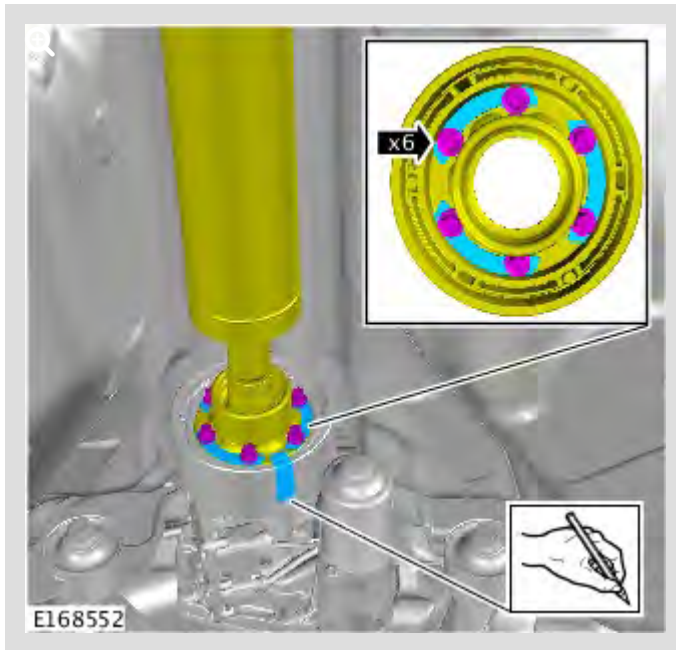

Position the driveshaft to the side.

- Torque: **40 Nm**.

5

△ NOTE:

Do not discard the bolts.

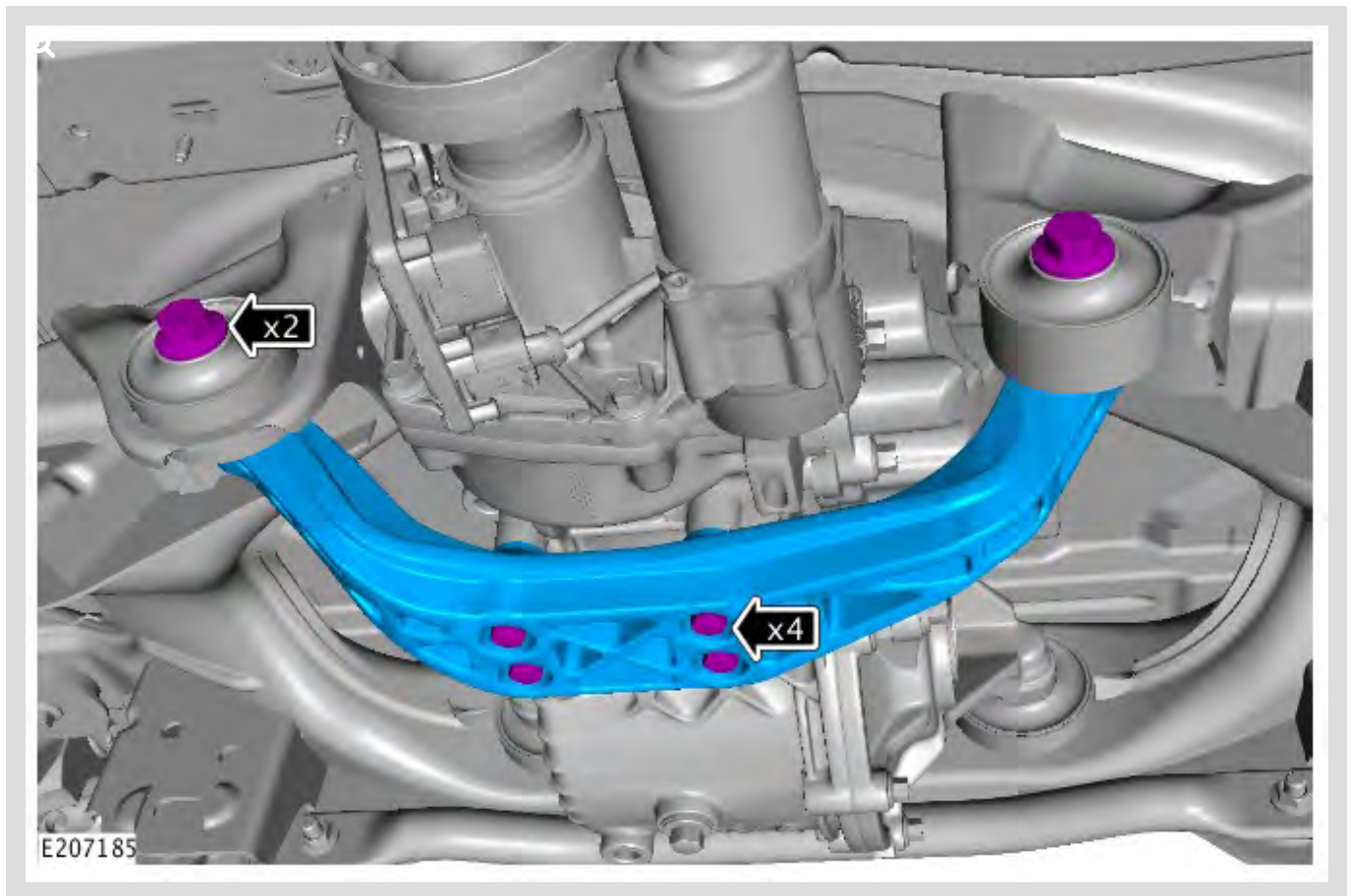

Remove the RDU cross member.

- Torque: **175 Nm [2]**
- Torque: **25 Nm [4]**

6

⚠ WARNING:

Wear eye protection when using compressed air.

△ NOTES:

- Use compressed air to make sure that the breather is clean and free from foreign material.
- Make sure that the area around the component is clean and free of foreign material.

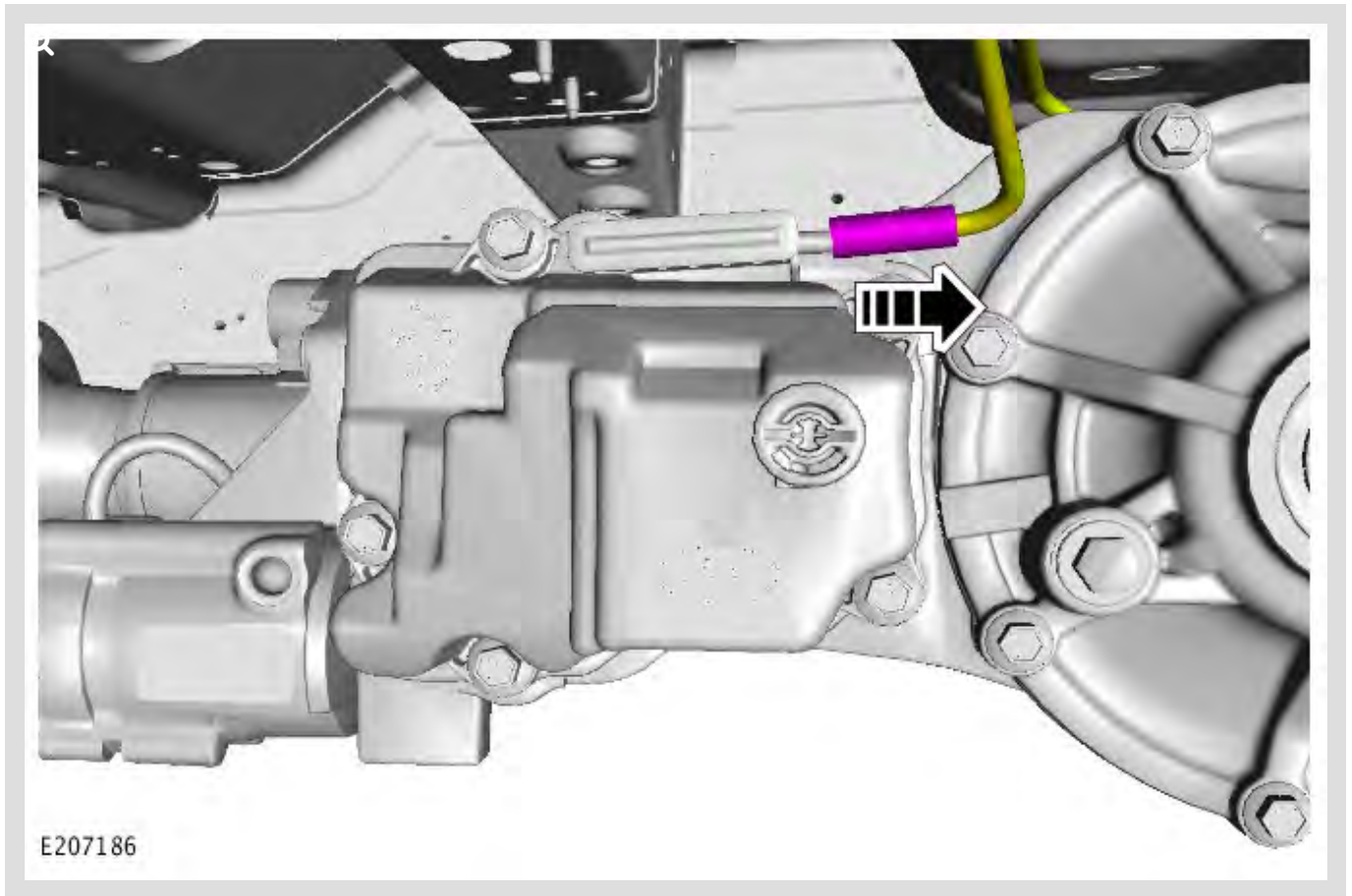

Remove the Active On-Demand Coupling breather pipe.

7

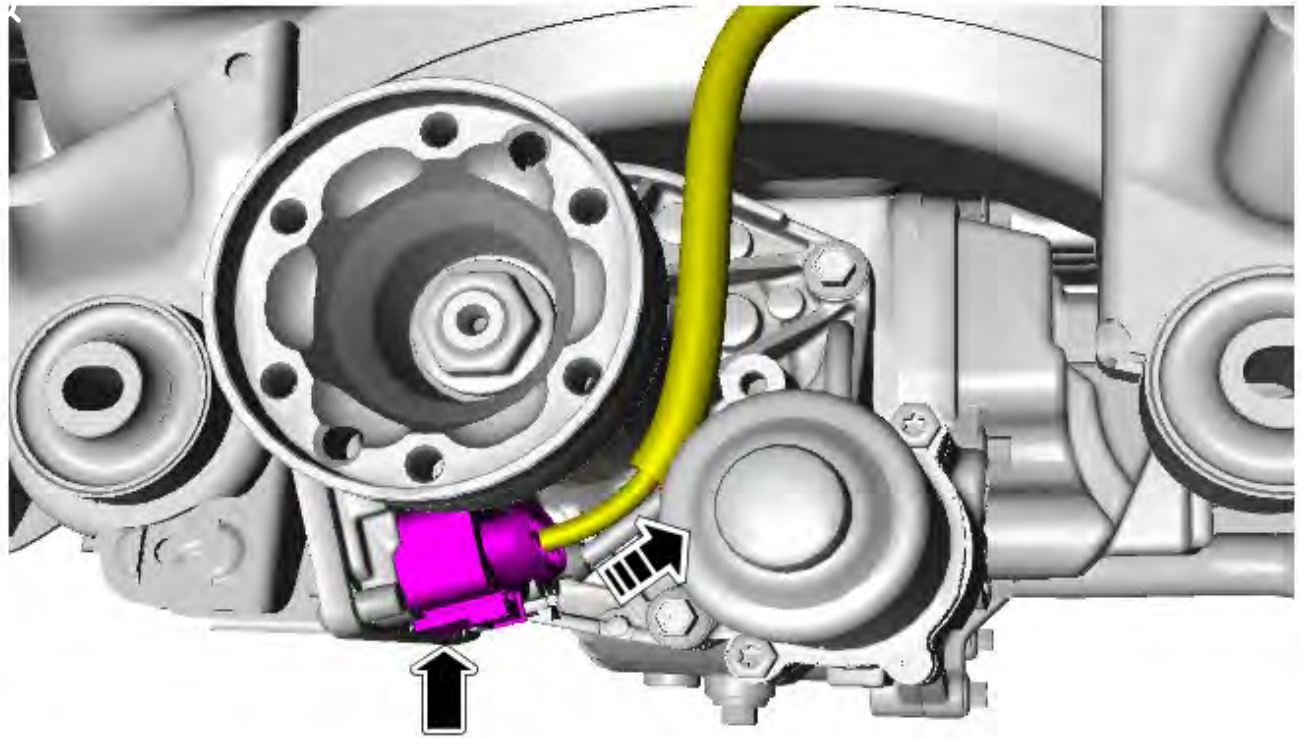

E207187

Disconnect the RDU electrical connector.

8

ⓘ CAUTION:

Be prepared to collect escaping fluids.

⚠ NOTE:

Make sure that the area around the component is clean and free of foreign material.

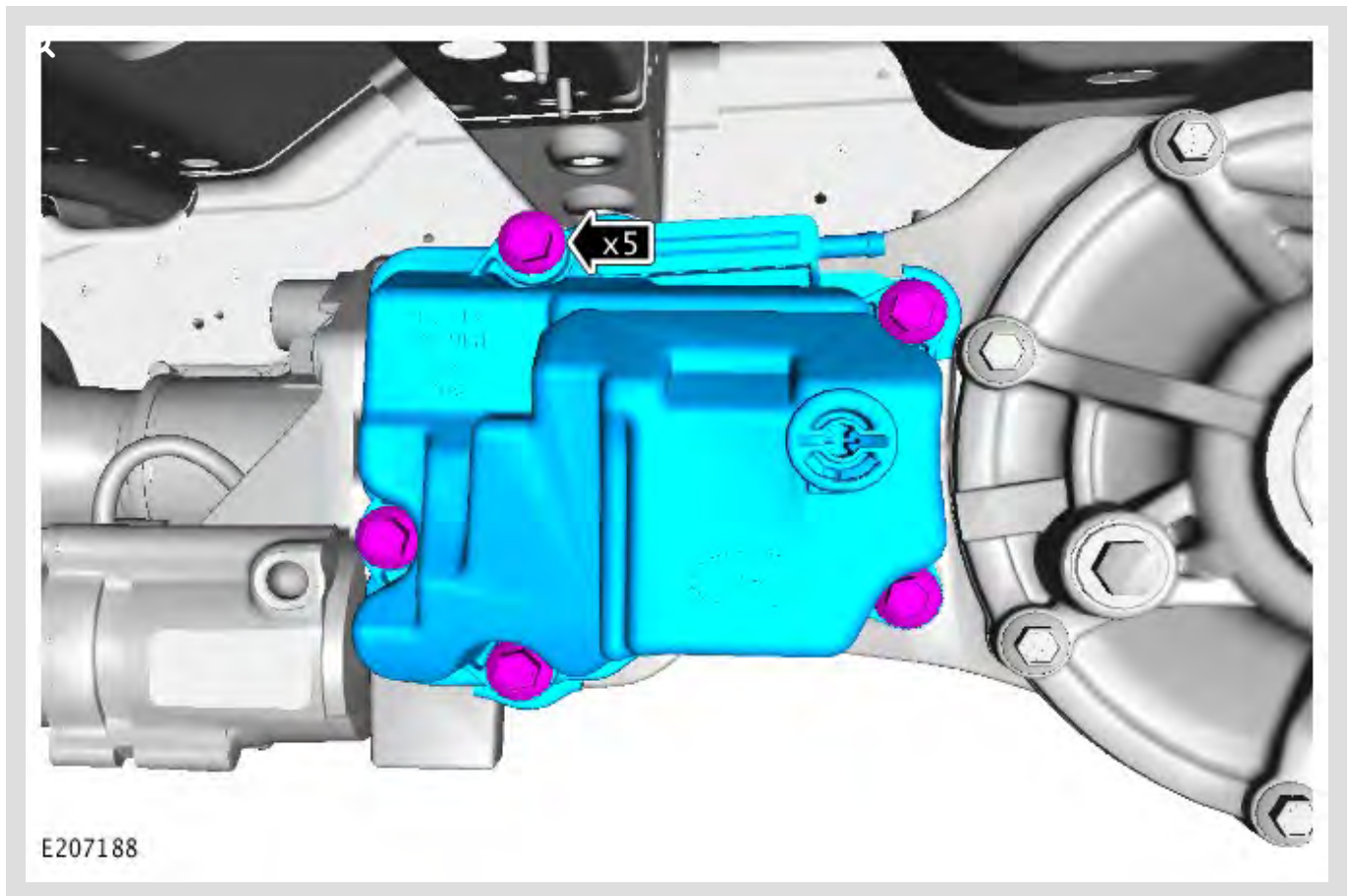

Remove the Active On-Demand Coupling sump.

- Torque: 29 ± 4 Nm.

9

⚠ CAUTION:

Be prepared to collect escaping fluids.

△ NOTE:

Make sure that the area around the component is clean and free of foreign material.

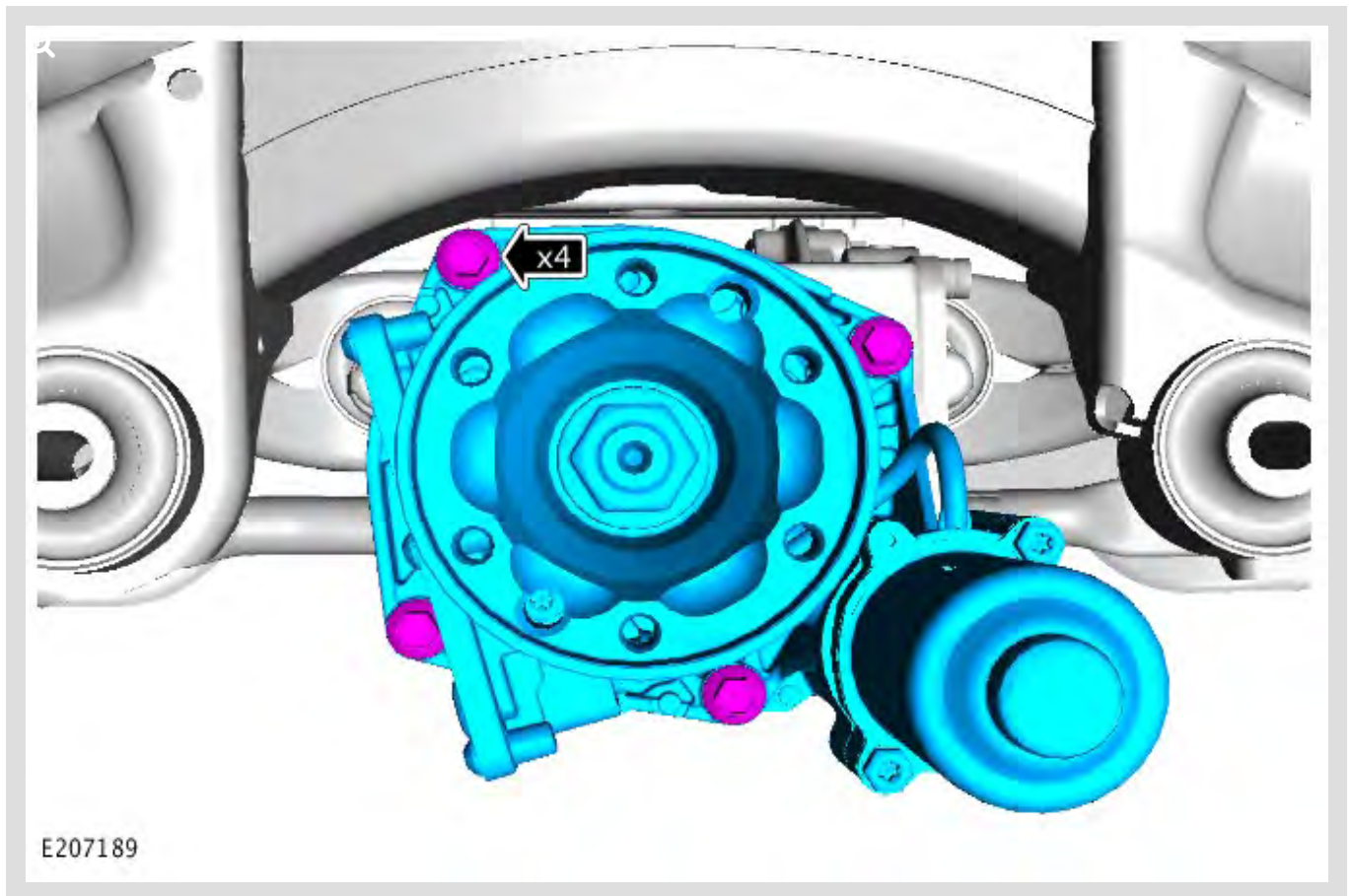

Remove the Active On-Demand Coupling from the RDU.

- Torque: **29 Nm.**

10

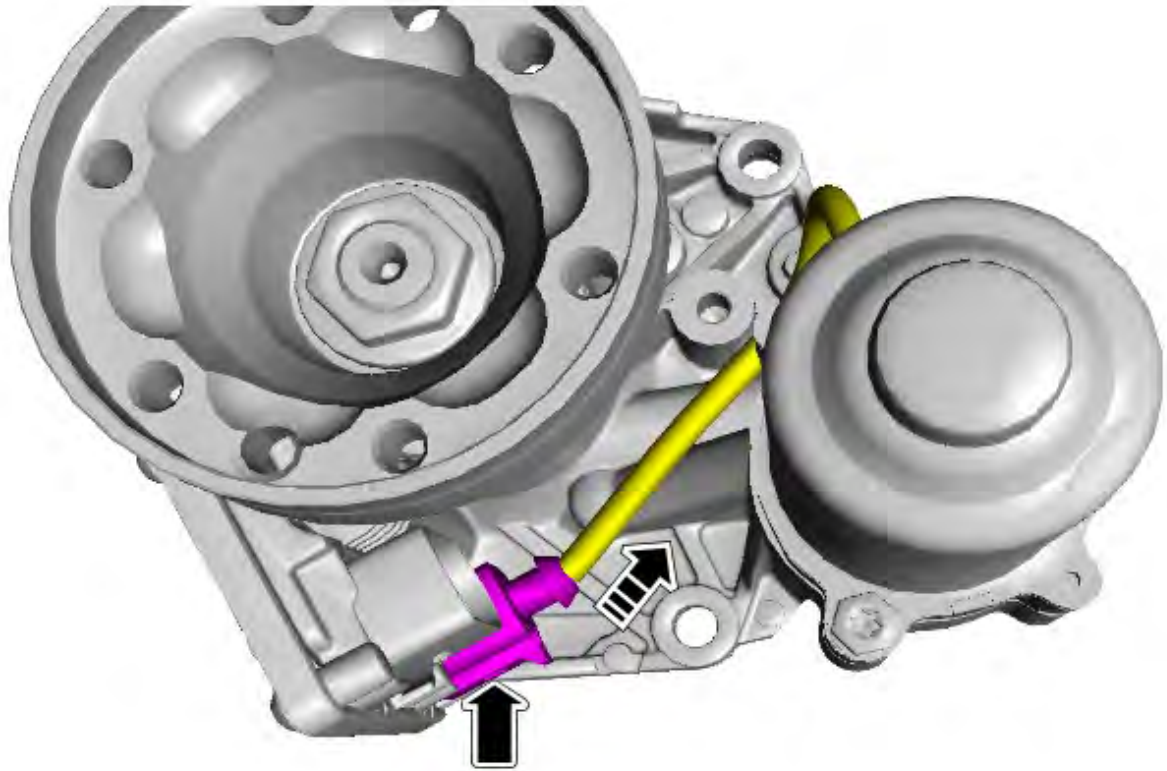

E207190

Disconnect the electrical connector from the Active On-Demand Coupling.

11

△ NOTE:

Make sure that the area around the component is clean and free of foreign material.

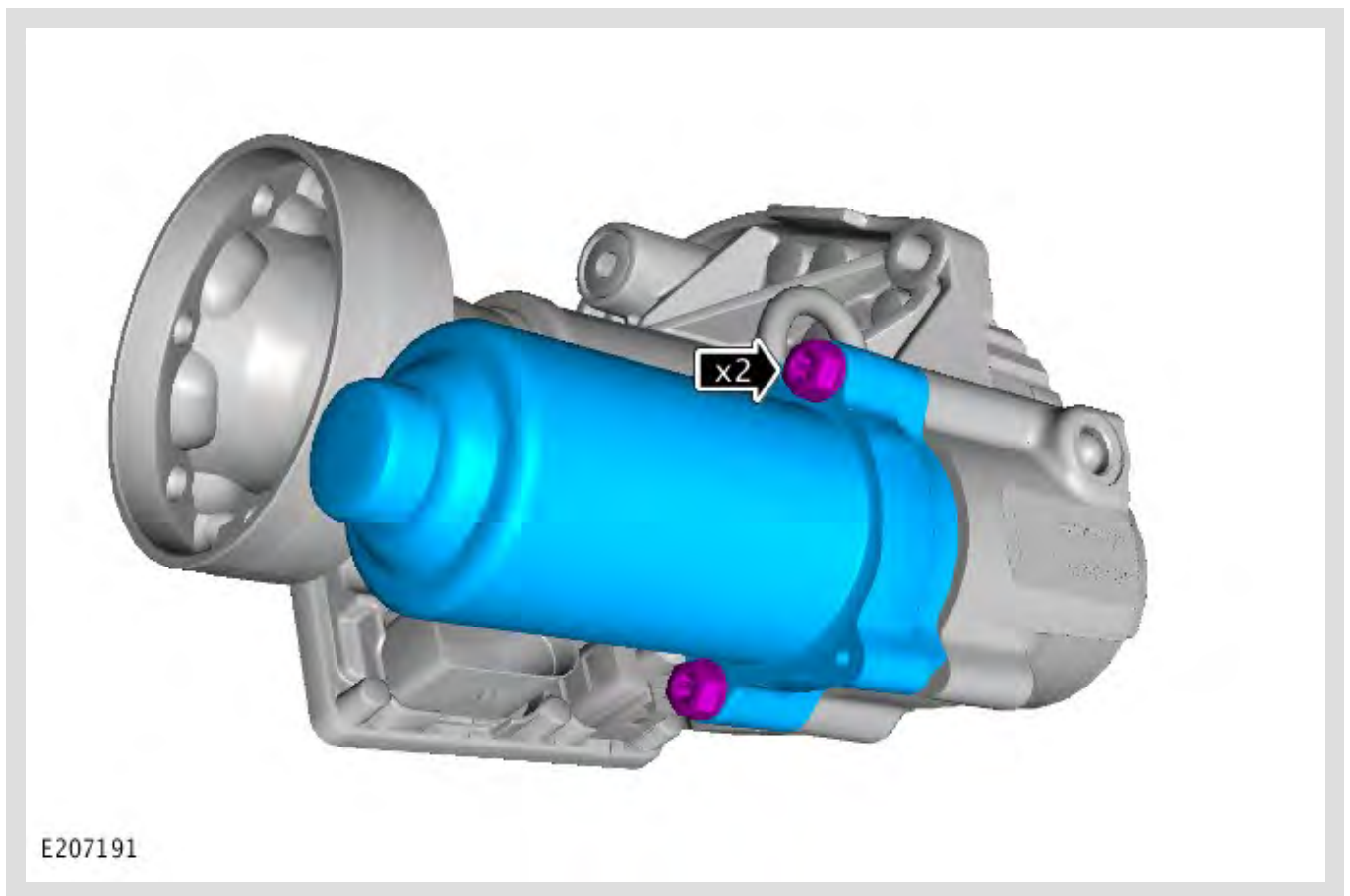

Remove the motor from the Active On-Demand Coupling.

- Torque: **10 Nm.**

12

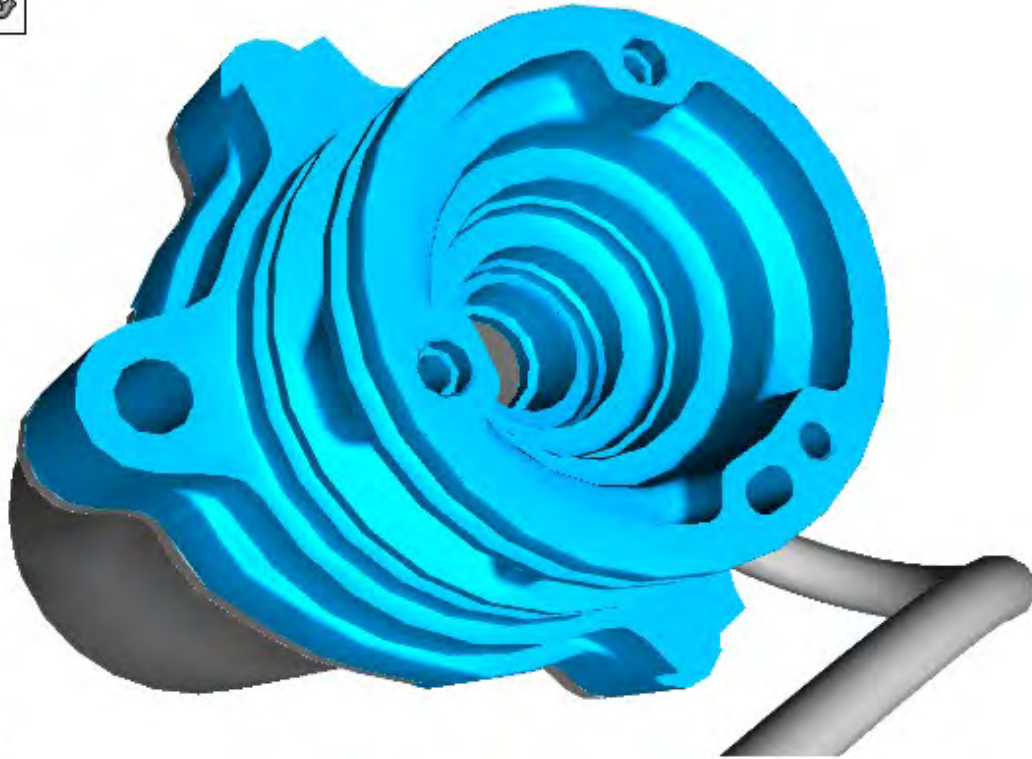

E207821

Use compressed air to make sure that the breather is clean and free from foreign material.

13

△ NOTES:

- Make sure that the area around the component is clean and free of foreign material.
- Use compressed air to blow into each hole to disperse the water between the clutch plates.

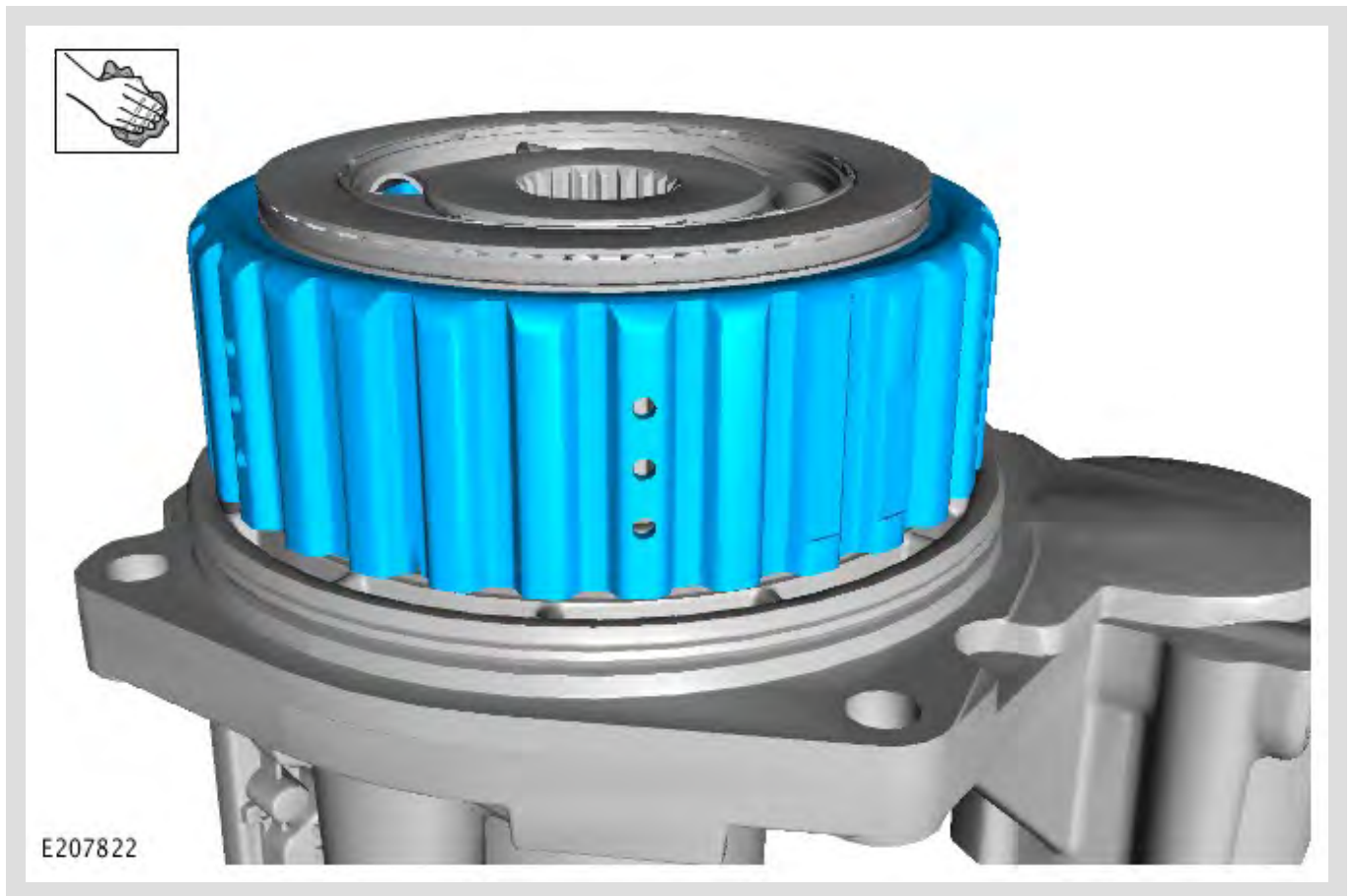

Clean the Active On-Demand Coupling using lint-free cloths and compressed air.

14

△ NOTES:

- Make sure that the area around the component is clean and free of foreign material.
- Lower the RDU until it can not be lowered any further.

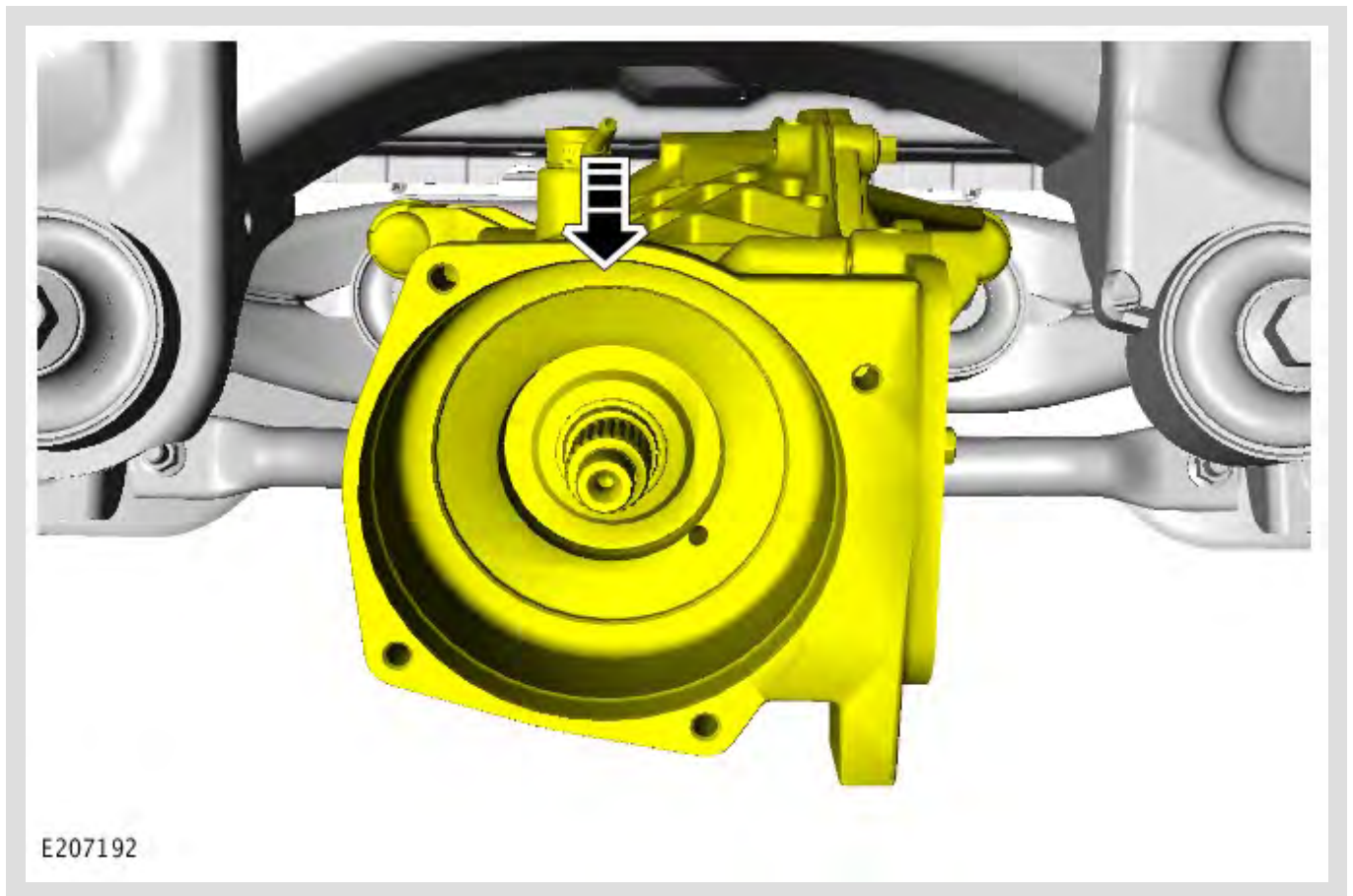

Lower the RDU to make sure all the RDU fluid is drained from the RDU.

15

△ NOTES:

- Make sure that the area around the component is clean and free of foreign material.
- Make sure to clean the oil ways in the RDU.

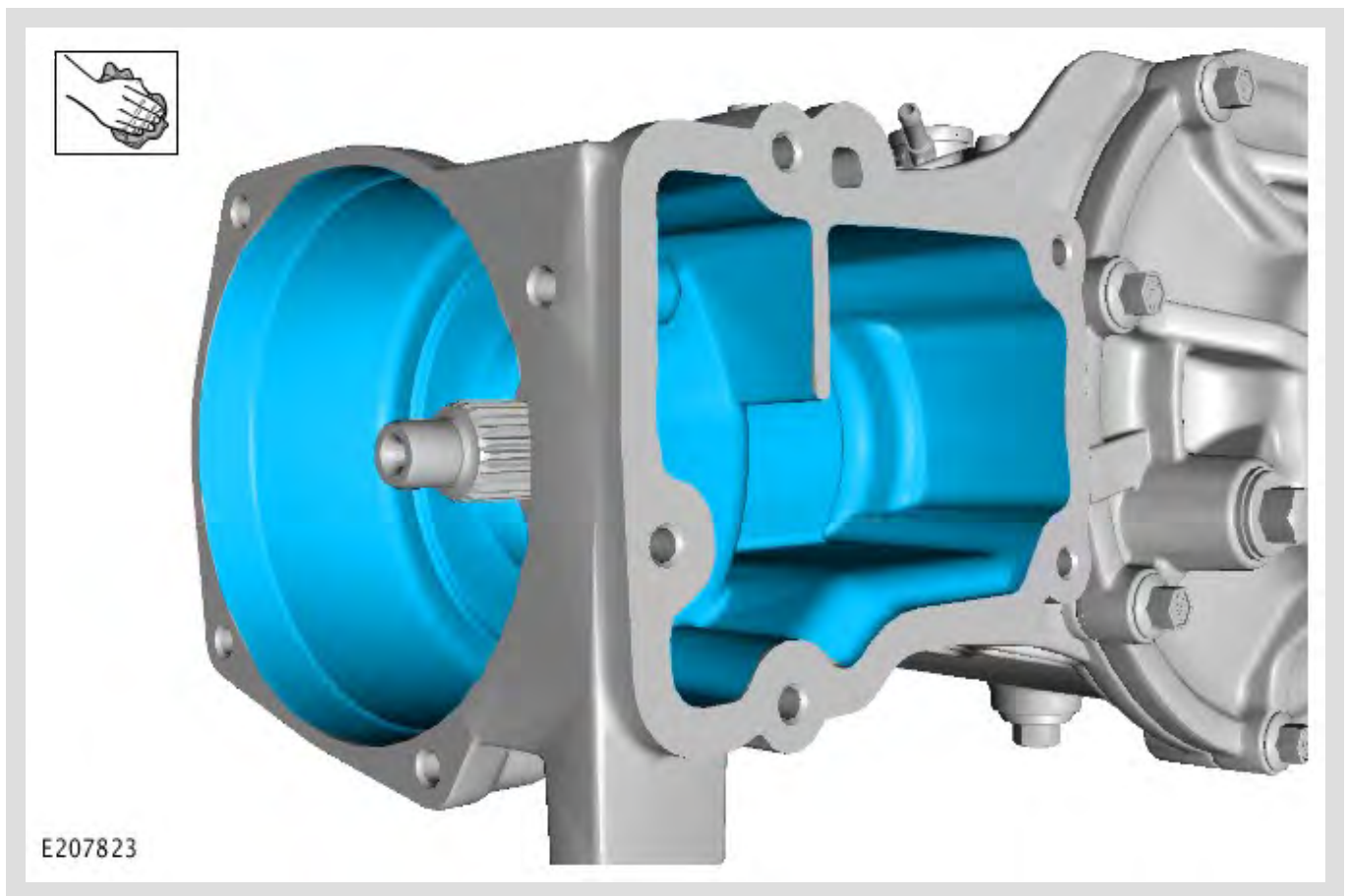

Clean the RDU in the areas shown using lint-free cloth and compressed air.

16

△ NOTE:

Make sure that all oil ways, breathers and components are clean and free from foreign material before installation.

To install, reverse the removal steps.

17

△ NOTE:

Make sure that the area around the component is clean and free of foreign material.

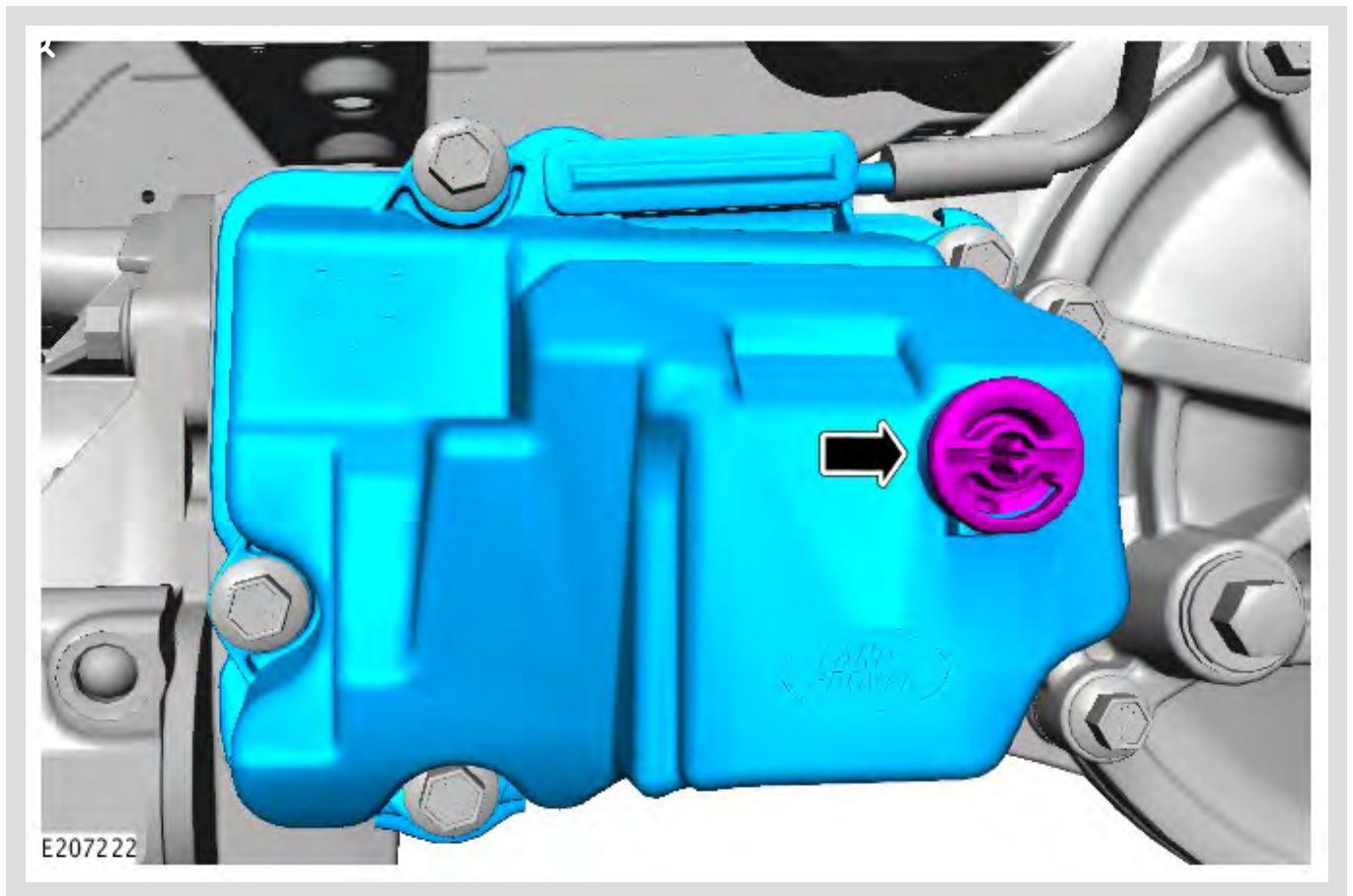

Remove the Active On-Demand Coupling sump fill plug.

18

△ NOTE:

Make sure that the area around the component is clean and free of foreign material.

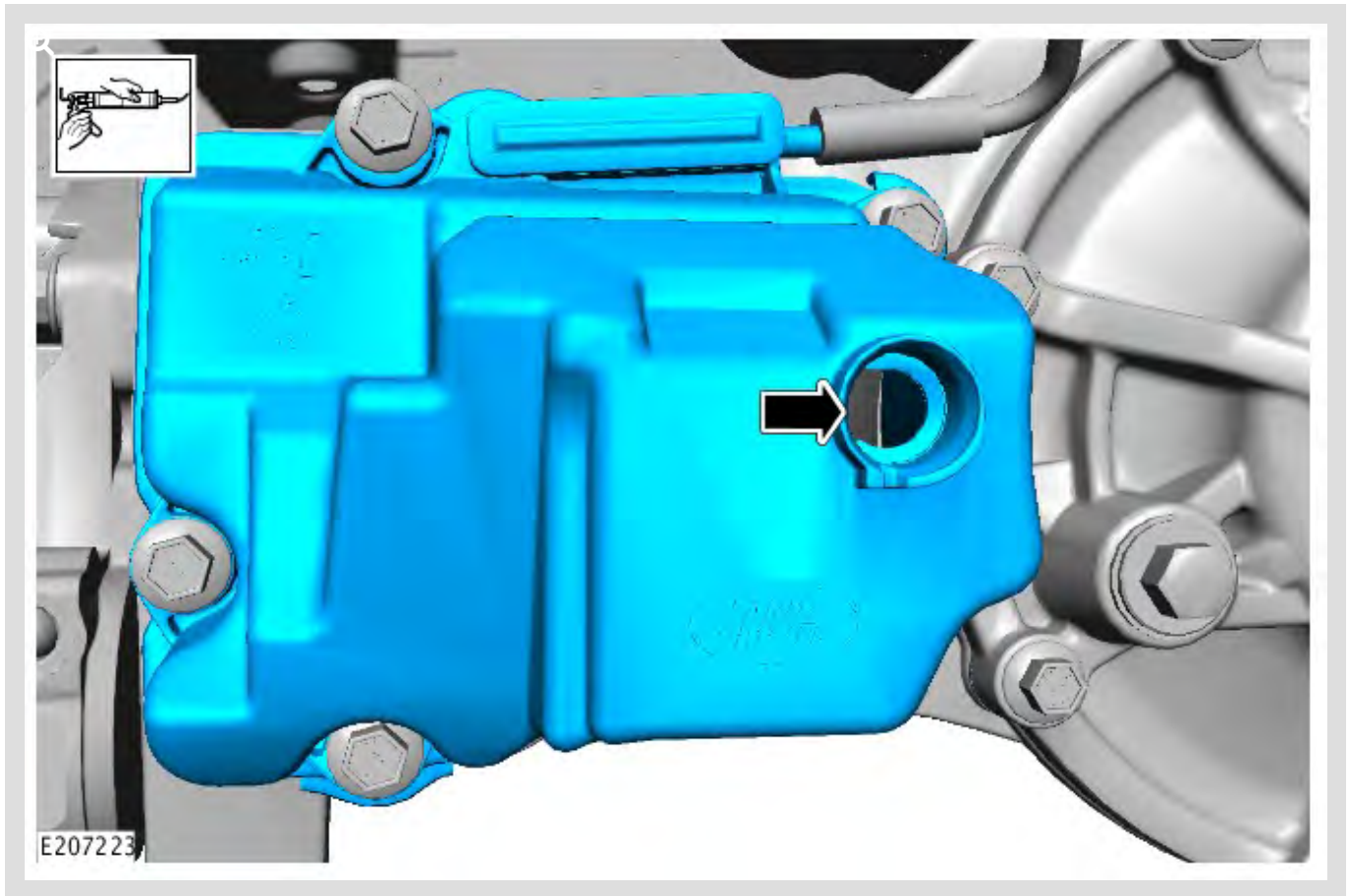

Fill the Active On-Demand Coupling sump.

- Capacity: **780 ml.**

19

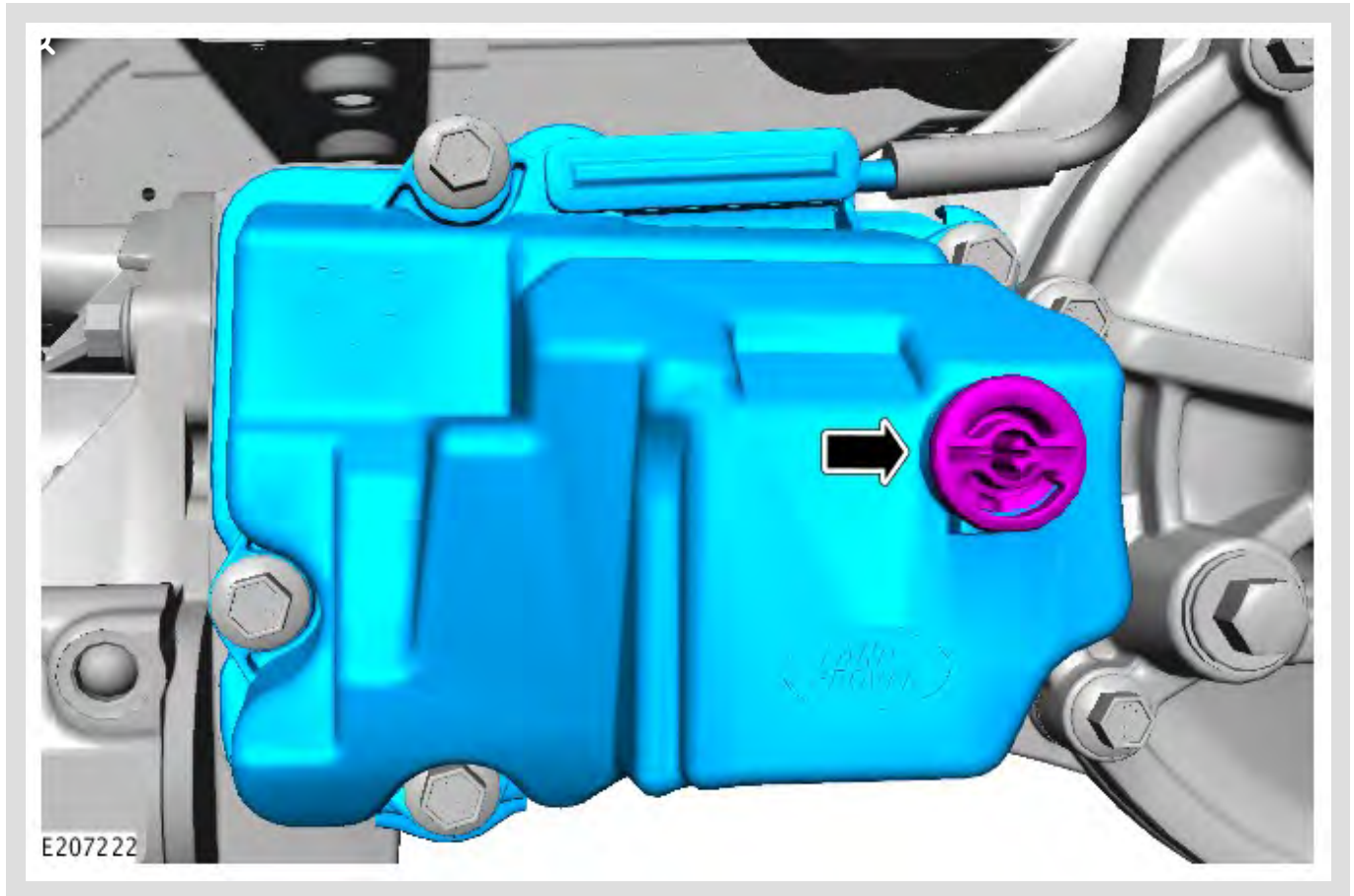

Install the Active On-Demand Coupling sump fill plug.

- Torque: **12 Nm**.

20 Remove the rear left fender splash shield (see TOPIx Workshop Manual section 501-08: Exterior Trim and Ornamentation - Rear Fender Splash Shield).

21

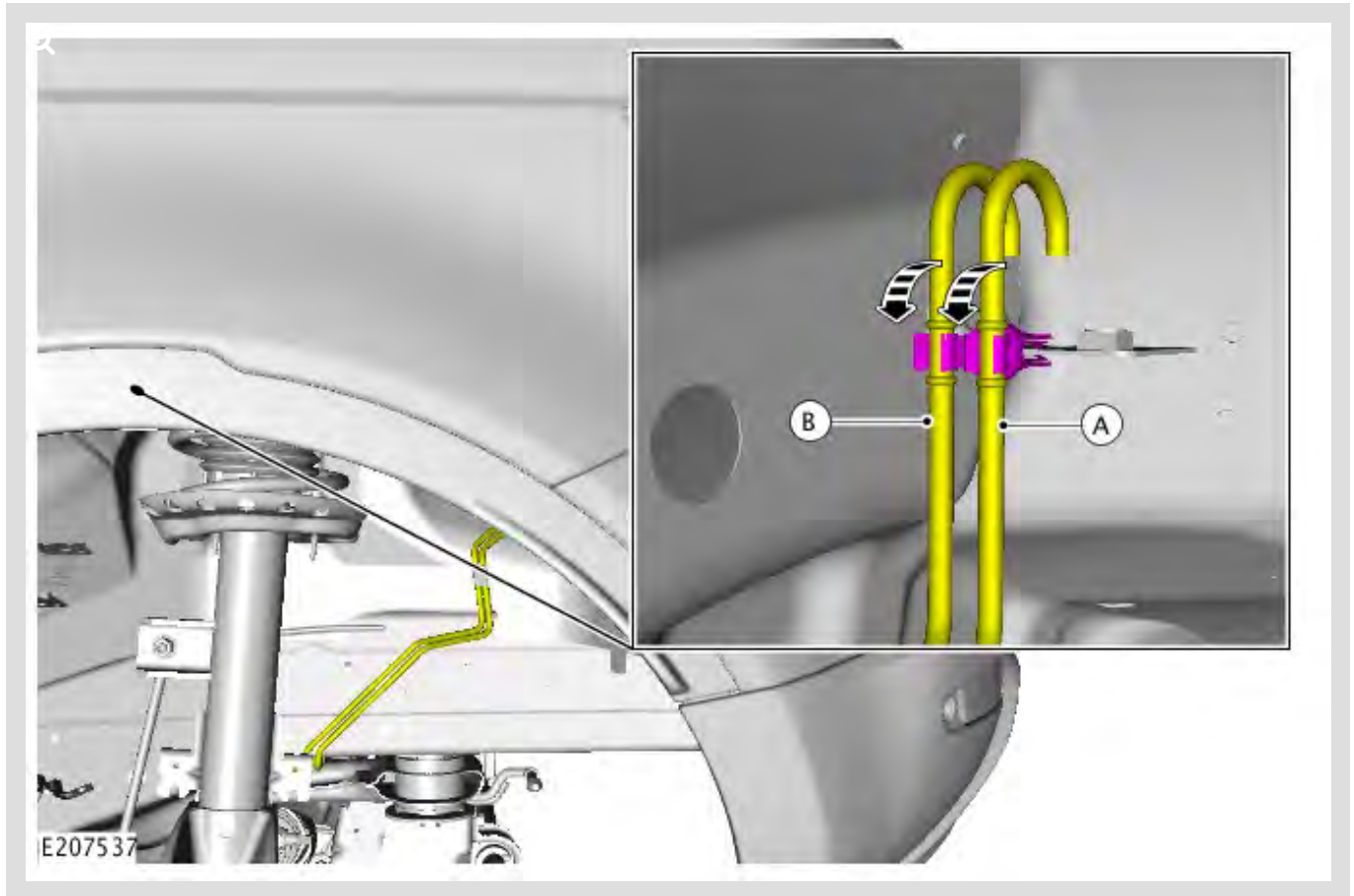

Disconnect the breathers from the retaining clips and position to one side.

22

 **NOTE:**

Discard the removed part of the breather.

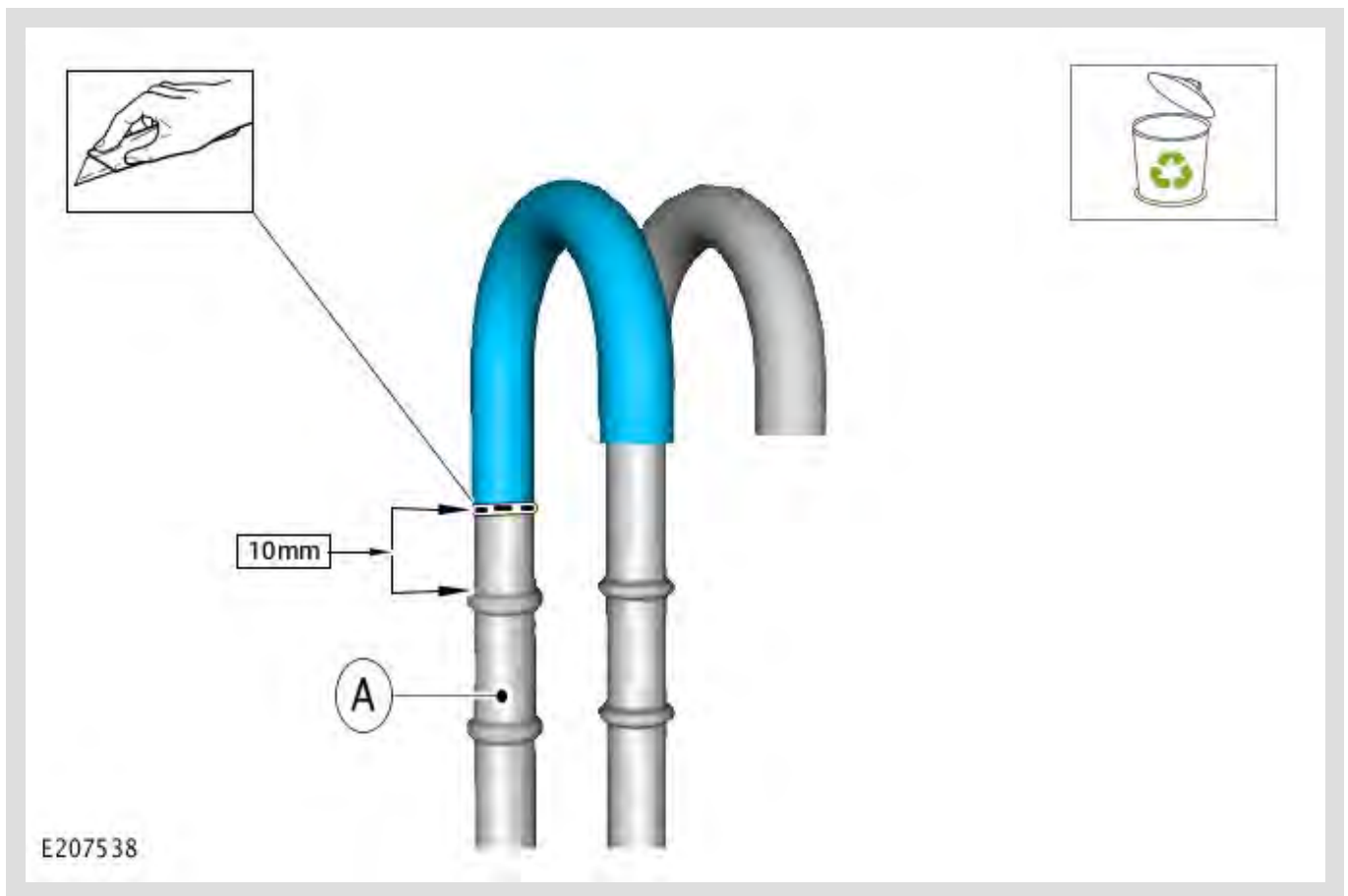

Mark the breather pipe (A) 10mm in the position shown.

- 1 Cut the breather (A) using a sharp knife in the area shown.

23

NOTE:

Make sure the new breather canister hose is installed to its maximum position.

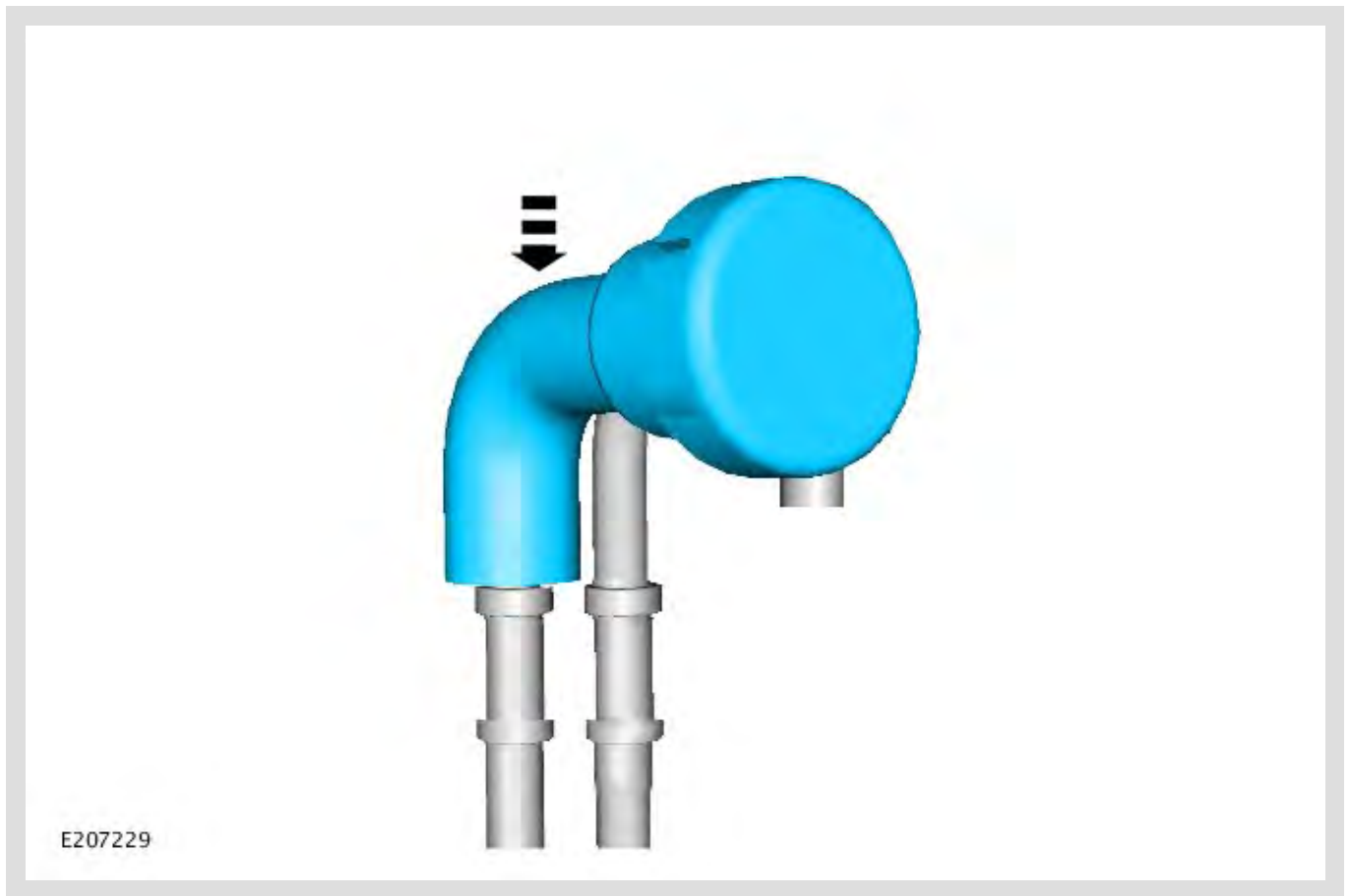

Install the new breather canister as shown.

-
- 24 Position the breather pipes and connect to the retaining clips.
-
- 25 Install the rear left fender inner splash shield (see TOPIx Workshop Manual section 501-08: Exterior Trim and Ornamentation - Rear Fender Splash Shield).