

# 2019 LC500/LC500h Pre-Delivery Service (PDS)

**Service Category** General

**Section** Pre-Delivery Service

**Market** USA



## Applicability

YEAR(S)	MODEL(S)	ADDITIONAL INFORMATION
2019	LC500, LC500H	

## Introduction

This bulletin contains the vehicle specific pre-delivery services for 2019 model year LC500 and LC500h vehicles. Additionally, refer to the applicable Pre-Delivery Service (PDS) Check Sheet for services to be performed.

## Warranty Information

OP CODE	DESCRIPTION	TIME	OFF	T1	T2
N/A	Not Applicable to Warranty	-	-	-	-

## Procedures

- Front License Plate and Mounting Bracket Installation ..... 2
- D/C Cut Fuse Installation ..... 4
- Front and Rear Emergency Towing Eyelet Removal ..... 6
- Front and Rear Emergency Towing Eyelet Hole Cover Installation ..... 7
- Front Wheel Opening Extension Pad Installation ..... 8
- Initialization of Parking Assist Monitor System ..... 9

## 2019 LC500/LC500h Pre-Delivery Service (PDS)

### Front License Plate and Mounting Bracket Installation

The front license plate mounting bracket and two self-tapping screws for the 2019 model year LC500 and LC500h are stored in the luggage compartment. Install the license plate and mounting bracket during PDS according to the following procedure.

1. Locate the front license plate mounting bracket over the radiator grille.
2. Align holes "A" of the mounting bracket with the dimples on the front bumper cover. Mark the location of holes "B" on the front bumper cover.

**NOTICE**

**Do NOT drill into the dimples on the front bumper cover.**

**NOTE**

- Holes "A" are used to install the mounting bracket onto the radiator grille.
- Holes "B" are used to install the front license plate onto the mounting bracket.

3. Screw the two self-tapping screws directly into the dimples to install the front license plate mounting bracket.

**NOTICE**

**Do NOT overtighten the self-tapping screws.**

**Figure 1.**

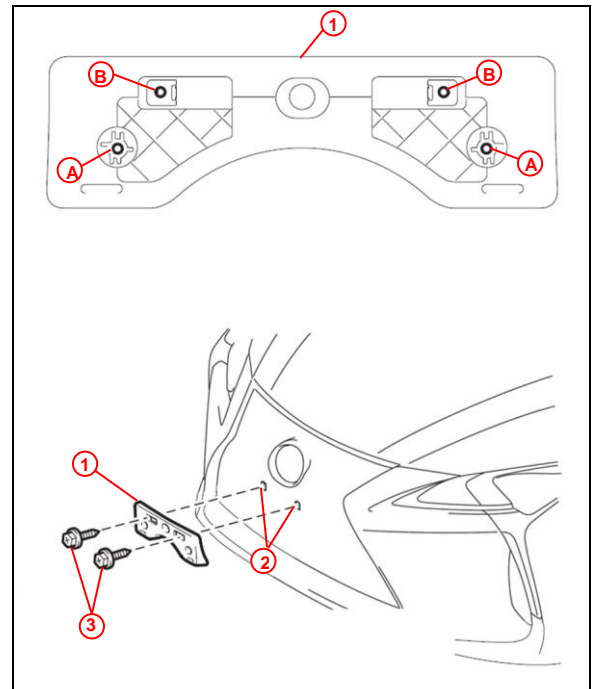

1	Mounting Bracket
2	Dimple
3	Self-Tapping Screw

## 2019 LC500/LC500h Pre-Delivery Service (PDS)

### Front License Plate and Mounting Bracket Installation (continued)

4. Install the front license plate onto the mounting bracket using the two bolts.

**Figure 2.**

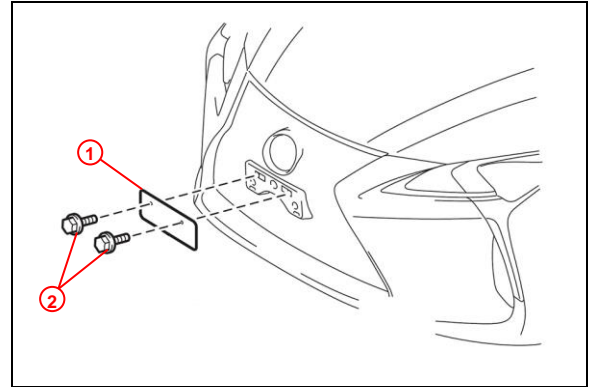

<b>1</b>	<b>Front License Plate</b>
<b>2</b>	<b>Bolt</b>

5. Use bolts of noncorroding type with the following size for installation of the front license plate.

**Nominal Length: 15.0 mm (0.59 in.)**

**Diameter: 6.0 mm (0.24 in.)**

**Figure 3.**

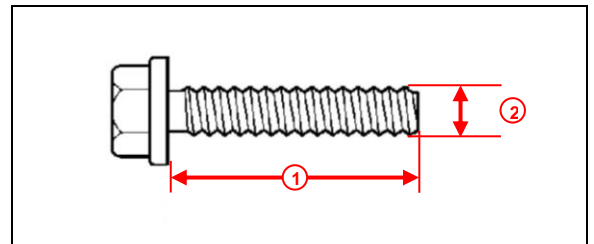

<b>1</b>	<b>Nominal Length</b>
<b>2</b>	<b>Diameter</b>

## 2019 LC500/LC500h Pre-Delivery Service (PDS)

### D/C Cut Fuse Installation

To minimize battery discharge during transportation and storage, the D/C cut fuses (30A) have been removed at the assembly plant and temporarily stored in the blank spaces of the relay block in the engine compartment.

During PDS, remove the D/C cut fuses (30A) from the blank spaces of the relay block in the engine compartment and install them in the locations shown.

**Figure 4. Hybrid Models**

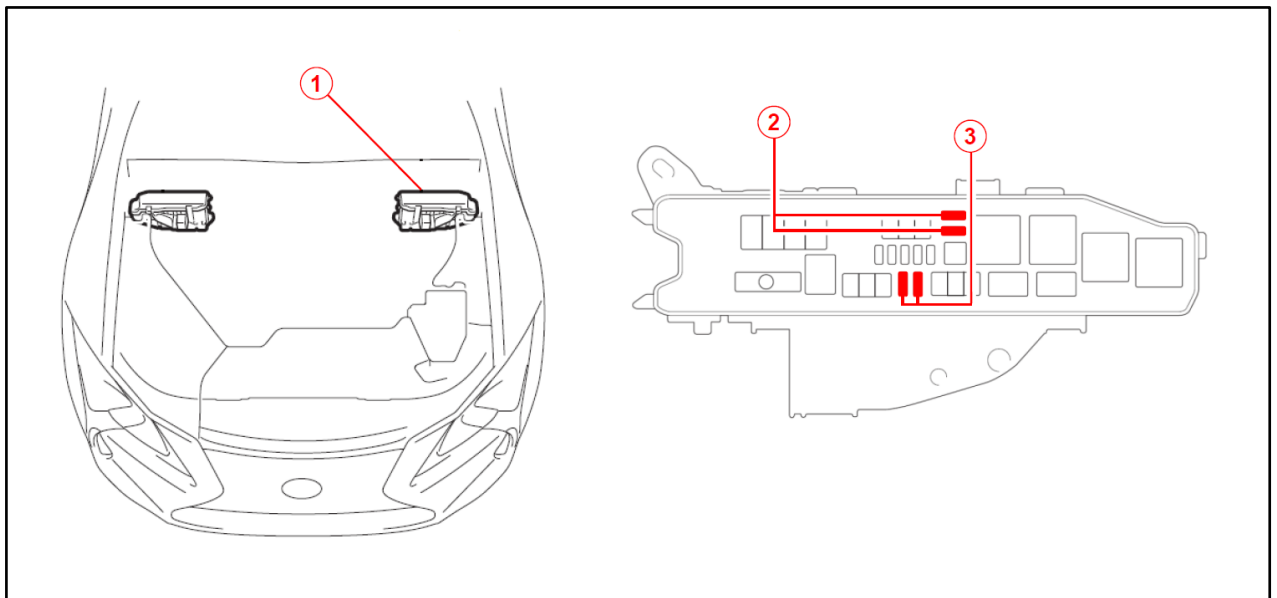

<b>1</b>	<b>Relay Block</b>
<b>2</b>	<b>Remove These D/C Cut (30A) Fuses</b>

<b>3</b>	<b>Install D/C Cut Fuses (30A) Here (Original Location)</b>
----------	---

## 2019 LC500/LC500h Pre-Delivery Service (PDS)

### D/C Cut Fuse Installation (continued)

Figure 5. Gasoline Models

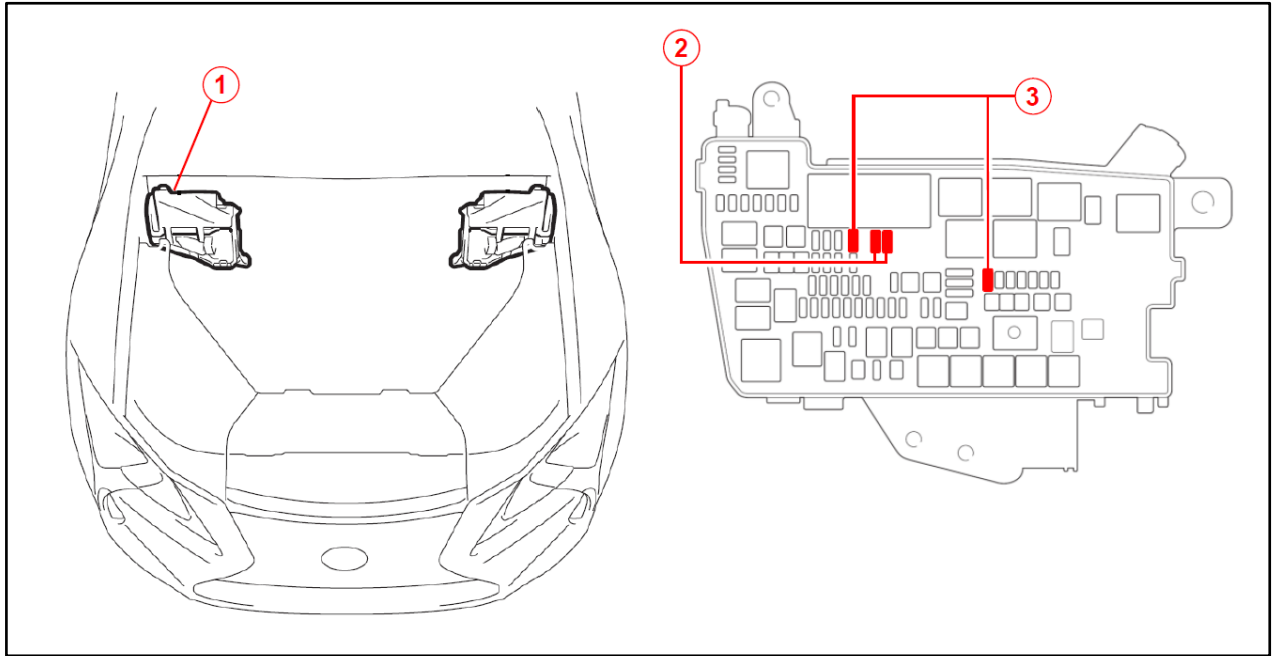

<b>1</b>	<b>Relay Block</b>
<b>2</b>	<b>Remove These D/C Cut (30A) Fuses</b>

<b>3</b>	<b>Install D/C Cut Fuses (30A) Here (Original Location)</b>
----------	---

**NOTE**

While the vehicle is stored at the dealership, disconnect the negative (-) battery terminal to prevent battery discharge. Refer to Service Bulletin No. [L-SB-0108-17](#), *Battery Maintenance During PDS*.

## 2019 LC500/LC500h Pre-Delivery Service (PDS)

### Front and Rear Emergency Towing Eyelet Removal

1. Remove the front and rear emergency towing eyelets from the front and rear bumpers by turning them counterclockwise.

**HINT**

If it is difficult to loosen the front emergency towing eyelet, use a steel bar.

**Figure 6.**

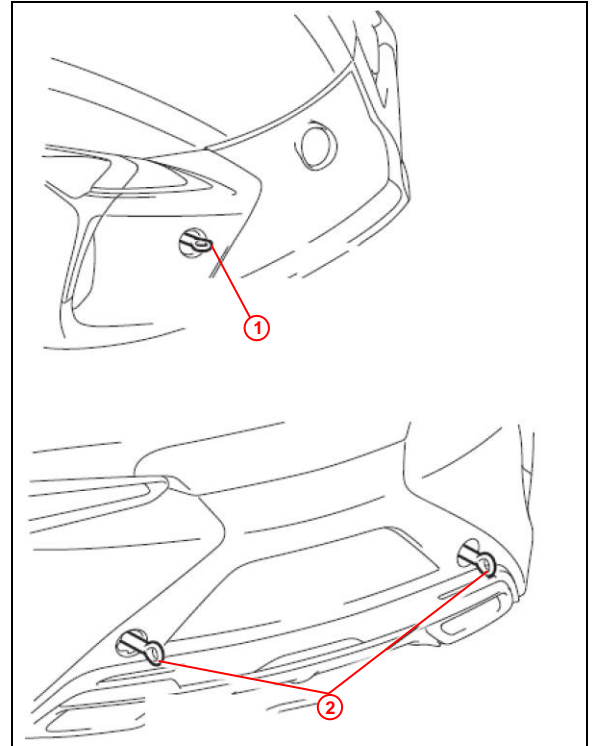

<b>1</b>	<b>Front Emergency Towing Eyelet</b>
<b>2</b>	<b>Rear Emergency Towing Eyelet</b>

2. Place one of the removed emergency towing eyelets into the luggage tray in the luggage compartment.

**HINT**

Dispose of the other removed emergency towing eyelets.

**Figure 7.**

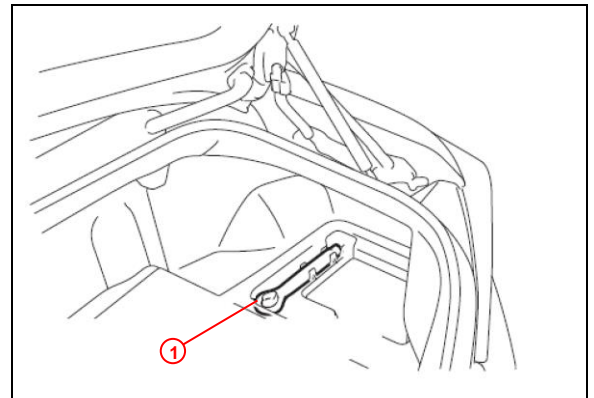

<b>1</b>	<b>Emergency Towing Eyelet</b>
----------	--------------------------------

## 2019 LC500/LC500h Pre-Delivery Service (PDS)

### Front and Rear Emergency Towing Eyelet Hole Cover Installation

1. Install the front and rear emergency towing eyelet hole covers, which are stored in the glove compartment, onto the front and rear bumpers.
  - A. Insert the arrow-shaped part of the emergency towing eyelet hole cover "A" into the eyelet hole "B" as shown.
  - B. Install the emergency towing eyelet hole cover to the hole of the bumper.

**HINT**

Make sure the front emergency towing eyelet hole cover is installed in the front, and the rear emergency towing eyelet hole cover is installed in the rear.

**Figure 8.**

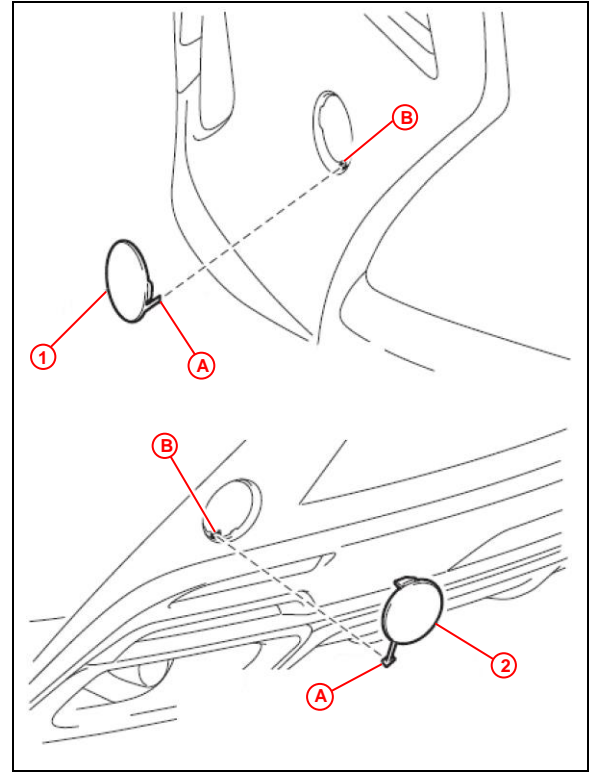

<b>A</b>	<b>Arrow-Shaped Part</b>
<b>B</b>	<b>Eyelet Hole</b>
<b>1</b>	<b>Front Emergency Towing Eyelet Hole Cover</b>
<b>2</b>	<b>Rear Emergency Towing Eyelet Hole Cover</b>

## 2019 LC500/LC500h Pre-Delivery Service (PDS)

### Front Wheel Opening Extension Pad Installation

The front wheel opening extension pad set (right and left front wheel opening extension pads and four self-tapping screws) is placed in the luggage compartment at the assembly plant to avoid damage in transit.

**NOTE**

Use the same procedure for the RH side and LH side. The procedure listed below is for the LH side. There is a distinguishable mark on each pad indicating the left and right side pads.

Place the left front wheel opening extension pad on the installation position and tighten the four self-tapping screws.

**Figure 9.**

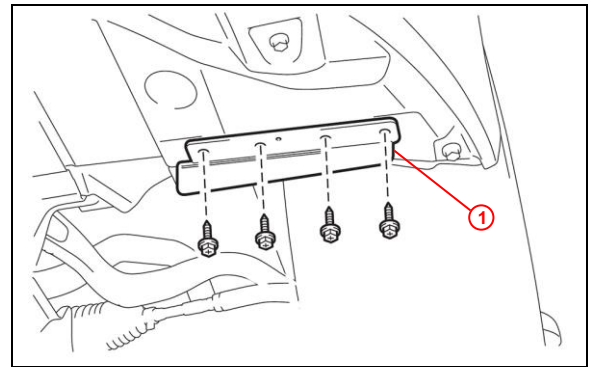

<b>1</b>	<b>Front Wheel Opening Extension Pad</b>
----------	--



## 2019 LC500/LC500h Pre-Delivery Service (PDS)

### Initialization of Parking Assist Monitor System

The Parking Assist Monitor System aids the driver by displaying an image of the area behind the vehicle while in Reverse.

When the D/C cut fuses are removed or the battery terminal is disconnected, the power source to the steering angle sensor is cut OFF. When the D/C cut fuses are re-installed or the battery terminal is reconnected, the rear view monitor will operate, but the steering angle sensor center position **MUST** be set through system initialization **BEFORE** the park assist will become operational.

Initialize the Parking Assist Monitor System **AFTER** installing the D/C cut fuses during PDS.

**NOTE**

Anytime the battery terminal has been disconnected, the Parking Assist Monitor System **MUST** be initialized.

1. Start the engine (Hybrid System "READY").
2. Apply the parking brake.
3. Check if the Parking Assist Monitor System is operative by moving the shift lever to the "R" position. Check to see if the "Estimated course line" is shown.

**NOTE**

If the "Estimated course line" is shown, then initialization is complete.

**Figure 10. Guide Line Display**

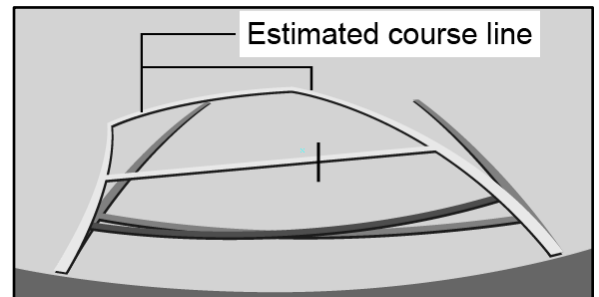

4. Move the shift lever to the "P" position and turn the steering wheel lock to lock.
5. Move the shift lever to the "R" position.  
When "Estimated course line" appears on the rear view monitor as shown, the initialization of the Parking Assist Monitor System has completed.