

Technical Service Bulletin

Mazda North American Operations
Irvine, CA 92618-2922



Subject: FRONT BRAKE SQUEAK DURING LIGHT BRAKING	Bulletin No.: 04-006/18
	Last Issued: 07/30/2018

APPLICABLE MODEL(S)/VINS

2016-2018 CX-9 vehicles with VINs lower than JM3TC*****231530 (produced before Apr. 27, 2018)

DESCRIPTION

Some vehicles may exhibit a squeaking noise from the front brakes during light braking. This concern usually occurs when the front brake pads have been worn to certain levels. Also, as the pads wear, the chamfer goes away and the grease between the pad and the shim deteriorates.

To eliminate this concern, the chamfer shape of the brake pad has been modified to increase its durability.

REPAIR PROCEDURE

1. Verify the customer concern.
2. Remove the front brake pads according to the instructions on MGSS online DISC PAD (FRONT) REPLACEMENT.

NOTE: The modified pads alone are effective for brake squeak, but the modified shims and grease should also be used, especially for customers who are very sensitive to brake noise.

3. Clean the mounting support areas (1) with brake cleaner.

CONSUMER NOTICE: The information and instructions in this bulletin are intended for use by skilled technicians. Mazda technicians utilize the proper tools/equipment and take training to correctly and safely maintain Mazda vehicles. These instructions should not be performed by "do-it-yourselfers." Customers should not assume this bulletin applies to their vehicle or that their vehicle will develop the described concern. To determine if the information applies, customers should contact their nearest authorized Mazda dealership. Mazda North American Operations reserves the right to alter the specifications and contents of this bulletin without obligation or advance notice. All rights reserved. No part of this bulletin may be reproduced in any form or by any means, electronic or mechanical---including photocopying and recording and the use of any kind of information storage and retrieval system ---without permission in writing.

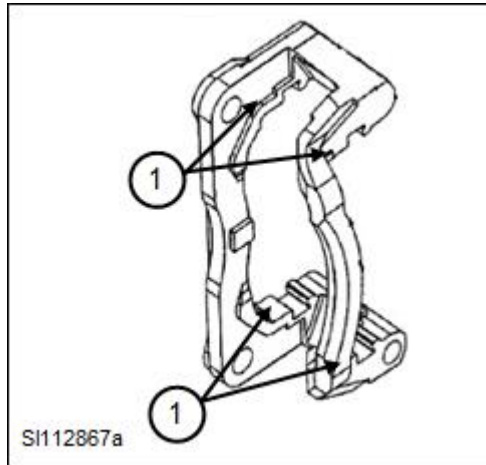

4. Clean the exposed area of the piston and the caliper pins with brake cleaner.

5. Press the piston in using a commercially available disc brake expander tool.

CAUTION: Do not use a pair of pliers etc. since the piston is made of plastic and may be damaged by pliers, etc.

6. Evenly apply the white grease between the pad and shim (as shown below).

NOTE:

- Use a half packet of white grease for the pad and shim (one (1) packet for one (1) side of the vehicle).
- Do not apply the white grease to the pad surface or disc plate.
- Wipe off any excess grease coming out of the applicable areas.
- Do not mix white grease with black grease.



CONSUMER NOTICE: The information and instructions in this bulletin are intended for use by skilled technicians. Mazda technicians utilize the proper tools/equipment and take training to correctly and safely maintain Mazda vehicles. These instructions should not be performed by "do-it-yourselfers." Customers should not assume this bulletin applies to their vehicle or that their vehicle will develop the described concern. To determine if the information applies, customers should contact their nearest authorized Mazda dealership. Mazda North American Operations reserves the right to alter the specifications and contents of this bulletin without obligation or advance notice. All rights reserved. No part of this bulletin may be reproduced in any form or by any means, electronic or mechanical---including photocopying and recording and the use of any kind of information storage and retrieval system ---without permission in writing.



SI112867c



SI112867d

7. Attach the shim as shown.



SI112867e

8. Remove the shim and confirm the grease has been applied evenly (as shown below).

CONSUMER NOTICE: The information and instructions in this bulletin are intended for use by skilled technicians. Mazda technicians utilize the proper tools/equipment and take training to correctly and safely maintain Mazda vehicles. These instructions should not be performed by "do-it-yourselfers." Customers should not assume this bulletin applies to their vehicle or that their vehicle will develop the described concern. To determine if the information applies, customers should contact their nearest authorized Mazda dealership. Mazda North American Operations reserves the right to alter the specifications and contents of this bulletin without obligation or advance notice. All rights reserved. No part of this bulletin may be reproduced in any form or by any means, electronic or mechanical---including photocopying and recording and the use of any kind of information storage and retrieval system ---without permission in writing.



9. Install the front brake pads according to the instructions on MGSS online DISC PAD (FRONT) REPLACEMENT.

NOTE: Replace the guide plates (1) with the new ones included in the shim set.

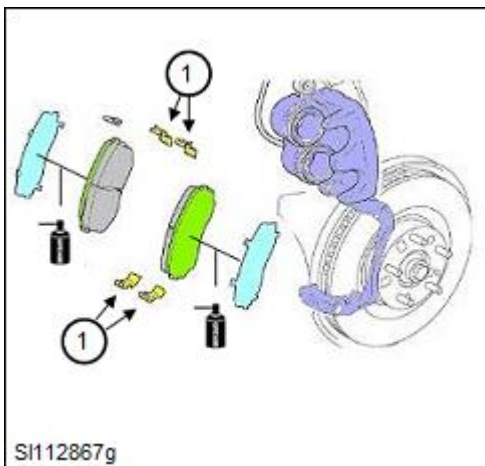

10. After installation, depress the brake pedal a few times and confirm that the brake pedal does not feel spongy.

11. Verify the repair.

PARTS INFORMATION

Parts Number	Description	Qty.	Notes
TNY9-33-28Z	Pad set	1	Includes one (1) package of grease
KCYR-33-29Z	Shim -set	1	Includes one (1) package of grease

CONSUMER NOTICE: The information and instructions in this bulletin are intended for use by skilled technicians. Mazda technicians utilize the proper tools/equipment and take training to correctly and safely maintain Mazda vehicles. These instructions should not be performed by "do-it-yourselfers." Customers should not assume this bulletin applies to their vehicle or that their vehicle will develop the described concern. To determine if the information applies, customers should contact their nearest authorized Mazda dealership. Mazda North American Operations reserves the right to alter the specifications and contents of this bulletin without obligation or advance notice. All rights reserved. No part of this bulletin may be reproduced in any form or by any means, electronic or mechanical---including photocopying and recording and the use of any kind of information storage and retrieval system ---without permission in writing.

WARRANTY INFORMATION

NOTE:

- This warranty information applies only to verified customer complaints on vehicles eligible for warranty repair.
- This repair will be covered under Mazda's New Vehicle Limited Warranty term.
- Additional diagnostic time cannot be claimed for this repair.

Warranty Type	A
Symptom Code	35
Damage Code	99
Part Number Main Cause	TNY9-33-28Z
Quantity	1
Operation Number / Labor Hours:	XXP6EXRX / 0.4 Hrs.

CONSUMER NOTICE: The information and instructions in this bulletin are intended for use by skilled technicians. Mazda technicians utilize the proper tools/equipment and take training to correctly and safely maintain Mazda vehicles. These instructions should not be performed by "do-it-yourselfers." Customers should not assume this bulletin applies to their vehicle or that their vehicle will develop the described concern. To determine if the information applies, customers should contact their nearest authorized Mazda dealership. Mazda North American Operations reserves the right to alter the specifications and contents of this bulletin without obligation or advance notice. All rights reserved. No part of this bulletin may be reproduced in any form or by any means, electronic or mechanical---including photocopying and recording and the use of any kind of information storage and retrieval system ---without permission in writing.