

Subject: CHECK ENGINE LIGHT ON WITH DTC P0456	Service Alert No.: SA-030/18
	Last Issued: 06/25/2018

APPLICABLE MODELS/VIN(S)

2017 Mazda3 with VINS starting with 3MZ (Mexico built)

DESCRIPTION

Some customer may complain about the CHECK ENGINE light ON while driving. When diagnosed, it is found that the PCM has stored DTC P0456 for evaporative gas leakage (extremely low). This may be caused by leakage detected from the catch tank unit (1) at the purge valve (2).

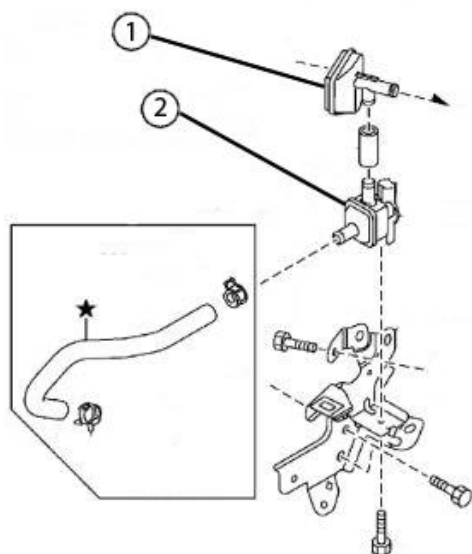

REPAIR PROCEDURE

1. Verify concern.
2. Inspect the catch tank by applying pressure with a Mighty Vac or similar tool and apply soapy water to the unit. See attached video for reference.
 - If no leak is found at the catch tank unit, continue to diagnose according to the instructions on MGSS.
 - If a leak is found at the catch tank unit, replace it.
3. Verify repair.