

**HYUNDAI**  
**Technical Service Bulletin**

GROUP <b>BODY ELECTRICAL</b>	NUMBER <b>18-BE-011</b>
DATE <b>JULY, 2018</b>	MODEL(S) <b>MULTIPLE MODELS</b>

**SUBJECT:** UNABLE TO SET OR VIEW D-AUDIO CLOCK

**Description:** This bulletin describes the procedure to diagnose the vehicle’s D-Audio unit as a result of the inability to set the clock or view it on the top of the screen.



**SYMPTOM(S)**

<b>No Clock Displayed at Top Center of Screen</b>	<b>Date/Time Settings Grayed out</b>

<p><b>Applicable Vehicles:</b></p>	<p><b>Certain D-Audio Equipped Models:</b></p> <ul style="list-style-type: none"> <li>• 17MY – 18MY Elantra (AD)</li> <li>• 18MY Ioniq Hybrid (AE HEV)</li> <li>• 17MY Sonata Hybrid (LF HEV)</li> <li>• 16MY – 17MY Sonata (LF)</li> <li>• 16MY – 17MY Elantra GT (GD)</li> <li>• 17MY – 18MY Santa Fe Sport (AN)</li> <li>• 18MY Elantra GT (PD)</li> <li>• 17MY Veloster (FS)</li> <li>• 17MY – 18MY Santa Fe (NC)</li> </ul>
------------------------------------	--

**Warranty Information:** Normal warranty applies where applicable.

**SUBJECT: UNABLE TO SET OR VIEW D-AUDIO CLOCK**

**Diagnostic Diagram:**

Start the vehicle by using the key (A), or with the Start Stop Button (A).

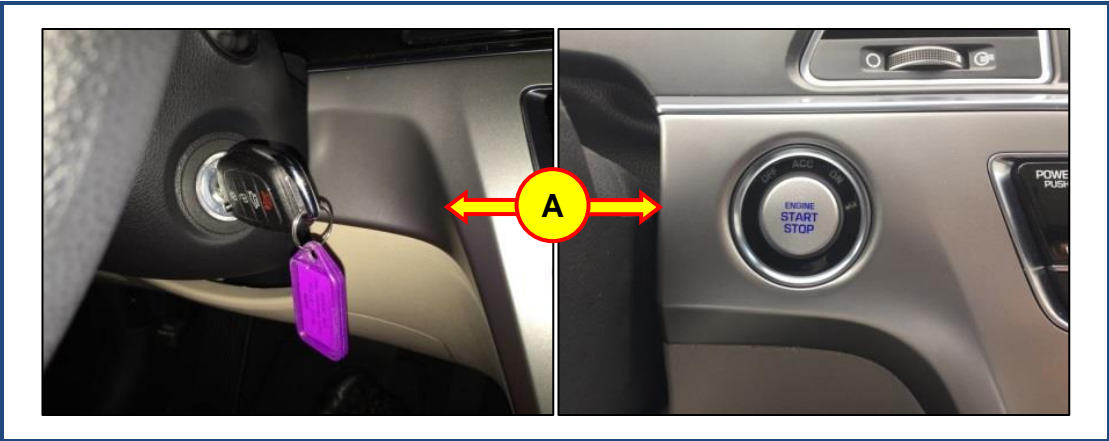

Confirm symptom(s)

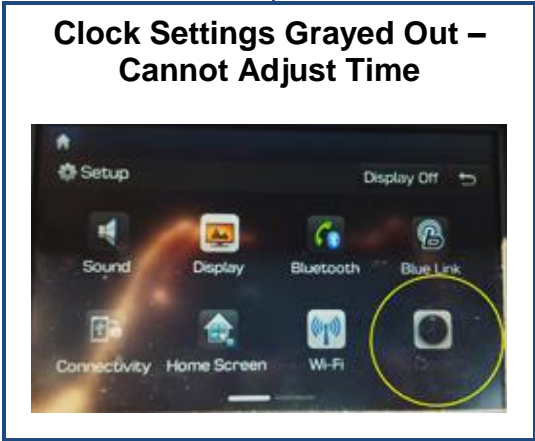
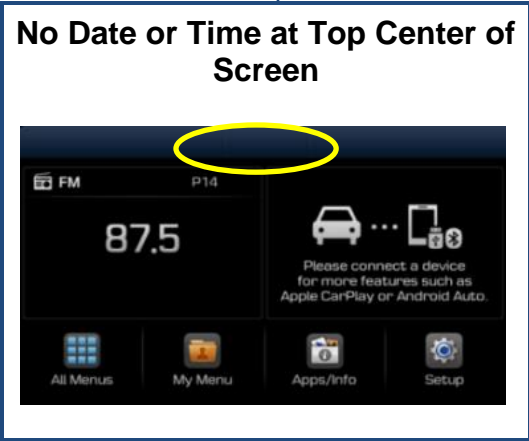

Action(s)

Replace radio assembly

Replace radio assembly