	GROUP General	MODEL 2017MY~ Sportage (QL) 2019MY~ Sorento (UMa)
	NUMBER PS451 (Rev 2, 06/08/2018)	DATE May 2016



TECHNICAL OPERATIONS

SUBJECT: FRONT LICENSE PLATE AND MOUNTING BRACKET POSITION ON VEHICLES EQUIPPED WITH AEB/FCA

★ NOTICE

This bulletin has been revised to include additional information. New/revised sections of this bulletin are indicated by a black bar in the margin area.

This Pitstop provides information regarding the installation of the front license plate bracket on 2017MY~ Sportage (QL) and 2019MY~ Sorento (UMa) vehicles equipped with Autonomous Emergency Braking (AEB) / Forward Collision Avoidance Assist (FCA).

On 2017MY~ Sportage (QL), the front license plate bracket is installed in one of two different positions, depending on whether the vehicle is equipped with 2-Wheel-Drive (2WD) or All-Wheel-Drive (AWD). On 2019MY~ Sorento (UMa), the front license plate bracket is installed in only one position.

On Sportage (QL) 2WD and Sorento (UMa) 2WD/AWD vehicles equipped with AEB or FCA, the radar sensor is mounted below the front bumper cover. The license plate needs to be positioned to provide an unobstructed “forward view” for the AEB/FCA radar module. If the bracket and license plate are mounted incorrectly, the plate may interfere with the AEB/FCA sensor and cause the system to not operate correctly. The system may display the “Auto Emergency Braking Disabled Temporarily” or “Forward Collision Avoidance Assist system disabled. Radar blocked” message* in the instrument cluster center and/or may illuminate the AEB/FCA warning light until the condition is corrected.

*Messages may vary from model to model.

Follow the instructions below to ensure that the AEB/FCA system is not being impaired by an incorrect license plate installation.



Radar module partially blocked; plate mounted **incorrectly**.



Warning message* may alert driver that AEB/FCA is unavailable!



Radar module unobstructed; plate mounted **correctly**.

To position the bracket and plate correctly, align the two guide/locator pins on the back of the bracket with the dimples (A) in the front bumper cover and position the license plate mounting holes in the bracket at the top, as shown (B) below.

Sportage (QL) 2WD

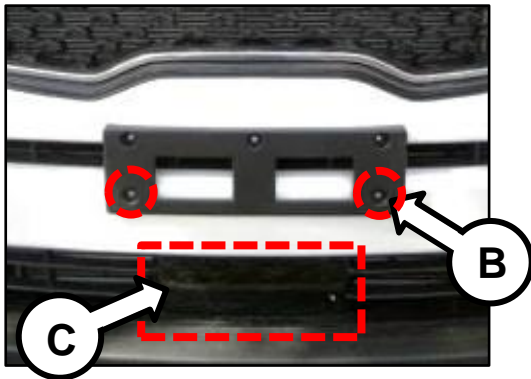
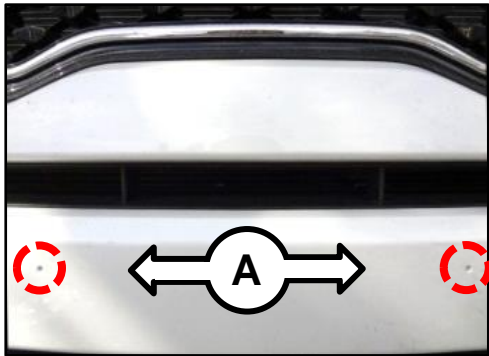

Sorento (UMa) 2WD/AWD

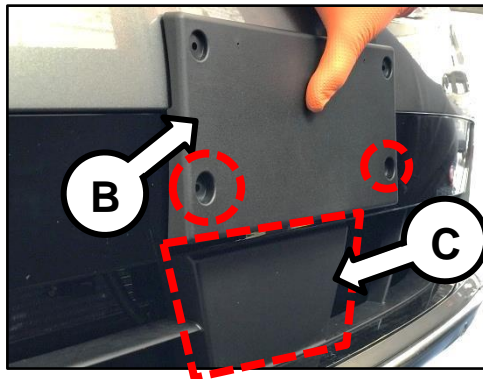
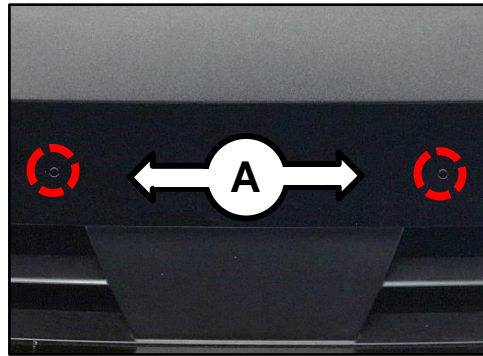

For more information on AEB/FCA operation and how obstructions of the sensor can interfere with proper system performance, refer to the applicable owner's manual pages (QL: 7-56 to 7-57; UMa: 5-54 to 5-55) or view the Owner's Manual on KGIS.

On Sportage (QL) AWD vehicles equipped with AEB, the radar sensor (C) is mounted above the license plate, in front of the grill. The front license plate mounting bracket (D) is installed on the lower portion of the front bumper cover, as shown below.

