



INSTRUCTION TO SERVICE

ITS: 6845

SECTION:	219 Engine and Transmission
WRITTEN BY:	Mike Pearson
SUBJECT:	Rework muffler harness connections against excessive heat

ITS6845

THIS DOCUMENT AND THE CONTENTS DISCUSSED HEREIN ARE THE CONFIDENTIAL AND PROPRIETARY INFORMATION OF NEW FLYER INDUSTRIES CANADA ULC AND NEW FLYER OF AMERICA INC. AND ARE DISCLOSED BY NEW FLYER IN CONFIDENCE. THIS DOCUMENT AND THE CONTENTS HEREIN ARE NOT TO BE DISCLOSED BY THE INTENDED RECIPIENT WITHOUT THE PRIOR WRITTEN AUTHORIZATION OF NEW FLYER. ANY UNAUTHORIZED DISCLOSURE, REPRODUCTION OR OTHER DISTRIBUTION OF THIS DOCUMENT OR INFORMATION IS STRICTLY PROHIBITED AND MAY RESULT IN ACTION BEING TAKEN AGAINST THE PARTY MAKING THE UNAUTHORIZED DISCLOSURE. THIS DOCUMENT AND ALL COPIES HEREOF MUST BE RETURNED TO NEW FLYER UPON REQUEST.



NEW FLYER

PROCEDURE:

1. Turn the main battery disconnect switch to the “OFF” position.
2. Open the muffler access door and locate the existing O2 and Exhaust temperature sensor harness support bracket.

⚠ WARNING: To avoid personal injury from hot surfaces, **DO NOT** work in the muffler area if it is hot. Allow the muffler compartment area to cool enough to touch before working in the area.

3. Remove and discard the existing p-clips and mounting hardware from the existing harness support bracket, temporarily tie back the existing harness (x2), see Figure 1.
4. Remove and save the existing screws and washers (x2) securing the existing harness bracket to the frame, remove and discard the bracket. Re-install the two (2) screws and washers into the same holes as removed. See Figure 1.

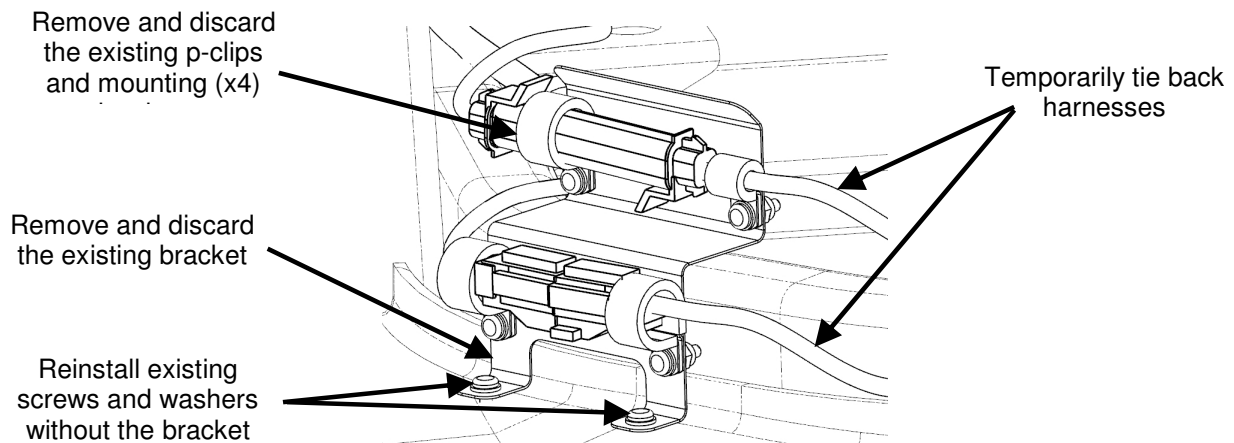

Figure 1: Existing Harness Support Bracket

5. Position new harness support bracket p/n 733063 at the location and orientation shown in Figures 2 and 3. Using the bracket mounting holes as a template mark and drill 0.166 dia tapping hole (x3) through the existing frame.

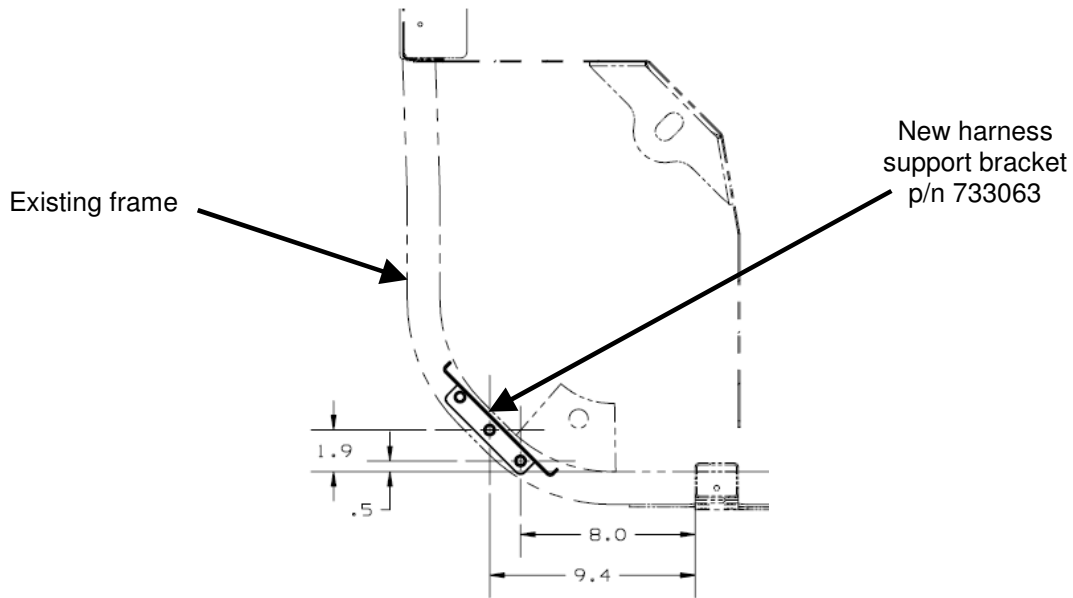

Figure 2: Harness Support Bracket Hole Location



NEW FLYER

6. Install the new harness support bracket to the existing frame as shown in Figure 3 using screw p/n 34S00012 (x3) and washer p/n 50W00000 (x3).

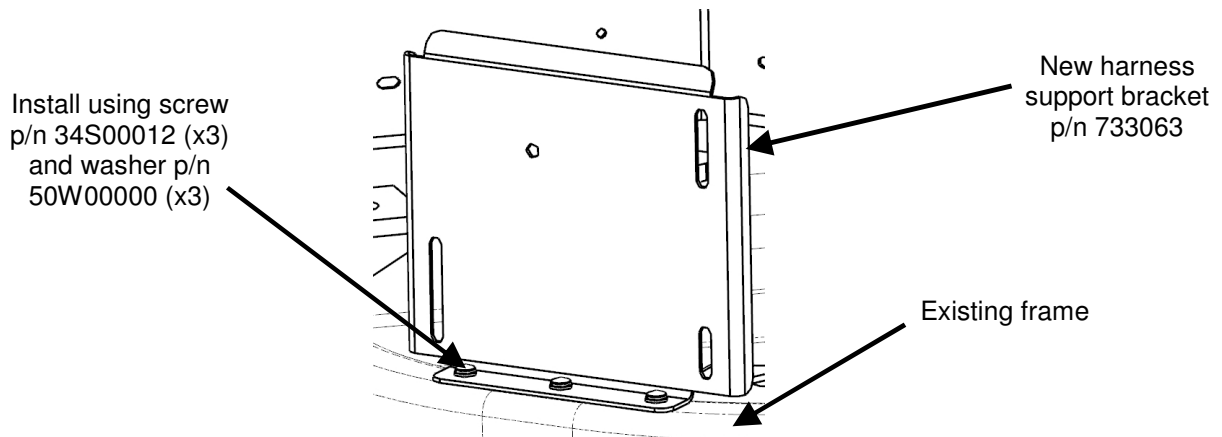

Figure 3: Harness Support Bracket Installation

7. Retrieve the tied back harnesses (x2) from Step 3 and double checking to make sure they are connected properly. Cover each harness connection completely with high heat tape p/n 199595. See Figure 4.
8. Secure the existing O2 sensor harness connectors to the new harness support bracket using clamp p/n 633401, screw p/n 14S00024, washer p/n 659000 (x2) and nut p/n 42N00000. Harness connection is to be positioned 30 degrees off horizontal as shown in Figure 4.
9. Secure the harness at the top of the bracket using clamp p/n 633401, screw p/n 14S00024, washer p/n 659000 (x2) and nut p/n 42N00000. Harness connection is to be positioned 30° off horizontal as shown in Figure 4.
10. When securing the harness ensure to leave a proper drip loop to drain any water/moisture, See Figure 4.
11. Secure the existing Exhaust gas temperature sensor harness connectors to the new harness support bracket using clamp p/n 633401, screw p/n 14S00024, washer p/n 659000 (x2) and nut p/n 42N00000 for the forward securement and clamp p/n 633400, screw p/n 14S00020, washer p/n 659000 (x2) and nut p/n 42N00000 for the rearward securement. See Figure 4.
12. When securing the harness ensure to leave a proper drip loop to drain any water/moisture, See Figure 4.

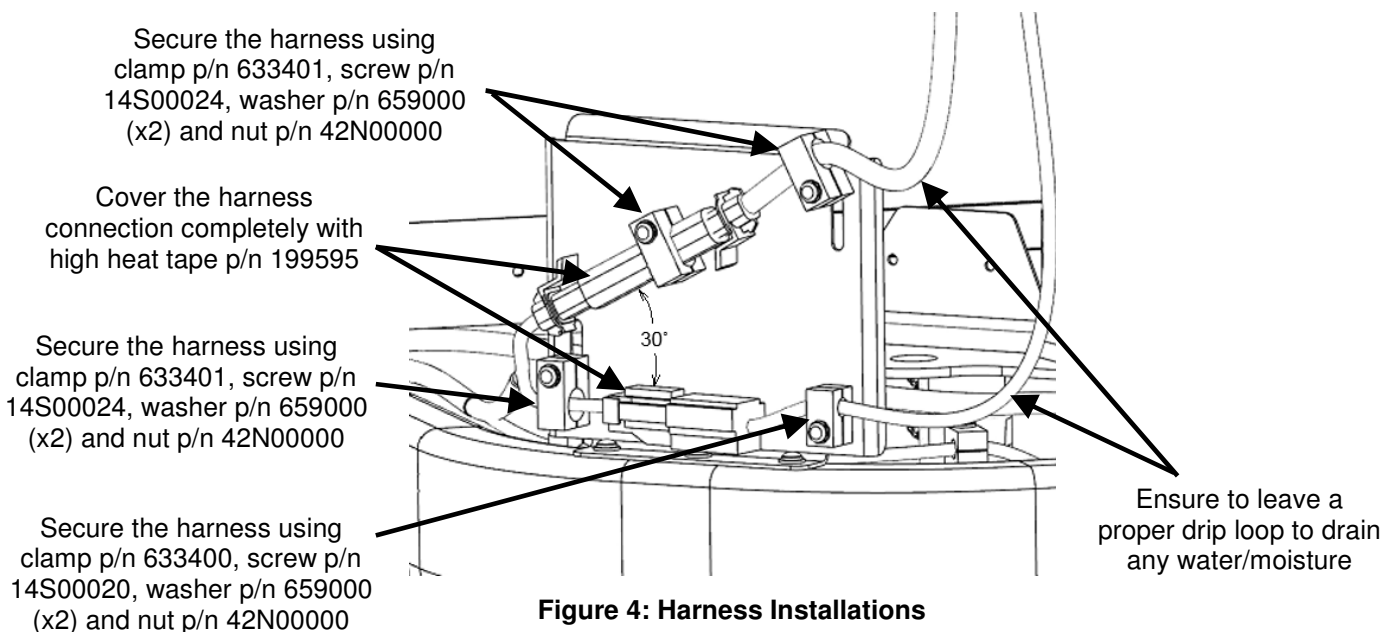

Figure 4: Harness Installations



NEW FLYER

13. Close the muffler access door.
14. Remove all tools and debris and return the bus to service condition.
15. Turn the main battery disconnect switch to the "ON" position.

LABOUR ESTIMATE

	Operation	Men	Hours	Labour Time M X HR
1	Rework muffler harness connections against excessive heat	1	0.75	0.75

PARTS REQUIRED

Item	Part Number	Description	Qty. per Coach	Units	Notes
1	733063	Bracket-Harness Support	1	EA	
2	199595	Tape-High Temperature Aluminum 342C	0.100	EA	
3	633401	Clamp-5/8 Dia Line PTFE	3	EA	
4	633400	Clamp-0.375 Dia line PTFE	1	EA	
5	14S00024	Screw-PH 10-24 x 1.50 Lg	3	EA	
6	14S00020	Screw-PH 10-24 x 1.25 Lg	1	EA	
7	659000	Washer-Flat SST #10	8	EA	
8	42N00000	Nut-Nylon Lock #10 SST	4	EA	