

Reference	SSM72624
Models	Discovery Sport / L550
Title	L550 - Unused seat trim parts found inside vehicle - 2nd Row fixed seat
Category	Body
Last modified	10-May-2018 00:00:00
Symptom	107000 Interior Trim
Attachments	111Bagged Items.jpg

Content**Issue:**

During PDI, an additional bag of unused seat trim parts (as per the image attached) may be discovered inside those vehicles fitted with non-sliding, fixed 2nd Row Seats.

Cause:

These parts are covers intended for the 2nd row sliding seats and have been supplied on 2nd row fixed seats due to a sequencing process at a JLR supplier.

Action:

Confirm the vehicle has a 2nd Row Seat = Fixed.

- If so, please dispose of the extra parts appropriately
- Do not attempt to fit the parts.

Technicians - Please rate this SSM and provide comments so that future communications can be improved.

1 = Poor – Basic information provided – The SSM does not help me resolve the customer concern.

3 = Average – Adequate information provided – The SSM partially helps me resolve the customer concern.

5 = Excellent – All required information provided to resolve the customer concern.

PRE-INITIALISATION OF DSS AFTER INSTALLATION (SWITCHING THE SYSTEM OFF/ON)

When the DSS is first installed the electronic ECU module is delivered in an 'OFF' condition. This is designed to prevent the steps from deploying/stowing unintentionally after installation.

Before proceeding with initialisation of the DSS module, the ignition should be switched on and off to allow the vehicle network to be awake; please refer to the owners hand book for instructions.

INITIALISATION OF DSS 'SWITCHING THE SYSTEM OFF/ON'

Initialisation of the DSS should be made within 60 seconds of PRE-INITIALISATION.

The DSS system is switched ON as follows;
Ensure the ignition is OFF.
Press and hold the DSS function switch and within 2* seconds of holding the DSS function switch, press the START/STOP button to turn the ignition on

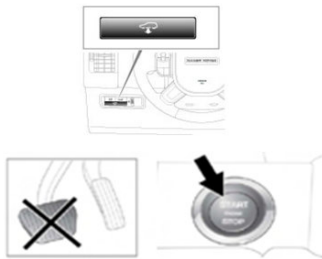

The function switch indicator will flash 3 times to indicate that the system is switched ON. To switch the system OFF, the same procedure should be followed and the function switch indicator will flash 2 times to indicate that the system is off.

* Failure to turn the ignition ON within 2 seconds of pressing the function switch will prevent the system from switching ON/OFF

FUNCTION SWITCH INDICATOR DOES NOT FLASH AFTER INITIALISATION SEQUENCE

It has been identified that the DSS initialisation process does not always switch the DSS system ON/OFF.

After performing the "SWITCHING THE SYSTEM ON/OFF" process, if the function switch indicator does not flash the process of "SWITCHING THE SYSTEM ON/OFF" should be repeated up to 10 times until the function switch indicator flashes.

If after 10 attempts the system still fails to turn ON/OFF the system should be diagnosed with dealer network tools (SDD) and any Device Trouble Codes (DTC's) should be cleared and the process from the PRE-INITIALISATION stage repeated.