

Diesel Exhaust Fluid (DEF) Pressure Line Disconnected at the Doser Connection

49-040

FLA COE
FLB COE
FLD Conventional
Business Class
FLC 112 Conventional

Century Class Conventional
Argosy COE
Cargo
Columbia
> 122SD and Coronado

> Business Class M2
> Cascadia
> 108SD/114SD
> New Cascadia

Freightliner
Service Bulletin

General Information

On some GHG14 and GHG17 vehicles equipped with a Detroit one-box aftertreatment system (ATS), the DEF pressure line may be pushed off the doser connection by frozen DEF in extreme cold climates. See [Fig. 1](#). Going forward, vehicles equipped with a Detroit Diesel one-box ATS will have a zip tie installed through the doser mounting bracket and around the DEF pressure line.

Installing the zip tie (part number 23-09796-509) prevents the DEF pressure line from being pushed off. The zip tie can be installed as a preventive measure or can be installed after the DEF line is disconnected, without replacing the DEF line.

Procedure

1. Park the vehicle on a level surface, shut down the engine, and set the parking brake. Chock the tires.
2. Locate the DEF pressure line on the ATS.
3. Install a zip tie through the doser mounting bracket and around the DEF pressure line as shown in [Fig. 2](#).

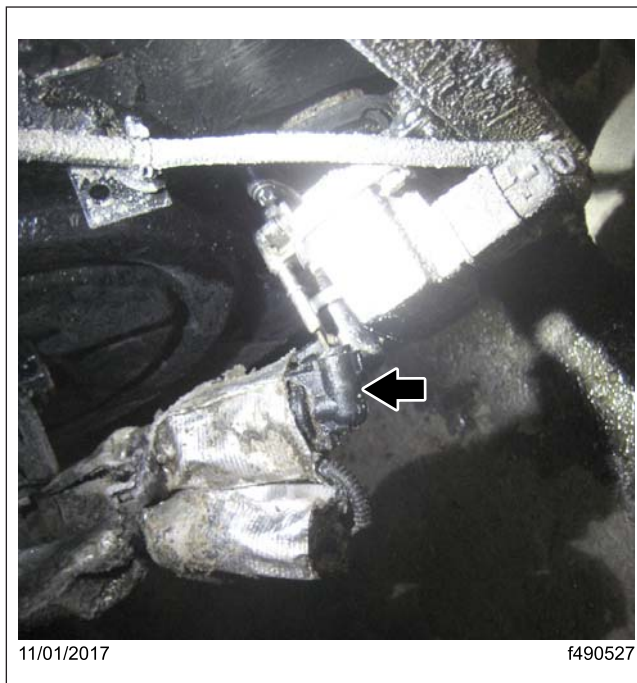

Fig. 1, Broken DEF Line

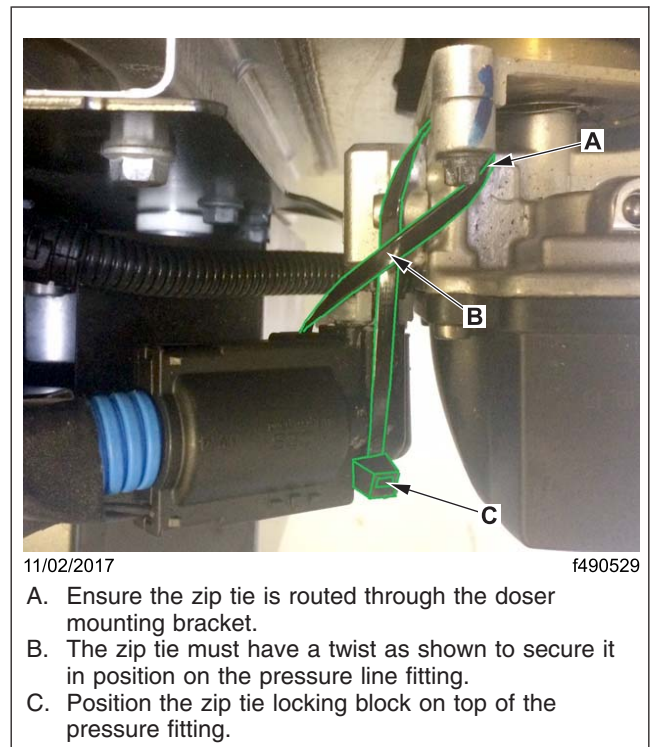

Fig. 2, Installing a Zip Tie on the DEF Pressure Line and Doser

Warranty

This procedure is warrantable only if the described condition exists and the repair is performed within the applicable base or extended coverage warranty period. If a failure is not found, this procedure is considered preventive and warranty does not apply.

49-040

Diesel Exhaust Fluid (DEF) Pressure Line Disconnected at the Doser Connection

Freightliner Service Bulletin

FLA COE
FLB COE
FLD Conventional
Business Class
FLC 112 Conventional

Century Class Conventional
Argosy COE
Cargo
Columbia
> 122SD and Coronado

> Business Class M2
> Cascadia
> 108SD/114SD
> New Cascadia

Normal warranty applies. See [Table 1](#) for OWL VMRS codes and labor allowance information. Enter this service bulletin number in the *Service Bulletin #* field.

OWL VMRS Codes and Labor Allowance					
Primary Failed Part	Component Code	Cause Code	SRT Code	Description	Time: Hours
04-31885-220	043-007-087	24	23W-5010A	Line, DEF, Doser Connection, Repair, SB49-040	0.3

Table 1, OWL VMRS Codes and Labor Allowance