

- ATTENTION:**
- GENERAL MANAGER
  - PARTS MANAGER
  - CLAIMS PERSONNEL
  - SERVICE MANAGER

IMPORTANT - All Service Personnel Should Read and Initial in the boxes provided, right.

|  |  |  |
|--|--|--|
|  |  |  |
|  |  |  |

© 2018 Subaru of America, Inc. All rights reserved.



QUALITY DRIVEN® SERVICE

## SERVICE BULLETIN

**APPLICABILITY:** 2014-2017MY Forester 2.0L Turbo  
2015-2017MY WRX 2.0L Turbo

**NUMBER:** 02-173-18

**DATE:** 02/06/18

**SUBJECT:** Turbocharger Intake Duct for Use in Extremely Cold Locations

### INTRODUCTION:

This bulletin announces availability of a special turbocharger air intake duct designed to prevent EXTREMELY RARE occurrences of ice formation from condensation in the duct's PCV system passages.



Ice formation in the PCV system



Compressor wheel damage from ingesting ice

**IMPORTANT NOTE:** There have only been a VERY small number of these cases and all have been in areas experiencing prolonged periods of sub-freezing (sub-zero) temperatures.

If these ice crystals were to become dislodged, internal components of the turbocharger, primarily the compressor wheel could be damaged. To prevent ice formation, the duct material is changed from resin to cast aluminum. The new part also incorporates an extra coolant passage to promote faster warm-up after cold start.

*Continued...*

**CAUTION: VEHICLE SERVICING PERFORMED BY UNTRAINED PERSONS COULD RESULT IN SERIOUS INJURY TO THOSE PERSONS OR TO OTHERS.**

Subaru Service Bulletins are intended for use by professional technicians ONLY. They are written to inform those technicians of conditions that may occur in some vehicles, or to provide information that could assist in the proper servicing of the vehicle. Properly trained technicians have the equipment, tools, safety instructions, and know-how to do the job correctly and safely. If a condition is described, DO NOT assume that this Service Bulletin applies to your vehicle, or that your vehicle will have that condition.

**Subaru of America, Inc. is ISO 14001 Compliant**

ISO 14001 is the international standard for excellence in Environmental Management Systems. Please recycle or dispose of automotive products in a manner that is friendly to our environment and in accordance with all local, state and federal laws and regulations.

**PRODUCTION CHANGE INFORMATION:**

As mentioned above, related cases have been reported from areas experiencing prolonged sub-freezing temperatures. For this reason, the aluminum duct and related parts have been incorporated into production on Canada-specification vehicles only, starting with the following VINs:

- Forester: **H\*483281**
- WRX: **H\*821561**

**PART INFORMATION:**

**NOTE:** Replace this duct **ONLY** after confirming the conditions shown in the Introduction photos above exist.

The part numbers for the aluminum intake ducts are supplied below. Additional “New” part information tables and illustrations are supplied for the related parts required to perform the installation. The “Old” part information is also supplied for comparison purposes.

| Description     | Part Number | Applicability |
|-----------------|-------------|---------------|
| DUCT CP-AIR INT | 14460AA370  | 2017MY        |
|                 | 14460AA390  | 2014-2016MY   |

**NOTES:**

- When ordering the parts for this procedure, order **ALL** the parts as listed on the applicable table.
- Never reuse parts listed as “non-reusable” or one-time use items.

*Continued...*

For **2014-2016MY** Vehicles:

**New Parts:**

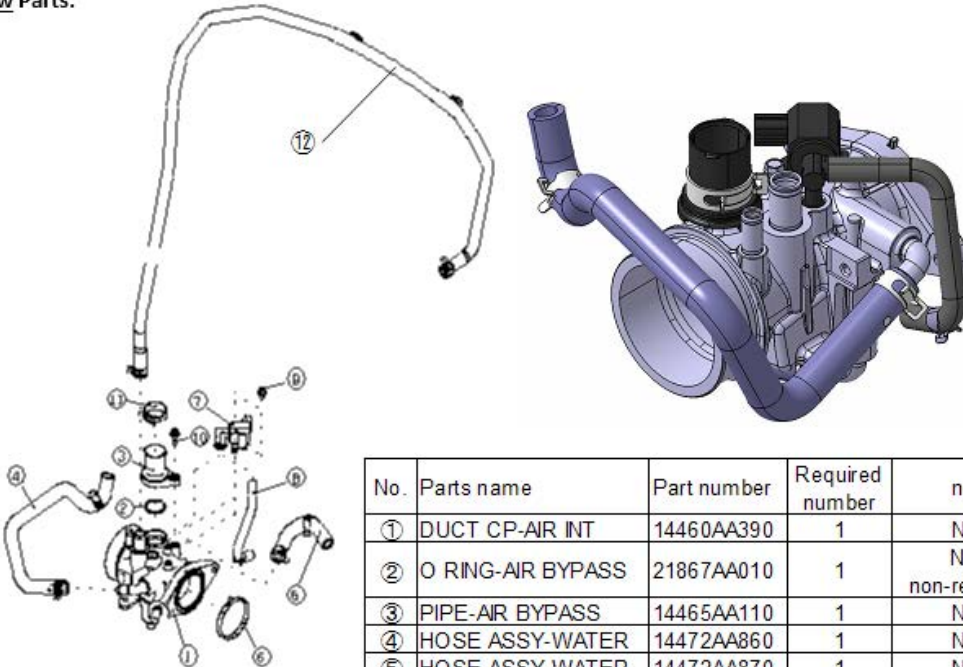

| No. | Parts name        | Part number | Required number | note             |
|-----|-------------------|-------------|-----------------|------------------|
| ①   | DUCT CP-AIR INT   | 14460AA390  | 1               | New              |
| ②   | O RING-AIR BYPASS | 21867AA010  | 1               | New non-reusable |
| ③   | PIPE-AIR BYPASS   | 14465AA110  | 1               | New              |
| ④   | HOSE ASSY-WATER   | 14472AA860  | 1               | New              |
| ⑤   | HOSE ASSY-WATER   | 14472AA870  | 1               | New              |
| ⑥   | GSKT-AIR INT DUCT | 14497AA040  | 1               | non-reusable     |
| ⑦   | VALVE AY-DUTY SOL | 16102AA520  | 1               |                  |
| ⑧   | HOSE AY-VAC CONT  | 22310AC420  | 1               |                  |
| ⑨   | BOLT-5X8X8        | -800105220  | 2               | New              |
| ⑩   | BOLT-SKT 6X16X16  | -800406030  | 1               | New              |
| ⑪   | HOSE CLP-26X12    | -805926090  | 1               |                  |
| ⑫   | PIPE ASSY-PCV     | 11849AA160  | 1               | New non-reusable |

**Old Parts:**

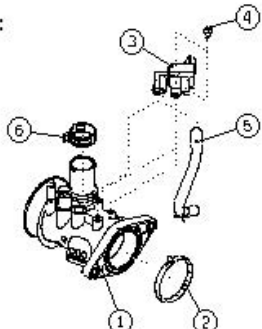

| No. | Parts name        | Part number | Required number | note         |
|-----|-------------------|-------------|-----------------|--------------|
| ①   | DUCT-AIR INT      | 14462AA571  | 1               |              |
| ②   | GSKT-AIR INT DUCT | 14497AA040  | 1               | non-reusable |
| ③   | VALVE AY-DUTY SOL | 16102AA520  | 1               |              |
| ④   | TAPPING SCREW 1   | -045105100  | 2               |              |
| ⑤   | HOSE AY-VAC CONT  | 22310AC420  | 1               |              |
| ⑥   | HOSE CLP-26X12    | -805926090  | 1               |              |

*Continued...*

For **2017MY** Vehicles:

**NEW Parts:**

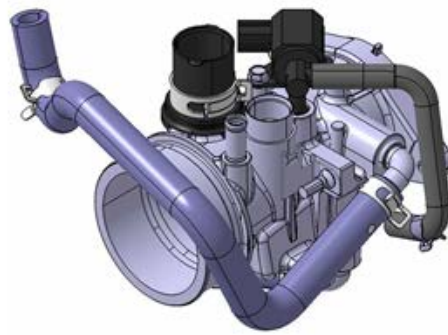
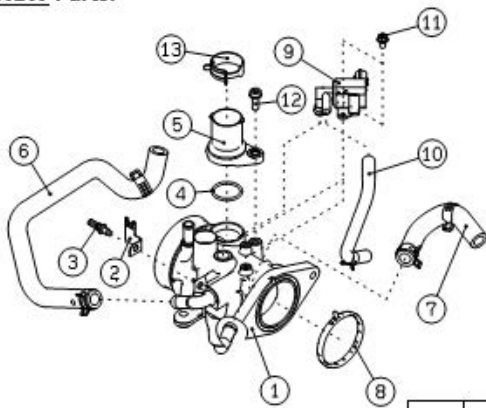

| No. | Parts name        | Part number | Required number | note                |
|-----|-------------------|-------------|-----------------|---------------------|
| ①   | DUCT CP-AIR INT   | 14460AA370  | 1               | New                 |
| ②   | STAY-CONN         | 22185AA000  | 1               | New                 |
| ③   | BOLT-6X11X8       | -808206080  | 1               | New                 |
| ④   | O RING-AIR BYPASS | 21867AA010  | 1               | New<br>non-reusable |
| ⑤   | PIPE-AIR BYPASS   | 14465AA110  | 1               | New                 |
| ⑥   | HOSE ASSY-WATER   | 14472AA860  | 1               | New                 |
| ⑦   | HOSE ASSY-WATER   | 14472AA870  | 1               | New                 |
| ⑧   | GSKT-AIR INT DUCT | 14497AA040  | 1               | non-reusable        |
| ⑨   | VALVE AY-DUTY SOL | 16102AA520  | 1               |                     |
| ⑩   | HOSE AY-VAC CONT  | 22310AC420  | 1               |                     |
| ⑪   | BOLT-5X8X8        | -800105220  | 2               | New                 |
| ⑫   | BOLT-SKT 6X16X16  | -800406030  | 1               | New                 |
| ⑬   | HOSE CLP-26X12    | -805926090  | 1               |                     |

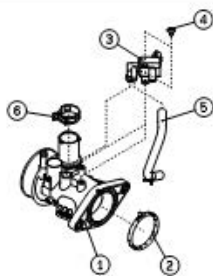

| No. | Parts name        | Part number | Required number |              |
|-----|-------------------|-------------|-----------------|--------------|
| ①   | DUCT-AIR INT      | 14462AA660  | 1               |              |
| ②   | GSKT-AIR INT DUCT | 14497AA040  | 1               | non-reusable |
| ③   | VALVE AY-DUTY SOL | 16102AA520  | 1               |              |
| ④   | TAPPING SCREW 1   | -045105100  | 2               |              |
| ⑤   | HOSE AY-VAC CONT  | 22310AC420  | 1               |              |
| ⑥   | HOSE CLP-26X12    | -805926090  | 1               |              |

*Continued...*

## SERVICE PROCEDURE / INFORMATION:

**Step 1:** Drain the engine coolant into a clean container following the procedure in the applicable Service Manual.

**Step 2:** Remove the turbocharger air intake duct (Intake Duct No. 1) following the procedure in the applicable Service Manual. (It is not necessary to remove Duct No.2 and No. 3.)

**Step 3:** Remove the engine water hose (highlighted) from the water pipe RH and Turbocharger.

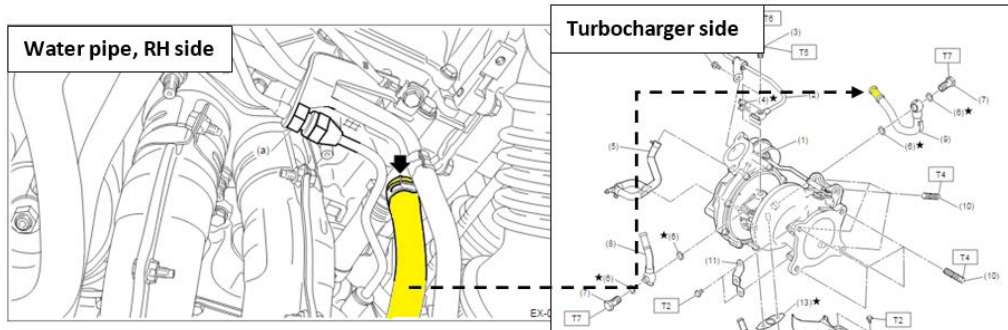

**NOTE:** STEPS **4** and **6** BELOW ARE APPLICABLE TO **2014 - 2016MY** VEHICLES ONLY.

**Step 4:** CAREFULLY remove the plastic PCV pipe following the procedure in the applicable Service Manual and discard it (the PCV pipe is a one-time use part).

**Step 5:** Assemble the new aluminum intake duct using the exploded view supplied with the Parts Information section of this bulletin as a guide.

**Step 6:** Install the new PCV pipe in reverse order of removal.

**Step 7:** Install the new aluminum intake duct and related components in reverse order of removal **BUT**, refer to the illustration below for installation of the new water hose to the water pipe RH and Turbocharger.

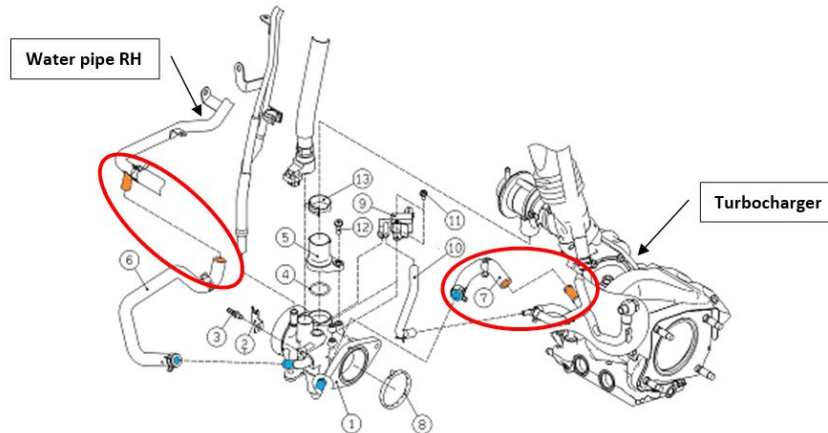

**Step 8:** Refill the cooling system fully following the procedure in the applicable Service Manual. Perform a final inspection for leaks along with confirmation of proper cooling fan and HVAC system operation to complete the procedure.

*Continued...*

## WARRANTY / CLAIM INFORMATION:

For vehicles within the Basic New Car Limited Warranty period or covered by an active Subaru Added Security Gold plan, this repair may be submitted using the following claim information:

| Labor Description  | Labor Operation # | Labor Time | Fail Code |
|--|-------------------|------------|-----------|
| TURBOCHARGER INTAKE DUCT- COLD WEATHER UPDATE, <b>2014-2016MY</b> VEHICLES | A451-300          | 0.9        | DCM-48    |
| TURBOCHARGER INTAKE DUCT- COLD WEATHER UPDATE, <b>2017MY</b> VEHICLES ONLY |                   | 0.8        |           |

## IMPORTANT REMINDERS:

- SOA strongly discourages the printing and/or local storage of service information as previously released information and electronic publications may be updated at any time.
- Always check for any open recalls or campaigns anytime a vehicle is in for servicing.
- Always refer to STIS for the latest service information before performing any repairs.