

**TB-18-94-01****MODEL:** Karma Revero**DATE:** April 2018**TITLE:** USB port install**First Release****PRIORITY:** On complaint**APPLICABILITY:** MY17 and MY18 Revero**MARKET REGION:** North America**PURPOSE:** Install updated USB port

For any concerns related to the USB port, use the following repair procedure to replace the USB port if necessary.

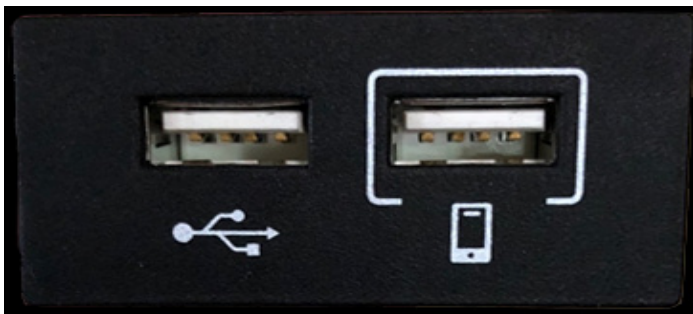

## Overview:

- 1 - Open center console
- 2 - Carefully use a pick tool on the sides of the port, push the tabs in and pull forward
- 3 - Repeat on the other side of the USB port
- 6 - Carefully disconnect the electrical connectors at the back of the USB port
- 7 - Dispose of the old USB port
- 8 - Connect the two electrical connectors and install the new USB port
- 9 - Verify function of USB port for data use and charging
- 10 - Check for available bulletins, verify no codes are present, address and correct any codes or conditions found as necessary.

Karma Automotive Bulletins and service documents are intended for use by experienced and trained Technicians. If you lack the skills, tools, equipment and a suitable workshop for any procedure described in this document, we suggest you leave such repairs to a Karma retailer and service provider. See your service provider for advice on whether your vehicle may benefit from the information contained within this document. The information contained in the Karma Bulletin is accurate at the date of publication. However, Karma Automotive regularly updates technical information. Please check with your Karma Automotive Retailer and Karma Automotive service provider that the bulletin you intend to use contains the latest available information.

**MODEL: Karma Revero****DATE: April 2018****TITLE: USB port install****First Release**

Open the center console (fig 1a 1b).

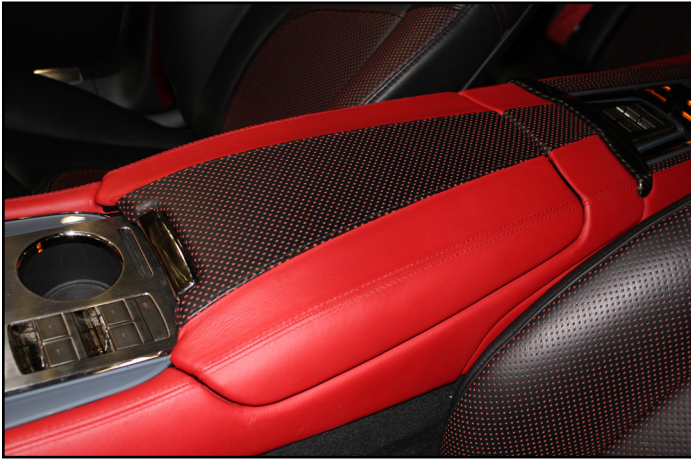

fig. 1a



fig. 1b

Care must be taken to insert the pick behind the USB port to avoid nicking or damaging the center console, (fig 1c, 1d) replace with the new unit.



fig. 1c



fig. 1d

Karma Automotive Bulletins and service documents are intended for use by experienced and trained Technicians. If you lack the skills, tools, equipment and a suitable workshop for any procedure described in this document, we suggest you leave such repairs to a Karma retailer and service provider. See your service provider for advice on whether your vehicle may benefit from the information contained within this document. The information contained in the Karma Bulletin is accurate at the date of publication. However, Karma Automotive regularly updates technical information. Please check with your Karma Automotive Retailer and Karma Automotive service provider that the bulletin you intend to use contains the latest available information.

**MODEL: Karma Revero****DATE: April 2018****TITLE: USB port install****First Release**

Repeat the process for the other side and gently pull forward (fig 2a, 2b).



fig. 2a



fig. 2b

There are two (2) connectors (fig 2c). Should you encounter any resistance be prepared to remove the console and do not damage the fragile connectors (see below and refer to service manual for assistance).

Attach the connectors and install the new USB port (fig 2d).



fig. 2c



fig. 2d

Karma Automotive Bulletins and service documents are intended for use by experienced and trained Technicians. If you lack the skills, tools, equipment and a suitable workshop for any procedure described in this document, we suggest you leave such repairs to a Karma retailer and service provider. See your service provider for advice on whether your vehicle may benefit from the information contained within this document. The information contained in the Karma Bulletin is accurate at the date of publication. However, Karma Automotive regularly updates technical information. Please check with your Karma Automotive Retailer and Karma Automotive service provider that the bulletin you intend to use contains the latest available information.

**MODEL:** Karma Revero

**DATE:** April 2018

**TITLE:** USB port install

**First Release**

Should you require to remove the console, Ensure the center console is empty, and remove rear jewel (fig. 3a). Remove the fasteners, T30 torx, install torque is 6.0 +/- 1.0Nm (fig.3b).



fig. 3a



fig. 3b

Karma Automotive Bulletins and service documents are intended for use by experienced and trained Technicians. If you lack the skills, tools, equipment and a suitable workshop for any procedure described in this document, we suggest you leave such repairs to a Karma retailer and service provider. See your service provider for advice on whether your vehicle may benefit from the information contained within this document. The information contained in the Karma Bulletin is accurate at the date of publication. However, Karma Automotive regularly updates technical information. Please check with your Karma Automotive Retailer and Karma Automotive service provider that the bulletin you intend to use contains the latest available information.

**MODEL: Karma Revero****DATE: April 2018****TITLE: USB port install****First Release**

Begin by removing the center console, reference the service manual for guidance. Remove the console jewel and switches (fig. 4a), note the fasteners and remove.



fig. 4a

To lift the center console, remove the front center console trim pieces, and undo the exposed bolts (2) fig. 4b and 4c.



fig. 4b



fig. 4c

Karma Automotive Bulletins and service documents are intended for use by experienced and trained Technicians. If you lack the skills, tools, equipment and a suitable workshop for any procedure described in this document, we suggest you leave such repairs to a Karma retailer and service provider. See your service provider for advice on whether your vehicle may benefit from the information contained within this document. The information contained in the Karma Bulletin is accurate at the date of publication. However, Karma Automotive regularly updates technical information. Please check with your Karma Automotive Retailer and Karma Automotive service provider that the bulletin you intend to use contains the latest available information.

**MODEL:** Karma Revero

**DATE:** April 2018

**TITLE:** USB port install

**First Release**

Open the center console door and remove the felt caps.

Remove the fasteners, T30 torx, install torque is 6.0 +/- 1.0Nm (fig. 5a)

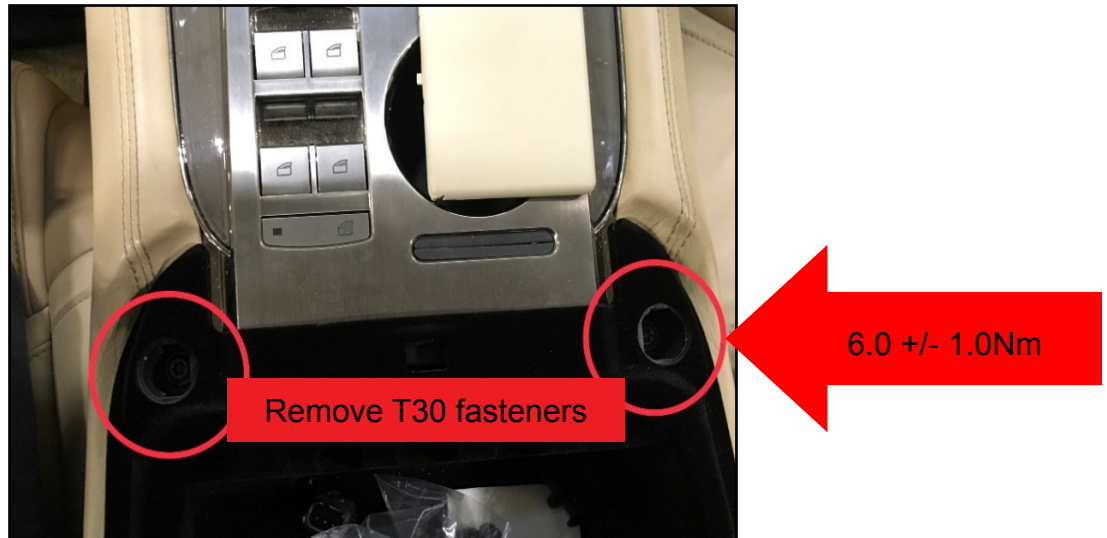

fig. 5a

The console can be lifted up slightly from the rear, push the tabs on the USB port and push forward into the console disconnect the electrical connectors at the back of the USB port (fig. 5b), install the new one. Assembly is the reverse of removal.

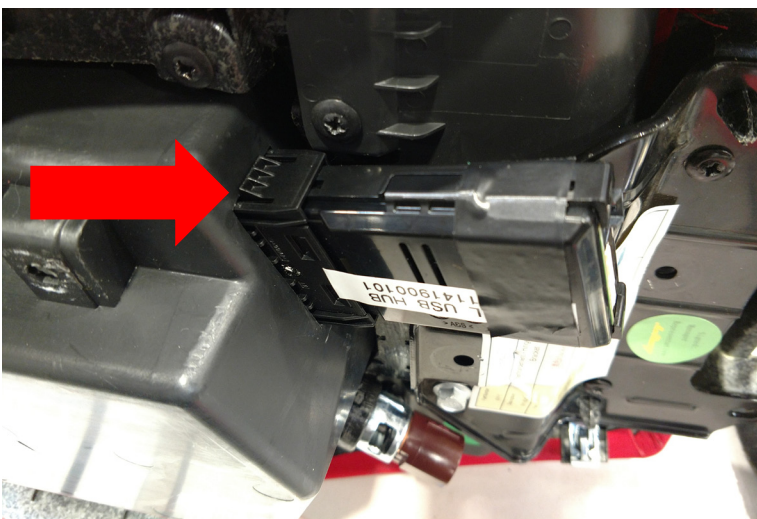

fig. 5b



Karma Automotive Bulletins and service documents are intended for use by experienced and trained Technicians. If you lack the skills, tools, equipment and a suitable workshop for any procedure described in this document, we suggest you leave such repairs to a Karma retailer and service provider. See your service provider for advice on whether your vehicle may benefit from the information contained within this document. The information contained in the Karma Bulletin is accurate at the date of publication. However, Karma Automotive regularly updates technical information. Please check with your Karma Automotive Retailer and Karma Automotive service provider that the bulletin you intend to use contains the latest available information.



# Technical Service Bulletin

**TB-18-94-01**

**MODEL:** Karma Revero

**DATE:** April 2018

**TITLE:** USB port install

**First Release**

**PARTS REQUIRED:**

PART NUMBER	DESCRIPTION	QTY
N/A		

**SHOP SUPPLIES:**

DESCRIPTION	QTY

**SPECIAL TOOLS:**

DESCRIPTION

**CAUSAL PART:**

PART NUMBER	DESCRIPTION
C131141900101	USB Port - Dual

**LABOR CODE**

CODE	DESCRIPTION	TIME	DEFECT CODE
94-20-15-05	USB port install	0.2	94-20-15-17

**SUBLET:**

CODE	DESCRIPTION	AMOUNT
N/A		

**WARRANTY DISPOSITION:** This repair is covered under the New Vehicle Limited Warranty, in effect for five (5) years from the in-service date with no mileage limitation.

Karma Automotive Bulletins and service documents are intended for use by experienced and trained Technicians. If you lack the skills, tools, equipment and a suitable workshop for any procedure described in this document, we suggest you leave such repairs to a Karma retailer and service provider. See your service provider for advice on whether your vehicle may benefit from the information contained within this document. The information contained in the Karma Bulletin is accurate at the date of publication. However, Karma Automotive regularly updates technical information. Please check with your Karma Automotive Retailer and Karma Automotive service provider that the bulletin you intend to use contains the latest available information.