



Technical Bulletin 186
02.2018

Contents

Item	Subject	Model Affected
186.1	Motorcycle Assembly Guide	Speed Triple S and Speed Triple RS From VIN 867601

Item: 186.1
Description: Motorcycle Assembly Guide
Model Affected: Speed Triple S and Speed Triple RS From VIN 867601

The following Assembly Guide is for the above motorcycles.

Motorcycle Crate Contents

- One motorcycle
- One battery (factory activated)
- Keys secured to the handlebar (three for Speed Triple S, two for Speed Triple RS)
- Smart key located under the passenger seat (Speed Triple RS only)
- One parts box consisting of the following:
 - One fulfilment pack
 - One or more owner handbook assemblies
 - One assembled seat cowl (Speed Triple RS only)

Assembly

1. Remove the motorcycle from the steel delivery crate as described in Part 1 - Motorcycle Unpacking Guide.

Warning

Ensure the motorcycle is stabilised and adequately supported. This will help prevent it from falling and causing injury to the operator or damage to the motorcycle.

Mirrors

Caution

Incorrect adjustment of the bar end mirrors may cause the mirror arm to make contact with the fuel tank, brake or clutch levers or other parts of the motorcycle. This will result in damage to the fuel tank, brake or clutch levers or other parts of the motorcycle.

Adjust the mirrors as required to ensure they do not contact any part of the motorcycle. After adjustment, move the handlebar to the left and right full lock while checking that the mirrors do not contact the fuel tank, brake or clutch levers or other parts of the motorcycle.

1. Position the mirrors to give rear visibility in the riding position. Do not rotate the mirror beyond 75°, measured from the vertical section of the mirror arm.

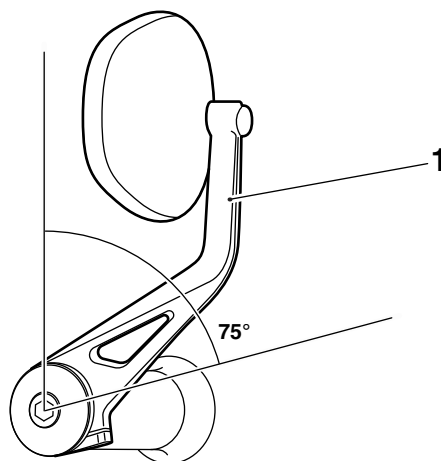

1. Mirror arm vertical section

Warning

If the mirror fixing is too loose, the mirror may blow back at speed. This will result in a loss of vision to the rear of the motorcycle. It is dangerous to ride a motorcycle without sufficient rearward vision.

2. Tighten the mirror lock nuts to **3.5 Nm**.

Seat Cowl - Speed Triple RS Only

Recover the seat cowl from the parts box. The seat cowl is to remain with the motorcycle and handed over to customer when the motorcycle handover. The installation and removal of the seat cowl is the same as the passenger seat described in the Owner Handbook.

General

1. Following the procedure listed in this model's handbook, check the engine oil has been pre-filled to the correct level.

Note:

- **Triumph recommend the use of Castrol Power 1 4T, 10W-40 for the initial running in period and a semi or fully synthetic 10W/40 or 10W/50 engine oil which meets specification API SH (or higher) and JASO MA such as Castrol Power 1 Racing 4T 10W-40 (fully synthetic) engine oil, sold as Castrol Power RS Racing 4T 10W-40 (fully synthetic) in some countries, thereafter.**
2. Clean off the protective coating from the tyres using a low alkaline soap and water solution.
 3. When required, carry out the pre-delivery inspection as detailed in Part 3 - Motorcycle Pre-Delivery Inspection Guide.

Note:

- **All Triumph motorcycles are still required to have their engine oil replaced at the first 500 mile (800 km) service.**
4. Stack or dispose the crate base as described in Part 1 - Motorcycle Unpacking Guide.

Circulation

Initial and date when read and return to central file holder

Service Manager	Parts Manager	Sales Manager	Workshop Supervisor	Technician 1	Technician 2