



Service Bulletin

File in Section: -

Bulletin No.: 18-NA-046

Date: February, 2018

TECHNICAL

Subject: Headlamp Bezel Loose or Falling Off

| Brand: | Model: | Model Year: | | VIN: | | Engine: | Transmission: |
|-----------|------------------------|-------------|------|------|----|---------|---------------|
| | | from | to | from | to | | |
| Chevrolet | Silverado - Light Duty | 2016 | 2018 | | | All | All |

| | |
|----------------------------|------------------------------------------------------------------------------------------------------------------------------------------------------------------------------|
| Involved Region or Country | North America, Middle East, Chile, Thailand and Paraguay |
| Additional Options (RPOs) | |
| Condition | Some customers may comment on finding a headlamp bezel loose or falling off. |
| Cause | The cause of the condition may be that the attachment tape holding the bezel to the headlamp is not adhering properly. |
| Correction | Note: It is not necessary to replace the headlamp assembly. Clean the headlamp and bezel, and install new double-sided tape following the Service Procedure below. |

Service Procedure

1. Remove the affected headlamp assembly from the vehicle. Refer to the appropriate side *Headlamp Replacement (Chevrolet)*, in SI.
2. Place headlamp on a protected surface.

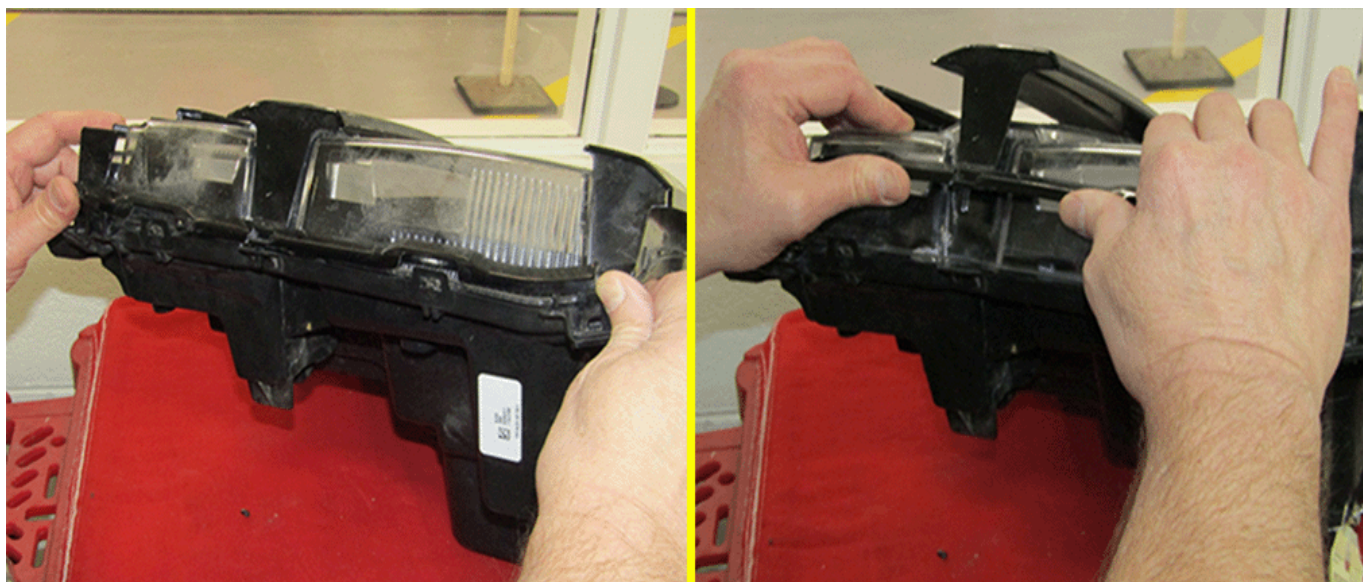

4971116

Important: To avoid damaging the bezel, gently push upward in a uniform manner, without twisting the bezel. This should release the attachment tape from the loose side across to the opposite side and the bezel can be detached from the headlamp.

3. Grabbing the top and bottom corners of the loose side of the headlamp bezel, carefully push the bezel upward to release the remaining tape holding the bezel to the lamp.

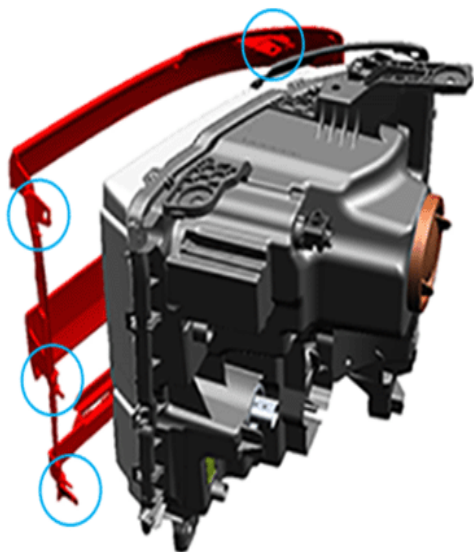

4971117

4. Once the tape is loose, carefully detach the bezel's retention tabs from the mating slots in the headlamp assembly.



4971119

5. Using a pushing and rolling action with the thumb or fingers, manually peel off the remnants of the tape on both the inside of the bezel and the outside of the headlamp.



4971120

Important: The headlamp bezel is made from ABS plastic and certain manufacturers recommend NOT using their solvent on ABS. Follow the manufacturer's recommendations for any cleaners/solvents used.

6. Completely clean both surfaces again with mild soap and water mixture, glass cleaner or equivalent.
7. Wipe both surfaces dry with a clean cloth.
8. Cut two 38 cm (15 in) lengths and two 35 cm (13.5 in) lengths of 3M Automotive Acrylic Plus Tape P/N 06382, or equivalent.



4971121

9. Apply the 38 cm (15 in) lengths of tape to the center of the bezel, positioning it directly over the visible previous location of the tape.
10. Apply the 35 cm (13.5 in) lengths of tape to the top and bottom of the bezel, positioning it directly over the visible previous location of the tape.
11. Firmly press and wet out all four pieces of the tape across the full length of the bezel.
12. Peel the protective film from the tape and position the bezel to the headlamp.

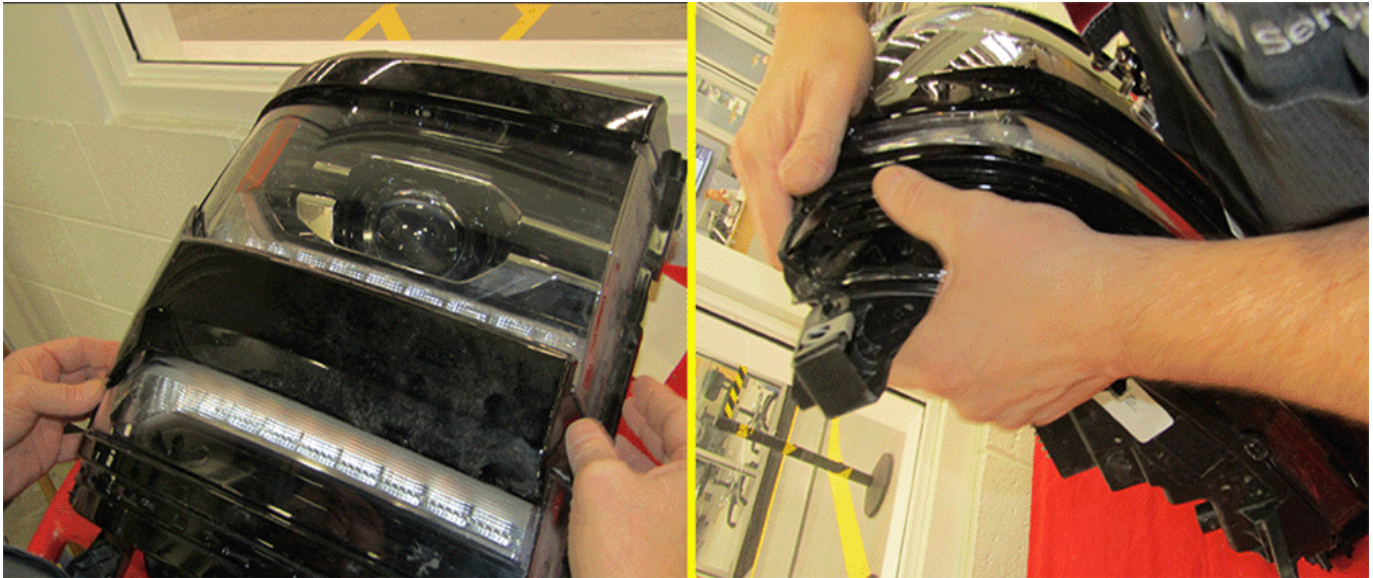

4971122

13. Ensure all retention tabs are engaged in their mating slots, and firmly press the bezel to the headlamp. Firmly press along all areas where the tape was applied.
14. Reinstall the headlamp to the vehicle. Refer to the appropriate side *Headlamp Replacement (Chevrolet)*, in SI.

Important: Allow the tape to set up per the manufacturer's recommendation, and don't run the vehicle through a car wash for at least 24 hours.

Parts Information

Unless damaged during removal, reinstall original bezel to the headlamp.

| Description | Part Number | Material Allowance |
|---------------------------------|-------------|----------------------------|
| 3M Automotive Acrylic Plus Tape | 06382 | \$3.00 US. (\$4.50 Canada) |

Warranty Information

For vehicles repaired under the Bumper-to-Bumper coverage (Canada Base Warranty coverage), use the following labor operation. Reference the Applicable Warranties section of Investigate Vehicle History (IVH) for coverage information.

| Labor Operation | Description | Labor Time |
|-----------------|-----------------------------------------------------|------------|
| 2080978* | Clean Headlamp and Bezel, Reapply Double Sided Tape | 1.6 hr |

*This is a unique Labor Operation for Bulletin use only.

| | |
|----------|----------------------------|
| Version | 1 |
| Modified | Released February 15, 2018 |

GM bulletins are intended for use by professional technicians, NOT a "do-it-yourselfer". They are written to inform these technicians of conditions that may occur on some vehicles, or to provide information that could assist in the proper service of a vehicle. Properly trained technicians have the equipment, tools, safety instructions, and know-how to do a job properly and safely. If a condition is described, **DO NOT** assume that the bulletin applies to your vehicle, or that your vehicle will have that condition. See your GM dealer for information on whether your vehicle may benefit from the information.



WE SUPPORT VOLUNTARY
TECHNICIAN
CERTIFICATION