

Subject: A/C MODE SELECTOR DIAL DOES NOT STAY IN "DEFROSTER VENTS" POSITION - (MANUAL A/C ONLY)	Bulletin No.: 07-003/18
	Last Issued: 04/20/2018

BULLETIN NOTES

This bulletin supersedes the previously issued bulletin(s) listed below. The changes are noted in Red text.

Previous TSBs:	Date(s) Issued:
07-001/14	12/03/2014

APPLICABLE MODEL(S)/VINS

2013-2015 CX-5 vehicles equipped with manual type air conditioning system with VINs lower than JM3KE*****549198 (produced before November 3, 2014)

DESCRIPTION

Some customers may complain about one or both of the following symptoms:

- When selecting the "Defroster Vents" position (2) with the Mode Selector Dial (1), the dial does not stay in the "Defroster Vents" position and returns to the "Defroster/Floor Vents" position (3).
- When rotating the Mode Selector Dial (1) to the "Defroster Vents" position (2), it may be difficult to tell if the Mode Selector Dial is firmly in the "Defroster Vents" position.

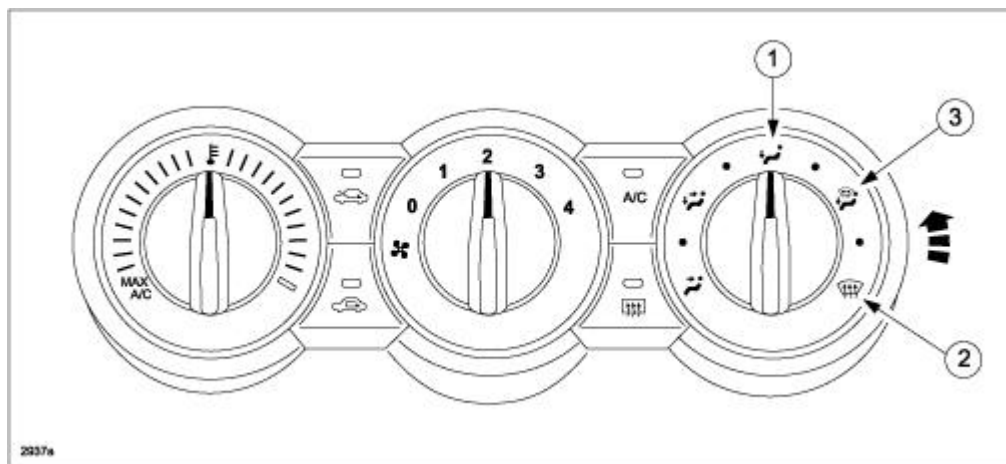

CONSUMER NOTICE: The information and instructions in this bulletin are intended for use by skilled technicians. Mazda technicians utilize the proper tools/equipment and take training to correctly and safely maintain Mazda vehicles. These instructions should not be performed by "do-it-yourselfers." Customers should not assume this bulletin applies to their vehicle or that their vehicle will develop the described concern. To determine if the information applies, customers should contact their nearest authorized Mazda dealership. Mazda North American Operations reserves the right to alter the specifications and contents of this bulletin without obligation or advance notice. All rights reserved. No part of this bulletin may be reproduced in any form or by any means, electronic or mechanical---including photocopying and recording and the use of any kind of information storage and retrieval system ---without permission in writing.

This concern may be due to a production variation. Some of the mode control wires (1) may be too long to transmit movement from the mode selector dial to the link (2). The length of the mode control wire has been shortened to eliminate this concern.

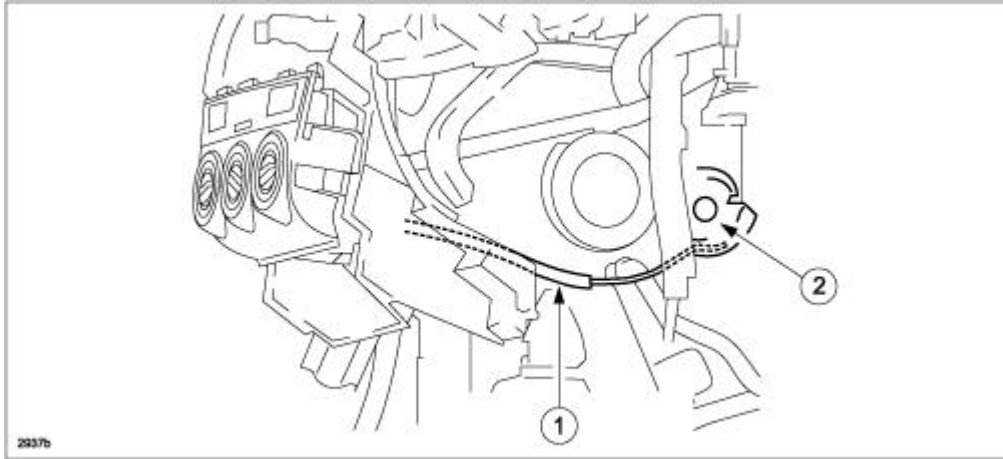

Customers having this concern should have their vehicle repaired using the following repair procedure.

REPAIR PROCEDURE

1. Verify the customer concern.
2. Replace the mode control wire with a modified one according to the instructions on MGSS online or the Workshop Manual (section 07-40 CLIMATE CONTROL UNIT REMOVAL/INSTALLATION [MANUAL AIR CONDITIONER])

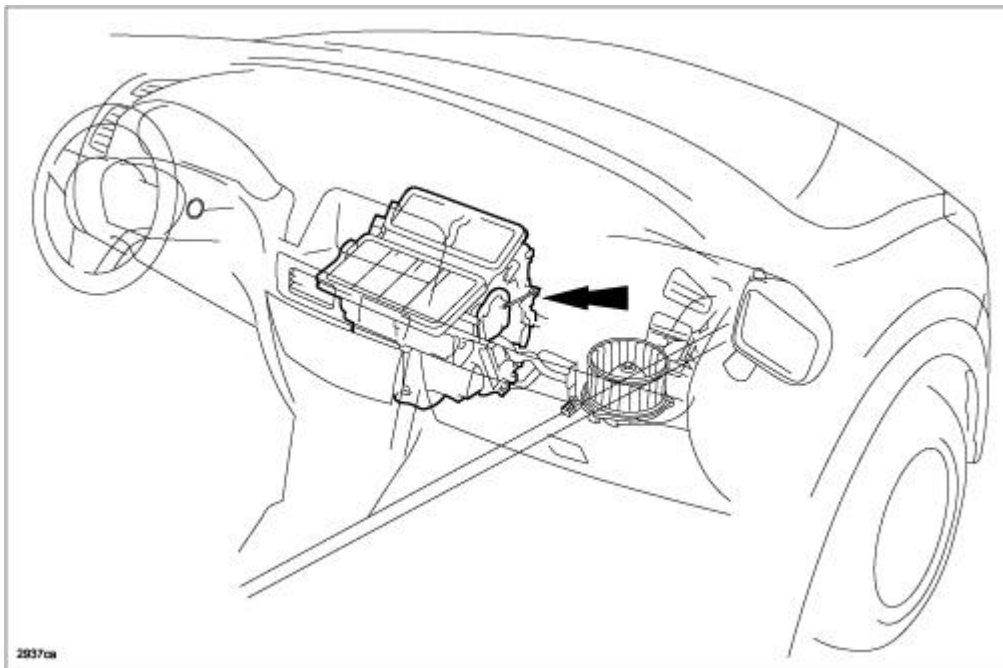

CONSUMER NOTICE: The information and instructions in this bulletin are intended for use by skilled technicians. Mazda technicians utilize the proper tools/equipment and take training to correctly and safely maintain Mazda vehicles. These instructions should not be performed by "do-it-yourselfers." Customers should not assume this bulletin applies to their vehicle or that their vehicle will develop the described concern. To determine if the information applies, customers should contact their nearest authorized Mazda dealership. Mazda North American Operations reserves the right to alter the specifications and contents of this bulletin without obligation or advance notice. All rights reserved. No part of this bulletin may be reproduced in any form or by any means, electronic or mechanical---including photocopying and recording and the use of any kind of information storage and retrieval system ---without permission in writing.

3. Rotate the mode selector dial so it stays firmly in the “Defroster Vents” position.
4. Verify the mode is correctly selected by checking the position of the air flow mode main link (1), as shown below.
 - (2) OK: If the boss is visible through the square hole, proceed to Step 7.
 - (3) OK: If only half of the boss is visible through the square hole, proceed to Step 7.
 - (4) NG: If the boss is not visible through the square hole, proceed to Step 5.

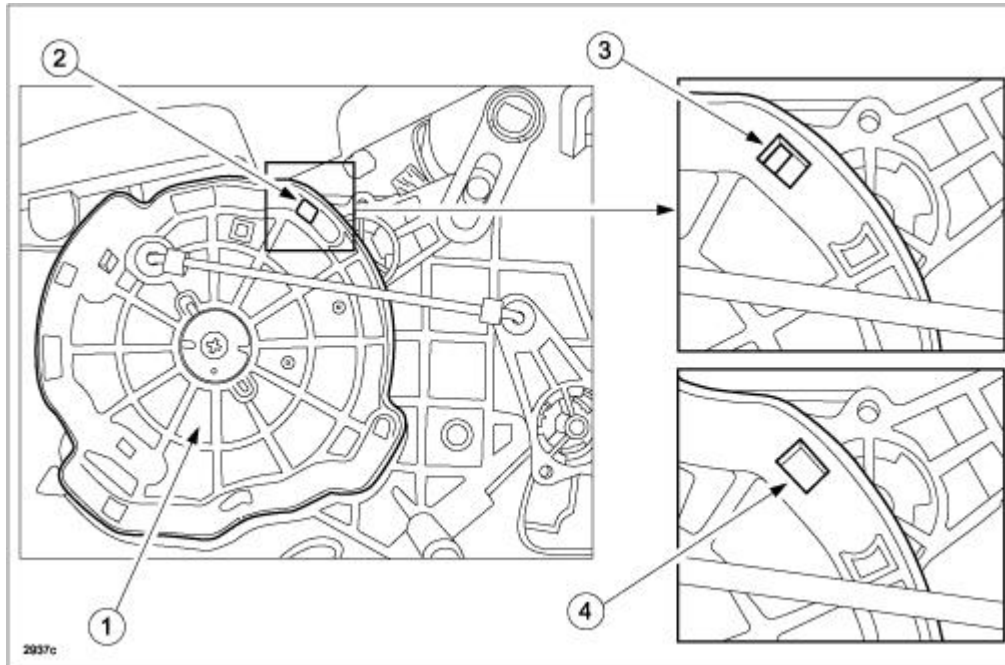

5. Remove the E-ring (1) at the tip of the mode selector wire and reinstall it to a maximum of 2 mm away (2) from the original position (3), as shown below.

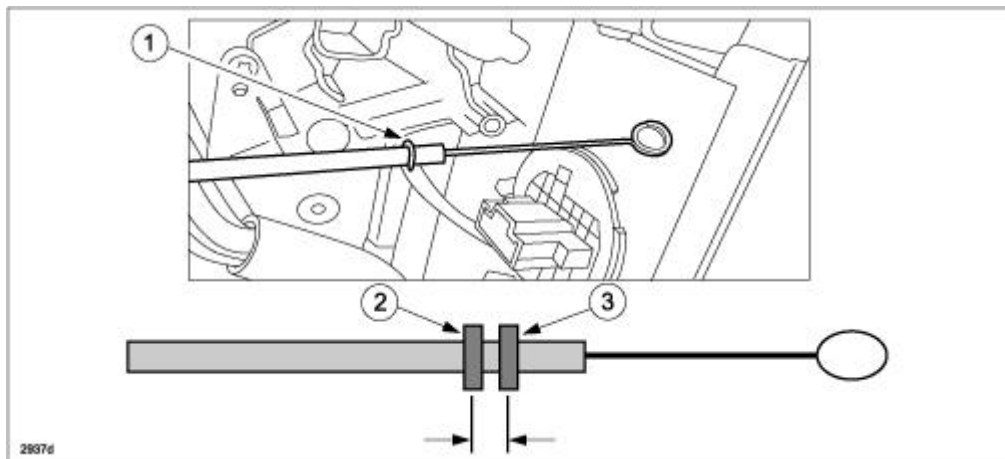

CAUTION: If the E-ring is moved too far away from the original position, it will become difficult to select other “VENT” modes.

CONSUMER NOTICE: The information and instructions in this bulletin are intended for use by skilled technicians. Mazda technicians utilize the proper tools/equipment and take training to correctly and safely maintain Mazda vehicles. These instructions should not be performed by “do-it-yourselfers.” Customers should not assume this bulletin applies to their vehicle or that their vehicle will develop the described concern. To determine if the information applies, customers should contact their nearest authorized Mazda dealership. Mazda North American Operations reserves the right to alter the specifications and contents of this bulletin without obligation or advance notice. All rights reserved. No part of this bulletin may be reproduced in any form or by any means, electronic or mechanical—including photocopying and recording and the use of any kind of information storage and retrieval system ---without permission in writing.

6. Repeat Step 3 to verify the "Defroster Vents" mode stays firmly set in the proper position.
7. Apply grease to the inner channels of the air flow mode main link (1) according to steps a - i below.

NOTE: Use the excess grease on the link.

- a. Before removing the air flow mode main link, place an arrow marking (2) to identify the upward position.

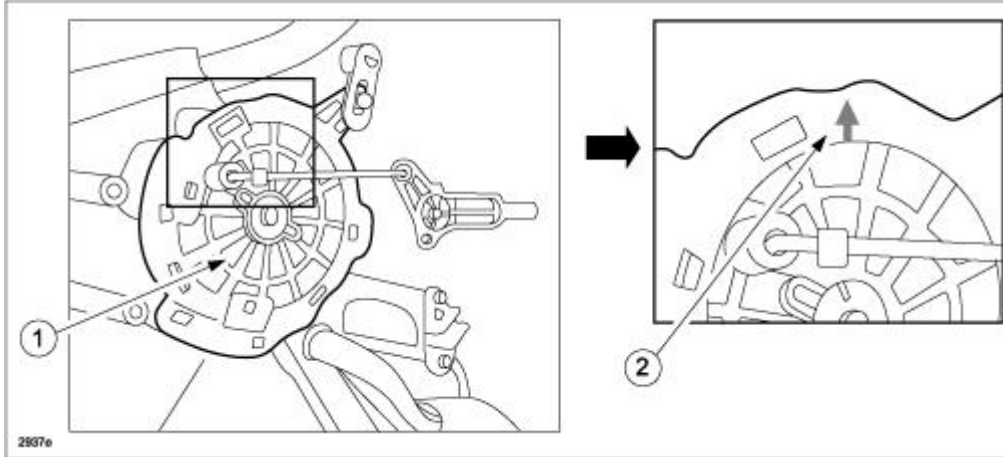

- b. Disconnect the rod from the air flow mode main link.

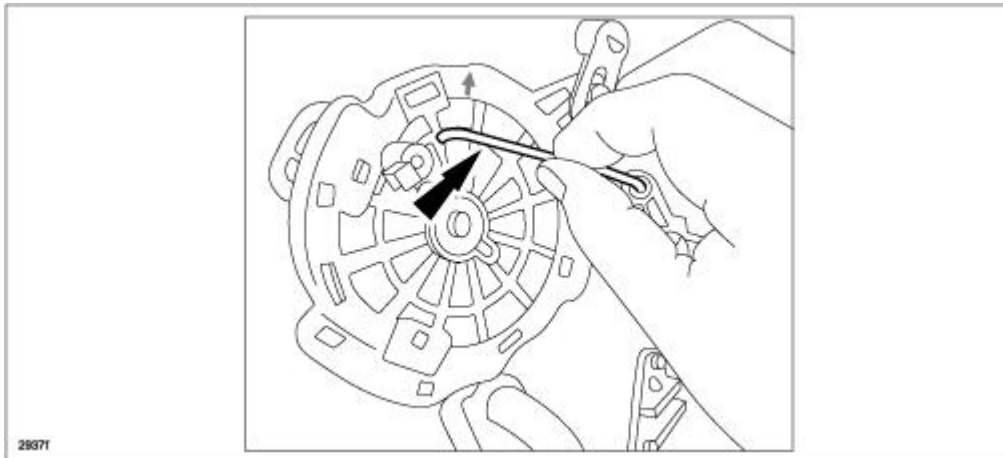

- c. Remove the screw (1), then remove the air flow mode main link (2).

CONSUMER NOTICE: The information and instructions in this bulletin are intended for use by skilled technicians. Mazda technicians utilize the proper tools/equipment and take training to correctly and safely maintain Mazda vehicles. These instructions should not be performed by "do-it-yourselfers." Customers should not assume this bulletin applies to their vehicle or that their vehicle will develop the described concern. To determine if the information applies, customers should contact their nearest authorized Mazda dealership. Mazda North American Operations reserves the right to alter the specifications and contents of this bulletin without obligation or advance notice. All rights reserved. No part of this bulletin may be reproduced in any form or by any means, electronic or mechanical---including photocopying and recording and the use of any kind of information storage and retrieval system ---without permission in writing.

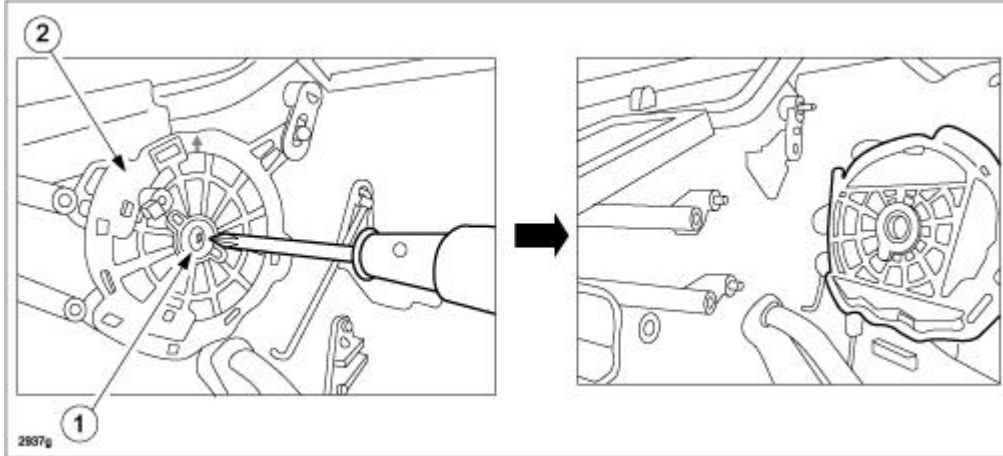

d. Remove any dust or foreign material from the inner side of the air flow mode main link.

e. Apply grease to each inner channel (1, 2, 3) highlighted below, using a screwdriver (or equivalent tool).

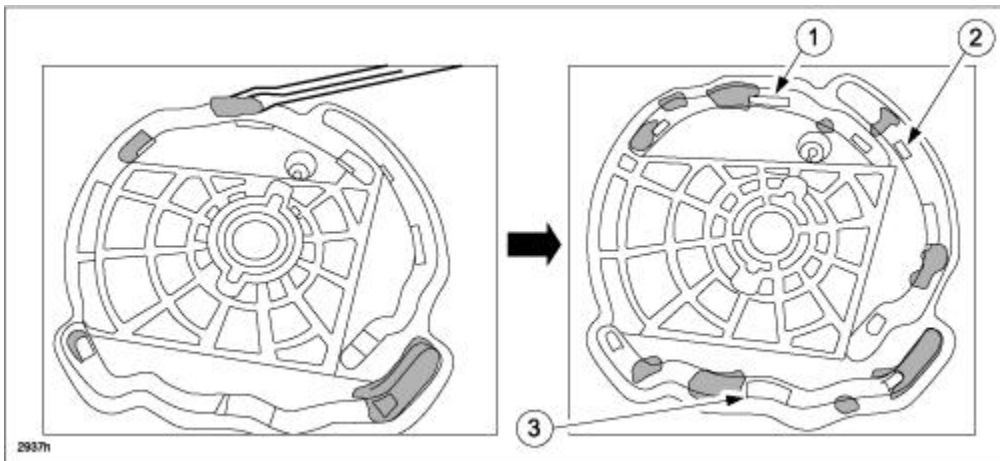

f. Install the air flow mode main link (with marked arrow (1) pointing upward) and engage the link for each mode door into the respective air flow mode main link channel.

IMPORTANT: Ensure that links 1, 2 and 3 are correctly engaged to channels 1, 2 and 3.

CONSUMER NOTICE: The information and instructions in this bulletin are intended for use by skilled technicians. Mazda technicians utilize the proper tools/equipment and take training to correctly and safely maintain Mazda vehicles. These instructions should not be performed by "do-it-yourselfers." Customers should not assume this bulletin applies to their vehicle or that their vehicle will develop the described concern. To determine if the information applies, customers should contact their nearest authorized Mazda dealership. Mazda North American Operations reserves the right to alter the specifications and contents of this bulletin without obligation or advance notice. All rights reserved. No part of this bulletin may be reproduced in any form or by any means, electronic or mechanical---including photocopying and recording and the use of any kind of information storage and retrieval system ---without permission in writing.

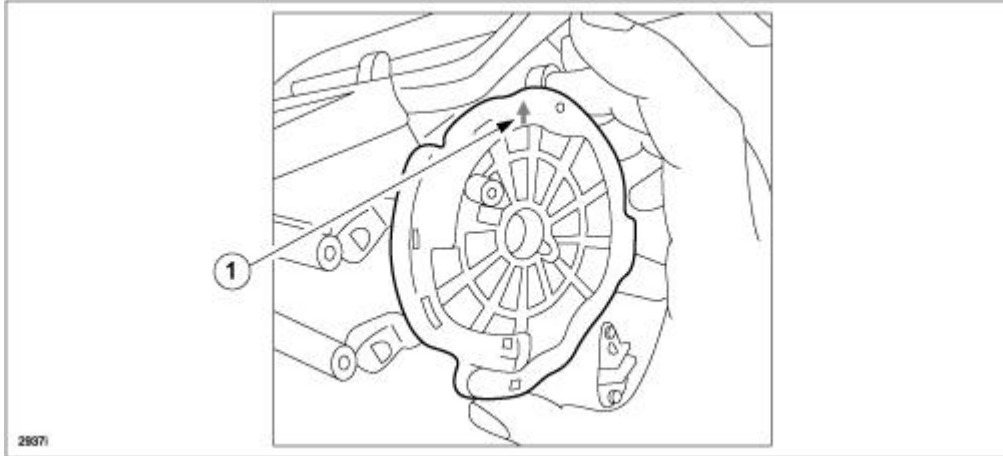

g. Install the collar (1) and tighten the screw.

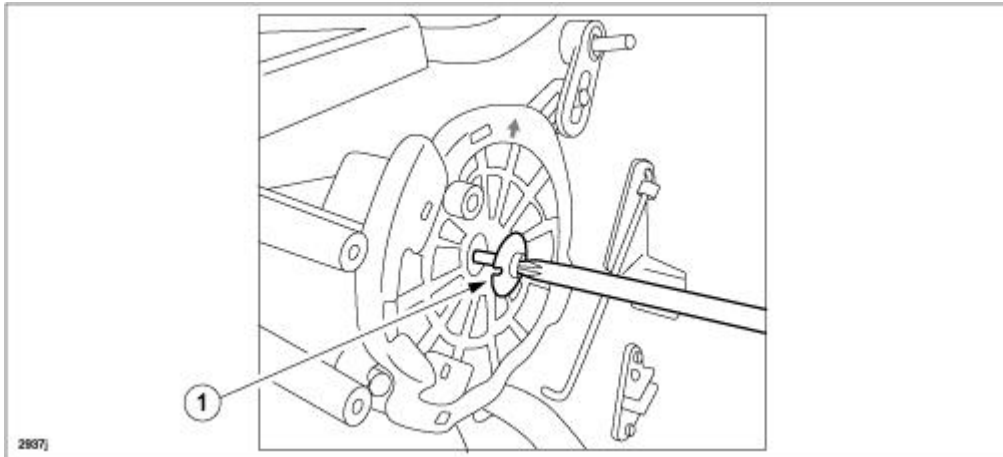

h. Rotate the air flow mode main link (1) several times back and forth between the “VENT” and “DEF” positions to verify the mode can be switched properly.

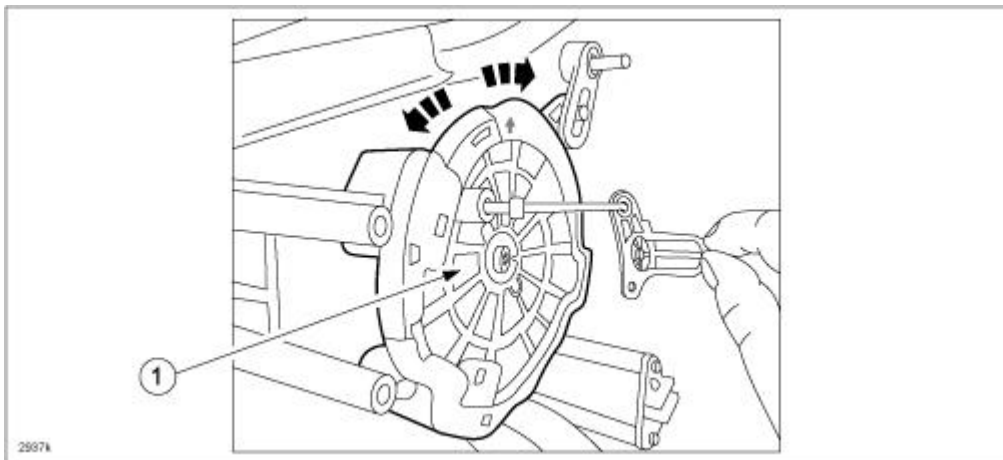

CONSUMER NOTICE: The information and instructions in this bulletin are intended for use by skilled technicians. Mazda technicians utilize the proper tools/equipment and take training to correctly and safely maintain Mazda vehicles. These instructions should not be performed by “do-it-yourselfers.” Customers should not assume this bulletin applies to their vehicle or that their vehicle will develop the described concern. To determine if the information applies, customers should contact their nearest authorized Mazda dealership. Mazda North American Operations reserves the right to alter the specifications and contents of this bulletin without obligation or advance notice. All rights reserved. No part of this bulletin may be reproduced in any form or by any means, electronic or mechanical---including photocopying and recording and the use of any kind of information storage and retrieval system ---without permission in writing.

- i. Rotate the air flow mode main link back and forth several more times to allow the grease to spread.

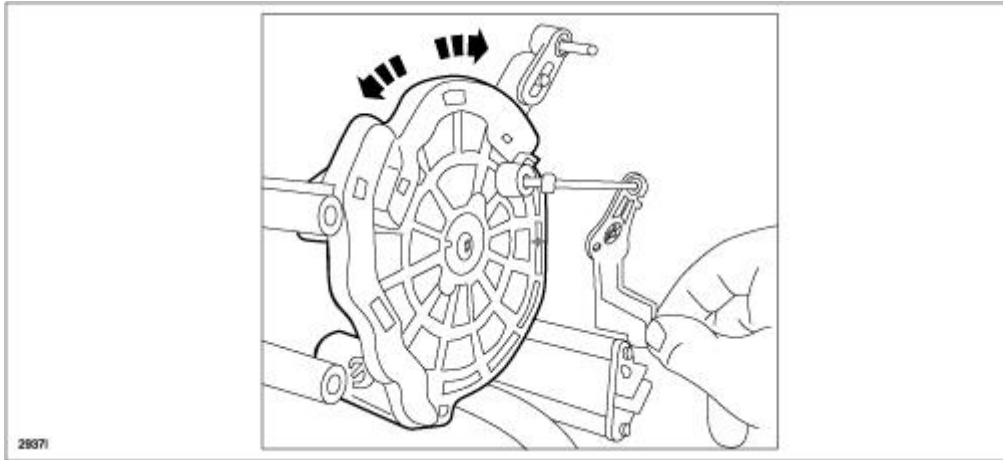

8. Reinstall all remaining parts in reverse order according to the instructions on MGSS online or the Workshop Manual (section 07-40 CLIMATE CONTROL UNIT REMOVAL/INSTALLATION [MANUAL AIR CONDITIONER]).
9. Verify the repair.

CONSUMER NOTICE: The information and instructions in this bulletin are intended for use by skilled technicians. Mazda technicians utilize the proper tools/equipment and take training to correctly and safely maintain Mazda vehicles. These instructions should not be performed by "do-it-yourselfers." Customers should not assume this bulletin applies to their vehicle or that their vehicle will develop the described concern. To determine if the information applies, customers should contact their nearest authorized Mazda dealership. Mazda North American Operations reserves the right to alter the specifications and contents of this bulletin without obligation or advance notice. All rights reserved. No part of this bulletin may be reproduced in any form or by any means, electronic or mechanical---including photocopying and recording and the use of any kind of information storage and retrieval system ---without permission in writing.

PARTS INFORMATION

Part Number	Description	Qty.	Notes
KD45-61-C35A	Mode Control Wire	1	Manual A/C System

WARRANTY INFORMATION**NOTE:**

- This warranty information applies only to verified customer complaints on vehicles eligible for warranty repair.
- This repair will be covered under Mazda's New Vehicle Limited Warranty term.
- Additional diagnostic time cannot be claimed for this repair.

Warranty Type	A
Symptom Code	43
Damage Code	97
Part Number Main Cause	KD45-61-C35A
Quantity	1 or 0*
Operation Number / Labor Hours:	XXKBCRX / 0.8 Hrs.

NOTE: * If the mode control wire was previously replaced with part number KD45-61-C35A, use Quantity "0".

CONSUMER NOTICE: The information and instructions in this bulletin are intended for use by skilled technicians. Mazda technicians utilize the proper tools/equipment and take training to correctly and safely maintain Mazda vehicles. These instructions should not be performed by "do-it-yourselfers." Customers should not assume this bulletin applies to their vehicle or that their vehicle will develop the described concern. To determine if the information applies, customers should contact their nearest authorized Mazda dealership. Mazda North American Operations reserves the right to alter the specifications and contents of this bulletin without obligation or advance notice. All rights reserved. No part of this bulletin may be reproduced in any form or by any means, electronic or mechanical---including photocopying and recording and the use of any kind of information storage and retrieval system ---without permission in writing.