

New Curtain Style Airbags

Attention: **Service Personnel**

Vehicle Type: **911 (991-II) Coupe / 718 Cayman (982)**

Model Year: **As of calendar week (CW) 22, 2017**

Concern: **Production change**

Information: There was a production change to the airbag system in sports cars (991 II/982) starting in CW22/2017. All Coupe versions now have a curtain style head airbag, as opposed to the head airbag previously (still in Cabriolet versions) found in the doors.

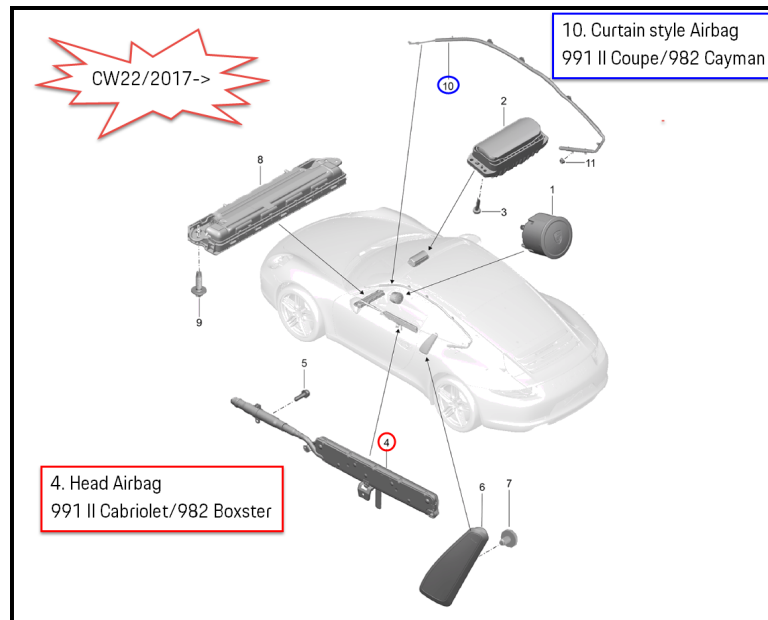

The new location can be easily ascertained by the location of the "Airbag" script as shown in the images on the next page.

Information
(cont'd):



718 Cayman (982)



911 (991-II) Coupe



911 (991-II) Cabriolet / 718 Boxster (982)

Important Notice: Technical Bulletins issued by Porsche Cars North America, Inc. are intended only for use by professional automotive technicians who have attended Porsche service training courses. They are written to inform those technicians of conditions that may occur on some Porsche vehicles, or to provide information that could assist in the proper servicing of a vehicle. Porsche special tools may be necessary in order to perform certain operations identified in these bulletins. Use of tools and procedures other than those Porsche recommends in these bulletins may be detrimental to the safe operation of your vehicle, and may endanger the people working on it. Properly trained Porsche technicians have the equipment, tools, safety instructions, and know-how to do the job properly and safely. Part numbers listed in these bulletins are for reference only. The work procedures updated electronically in the Porsche PIWIS diagnostic and testing device take precedence and, in the event of a discrepancy, the work procedures in the PIWIS Tester are the ones that must be followed.
