

# Wind (Reed/Buzz) Noise From Front Doors - Cross-Wind Conditions

**Service Category** Vehicle Exterior

**Section** Door/Hatch

**Market** USA

Toyota Supports  
ASE Certification 

## Applicability

YEAR(S)	MODEL(S)	ADDITIONAL INFORMATION
2012 - 2017	Tacoma	

### REVISION NOTICE

January 22, 2018 Rev1:

- **Applicability has been updated to include 2016 – 2017 model year Tacoma vehicles.**
  - **The Warranty Information, Parts Information, and Repair Procedure sections have been updated.**
- Any previous printed versions of this bulletin should be discarded.**

## Introduction

Some 2012 – 2017 model year Tacoma vehicles may exhibit a reed/buzz type wind noise from the LH and/or RH front door when driving in high cross-wind areas. Follow the Repair Procedure in this bulletin to address this condition.

## Warranty Information

OP CODE	MODEL YEAR	DESCRIPTION	TIME	OFF	T1	T2
BD1614	2012 – 2017	R & R Weatherstrip, FR Door, RH (Access Cab)	0.6	67861-04051	91	57
BD1614A		R & R Weatherstrip, FR Door, LH (Access Cab)		67862-04051		
BD1615		R & R Weatherstrip, FR Door, RH (Double Cab)		67861-04061 67861-04070		
BD1615A		R & R Weatherstrip, FR Door, LH (Double Cab)		67862-04061 67862-04070		

### APPLICABLE WARRANTY

- **This repair is covered under the Toyota Basic Warranty. This warranty is in effect for 36 months or 36,000 miles, whichever occurs first, from the vehicle's in-service date.**
- **Warranty application is limited to occurrence of the specified condition described in this bulletin.**

## Wind (Reed/Buzz) Noise From Front Doors - Cross-Wind Conditions

### Parts Information

PART NUMBER		MODEL YEAR	PART NAME	QTY
PREVIOUS	NEW			
67861-04051	67861-04052	2012 – 2017	Weatherstrip, FR Door, RH (Access Cab)	1
67862-04051	67862-04052		Weatherstrip, FR Door, LH (Access Cab)	1
67861-04061	67861-04062	2012 – 2015	Weatherstrip, FR Door, RH (Double Cab)	1
67862-04061	67862-04062		Weatherstrip, FR Door, LH (Double Cab)	1
67861-04070	67861-04071	2016 – 2017	Weatherstrip, FR Door, RH (Double Cab)	1
67862-04070	67862-04071		Weatherstrip, FR Door, LH (Double Cab)	1

### Required Tools & Equipment

SPECIAL SERVICE TOOLS (SST)	PART NUMBER	QTY
Plastic Pry Tool Kit*	<a href="#">00002-06020-01</a>	1

\* Essential SST.

#### NOTE

Additional SSTs may be ordered by calling 1-800-933-8335.

### Repair Procedure

#### NOTE

- The reed/buzz noise can be present on both the LH and/or the RH side.
- The following procedure is for the LH side.
- Use the same procedure for the RH side.

1. Test drive the vehicle to confirm the reed/buzz noise from the front door(s).

Is the noise present?

- **YES** — Continue to step 2.
- **NO** — This bulletin does NOT apply. Continue diagnosis using the applicable Repair Manual.

## Wind (Reed/Buzz) Noise From Front Doors - Cross-Wind Conditions

### Repair Procedure (Continued)

2. Remove the front door check assembly.
  - A. Remove the bolt.
  - B. Remove the two nuts and front door check assembly.

Figure 1.

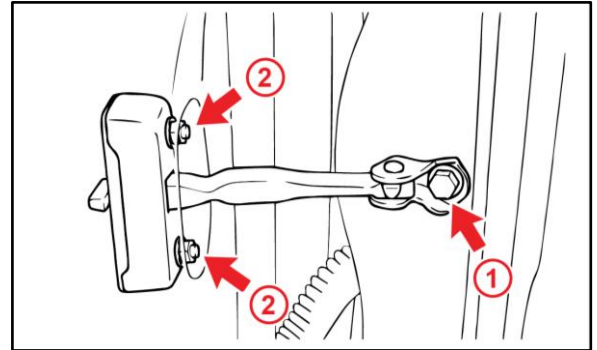



<b>1</b>	<b>Bolt</b>
<b>2</b>	<b>Nut</b>

3. Confirm which cab type is used in the vehicle.
  - **Access Cab** — Continue to step 4.
  - **Double Cab** — Go to step 5.

4. Remove the front door weatherstrip (for access cab).
  - A. Using a clip remover, remove the three clips.
  - B. Using a clip remover, disengage the 33 clips.

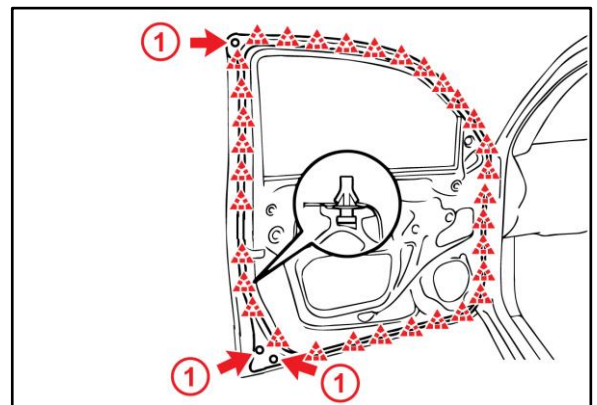
Figure 2.



<b>1</b>	<b>Clip (Three)</b>
	<b>Clip (33)</b>

## Wind (Reed/Buzz) Noise From Front Doors - Cross-Wind Conditions

### Repair Procedure (Continued)

- C. Peel off double-sided tape to remove the front door weatherstrip.

**NOTICE**

Remove ALL of the double-sided tape remaining on the front door panel side.

Figure 3.

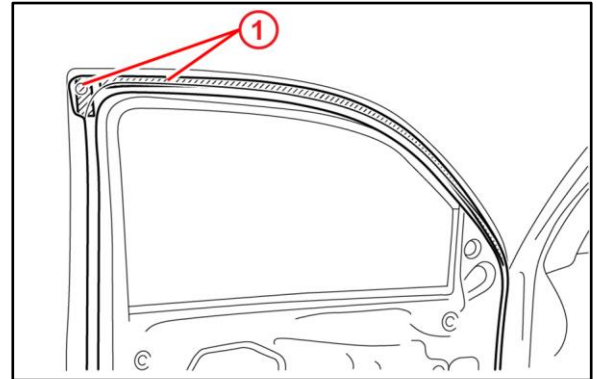

1	Double-sided Tape
---	-------------------

- 5. Remove the front door weatherstrip (for double cab).
  - A. Using a clip remover, remove the clip.
  - B. Using a clip remover, disengage the 33 clips.

Figure 4.

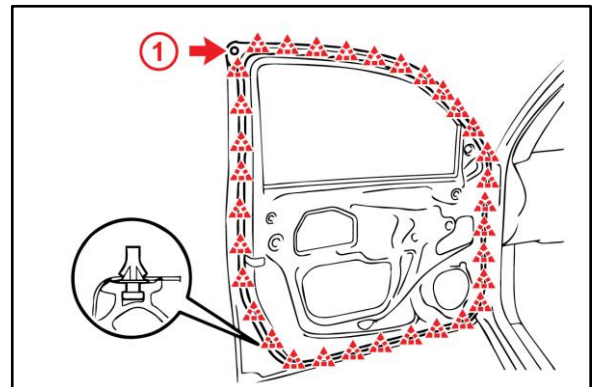

1	Clip (One)
▲	Clips (33)

## Wind (Reed/Buzz) Noise From Front Doors - Cross-Wind Conditions

### Repair Procedure (Continued)

- C. Peel off the double-sided tape to remove the front door weatherstrip.

**NOTICE**

Remove ALL of the double-sided tape remaining on the front door panel side.

Figure 5.

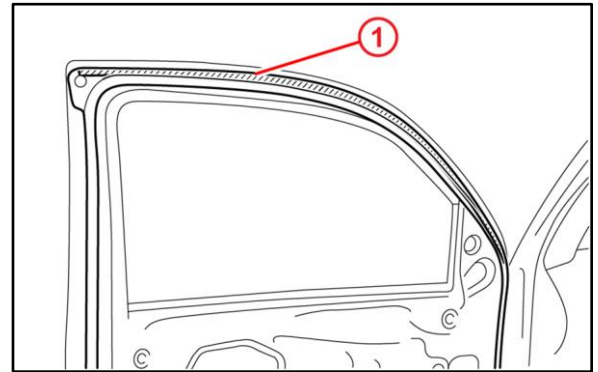

<b>1</b>	<b>Double-sided Tape</b>
----------	--------------------------

6. Install the NEW weatherstrip.

Refer to TIS, applicable model and model year Repair Manual:

- [2012](#) / [2013](#) / [2014](#) Tacoma:  
*Vehicle Exterior – Door Hatch – “Engine Hood / Door: Front Door (w/o Power Window): Reassembly”*
- [2015](#) / [2016](#) / [2017](#) Tacoma:  
*Vehicle Exterior – Door/Hatch – “Engine Hood / Door: Front Door: Reassembly”*

**NOTE**

Pay attention to the location of the double-sided tape and prepare the surface to ensure good tape adhesion.

## Wind (Reed/Buzz) Noise From Front Doors - Cross-Wind Conditions

### Repair Procedure (Continued)

7. Check door fitting for gap/levelness to be within allowable specification (see below). If gap/levelness is outside of specification, the door MUST be refit to specification.

**Figure 6. Clearance Measurements for Access Cab**

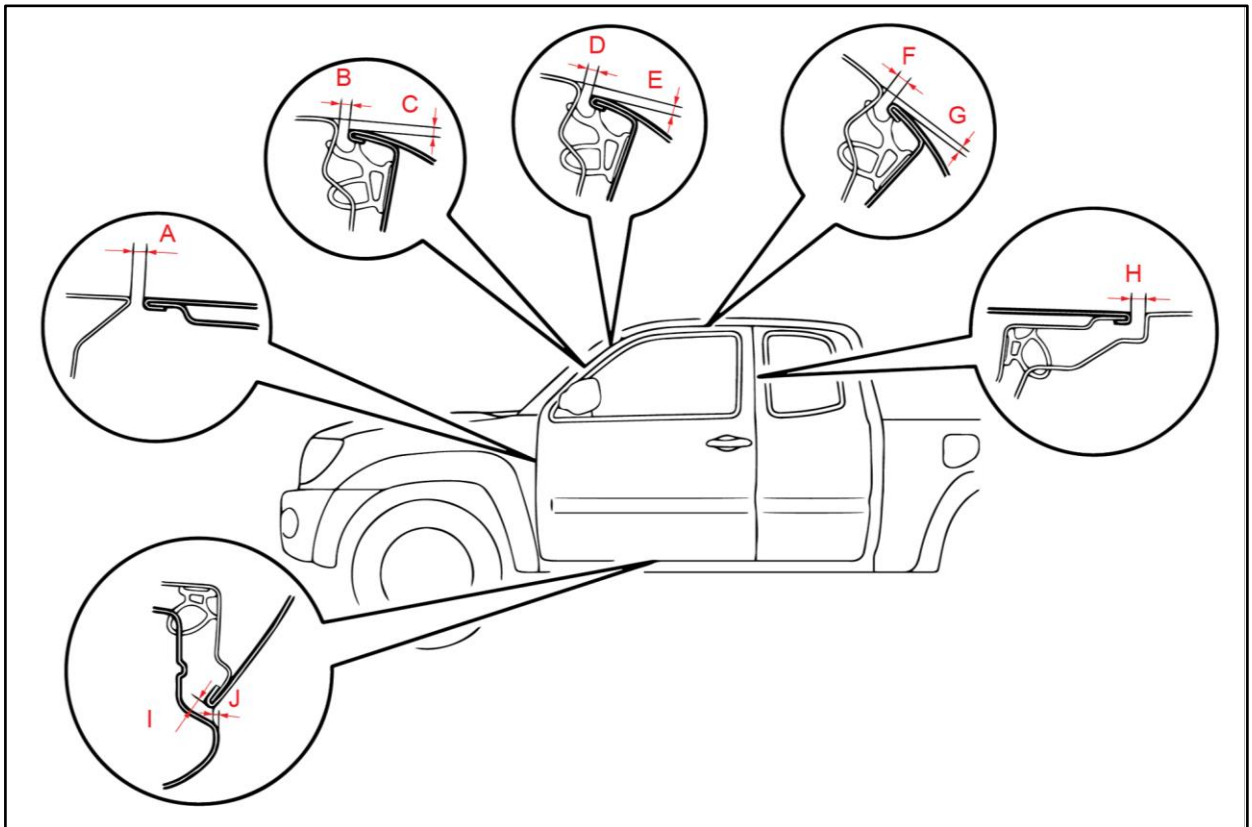

<b>A</b>	3.2 to 6.2 mm (0.126 to 0.244 in.)
<b>B</b>	3.4 to 6.4 mm (0.134 to 0.252 in.)
<b>C</b>	1.1 to 4.1 mm (0.043 to 0.161 in.)
<b>D</b>	3.3 to 6.3 mm (0.130 to 0.248 in.)
<b>E</b>	1.1 to 4.1 mm (0.043 to 0.161 in.)

<b>F</b>	3.3 to 6.3 mm (0.130 to 0.248 in.)
<b>G</b>	0.7 to 3.7 mm (0.028 to 0.146 in.)
<b>H</b>	2012 – 2015: 3.5 to 6.5 mm (0.138 to 0.256 in.) 2016 – 2017: 4.5 to 7.5 mm (0.177 to 0.295 in.)
<b>I</b>	3.5 to 6.5 mm (0.138 to 0.256 in.)
<b>J</b>	0.5 to 3.5 mm (0.020 to 0.138 in.)

## Wind (Reed/Buzz) Noise From Front Doors - Cross-Wind Conditions

### Repair Procedure (Continued)

**Figure 7. Clearance Measurements for Double Cab**

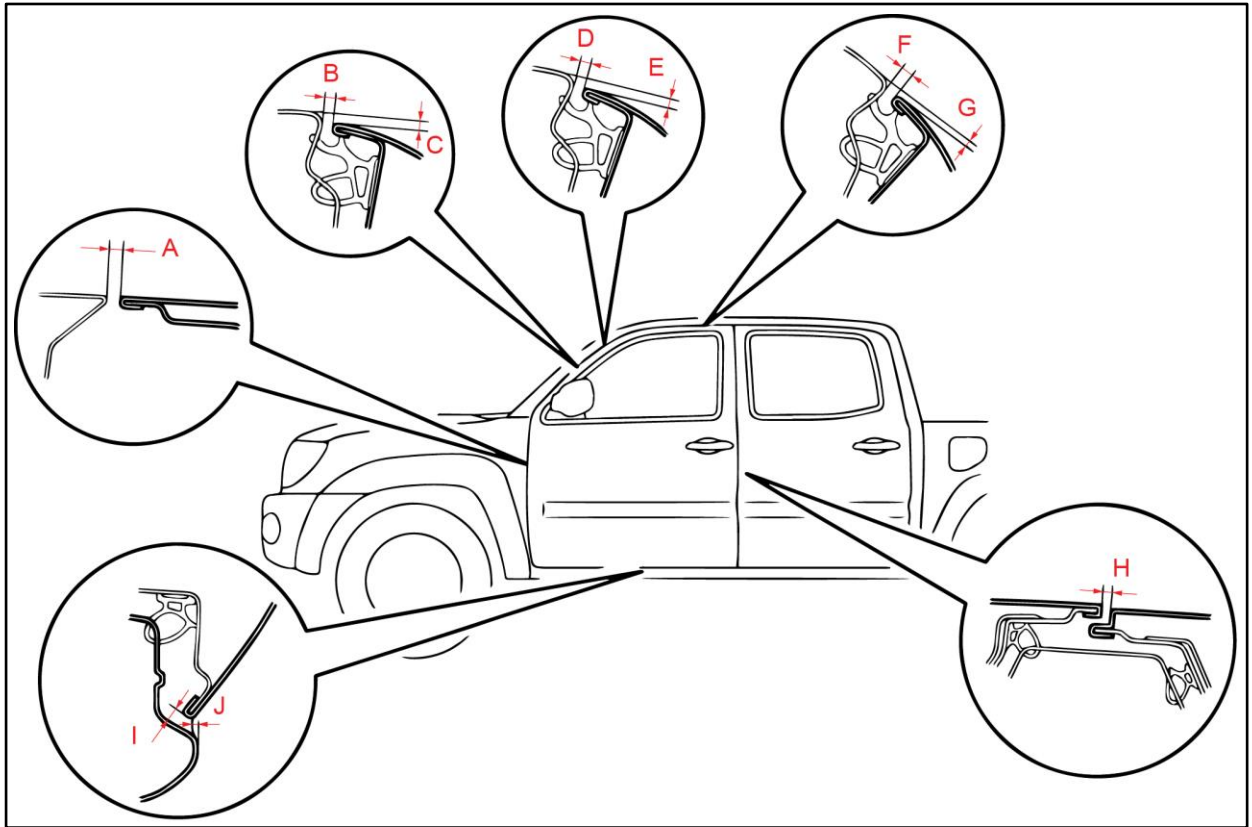

<b>A</b>	3.2 to 6.2 mm (0.126 to 0.244 in.)
<b>B</b>	3.4 to 6.4 mm (0.134 to 0.252 in.)
<b>C</b>	1.1 to 4.1 mm (0.043 to 0.161 in.)
<b>D</b>	3.3 to 6.3 mm (0.130 to 0.248 in.)
<b>E</b>	1.1 to 4.1 mm (0.043 to 0.161 in.)

<b>F</b>	3.3 to 6.3 mm (0.130 to 0.248 in.)
<b>G</b>	0.7 to 3.7 mm (0.028 to 0.146 in.)
<b>H</b>	3.5 to 6.5 mm (0.138 to 0.256 in.)
<b>I</b>	3.5 to 6.5 mm (0.138 to .256 in.)
<b>J</b>	0.5 to 3.5 mm (0.020 to 0.138 in.)

8. Test drive the vehicle to confirm that the reed/buzz noise is no longer present.