



---

# SERVICE BULLETIN

---

Classification: EC18-003	Reference: NTB18-016	Date: February 27, 2018
-----------------------------	-------------------------	----------------------------

## 2018 PATHFINDER; MIL ON WITH DTC P34A5, AND/OR P34A9 STORED

**APPLIED VEHICLES:** 2018 Pathfinder (R52)  
**APPLIED DATE:** Built before December 18<sup>th</sup>, 2017

### IF YOU CONFIRM

MIL is ON with one or both of the following DTCs:

- P34A5 (A camshaft posi actuator temp sens B1)
- P34A9 (A camshaft posi actuator temp sens B2)

### And

Outside ambient temperature was near or below freezing (32°F) when the DTCs were stored.

**NOTE:** If any VTC DTCs other than P34A5 and/or P34A9 are also stored (example: P0011, P0021), those DTCs should be diagnosed and resolved first.

### ACTION

Replace the electric intake valve timing control module (see Figure 1 on Page 2).

- Electric intake valve timing control module is listed in the Parts Information of this bulletin.
- Refer to the Electronic Service Manual (ESM), section **ENGINE > ENGINE CONTROL SYSTEM**, for replacement information.
- Make sure to perform Electric IVT Control Actuator Position Learning after replacement of the module.

Nissan Bulletins are intended for use by qualified technicians, not 'do-it-yourselfers'. Qualified technicians are properly trained individuals who have the equipment, tools, safety instruction, and know-how to do a job properly and safely. NOTE: If you believe that a described condition may apply to a particular vehicle, DO NOT assume that it does. See your Nissan dealer to determine if this applies to your vehicle.

# Electric Intake Valve Timing Control Module Location

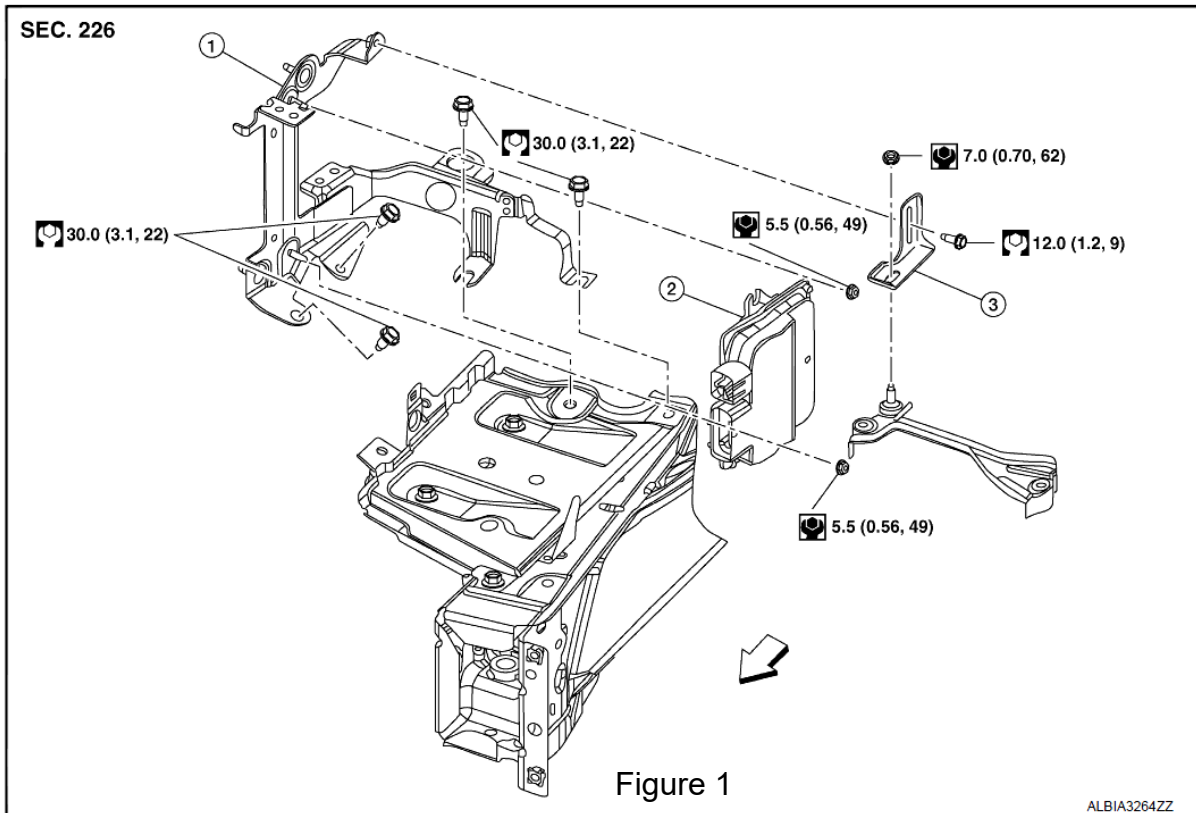

- 1. Electric intake valve timing control module bracket
- 2. Electric intake valve timing control module
- 3. ECM cover

← Front

⊗ : Always replace after every disassembly.

⊞ : N·m (kg-m, ft-lb)

⊞ : N·m (kg-m, in-lb)

## PARTS INFORMATION

DESCRIPTION	PART NUMBER	QUANTITY
Electric Intake Valve Timing Control Module	237F0-9PJ0A (1)	1

- (1) The new part must either have the green dots as shown in Figure 2 or an “AB” with additional “QR” on the label as shown in Figure 3, to indicate that it has the correct software version.

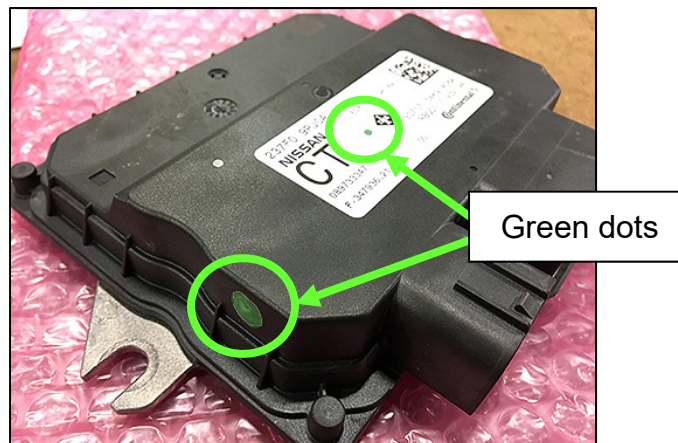

Figure 2



Figure 3

## CLAIMS INFORMATION

Submit a Primary Part (PP) type line claim using the following claims coding:

DESCRIPTION	PFP	OP CODE	SYM	DIA	FRT
Replace VTC Control Module	(1)	DE71AA	ZE	32	(2) (3)

- Reference the electronic parts catalog (FAST), and use the VTC Control Module (237F0-\*\*\*\*\*) as the Primary Failed Part (PFP).
- Reference the current Nissan Warranty Flat Rate Manual and use the indicated Flat Rate Time (FRT).
- The FRT allows adequate time to access DTC codes. No other diagnostic procedures subsequently required. Do Not claim any other diagnostic operation codes with this claim.