

REFERENCE:	Nova Bus Manuals
SECTION:	16: Electrical system
RS N°:	MQR 7621-1362
EFFECTIVE IN PROD.:	LB38 (2017DE)

APPLICATION DEADLINE: 2019MR21
CLAIM REFERENCE NUMBER: WB-4243

SUBJECT:	Decals on hybrid units
JUSTIFICATION:	Dust hides safety decals on hybrid electric units

LEVEL	DESCRIPTION	DIRECT CHARGES		TIME
		LABOUR	MATERIAL	
1	Install two safety decals inside the ESS door.	Nova Bus	Nova Bus	15 min
2	–	–	–	–

MATERIAL

QTY	PART N°	REV.	DESCRIPTION	REPLACES PART N°
LEVEL 1				
1	N91789	–	Decal	–
1	N83281	–	Decal	–
LEVEL 2				
–	–	–	–	–

Materials will be available within 14 days once your order has been placed. To order, please contact Prevost Parts by phone at 1-800-771-6682, by fax at 1-888-668-2555 or by email at prevostparts.commandes@volvo.com. Specify document number, quantity of parts required and shipping address.

DISPOSAL OF PARTS

REMOVED PARTS ARE:	DISCARDED *	RETAINED	* Dispose of the unused parts and the defective parts in accordance with local environmental standards in effect.
	Yes	–	

REVISION HISTORY

REV.	DATE	CHANGE DESCRIPTION	WRITTEN BY
NR	2018FE06	Initial release	Marc Rougeau

CLIENT	ORDER	ROAD NUMBER		VIN (2NVY/4RKY...)		QTY
		FROM	TO	FROM	TO	
Bow Valley Transit - Alberta	L347	1	4	L82W083000175	L82W683000178	4
Brantford - Ontario	L547	10101	10105	L82X6A3000082	L82X3A3000086	5
Central Oklahoma Transportation Authority	L619	—	—	L82X7C3000367	L82X7C3000367	1
CMBC (TransLink) - British Columbia	L412	9401	9401	L82X993000136	L82X993000136	1
CMBC (TransLink) - British Columbia	L454	9402	9470	L82X793000359	L82XX93000453	69
CMBC (TransLink) - British Columbia	L455	9471	9491	L82X093000459	L82X993000489	21
CMBC (TransLink) - British Columbia	L482	9492	9517	L82X894000040	L82X094000064	25
CMBC (TransLink) - British Columbia	L483	9518	9542	L82X294000065	L82X594000089	25
CT Transit - Connecticut	L571	1101	1110	S92YXB4000144	S92Y4B4000169	10
CT Transit - Connecticut	L814	1462	1473	S92LXE4500717	S92L4E4500728	12
CT Transit - Connecticut	L815	1426	1429	S92L0E4500709	S92L0E4500712	4
Démo US	L724	7300	7301	S92Y1D4500275	S92Y3D4500276	2
Duke University - North Carolina	L651	—	—	S92Y1B4000145	S92Y3B4000146	2
Duke University - North Carolina	L938	-	-	L82L8G9775399	L82L0G9775400	2
Duke University - North Carolina	LA38	—	—	L82L9H9775994	L82L9H9775994	1
Grand River Transit - GRT - Ontario	L405	8022	8027	L82W683000259	L82WX83000264	6
Grand River Transit - GRT - Ontario	L599	21116	21118	L82X9B3000465	L82X2B3000467	3
Grand River Transit - GRT - Ontario	L631	21119	21121	L82X4B3000468	L82X2B3000470	3
LYNX - Florida	L725	—	—	S92Y9D4500329	S92Y5D4500330	2
LYNX - Florida	L764	—	—	S92Y7D4500331	S92Y9D4500332	2
LYNX - Florida	L785	—	—	S92L6E4500505	S92L8E4500506	2
Marketing Sales Demo - MSD 1 ISB Hybrid	L548	—	—	L82X5A3000087	L82X5A3000087	1
San Joaquin County - California	L768	—	—	S92L4D4500422	S92L3D4500427	6
SEPTA - Pennsylvania	L728			L82W7D4500335	L82W7D4500335	1
SEPTA - Pennsylvania	L741	7355	7355	S92L4E4500504	S92L4E4500504	1
SEPTA - Pennsylvania	L742	7371	7414	S92L6E4500729	S92L7E4500772	44
SEPTA - Pennsylvania	L743	7356	7370	S92L1E4500489	S92L2E4500503	15
SEPTA - Pennsylvania	L744	8601	8689	L82L7E4500570	L82LXE4500661	89
SEPTA - Pennsylvania	L745	7415	7415	S92L0F4500873	S92L0F4500873	1
SEPTA - Pennsylvania	L746	7416	7454	S92L7F4500952	S92L8F4501012	39
SEPTA - Pennsylvania	L749	7302	7354	S92Y7D4500409	S92L2E4500470	53
SEPTA - Pennsylvania	L861	7300	7484	S92L5G9775188	S92L8G9775220	32
Strathcona County Transit - Alberta	L407	940	943	L82W083000273	L82W683000276	4
Strathcona County Transit - Alberta	L524	3005	3010	L82X593000604	L82X493000609	6

**WARNING**

Follow your internal safety procedures.

PROCEDURE

- 1.1. Park the vehicle on level ground and place the transmission in neutral (N).
- 1.2. Place the master control switch and the battery disconnect switch in the off position. Follow your local lock-out procedure (see Figure 1).

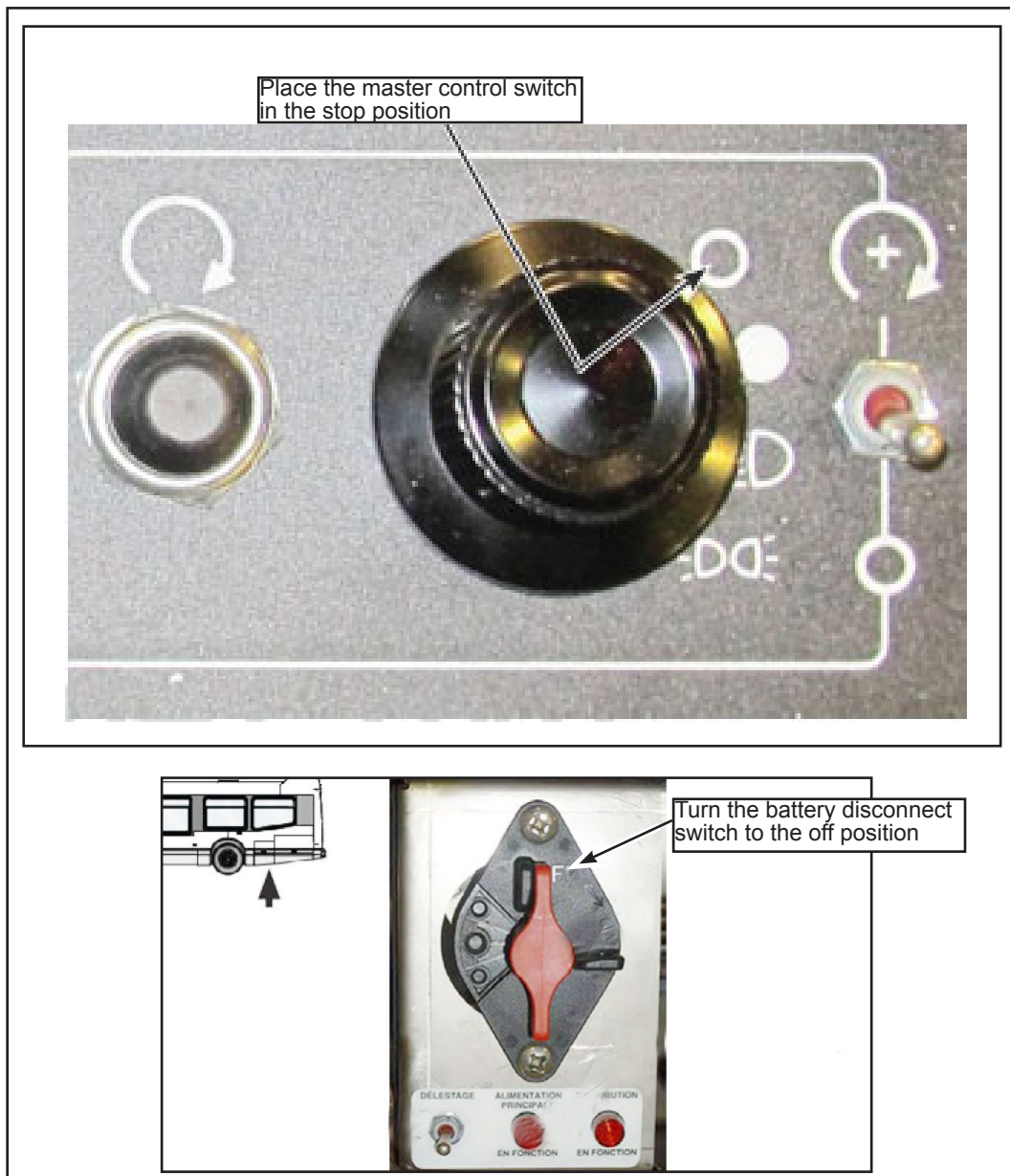

Figure 1 - Place the Master Control Switch and the Battery Disconnect Switch in the Stop Position

- 1.3. Clean the interior of the ESS door before installing decals N91789 and N83281. Install both decals as per the measurements shown below (see Figure 2).

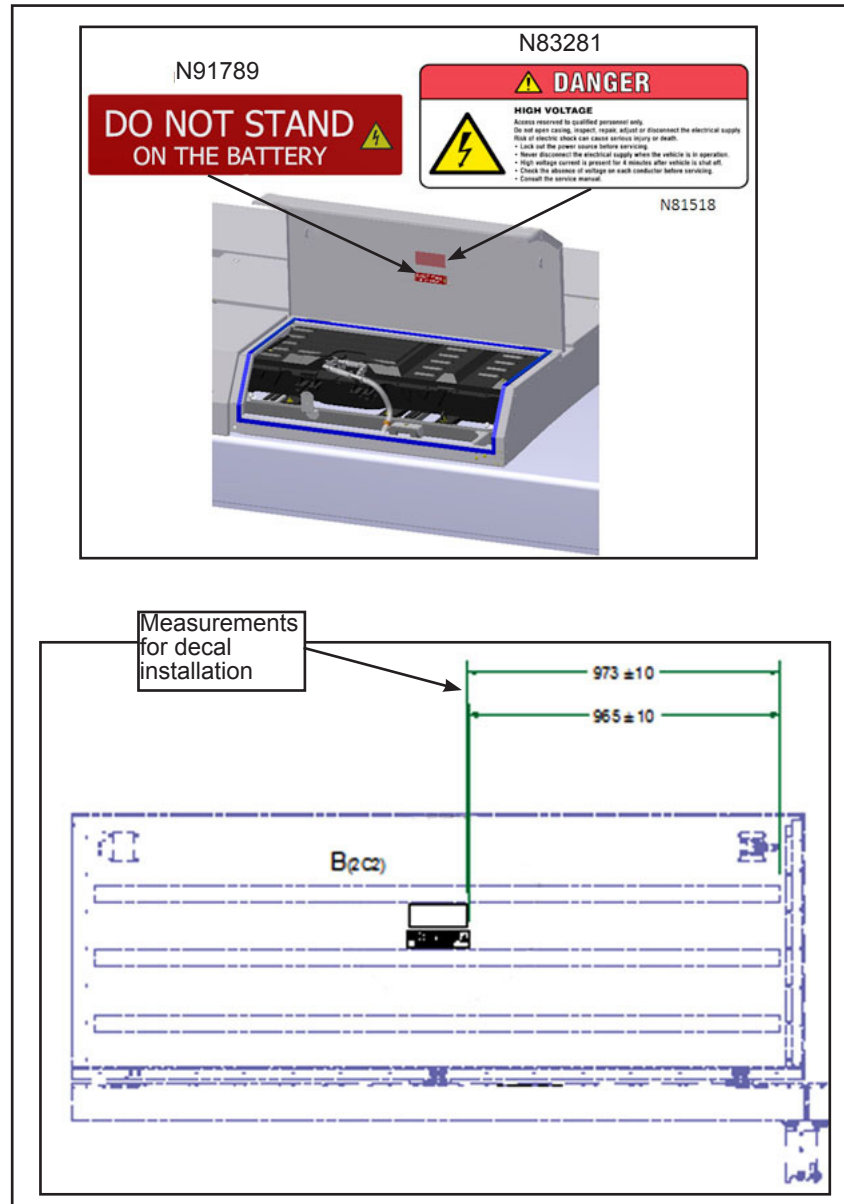

Figure 2 - Clean door and install decals

- 1.4. Return the vehicle to service. ❖