

D/C Cut Fuse Installation During PDS

Service Category General

Section Pre-Delivery Service

Market USA

Lexus Supports
ASE Certification 

Applicability

YEAR(S)	MODEL(S)	ADDITIONAL INFORMATION
2018	LS500, LS500H	

REVISION NOTICE

February 23, 2018 Rev1:

- The Installation Procedure section has been updated.
Any previous printed versions of this bulletin should be discarded.

Introduction

To minimize battery discharge during transportation and storage, the D/C cut fuses (30A) have been removed at the assembly plant and temporarily stored in the blank spaces of the engine compartment Relay Block.

During Pre-Delivery Service (PDS), reinstall the D/C cut fuses (30A) into their original locations.

Warranty Information

OP CODE	DESCRIPTION	TIME	OFF	T1	T2
N/A	Not Applicable to Warranty	–	–	–	–

D/C Cut Fuse Installation During PDS

Installation Procedure

Gasoline Vehicles

With the ignition switch OFF, install the D/C cut fuses (30A) into their original locations in the engine compartment Relay Block.

Figure 1. Vehicles Without Active Stabilizer (Non-F Sport Models)

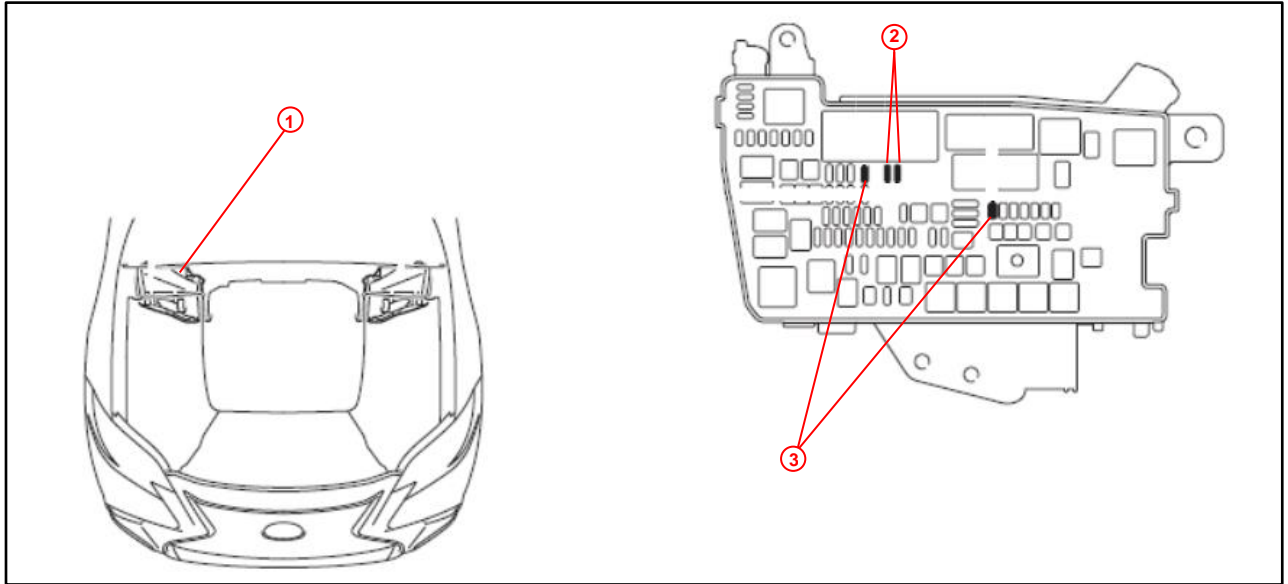

1	Main Relay Block (RHD)
2	D/C Cut Fuses (30A) (Storage Location)

3	Install D/C Cut Fuses (30A) Here
----------	---

NOTE

- While the vehicle is stored at the dealership, disconnect the negative (-) battery terminal to prevent battery discharge. Refer to Service Bulletin No. [L-SB-0108-17](#), "Battery Maintenance During PDS," for battery maintenance information.
- If the D/C cut fuses (30A) are installed with the ignition switch in the "IG-ON" position, Diagnostic Trouble Codes (DTCs) will be detected. Clear the DTCs.

D/C Cut Fuse Installation During PDS

Installation Procedure (continued)

Gasoline Vehicles With Active Stabilizer System (F Sport Models)

1. Push the core of the engine compartment side cover clips and remove them.
2. Remove the engine compartment side cover (upper radiator support seal).

Figure 2.

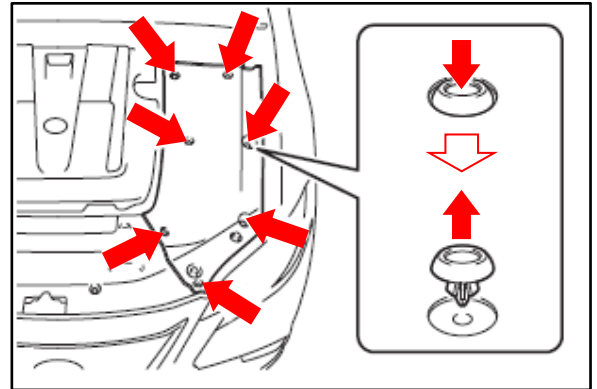

D/C Cut Fuse Installation During PDS

Installation Procedure (continued)

Gasoline Vehicles With Active Stabilizer System (F Sport Models) (continued)

- With the ignition switch OFF, install the D/C cut fuses (30A) into their original locations in the engine compartment Relay Block.

Figure 3. Vehicles With Active Stabilizer Suspension System (F Sport)

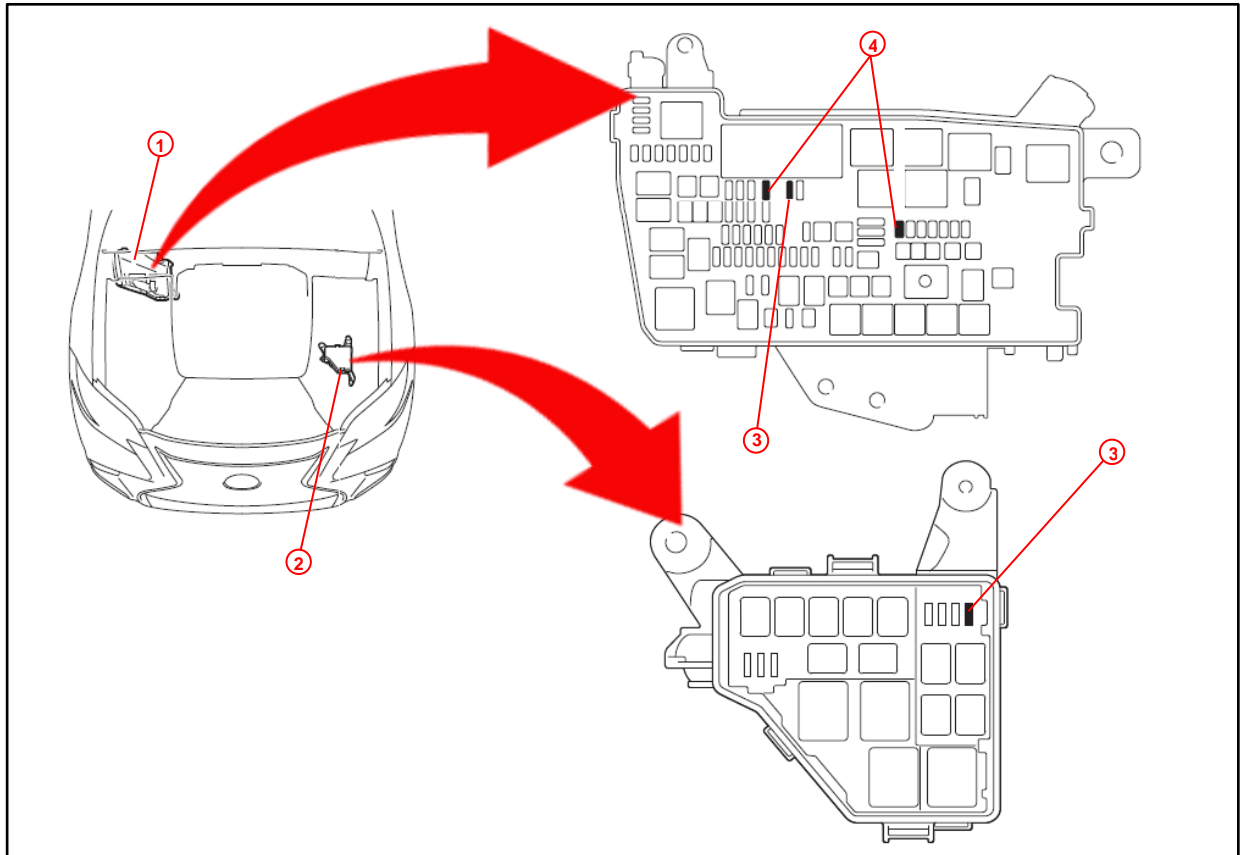

1	Main Relay Block
2	Sub Relay Block

3	D/C Cut Fuses (30A) (Storage Location)
4	Install D/C Cut Fuses (30A) Here

NOTE

- While the vehicle is stored at the dealership, disconnect the negative (-) battery terminal to prevent battery discharge. Refer to Service Bulletin No. [L-SB-0108-17](#), "Battery Maintenance During PDS," for battery maintenance information.
- If the D/C cut fuses (30A) are installed with the ignition switch in the "IG-ON" position, DTCs will be detected. Clear the DTCs.

D/C Cut Fuse Installation During PDS

Installation Procedure (continued)

Gasoline Vehicles With Active Stabilizer System (F Sport Models) (continued)

4. Reinstall the engine compartment side cover (upper radiator support seal).
5. Confirm the master warning light is OFF and there are no warning messages on the multi-informational display.

Hybrid Vehicles

With the ignition switch OFF, install the D/C cut fuses (30A) into their original locations in the engine compartment Relay Block.

Figure 4.

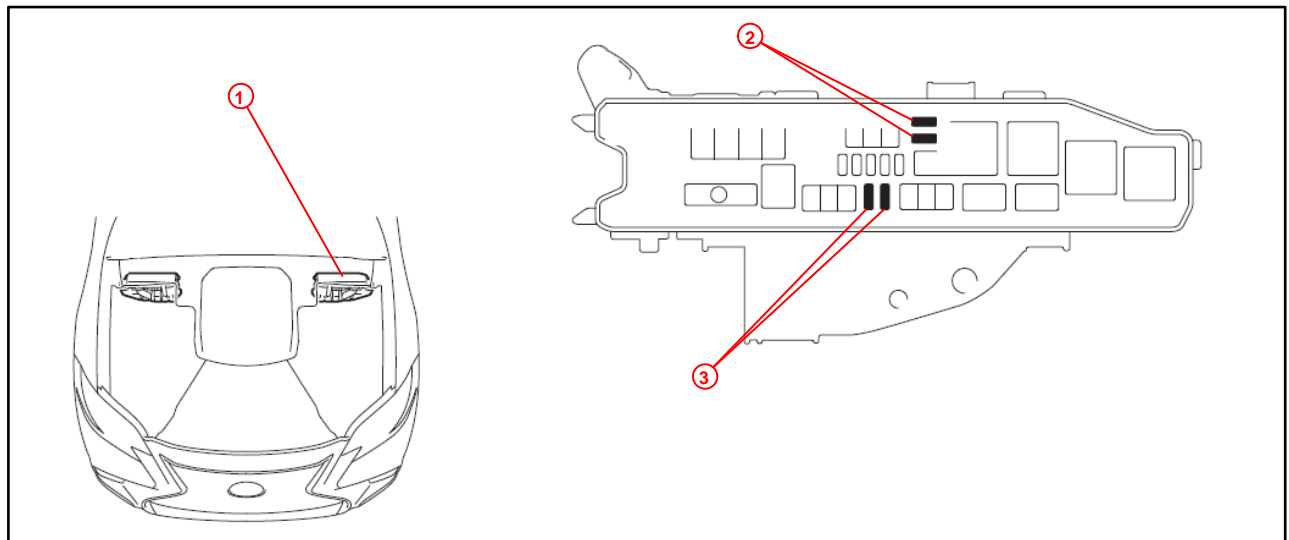

1	Main Relay Block (LHD)
2	D/C Cut Fuses (30A) (Storage Location)

3	Install D/C Cut Fuses (30A) Here
----------	---

NOTE

- While the vehicle is stored at the dealership, disconnect the negative (-) battery terminal to prevent battery discharge. Refer to Service Bulletin No. [L-SB-0108-17](#), "Battery Maintenance During PDS," for battery maintenance information.
- If the D/C cut fuses (30A) are installed with the ignition switch in the "IG-ON" position, DTCs will be detected. Clear the DTCs.