

MODEL: Karma Revero

DATE: January 2018

TITLE: Evaporative Emission System (EVAP) Inspection

First Release

PRIORITY: On Complaint

APPLICABILITY: MY17 and MY18 Revero

MARKET REGION: North America

PURPOSE: Diagnostic aid for indicated trouble codes and MIL on.

The MIL may be illuminated for the diagnostic trouble codes:

- P0497 - EVAP System Low Purge Flow
- P0440 - EVAP System General Fault
- P04EE - EVAP System Very Small Leak Detected - Fuel Tank Side
- P04EF - EVAP System Very Small Leak Detected - Fresh Air Side

In addition to normal diagnostic procedures and tests you may inspect the FTIV Valve connection ensure this is seated and connected properly.

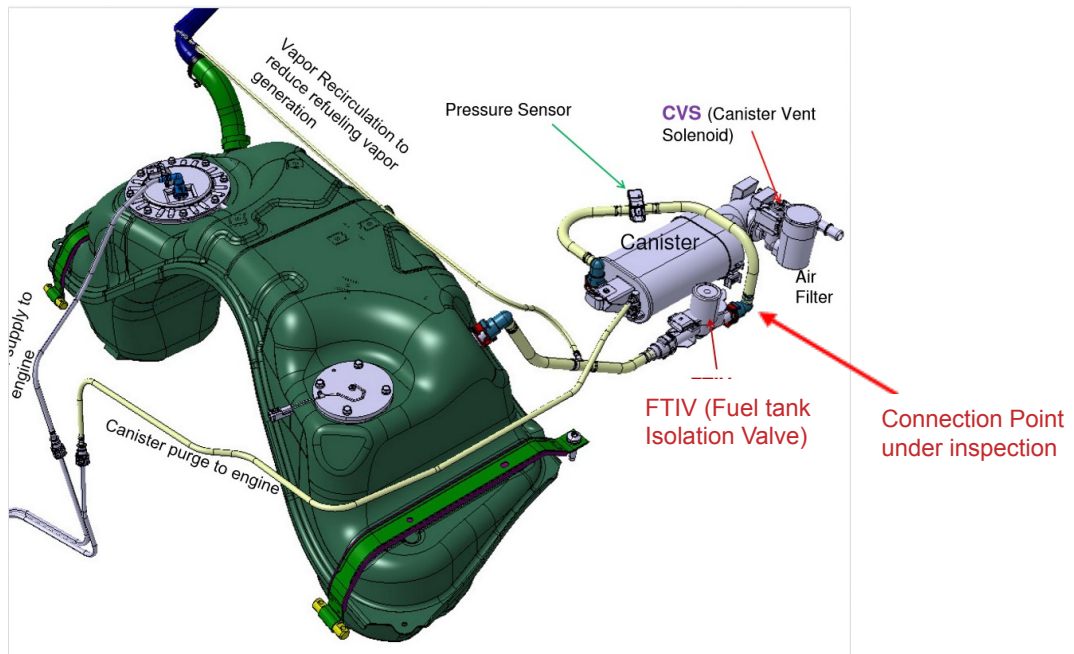

System Overview

Karma Automotive Bulletins and service documents are intended for use by experienced and trained Technicians. If you lack the skills, tools, equipment and a suitable workshop for any procedure described in this document, we suggest you leave such repairs to a Karma retailer and service provider. See your service provider for advice on whether your vehicle may benefit from the information contained within this document. The information contained in the Karma Bulletin is accurate at the date of publication. However, Karma Automotive regularly updates technical information. Please check with your Karma Automotive Retailer and Karma Automotive service provider that the bulletin you intend to use contains the latest available information.

MODEL: Karma Revero

DATE: January 2018

First Release

TITLE: Evaporative Emission System (EVAP) Inspection

Inspect for the connection for the fuel tank isolation valve, this is located in the left rear of the vehicle removal of the wheel and left rear wheel arch liner is recommend, for best access (fig. 1).

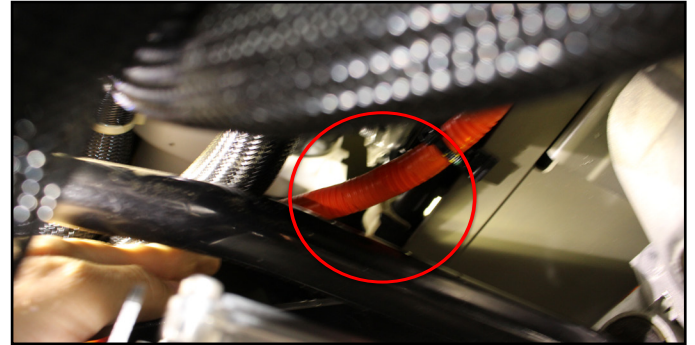

fig. 1

The valve is shown disconnected and the hose not connected here as well (fig. 2).



fig. 2

The connection is correct in this image (fig. 3).

If found disconnected, create a TSS case, and provide images of the disconnection.

Connect the hose as required.

Ensure the quick connect is pushed-in and securely seated all the way and the locking clip is in position.

Check operation and clear any codes found in Karma Sync.



fig. 3

Karma Automotive Bulletins and service documents are intended for use by experienced and trained Technicians. If you lack the skills, tools, equipment and a suitable workshop for any procedure described in this document, we suggest you leave such repairs to a Karma retailer and service provider. See your service provider for advice on whether your vehicle may benefit from the information contained within this document. The information contained in the Karma Bulletin is accurate at the date of publication. However, Karma Automotive regularly updates technical information. Please check with your Karma Automotive Retailer and Karma Automotive service provider that the bulletin you intend to use contains the latest available information.

MODEL: Karma Revero

DATE: January 2018

TITLE: Evaporative Emission System (EVAP) Inspection

First Release

Shown on the bench for better viewing, the connection in (fig 4a) connected and disconnected (fig.4b).

Note: the assembly is not oriented as installed.

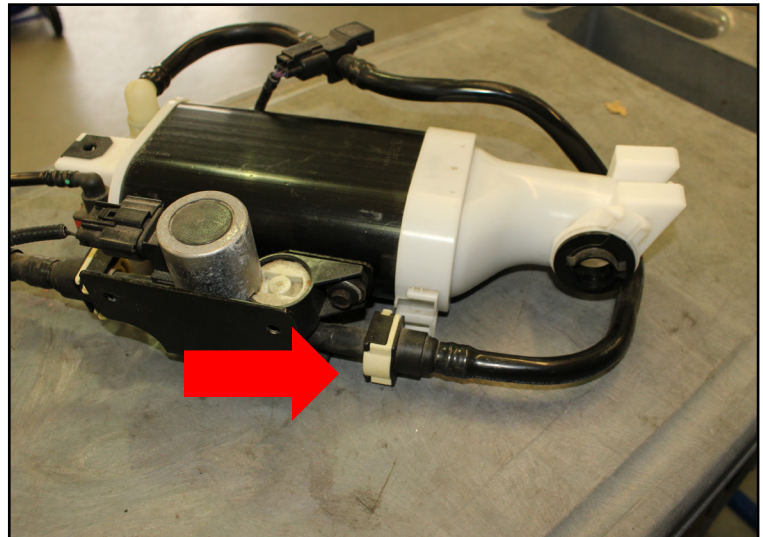

fig. 4a

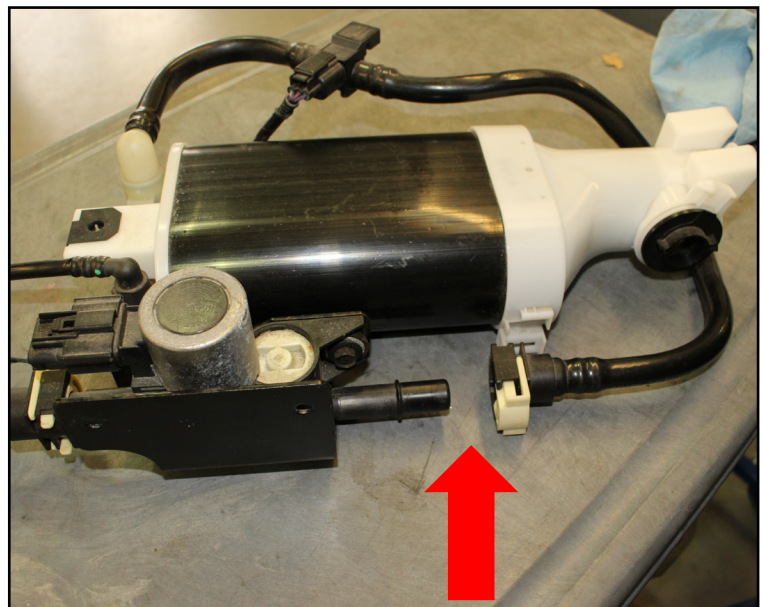

fig. 4b

Karma Automotive Bulletins and service documents are intended for use by experienced and trained Technicians. If you lack the skills, tools, equipment and a suitable workshop for any procedure described in this document, we suggest you leave such repairs to a Karma retailer and service provider. See your service provider for advice on whether your vehicle may benefit from the information contained within this document. The information contained in the Karma Bulletin is accurate at the date of publication. However, Karma Automotive regularly updates technical information. Please check with your Karma Automotive Retailer and Karma Automotive service provider that the bulletin you intend to use contains the latest available information.

MODEL: Karma Revero

DATE: January 2018

First Release

TITLE: Evaporative Emission System (EVAP) Inspection

Karma Sync has EVAP system controls available to test the individual components. This is found in the Engine Control Module selection as shown (fig 5).

to perform an EVAP system smoke test:

- 1) Have a smoke machine ready
- 2) Follow smoke machine instructions for set up
- 3) When ready select the icon indicated "O FTIV and C CVS" this seals the system for smoke testing
- 4) Start smoke machine per instruction and monitor for any smoke leaks
- 5) When test is complete: Select "Restore Val" icon (restore values) or exit the test

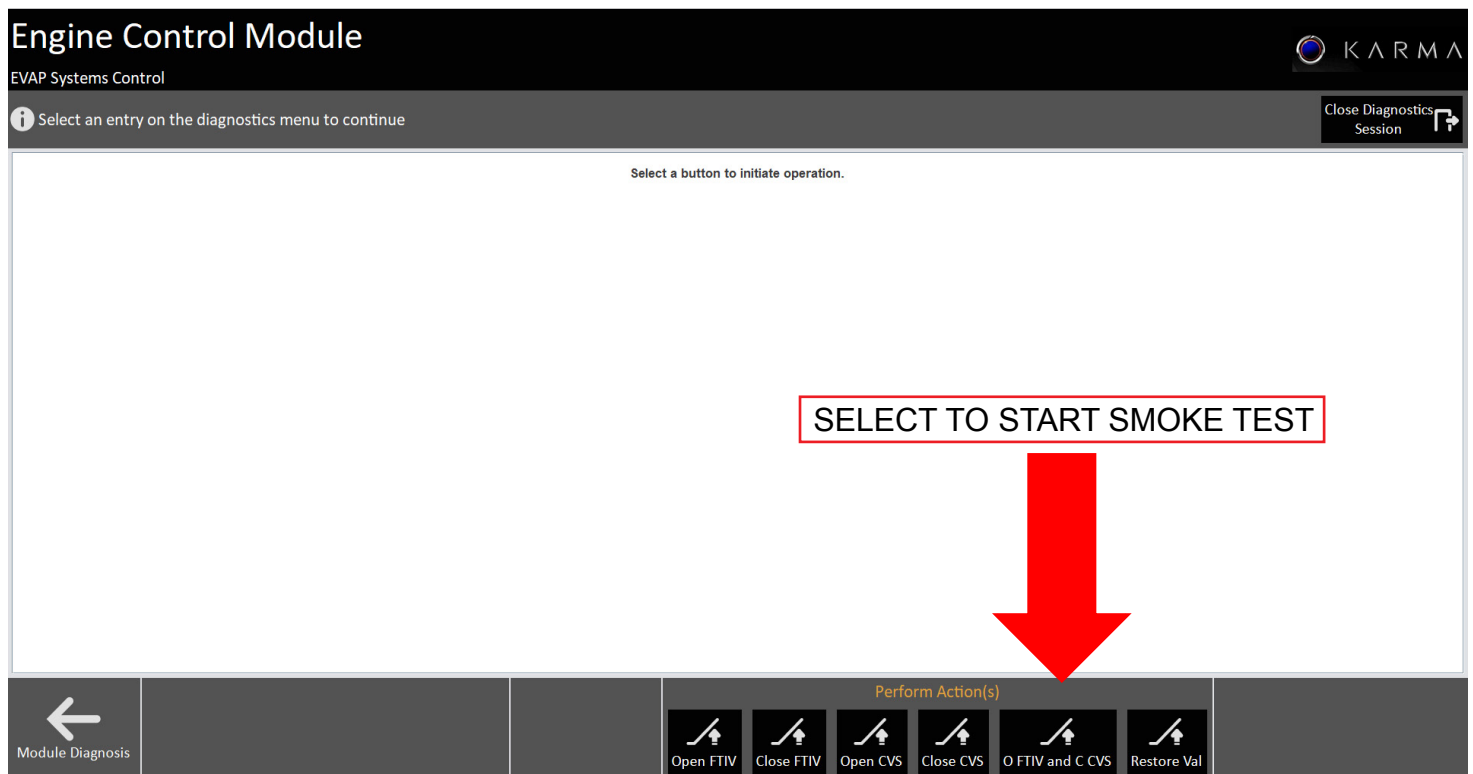

fig 5

Karma Automotive Bulletins and service documents are intended for use by experienced and trained Technicians. If you lack the skills, tools, equipment and a suitable workshop for any procedure described in this document, we suggest you leave such repairs to a Karma retailer and service provider. See your service provider for advice on whether your vehicle may benefit from the information contained within this document. The information contained in the Karma Bulletin is accurate at the date of publication. However, Karma Automotive regularly updates technical information. Please check with your Karma Automotive Retailer and Karma Automotive service provider that the bulletin you intend to use contains the latest available information.