	GROUP BOD	MODEL 2018MY Niro (DE HEV)
	NUMBER 180 (Rev 1, 1/25/2018)	DATE December 2017
TECHNICAL SERVICE BULLETIN		
SUBJECT: SERVICE ACTION: FUEL FILLER DOOR SPRING REPAIR (SA326)		

*** NOTICE**

This bulletin has been revised to include additional information. New/revised sections of this bulletin are indicated by a black bar in the margin area.

This bulletin provides the procedure to repair the fuel filler door pop-up spring on all 2018MY Niro (DE) vehicles, produced from July 24, 2017 through December 7, 2017 which may not allow the fuel filler door to open properly. Kia is requesting the completion of this Service Action on all affected vehicles in dealer stock, prior to delivery. Before conducting the procedure, verify that the vehicle is included in the list of affected VINs.

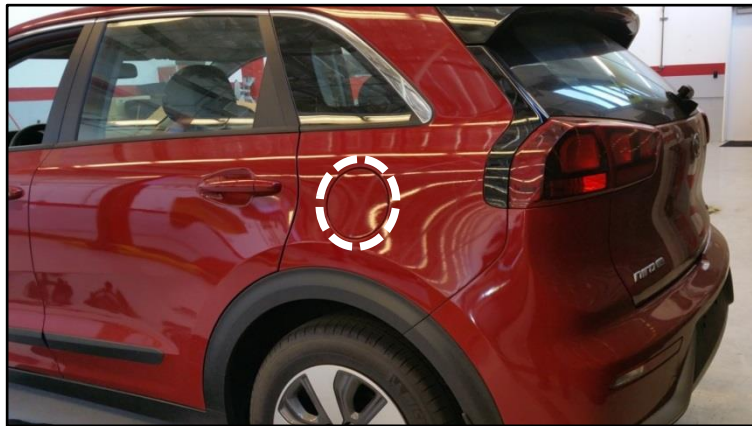

*** NOTICE**

A Service Action is a repair program without customer notification that is performed during the warranty period. Any dealer requesting to perform this repair outside the warranty period will require DPSM approval.

Repair status for a VIN is provided on WebDCS (Service → Warranty Coverage → Warranty Coverage Inquiry → Campaign Information). Not completed Recall / Service Action reports are available on WebDCS (Consumer Affairs → Not Completed Recall → Recall VIN → Select Report), which includes a list of affected vehicles.

This issue number is SA326.

File Under: <Body>

Circulate To: General Manager Service Manager Parts Manager
 Service Advisors Technicians Body Shop Manager Fleet Repair

Repair Procedure:

1. Open driver's door and press the fuel door button located on the lower left side of the interior dash.



2. Open the fuel filler door (A).

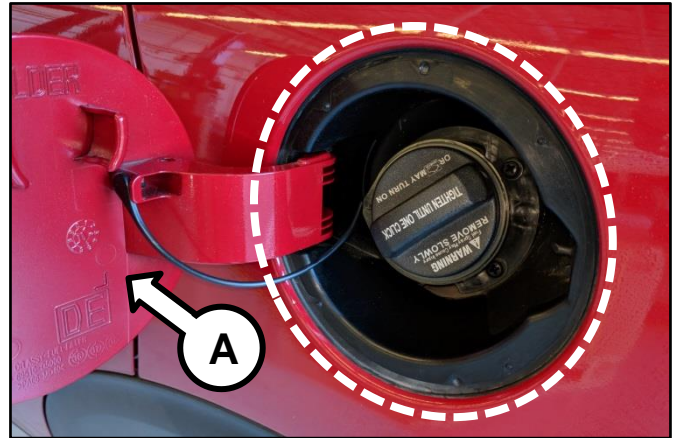

- 2a. If fuel filler door (A) is stuck closed, open the rear liftgate. Locate and remove the emergency fuel filler door manual release cover (B) inside the left side of the trunk compartment trim.

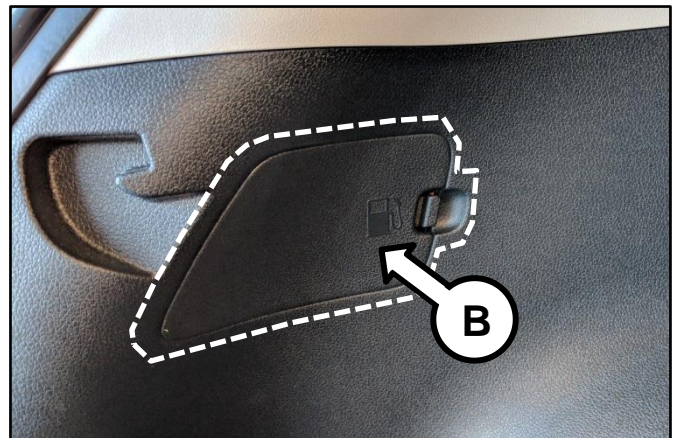

- 2b. Pull the emergency fuel door manual release cable outward as shown with your right hand, while also lifting the fuel filler door (A) on the outside of the vehicle with a left hand finger.

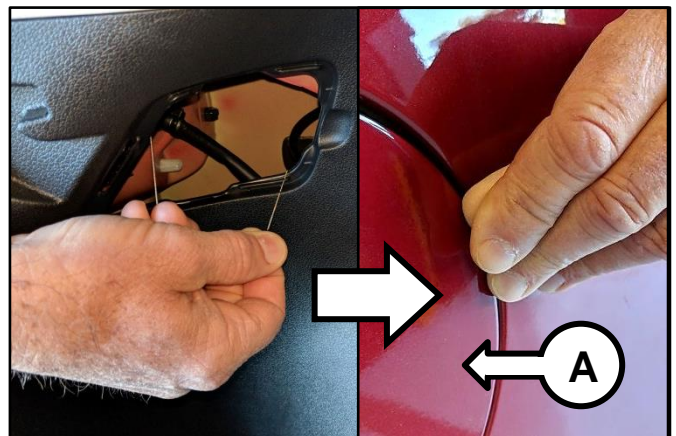

SUBJECT:

FUEL FILLER DOOR SPRING REPAIR (SA326)

3. Locate the fuel filler door spring end (C).

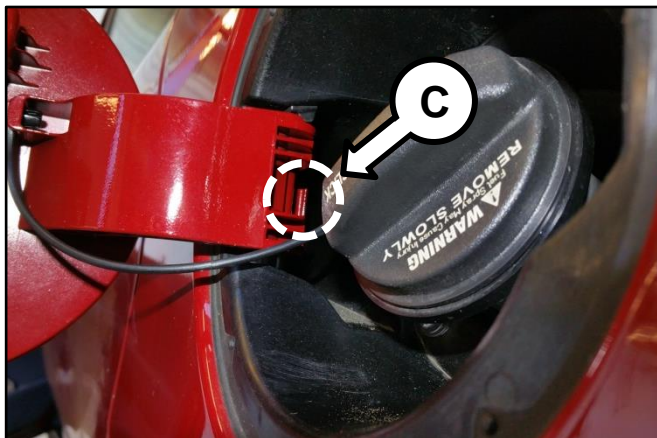

4. Measure the distance from the fuel filler door spring end (C) to the door goose neck edge (D) as show.

Specified distance required: (43 - 45mm)
1.69 - 1.77 inches.

If distance is less than specified above, proceed to step five (5). No further actions is required if within specification.

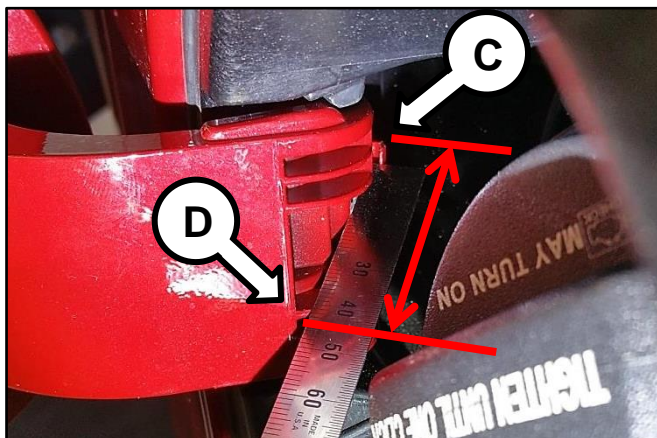

5. Using a flat tip screwdriver, push the spring clip end (C) inward as shown to increase the distance required. Refer back to step three (3) to measure again.



6. Open the fuel filler door (A), as outlined on step one (1). Repeat three (3) times. The door should pop-up open allowing for enough room to insert a finger to pull door.

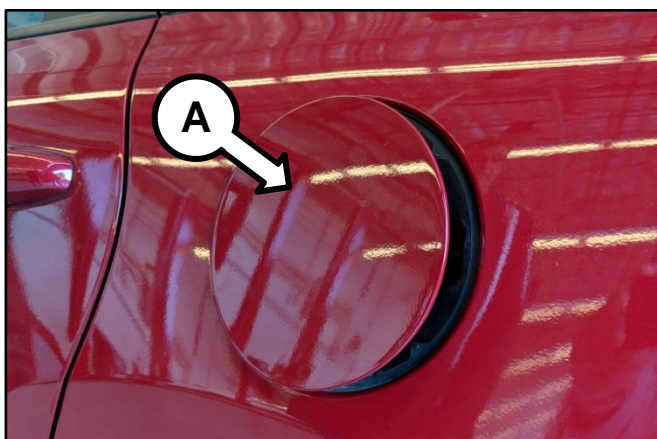

SUBJECT:

FUEL FILLER DOOR SPRING REPAIR (SA326)

AFFECTED VEHICLE RANGE:

Model	Production Date Range
Model (DE HEV)	July 24,2017 through December 7, 2017

WARRANTY INFORMATION:

N Code: N99 C Code: C99

Claim Type	Causal P/N	Qty.	Repair Description	Labor Op Code	Op Time	Replacement P/N	Qty.
V	79553 29000	0	(SA326) Fuel Filler Door Spring Repair	170132R0	0.2	N/A	0

*** NOTICE**

VIN inquiry data for this repair is provided for tracking purposes only. Kia retailers should reference SA326 when accessing the WebDCS system.