

April 21, 2017

05555 Version 1

Front Brake Noise (2016–17 RDX)

AFFECTED VEHICLES

Year	Model	Trim	VIN range
2016	RDX	2WD	5J8TB3...GL012359 thru END
2016	RDX	AWD	5J8TB4...GL019273 thru END
2017	RDX	ALL	ALL

SYMPTOM

There is front brake noise during light brake pedal application.

NOTE: There are two bulletins that address front brake noise:

- S/B 16-002, *Front Brake Noise and/or Front Brake Judder (2013–16 RDX)*, which covers 2013–15 and early production 2016 RDX models. Vehicles covered under this bulletin will require replacement of the front brake discs and brake pads.
- S/B 17-016, *Front Brake Noise (2016–17 RDX)*, which covers later production 2016 and all 2017 RDX models. Vehicles covered under this bulletin will require refinishing of the front brake discs and replacement of the front brake pads.

CORRECTIVE ACTION

Refinish the front brake discs and install the new front brake pads.

PARTS INFORMATION

Part Name	Part Number	Quantity
Front Brake Pads	45022-TX4-305	1

WARRANTY CLAIM INFORMATION

The normal warranty applies.

Operation Number	Description	Flat Rate Time	Defect Code	Symptom Code	Template ID	Failed Part Number
410820	Refinish the front brake discs and replace the front brake pads.	0.9 hr	03214	04201	17-016N	45022-TX4-A01

Skill Level: Repair Technician

CLIENT INFORMATION: The information in this bulletin is intended for use only by skilled technicians who have the proper tools, equipment, and training to correctly and safely maintain your vehicle. These procedures should not be attempted by "do-it-yourselfers," and you should not assume this bulletin applies to your vehicle, or that your vehicle has the condition described. To determine whether this information applies, contact an authorized Acura automobile dealer.

REPAIR PROCEDURE

1. Refinish the front brake discs.
2. Replace the front brake pads. Refer to the service information.

NOTE: Make sure the brake pads are installed in their correct locations. The chamfered inner pad has a wear indicator that goes in the upper inside position.

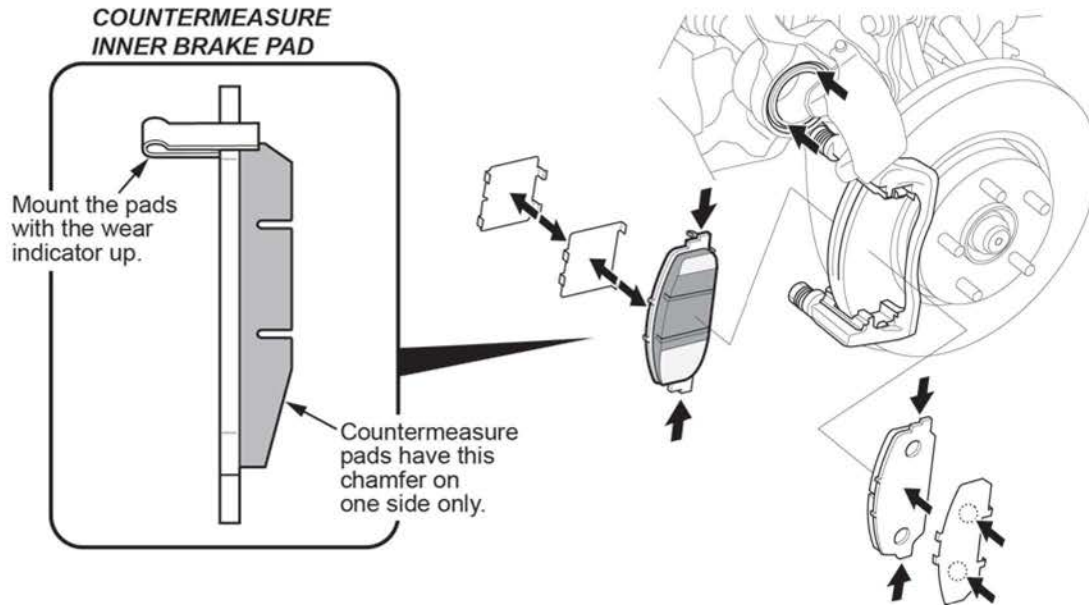

END