

## Initialisation of DSS.pdf

Reference	SSM66317
Models	Range Rover (All New) / L405
Title	L405 Deployable Side Step Module Initialisation
Category	Accessories
Last modified	13-Jun-2013 00:00:00
Symptom	Electrical Accessories
Content	<u>Issue:</u> Dealers are reporting that the when conducting the initialisation procedure the Deployable Side Steps do not function.
	<u>Action:</u> Please see attached file which details the full initialisation procedure and the process which is to be followed if the initialisation process does not switch the DSS system ON.

## **PRE-INITIALISATION OF DSS AFTER INSTALLATION (SWITCHING THE SYSTEM OFF/ON)**

When the DSS is first installed the electronic ECU module is delivered in an 'OFF' condition. This is designed to prevent the steps from deploying/stowing unintentionally after installation.

Before proceeding with initialisation of the DSS module, the ignition should be switched on and off to allow the vehicle network to be awake; please refer to the owners hand book for instructions.

## **INITIALISATION OF DSS 'SWITCHING THE SYSTEM OFF/ON'**

Initialisation of the DSS should be made within 60 seconds of PRE-INITIALISATION.

The DSS system is switched ON as follows;  
Ensure the ignition is OFF.  
Press and hold the DSS function switch and within 2\* seconds of holding the DSS function switch, press the START/STOP button to turn the ignition on

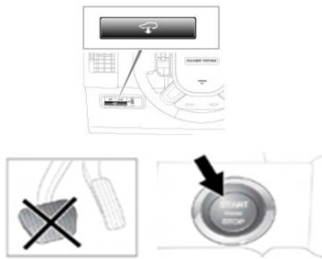

The function switch indicator will flash 3 times to indicate that the system is switched ON. To switch the system OFF, the same procedure should be followed and the function switch indicator will flash 2 times to indicate that the system is off.

\* Failure to turn the ignition ON within 2 seconds of pressing the function switch will prevent the system from switching ON/OFF

## **FUNCTION SWITCH INDICATOR DOES NOT FLASH AFTER INITIALISATION SEQUENCE**

It has been identified that the DSS initialisation process does not always switch the DSS system ON/OFF.

After performing the "SWITCHING THE SYSTEM ON/OFF" process, if the function switch indicator does not flash the process of "SWITCHING THE SYSTEM ON/OFF" should be repeated up to 10 times until the function switch indicator flashes.

If after 10 attempts the system still fails to turn ON/OFF the system should be diagnosed with dealer network tools (SDD) and any Device Trouble Codes (DTC's) should be cleared and the process from the PRE-INITIALISATION stage repeated.