

**Replacement Instructions for the Bolts
on the Meridian Ejector Pillow Blocks**

Date: February 24, 2017
Bulletin Name: FEL-TSB-031-A
Model: Meridian Front Loader 78
Model Year: 2016

Purpose:

The bolts on the ejector pillow blocks of certain Meridian Front Loaders may not have been torqued properly. This bulletin provides instructions to replace and properly torque the bolts for the ejector pillow block.

Notice:

- This bulletin should be read and understood in its entirety before performing this procedure.
- All procedures outlined in the bulletin must be performed by skilled service personnel. Refer to the product service manual for descriptions of maintenance procedures.

Tools and Equipment Required (Customer to supply own):

- 1-1/8" air impact wrench
- Breaker bar
- Torque wrench (400 ft.-lbs. needed)
- Loctite® 263
- Proximity switch wrenches or equivalent (can be purchased from McNeilus using P/N 0509600, quantity 2)
- 3/4" diameter tube style steel wire brush such as McMaster-Carr®
- Electric drill for wire brush attachment
- Cleaning solvent such as brake cleaner
- Hand-held propane torch
- Heat resistant gloves
- Safety glasses or goggles
- Compressed air (60 psi)

Parts Required per Truck:

Purchase parts from McNeilus Truck and Manufacturing, Inc. at 888-686-7278.

Item	Part Number	Description	Qty.
1	1571265	KIT EJECTOR PILLOW BLOCK HARDWARE	—
1	0120282	WASH, FLT .75 X 1.44 X .12 ZY HDN	20
2	1136926	SCR, CAP, HEX .75-10 X 2.00 G8 ZY	8
3	1136925	SCR, CAP, HEX .75-10 X 1.75 G8 ZY	4
4	1136931	SCR, CAP, HEX .75-10 X 3.50 G8 ZY	8

Procedure:

1. Place unit on a flat surface, block vehicle tires.
2. Extend the packing panel to the end of the packing stroke and stop it.
3. Perform your company's Lockout/Tagout procedure. If your company does not have a Lockout/Tagout procedure, follow OSHA 1910.147 and 1910.146 Confined Space as appropriate.
4. Battery Disconnect Switch

If your vehicle is equipped with a battery disconnect switch, it is located near the battery box. Use the battery disconnect switch when performing any maintenance so the vehicle cannot accidentally be started.

1. Turn the battery disconnect switch (Figure 1, Item 1) counterclockwise so the hole on the switch aligns with the hole in the bracket (Figure 1, Item 2).
2. Install the safety lockout device ring (Figure 2, Item 1) through the holes on the battery disconnect switch and the bracket.
3. Install a padlock (Figure 2, Item 2) onto the safety lockout device ring, lock it, and put the key in your pocket. If more than one person is working on the vehicle, each person must install his or her own padlock.

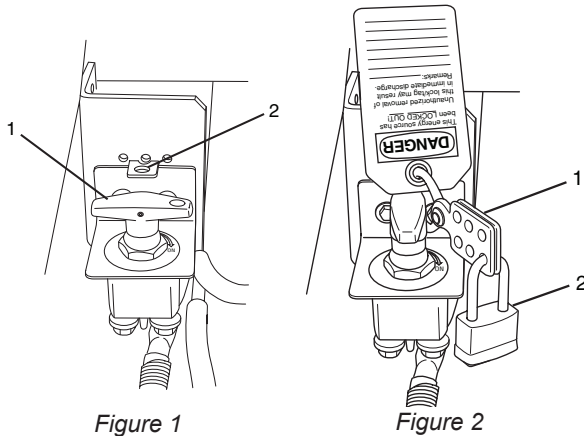

Battery Cable Disconnect

If your vehicle is not equipped with a battery disconnect switch, disconnect the negative (black) battery cable first, then disconnect the positive (red) cable.

⚠ WARNING	
For trucks without a battery disconnect switch, to prevent accidental vehicle start-up, which could cause death or serious injury, disconnect battery cables (negative cable first) before proceeding.	
Disconnect negative (-) battery cable first. If positive (+) cable should contact ground with negative (-) cable connected, the resulting sparks can cause a battery explosion, which could result in death or serious injury.	

5. Starting on the **street side of the vehicle**, remove and retain the bolts securing the proximity switch cover to the vehicle (Figure 3).
6. Remove and retain the proximity switch cover (Figure 3).



Figure 3

7. Using proximity switch wrenches to remove one proximity switch (as shown in Figure 4). Retain the proximity switch for reinstallation. The second proximity switch does not need to be removed because it is not in the path of the bolts.

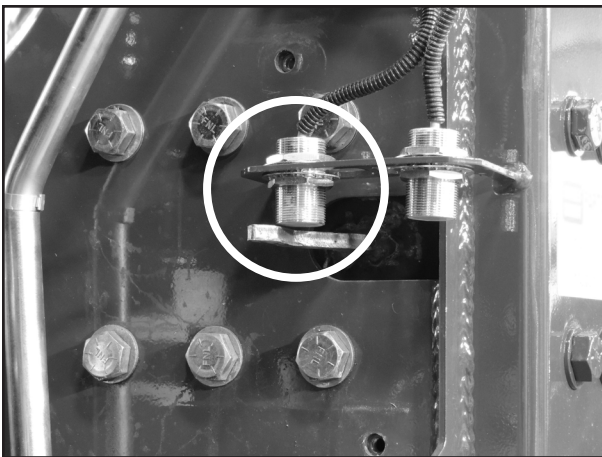

Figure 4

8. Working on one bolt at a time starting with bolt #1 in Figure 5 which illustrates the street side bolts or Figure 7 for curb side bolts, use a hand-held propane torch to heat the head of the bolt and wait approximately 60 seconds. **WARNING!** Heated metal may burn. Be extremely careful of hot metal. Use proper personal protection equipment when handling heated metal.

STREET SIDE

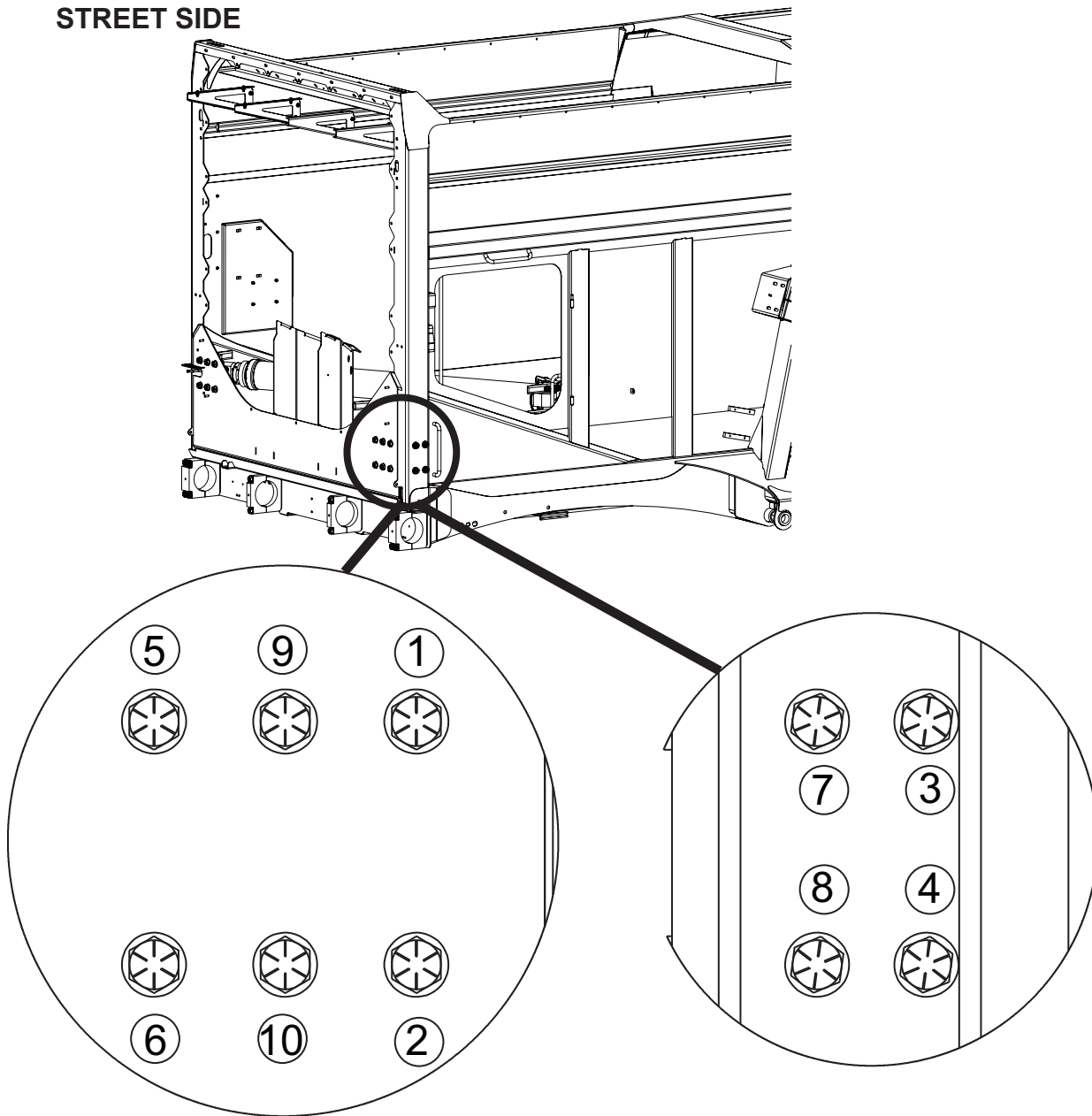

Figure 5

9. Remove the existing bolt and washer using a standard breaker bar or air impact (1-1/8" wrench) while it is still hot. **CAUTION!** If using an impact wrench, be cautious because if the head of the bolt breaks off, then the entire pillow block must be replaced. Discard bolt.
10. Clean the tapped hole in the pillow block by first heating the inside of the tapped hole with a hand-held propane torch for about 30 seconds.
11. Using the wire brush attached on a drill, clean out the hole with cleaning solvent while the hole is still hot.
12. Use compressed air (60 psi) to blow out any debris from the hole.

13. Apply Loctite 263 to the correct new bolt (see Figure 6 below for street side or Figure 8 for curb side for parts list of bolts).

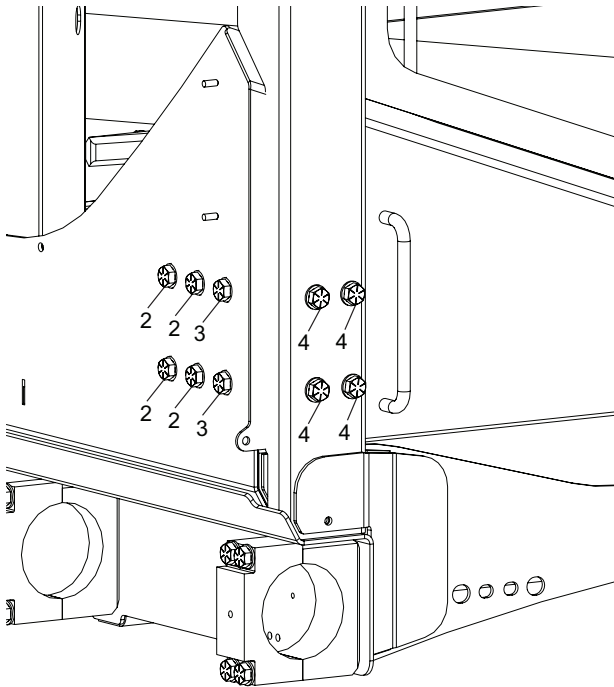

Figure 6

Item	Part Number	Description
1	0120282	WASH, FLT .75 X 1.44 X .12 ZY HDN (Not called out)
2	1136926	SCR, CAP, HEX .75-10 X 2.00 G8 ZY
3	1136925	SCR, CAP, HEX .75-10 X 1.75 G8 ZY
4	1136931	SCR, CAP, HEX .75-10 X 3.50 G8 ZY

14. Install the new bolt and a new washer (P/N 0120282).

15. Use a torque wrench to torque the bolt to 400 ft.-lbs.

NOTE: If the bolt threads strip out or if you get to 400 ft.-lbs. of torque before the washer is snug, then the threads on the pillow block are damaged and the pillow block must be replaced. Contact McNeilus National Service at 888-686-7278 for more information.

16. Repeat Steps 8-15 to each of the remaining bolts following the sequence in Figure 5 for street side (or Figure 7 for curb side), one bolt at a time.

17. Reinstall the proximity switch using the proximity switch wrenches to tighten the nut until snug. Clearance between the proximity switch and the proximity switch target piece should be approximately 1/8".

18. Reinstall the proximity switch cover and bolts. Tighten bolts until tight.

19. Move to the **curb side of the vehicle** and conduct Steps 8-16 for the curb side ejector pillow block bolts. See Figures 7 and 8 for curb side illustrations.

CURB SIDE BOLTS

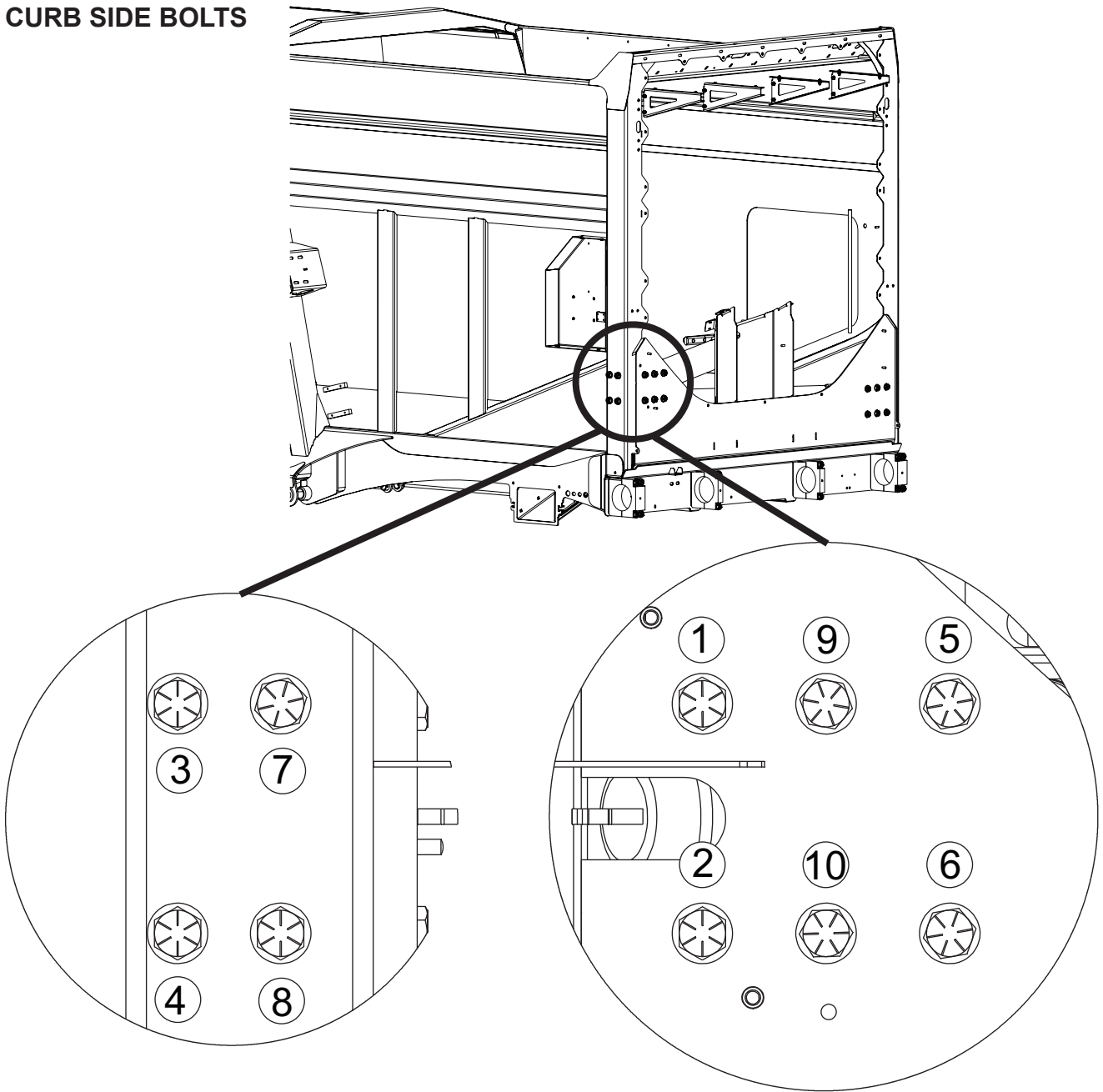

Figure 7

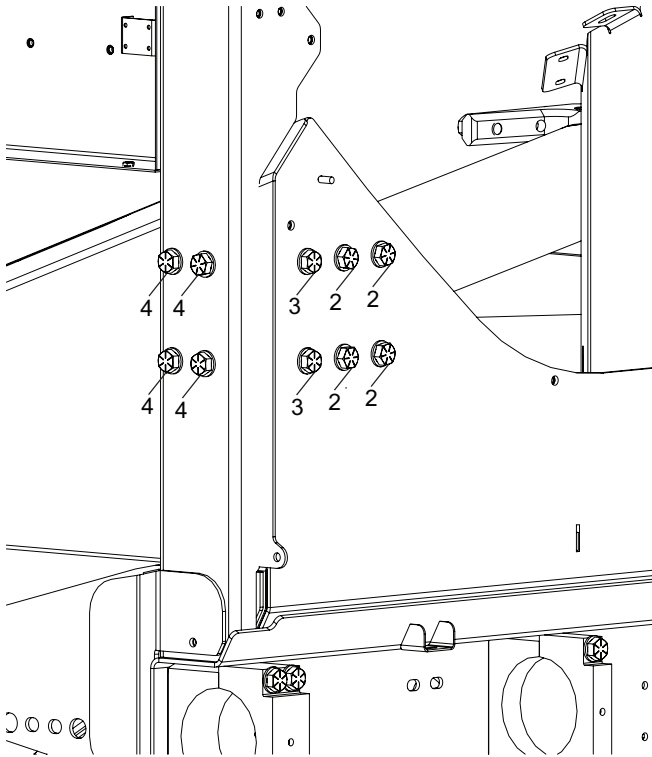

Figure 8

Item	Part Number	Description
1	0120282	WASH, FLT .75 X 1.44 X .12 ZY HDN (Not called out)
2	1136926	SCR, CAP, HEX .75-10 X 2.00 G8 ZY
3	1136925	SCR, CAP, HEX .75-10 X 1.75 G8 ZY
4	1136931	SCR, CAP, HEX .75-10 X 3.50 G8 ZY

20. When all of the ejector bolts have been replaced and torqued on both sides of the vehicle, inspect the head frame post weld on each side of the vehicle for cracking (Figure 9). If cracked weld is found on either or both sides, contact McNeilus National Service at 888-686-7278 for more information.

CURB SIDE

STREET SIDE

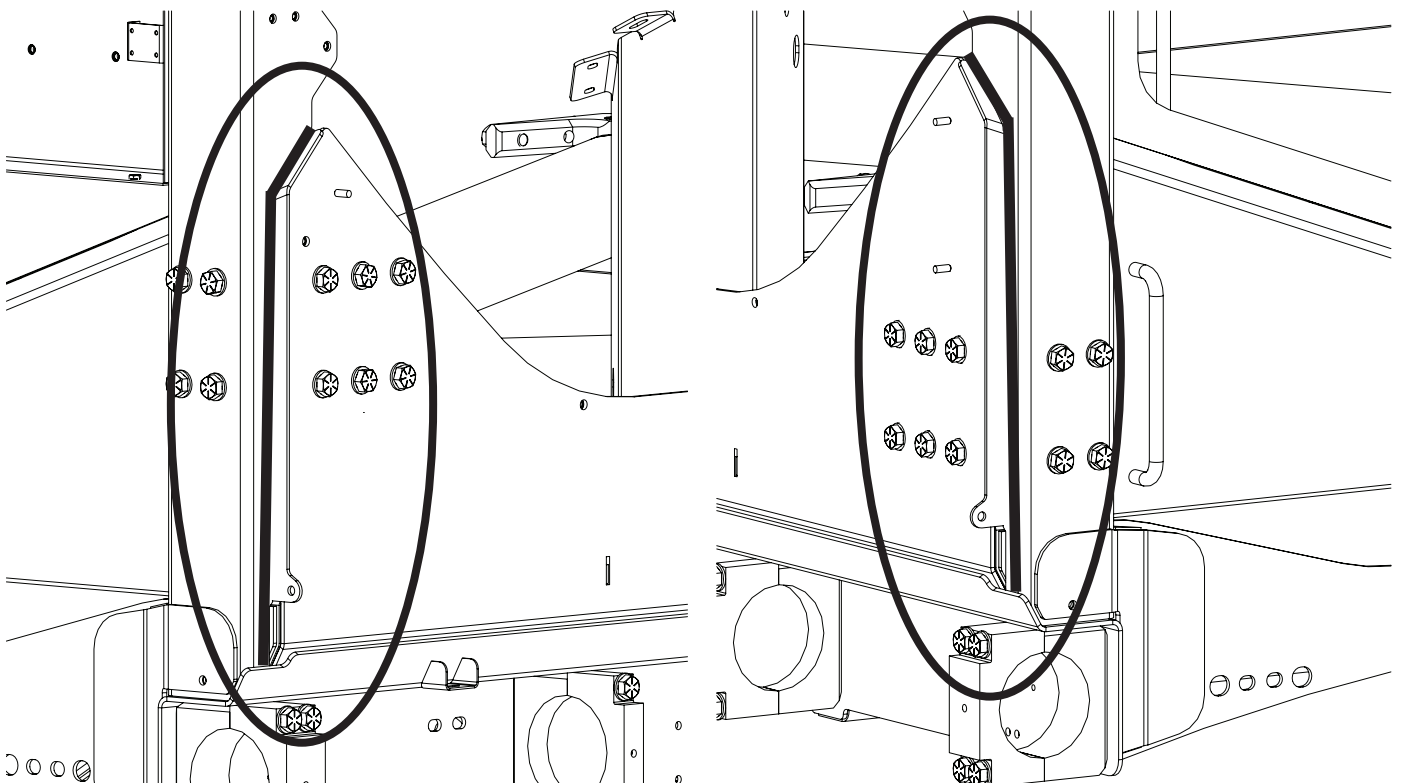

Figure 9

21. Procedure is complete.
22. Remove your company's Lockout/Tagout per your company's procedure. If your company does not have a Lockout/Tagout procedure, follow OSHA 1910.147 and 1910.146 Confined Space as appropriate. Reconnect the battery.
23. Return vehicle to service.

Labor Reimbursement:

In order to receive credit if you qualify, claims must be submitted through the normal McNeilus Warranty claim system. Claims must be received within 30 days of the repair. Claims must include the McNeilus serial number of the truck, the customer asset number, and the number of this bulletin. NOTE: One claim per truck.

Labor Reimbursement: 2.5 Hours

Parts Reimbursement:

Parts and ground shipping will be reimbursed to the customer. Parts necessary for this repair must be ordered from McNeilus Parts at 888-686-7278.

Claims must be submitted through the normal McNeilus Warranty claim system. Claims must be received within 30 days of the repair. Claims must include the McNeilus serial number of the truck, the customer asset number, and this bulletin's number. NOTE: One claim per truck.

Deadline:

If required, this service update should be performed at the earliest opportunity. The following terms must be met to qualify for reimbursement cost.

- For reimbursement, a warranty claim form with proof of installation must be submitted by: **August 13, 2017**

Continuous Improvement:

The change included in this bulletin is part of the McNeilus® Continuous Improvement Process.

McNeilus® Company's quality policy is Providing Customer Satisfaction through Innovative Products, Dedicated Service, and a constant focus on Continuous Improvement.

"The Customer is our Boss!"



(888) 686-7278

www.streetsmartparts.com