

POWER AND MOTION

Purpose

Calibration instructions for Lippert Hall Effect Bed Tilt Control.

To enter calibration mode from normal mode, hold down the configuration button for five seconds (Fig. 1A).

To calibrate the stops:

1. Flashing red LED (Fig. 1C) indicates that the upward limit needs to be set.
2. Use the wall switch (Fig. 2B) to move the unit to the desired top position.
3. When at the desired top position, press the configuration button (Fig. 1A).
4. The top limit is set.
5. Flashing green LED (Fig. 1B) indicates that the downward limit needs to be set.
6. Use the wall switch (Fig. 2A) to move the unit to its desired downward position.
7. When at the desired downward position, press the configuration button (Fig. 1A).
8. The downward limit is set.
9. Once the downward limit is set, both red (Fig. 1C) and green (Fig. 1B) LEDs will blink simultaneously for a moment.
10. Both limits have been set successfully.

NOTE: If an error occurs during this configuration, the red and green LEDs will quickly alternate flashing.

11. To reset the stops, press and hold the configuration button for five seconds. This will allow the system to enter calibration mode.

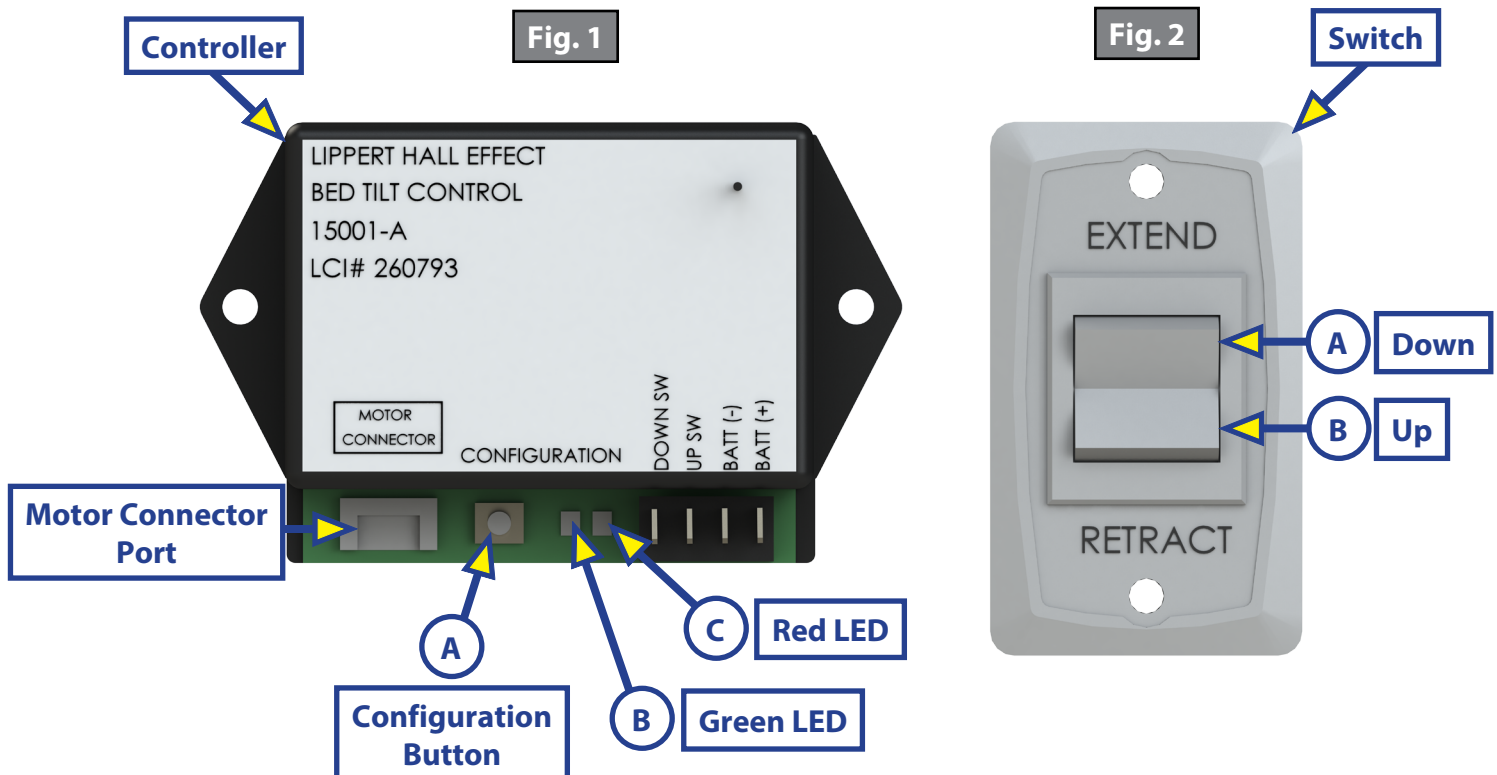

As a supplier of components to the RV industry, safety, education and customer satisfaction are our primary concerns. Should you have any questions, please do not hesitate to contact us at (574) 537-8900 or by email at customerservice@lci1.com. Self-help tips, technical documents, product videos and a training class schedule are available at lci1.com or by downloading the MyLCI app.