



TECHNICAL SERVICE BULLETIN

Date: March 23, 2017

Expiration Date: March 23, 2022

Indian Motorcycle

Bulletin Number: I-17-01

Model Years: 2016

Safety Bulletin

Service Bulletin

Service Alert Fax

Distribution: Owner/Principal Service Manager Sales Manager Parts Manager Technicians

This Service Bulletin is located at www.polarisdealers.com

-Confidential and Proprietary-

VERSION: R01 (March 23, 2017)

IMPORTANT

If you are working with a printed copy, please verify you have the most current version of these instructions.

SUBJECT:

Indian Motorcycles - 2016 Jack Daniel's® Limited Edition Vintage and Springfield Fuel Tank Replacement

PURPOSE:

Indian Motorcycle has learned that a defect exists affecting all 2016 Jack Daniel's® Limited Edition Vintage and Springfield fuel tanks, which may affect paint adhesion around the fuel fill port. During the paint process an alteration to the fuel fill port masking fixture caused the clear coat to terminate where exposure to fuel vapor is possible. If this occurs, fuel vapor can get under the clear coat, causing the base coat to bubble.

Indian Motorcycle will replace all affected fuel tanks with a new tank that has been painted to factory specification using an improved masking fixture.

Refer to "Unit Inquiry" on the dealer website to ensure each vehicle is within the specified VIN range for this Service Bulletin. Refer to the repair procedure below for the proper steps to complete this bulletin.

Your service department **MUST** perform the following actions as directed by this Service Bulletin:

1. Each member of your service department team must review this Service Bulletin in its entirety.
2. The Reminder Card included in the Fuel Tank Kit will direct you how to access the Kit Instructions. The Kit Instruction Audit Check List must be completed by a secondary dealer representative. Save and retain an electronic copy of the Kit Instructions for a minimum of 5 years.

AFFECTED MODELS:

MODEL YEAR	MODELS	VEHICLE IDENTIFICATION NUMBER RANGE
2016	Jack Daniel's® Limited Edition Vintage and Springfield	Reference "Unit Inquiry" on the dealer website or the Service Bulletin list on the STOP site to lookup affected units.

CUSTOMER NOTIFICATION

A customer notification letter will be sent to all registered owners of affected vehicles. In addition to the notification letter sent by Polaris, dealers are required to review sales records and contact consumers who have purchased a potentially affected vehicle. Make arrangements to perform the steps outlined in this Service Bulletin immediately.

WARRANTY CLAIM / PARTS INFORMATION:

File claim type **SB (Service Bulletin)**.

SERVICE BULLETIN #	I-17-01 Fuel Tank Replacement
CLAIM TYPE	SB (Service Bulletin)
LABOR ALLOWANCE	60 Minutes (1.0 Hours)
PART NUMBER / DESCRIPTION	2207296 (QTY.1) FUEL TANK KIT 7170107 (QTY.1) BULLETIN COMPLETION DECAL
PARTS AVAILABILITY	Available to Order
UNIVERSITY OF POLARIS VIDEO TRAINING REQUIREMENT	NO

ACCESSORY REMOVE & REPLACE LABOR:

Polaris will cover labor for the removal and installation of accessories required to complete the bulletin work. Follow the steps below to obtain reimbursement.

For accessory removal and installation up to 1 hour of labor:

1. Start a new warranty claim under the Service and Warranty dropdown and enter the VIN.
2. Enter the Date Failed and Date Repaired information into the applicable fields.
3. Enter "I-17-01" in the Authorization field.
4. Enter the miles and hours.
5. Enter the labor time up to 1 hour.
6. Enter "I-17-01" in the CONCERN and CAUSE fields. In the CORRECTION field, enter "ACCESSORY REMOVAL AND INSTALLATION".
7. Add part 0000541, quantity 1.
8. Enter warranty fail codes 105/168/121.
9. Validate the parts.
10. Save and submit the claim to Polaris.

For accessory removal and installation over 1 hour of labor:

1. Start a new Ask Polaris Case, Service & Warranty Question > Authorization: Non-Cosmetic & Polaris ESC or Authorization: Out of Warranty.
2. Enter your contact information and VIN, along with miles and hours into the applicable fields.
3. Enter "I-17-01" in the CONCERN and CAUSE fields. In the CORRECTION field, enter "ACCESSORY REMOVAL AND INSTALLATION".
4. Enter warranty fail codes 105/168/121.
5. Add part 0000541, quantity 1.
6. Attach photos of the vehicle and accessories sufficient to support the labor time requested.
7. Submit the case to Polaris.

NOTE

Polaris requires dealers to maintain warranty records, including repair orders and supporting documentation for five years. All claims for additional labor, dealer transport/travel or part stock claims for I-17-01 are subject to audit and inspection. Infractions will result in chargebacks and fines in accordance with the Polaris Audit Policy.

WARRANTY COVERAGE PERIOD

Warranty coverage for Service Bulletin I-17-01 will begin March 23, 2017. Warranty coverage for Service Bulletin I-17-01 will expire five (5) years from the date of warranty registration.

PARTS RETURN OR DISPOSAL INFORMATION

Under no circumstances shall the parts removed in this repair be re-used, sold, or re-purposed for another application. All fuel tanks affected by this bulletin should to be returned via the normal warranty parts return system.

SERVICE BULLETIN COMPLETION DECAL

A Service Bulletin Completion Decal must be completed for this bulletin repair. Remove the inside left cover and place the decal on inside of the cover. If you require more decals, order them through normal Polaris parts ordering channels.

FEEDBACK FORM

A feedback form has been created for the technician to provide POLARIS with an overall satisfaction rating for the instructions, provide comments on your experience or upload pictures/videos from a specific repair. This feedback form is viewable on a mobile device by scanning the QR code shown or by clicking [HERE](#) if viewing this document electronically.



KIT CONTENTS (2207296)

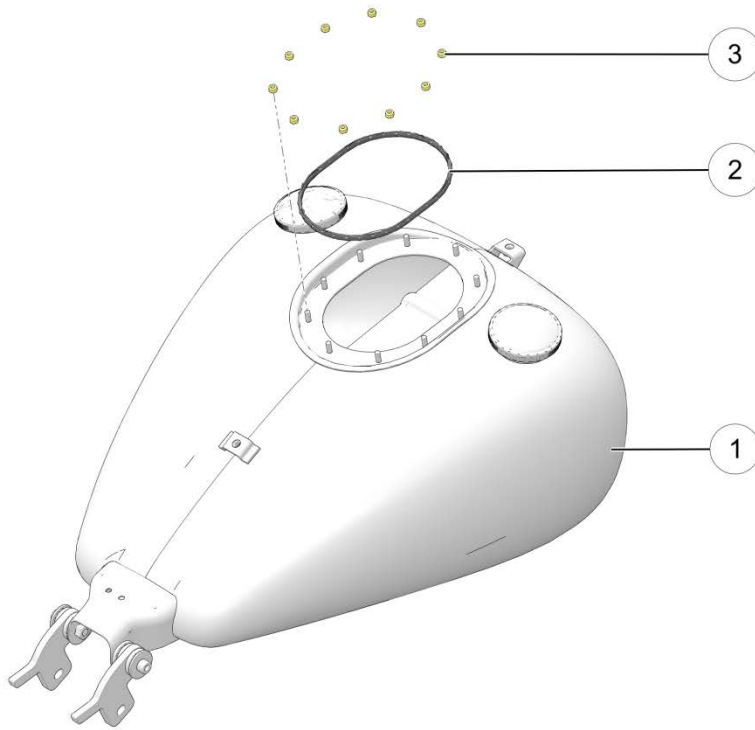

REF	PART DESCRIPTION	PART NUMBER	QTY
①	FUEL TANK	1021997	1
②	FUEL PUMP SEAL	5414514	1
③	FUEL PUMP RETAINING NUTS	7546601	10
	REMINDER CARD	9928436	1

I-17-01 - FUEL TANK REPLACEMENT PROCEDURE:

Tools Required:

- 8 mm socket
- Ratchet
- 4 mm, 6 mm allen wrench
- Torque wrench
- Fuel Rail Plug Tool 2521832

FUEL TANK REMOVAL

1. Remove upper side covers.

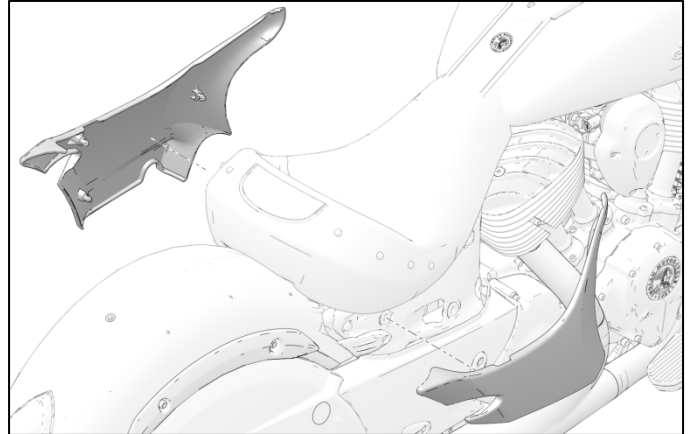

2. Using a 6 mm allen wrench, remove the two fasteners ① retaining the driver seat to the frame. Remove Seat.

NOTE

For models with a passenger seat, remove passenger seat fastener.

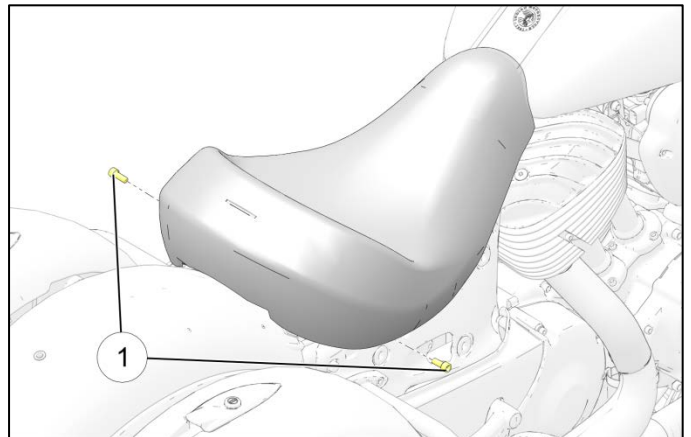

3. Using a 6 mm allen wrench, remove fuel tank fasteners ②.

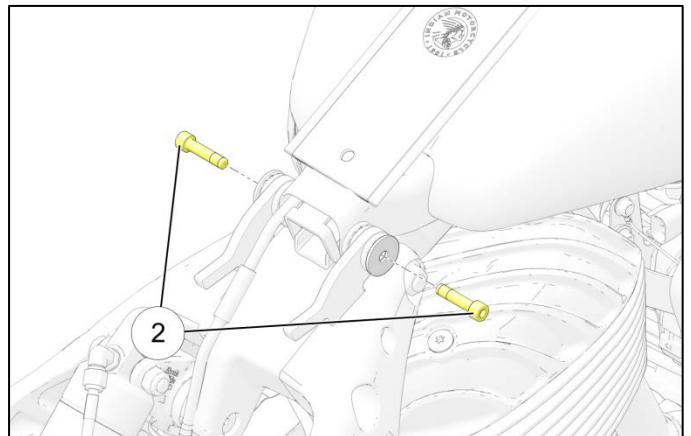

4. Remove washers and rubber isolators.
Retain for installation.

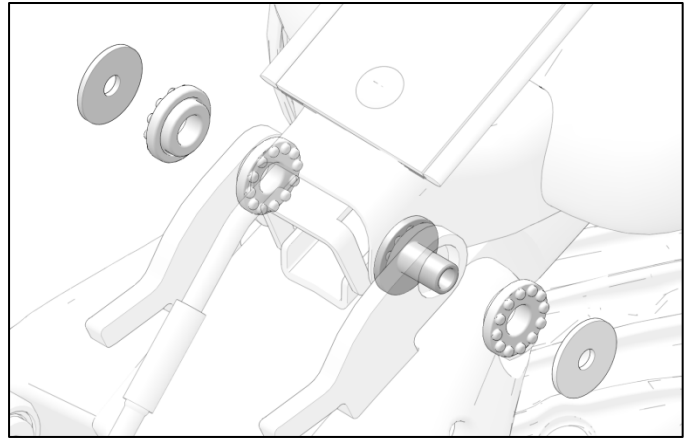

5. Lift the rear of the tank and slide back approximately 2" to expose the front console cover fastener.

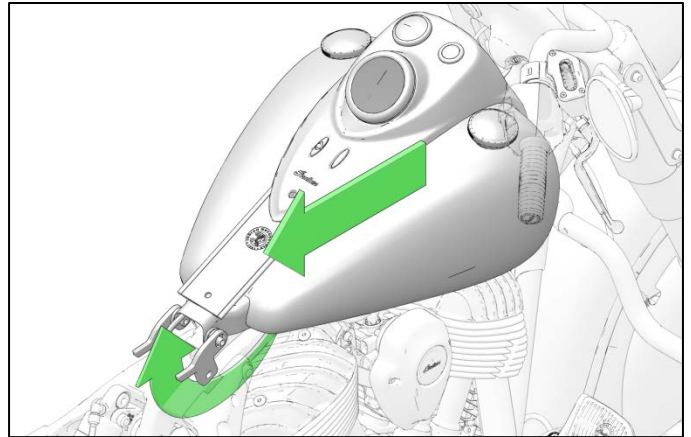

6. Using a 4 mm allen wrench, remove console cover fasteners ③.

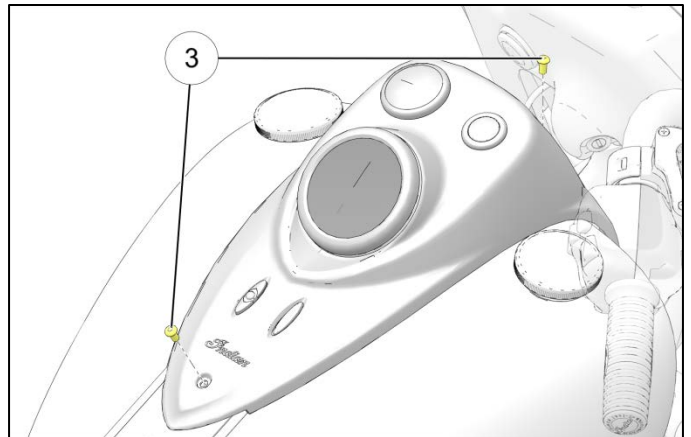

7. Remove tank strap plastic dart.

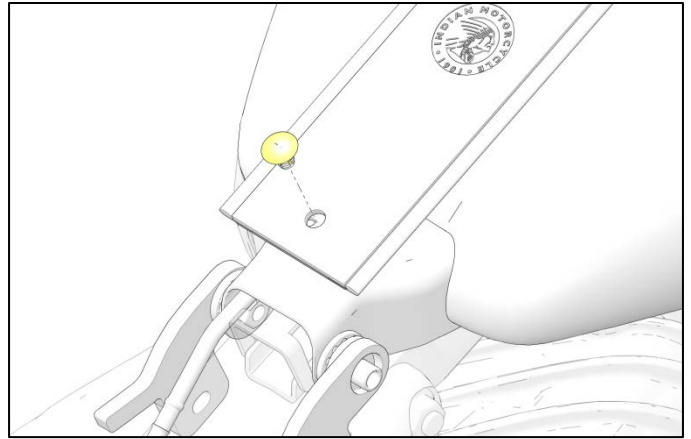

8. Disconnect electrical connectors at the security light, central locking and system power buttons and remove console cover.

9. Disconnect the fuel pump electrical connector from fuel pump (4) and the evaporative vent line (5).

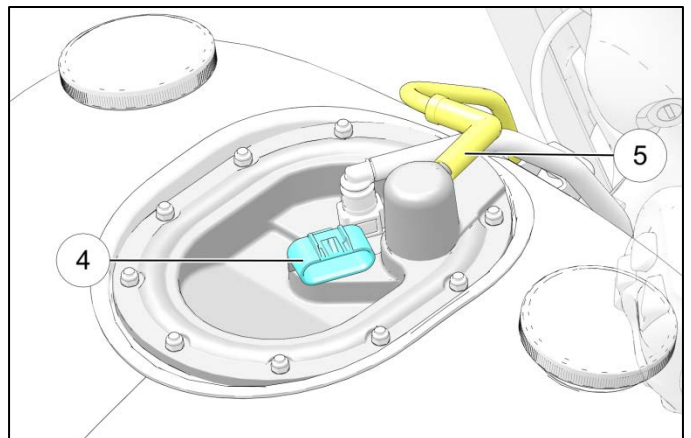

10. Wrap a shop rag around the fuel fitting, Squeeze the quick connect buttons (one on each side) and hold. Gently slide fitting straight off the fuel pump.

CAUTION

Always wear eye protection

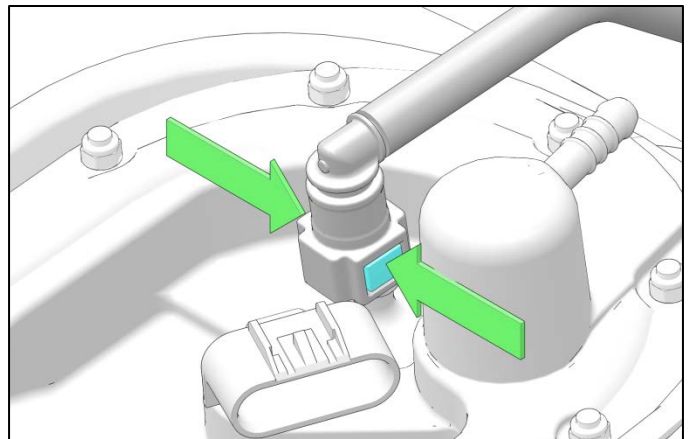

11. Install fuel line plug tool (2521832) to prevent fuel leakage. Push. Click. Pull.

IMPORTANT – AUDIT STEP

Verify the fuel line plug tool has fully engaged the fuel line.

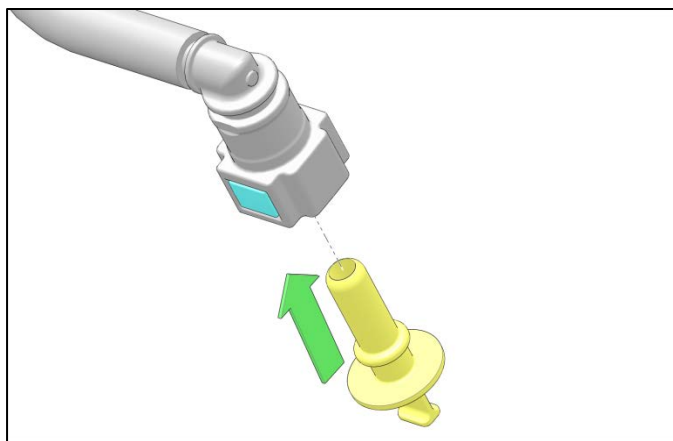

12. Lift the rear of the fuel tank and slide rearward to release from the front isolators.

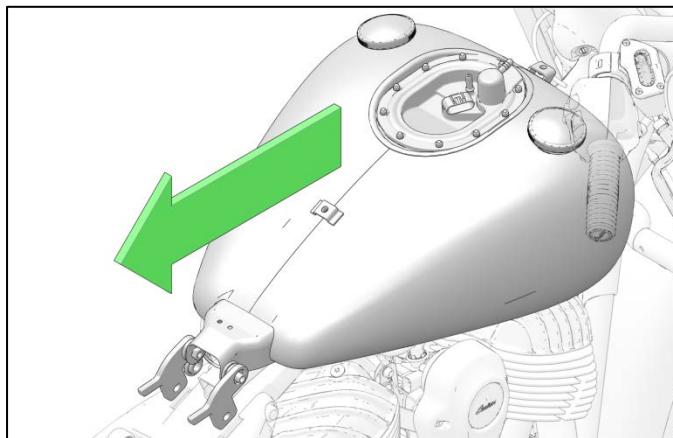

13. Place the fuel tank on a stable, flat surface, away from any ignition sources.

FUEL PUMP REMOVAL

CAUTION

Be careful when removing the fuel pump not to damage the fuel level float arm, jet pipe, fuel pump, electrical wiring, or hoses. Always inspect wires and hoses closely for damage after removing the fuel pump.

1. Using a 8 mm socket, remove fuel pump access cover nuts ① in an alternating “star” pattern.

IMPORTANT

Discard fuel pump nuts

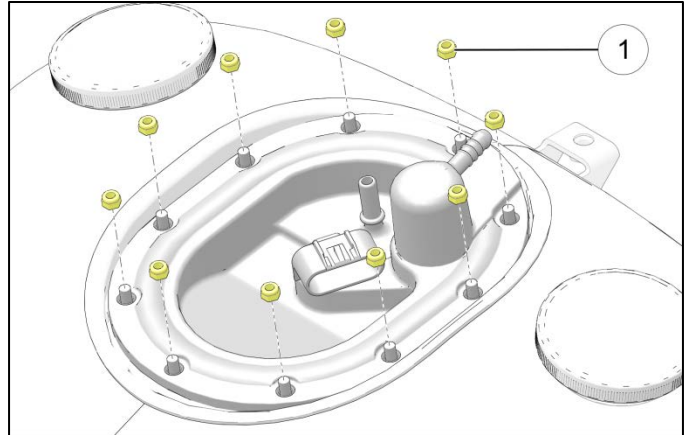

2. Remove sealing gasket ② from the bottom of the fuel pump access cover.

IMPORTANT

Discard sealing gasket

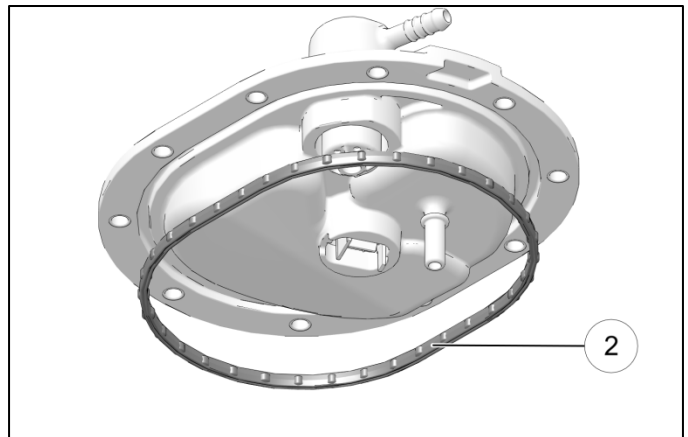

3. Raise the fuel pump access cover enough to disconnect the fuel pump electrical connector ③ and the supply line ④.

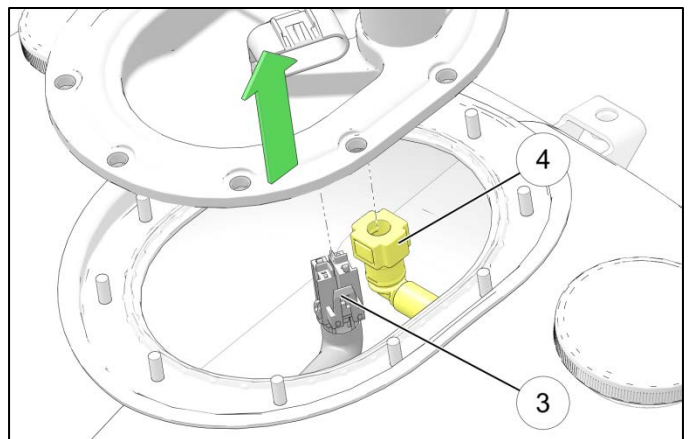

4. Reach in through the fuel pump access cover and gently press the fuel pump retaining tab ⑤ toward the right-hand side of the fuel tank.

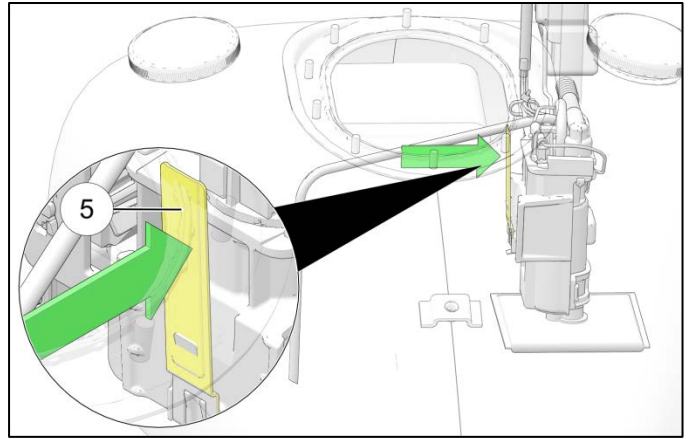

5. Lift the fuel pump assembly out of the retaining bracket and allow any residual fuel to drain back into the tank.
6. Place the pump assembly on an absorbent cloth.
7. Using a fluid transfer pump or siphon, drain remaining fuel from the fuel tank and into a suitable container. Properly dispose of old fuel.

FUEL PUMP INSTALLATION

1. Lower the fuel pump assembly into the access hole with the level arm facing forward and the jet pipe resting on the left side of the tunnel.

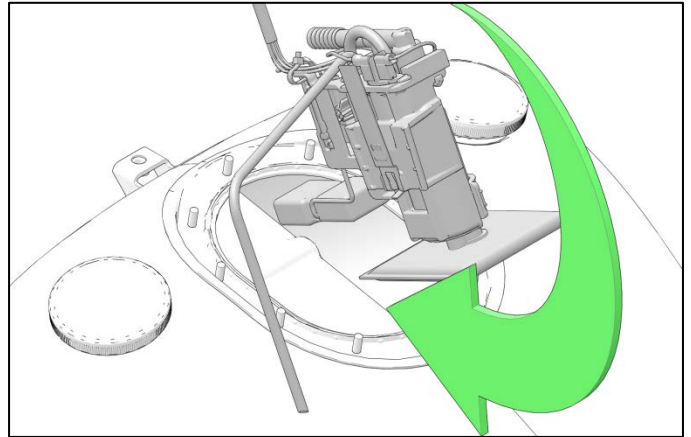

2. Once the pump body is inside the tank, line up the guide rails and retaining tab with the bracket ①.

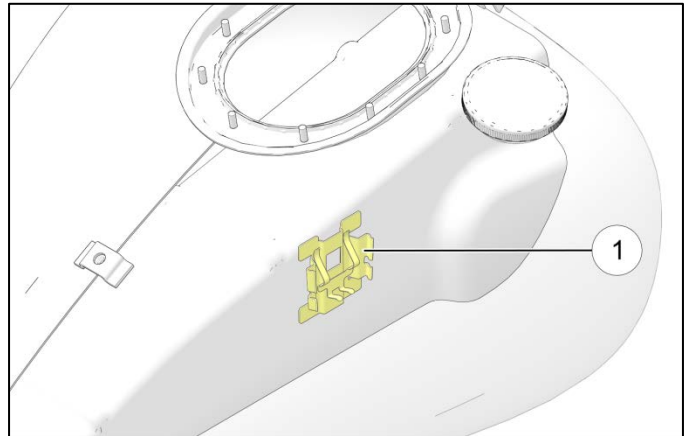

3. Slide the pump into position until the retaining tab engages and the pump is locked in place.

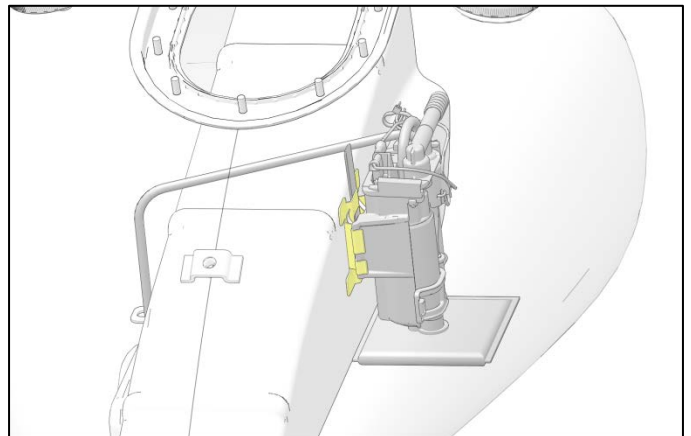

IMPORTANT

Verify that the float arm moves freely through its full range of travel.

4. Press a NEW sealing gasket ② into the bottom of the fuel pump access cover.

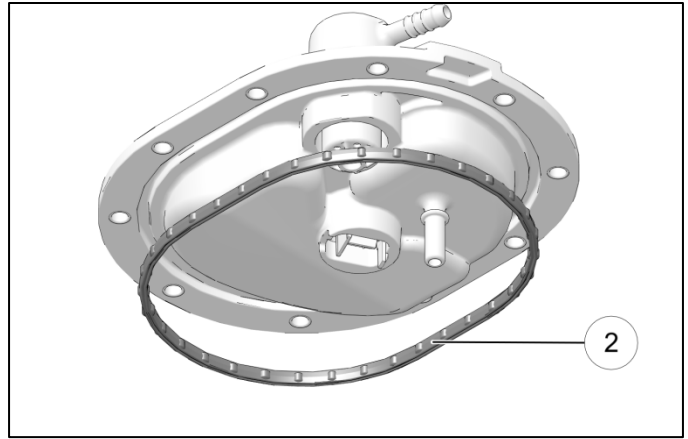

5. Lower the fuel pump access cover into position and connect the electrical connector ③ and supply line ④.

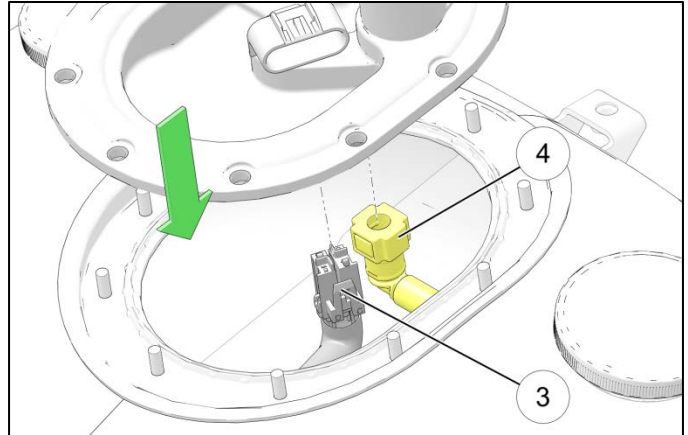

6. Install fuel pump access cover nuts ⑤ and torque to specification using the proper torque sequence.

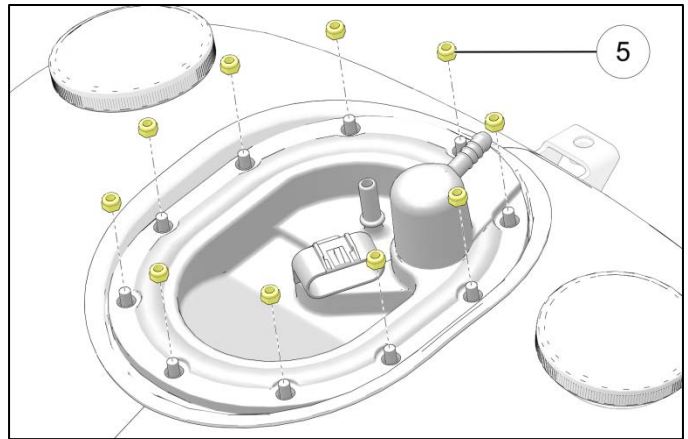

TORQUE

Fuel Pump Access Cover:
43 in-lbs (5 Nm)

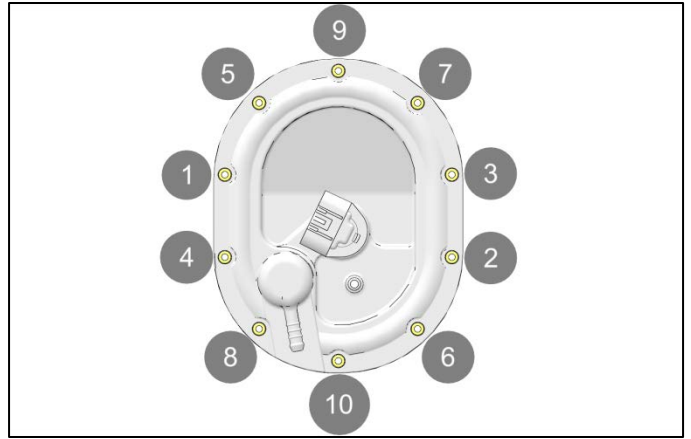

FUEL TANK INSTALLATION

1. Verify that the front tank isolators are in position on the frame mounts and lower tank into position.

IMPORTANT

DO NOT slide forward into position at this time.

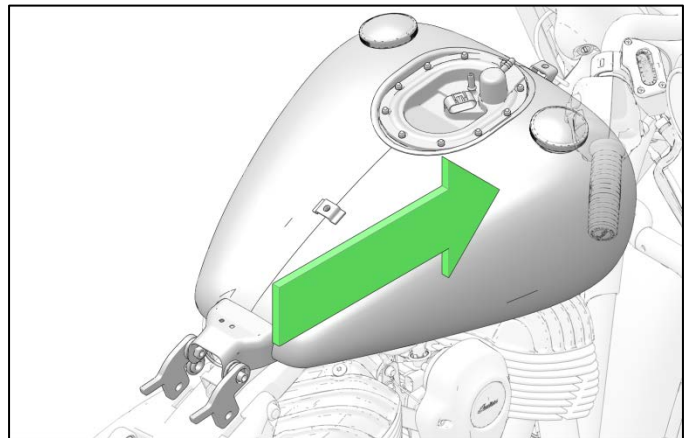

2. Wrap a shop rag around the fuel line fitting and remove the fuel line plug tool.

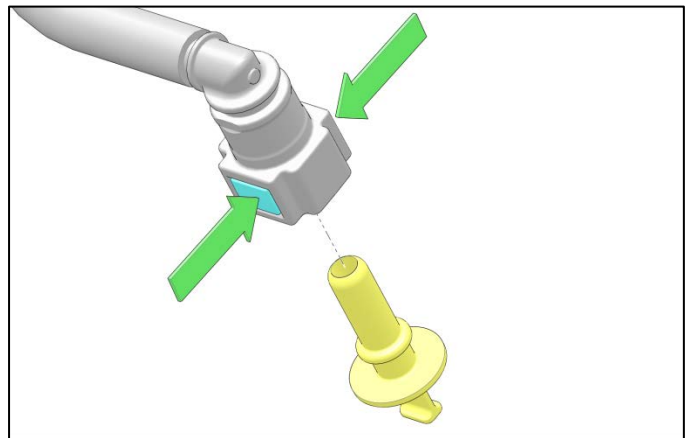

3. Install the upper fuel line connector ⑥ to the fuel pump until an audible click is heard. Push. Click. Pull.

IMPORTANT – AUDIT STEP

A secondary dealer representative must verify that the fuel line connection is secure. Mark the fuel fitting with a paint pen to indicate the audit has been completed.

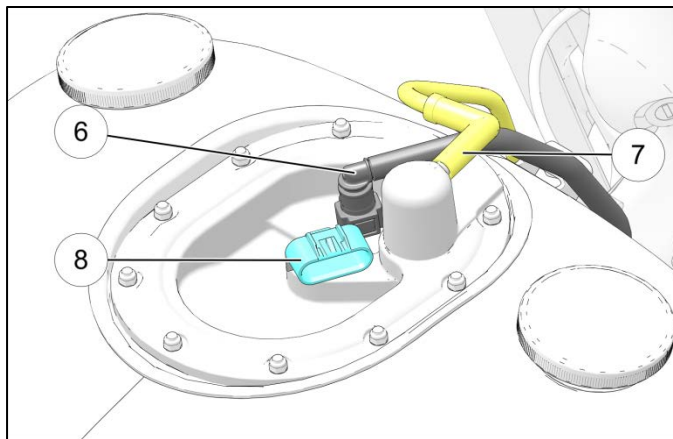

4. Connect the vent line ⑦ and fuel pump electrical connector ⑧ to the top of the access cover.

5. Prime the fuel system by following the steps below:

- a. Fill the fuel tank.
- b. Turn the Engine Stop switch to OFF.
- c. Press the power button to power up the motorcycle.
- d. Turn Engine Stop switch to RUN.
- e. Allow switch to remain in RUN position until pump stops running (about 2-3 seconds).
- f. Turn Engine Stop switch to OFF.
- g. Press power button to power down motorcycle.
- h. WAIT approximately 10 seconds.
- i. Repeat steps D-H about 4 times to complete the priming procedure.

NOTE

Fuel level in tank must be high enough to submerge pickup screen on fuel pump.

6. Install the console cover and torque fasteners ⑨ to specification.

TORQUE

Console Cover Fasteners:
84 in-lbs (10 Nm)

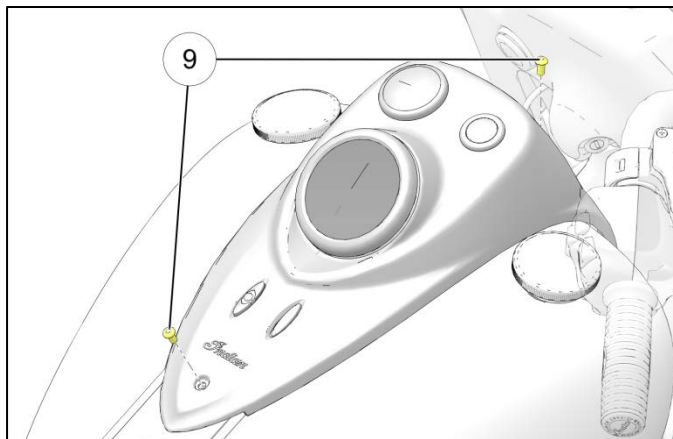

7. Slide tank forward until fully engaged on front isolators ⑩.

IMPORTANT

Make sure that the front tank mounts have fully engaged isolators.

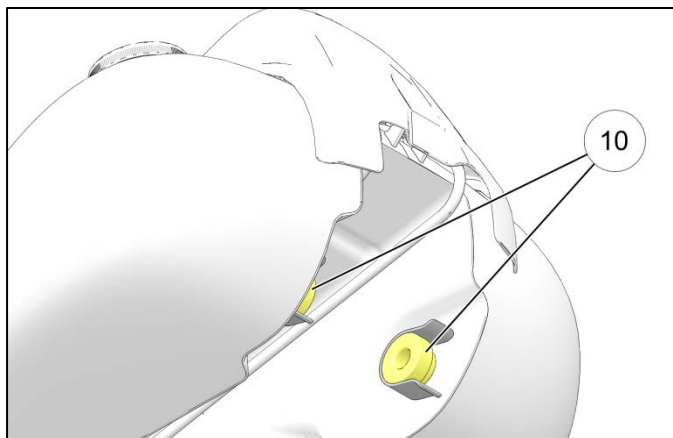

8. Lower the rear of the tank into position over the rear mounting bracket.

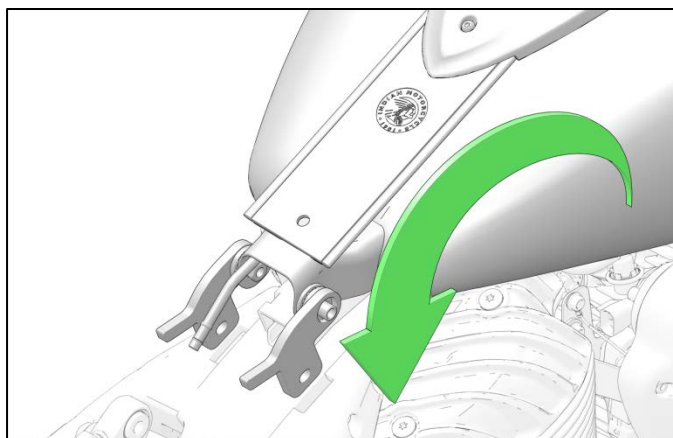

9. Install push plastic dart thru the tank strap and into the frame.

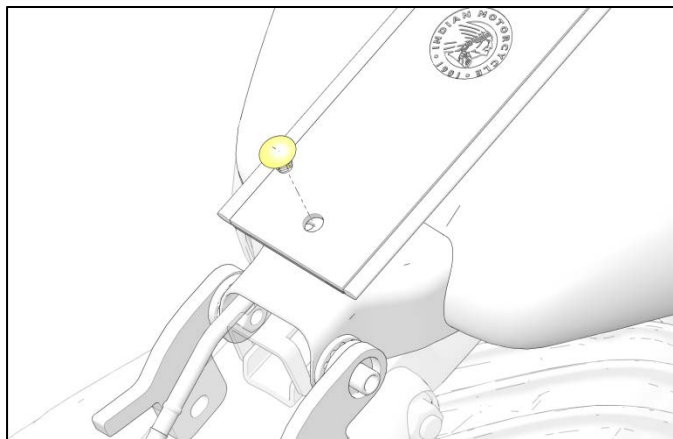

10. Install both fuel tank isolators and washers correctly as shown.

IMPORTANT

Verify that the fuel tank vent line is routed properly.

IMPORTANT – AUDIT STEP

A secondary dealer representative must verify that both fuel tank isolators and washers are assembled correctly.

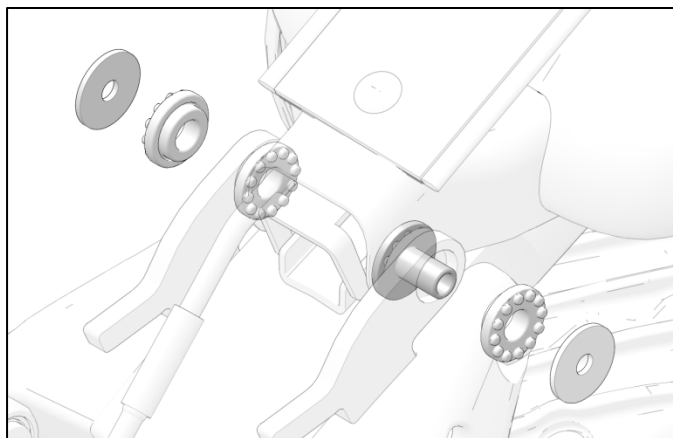

11. Using a 6 mm allen wrench, install fuel tank fasteners ⑪. Torque fasteners to specification.

TORQUE

Fuel Tank Fasteners:
18 ft-lbs (24 Nm)

IMPORTANT – AUDIT STEP

A secondary dealer representative must verify that the Fuel Tank Fasteners are torqued to specification. Mark fastener heads with a paint pen to indicate the audit has been completed.

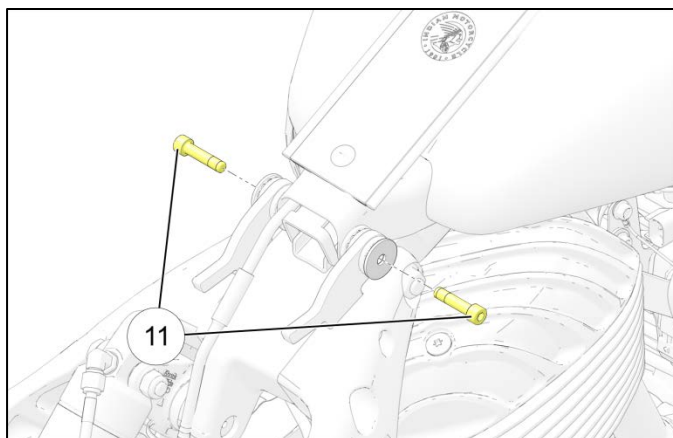

12. Slide front of seat into seat retaining bracket. Using a 6 mm allen wrench, install the two fasteners ⑫ retaining the driver seat to the frame. Torque seat fasteners to specification

TORQUE

Seat Fasteners:
18 ft-lbs (24 Nm)

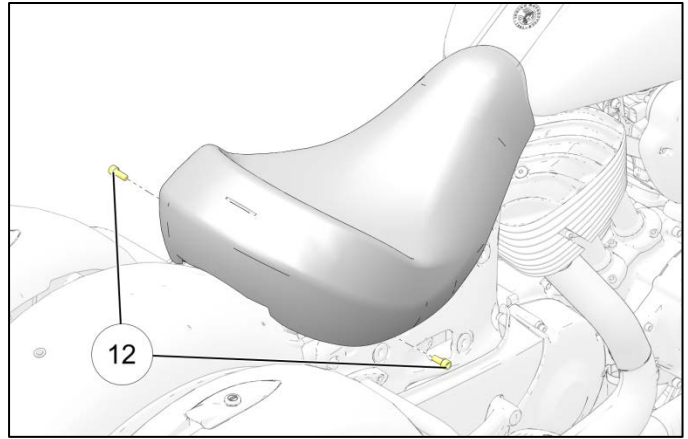

13. Connect the motorcycle to Digital Wrench. Verify no fail codes and no MIL lights are present. Field Test the motorcycle to verify proper operation.

IMPORTANT – AUDIT STEP

A secondary dealer representative must connect the motorcycle to Digital Wrench. Verify no fail codes and no MIL lights are present.

IMPORTANT

A secondary dealer representative must field test the motorcycle before putting into service to verify proper operation.

14. File a warranty claim for I-17-01 and Install a completed Service Bulletin Completion Decal (7170107).

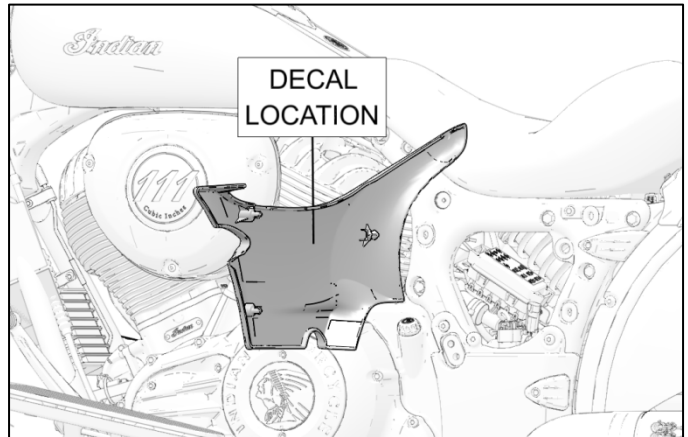

15. Replace upper side covers.

