



# Service Bulletin

File in Section: -

Bulletin No.: 17-NA-305

Date: September, 2017

## TECHNICAL

**Subject: Malfunction Indicator Lamp (MIL) Illuminated - DTCs P305C, P305D and/or P3054 Set**

Brand:	Model:	Model Year:		VIN:		Engine:	Transmission:
		from	to	from	to		
Chevrolet	Malibu (VIN Z)	2016	2016				
	Malibu	2017	2018				

<b>Involved Region or Country</b>	North America, Israel
<b>Additional Options (RPOs)</b>	KC4, KL9
<b>Condition</b>	Some customers may comment that the MIL is illuminated. The technician may find one or more of the following DTCs set: <ul style="list-style-type: none"><li>• P305C</li><li>• P305D</li><li>• P3054</li></ul>
<b>Cause</b>	This condition may be caused by condensation on the cooling duct used for the charging pad, dripping water on the DC/DC converter.
<b>Correction</b>	If one or more of the following DTCs have been set, the wireless device charge port cooling duct must be inspected for condensation dripping onto the DC/DC converter.

## Service Procedure

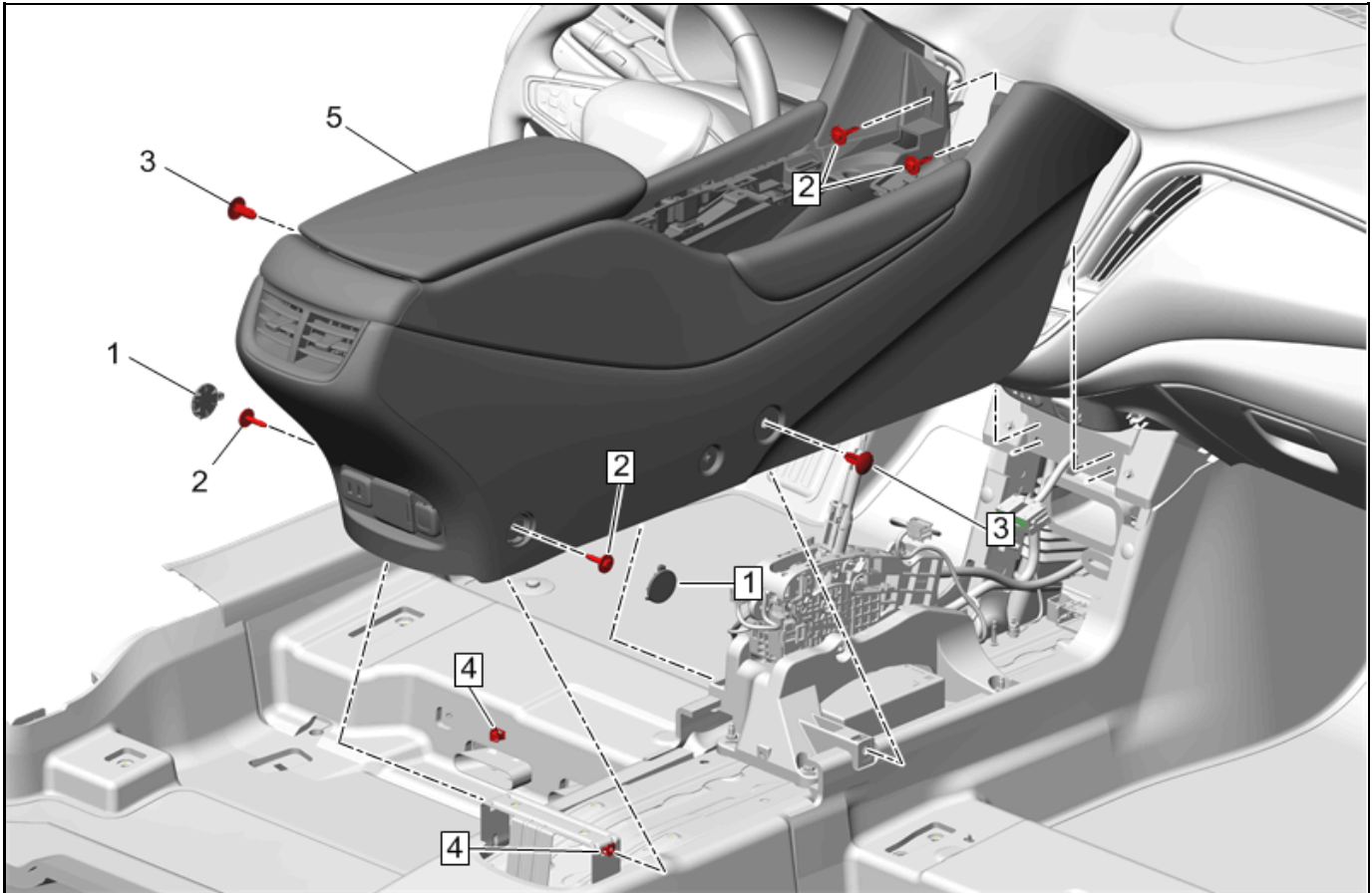

4225184

1. Remove the front floor console (5). Refer to *Front Floor Console Replacement* in SI.

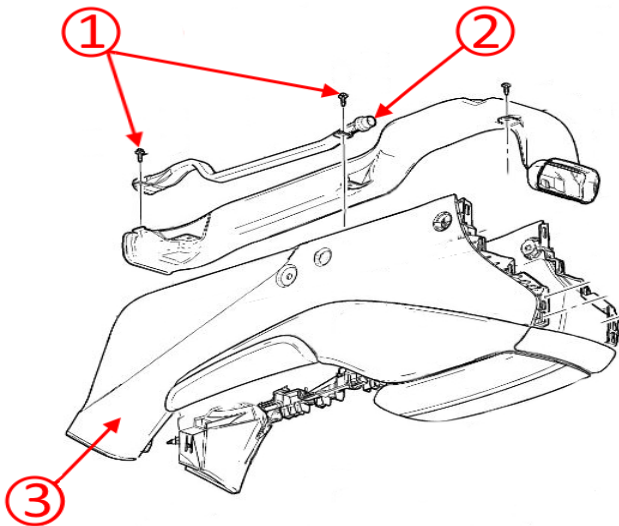

4866351

2. Remove the screws (1) that secure the wireless device charge port temperature control duct (2) to the underside of the floor console (3).



4866653

3. Wrap the duct (1) with a closed cell adhesive foam (2).
4. Inspect the DC/DC module electrical connector for signs of moisture.
  - If moisture is found in the connector, allow the connector to dry.
  - Apply dielectric grease to the area.
5. Install the wireless device charge port temperature control duct.
6. Install front floor console.

**Parts Information**

No parts are required for this repair.

**Warranty Information**

For vehicles repaired under the Bumper-to-Bumper coverage (Canada Base Warranty coverage), use the following labor operation. Reference the Applicable Warranties section of Investigate Vehicle History (IVH) for coverage information.

Labor Operation	Description	Labor Time
4480668*	Wireless Device Charge Port Temperature Control Duct Wrap	1.4 hrs
*This is a unique Labor Operation for Bulletin use only.		

Version	1
Modified	Released September 22, 2017

