

# Fuel Door Will Not Open

**Service Category** Vehicle Exterior

**Section** Door/Hatch

**Market** USA

Scion Supports  
 ASE Certification 

## Applicability

YEAR(S)	MODEL(S)	ADDITIONAL INFORMATION
2016	iA	

## Introduction

Some 2016 model year iA vehicles may exhibit a condition where the fuel door will NOT open due to a detached cable from the retainer when pulling the release lever. This condition may have been caused by incorrect assembly during manufacturing. Follow the procedure in this bulletin to address this condition.

## Warranty Information

OP CODE	DESCRIPTION	TIME	OFP	T1	T2
237991	R & R Retainer Fuel Filler Opening Lid Lock	0.5	77377-WB001	9A	57

### APPLICABLE WARRANTY

- This repair is covered under the Toyota Basic Warranty. This warranty is in effect for 36 months or 36,000 miles, whichever occurs first, from the vehicle's in-service date.
- Warranty application is limited to occurrence of the specified condition described in this bulletin.

## Parts Information

PART NUMBER	PART NAME	QTY
77377-WB001	Retainer, Fuel Filler Opening Lid Lock	1

## Fuel Door Will Not Open

### Repair Procedure

1. Confirm operation of the interior fuel door release lever.  
Is the lever inoperative and does NOT feel as if there is ANY tension on the lever when operating?
  - **YES** – Continue to step 2.
  - **NO** – If tension can be felt when pulling the fuel door release lever, then this bulletin does NOT apply. Continue diagnosis using the applicable Repair Manual.
2. Open the fuel filler lid and remove the nut.

**Figure 1.**

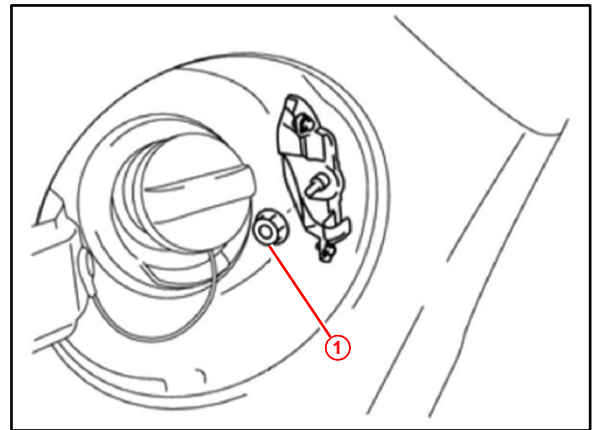

<b>1</b>	<b>Nut</b>
----------	------------

3. Remove the service hole cover on the trunk side trim (LH).

**Figure 2.**

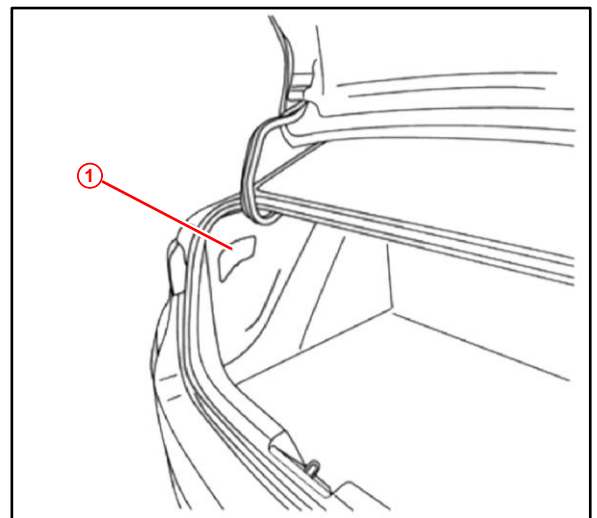

<b>1</b>	<b>Service Hole Cover</b>
----------	---------------------------

## Fuel Door Will Not Open

### Repair Procedure (Continued)

4. Detach ALL the stopper bracket tabs from the body and remove the stopper bracket.

Figure 3.

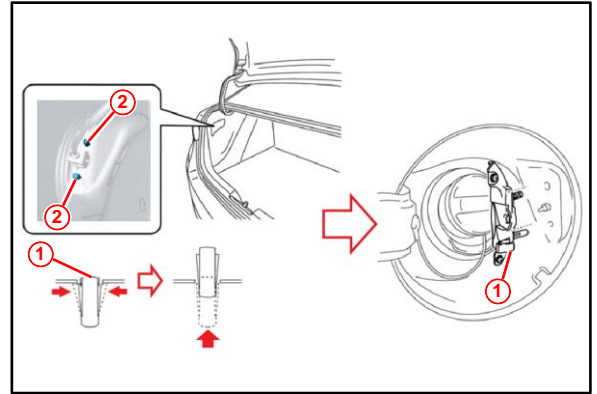

<b>1</b>	<b>Stopper Bracket</b>
<b>2</b>	<b>Tab</b>

5. Remove the fuel filler lid opener in the direction of the arrow.

Figure 4.

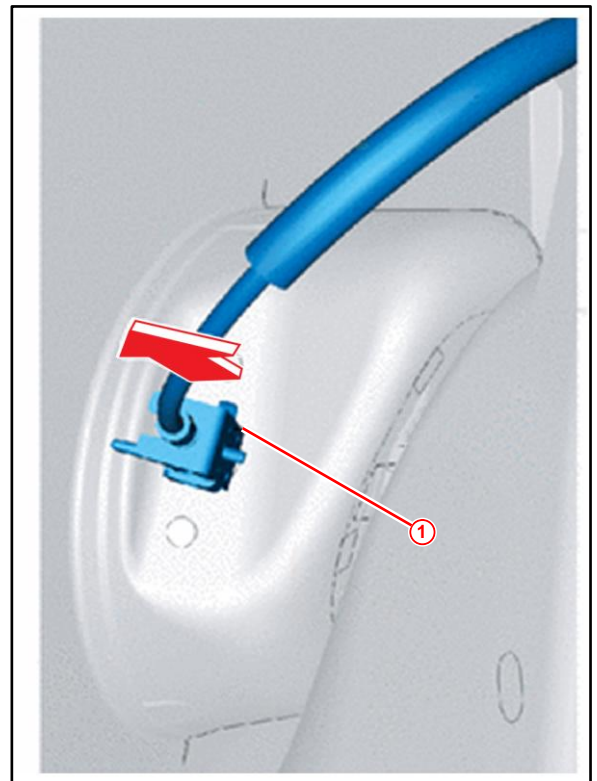

<b>1</b>	<b>Fuel Filler Lid Opener</b>
----------	-------------------------------

## Fuel Door Will Not Open

### Repair Procedure (Continued)

6. Rotate the fuel lid opener 180 degrees to the right and reinstall.

**NOTE**

The open side will face the inboard side of the vehicle.

7. Connect the fuel lid lock control cable assembly.
8. Attach ALL the stopper bracket tabs.
9. Install the service hole cover.
10. Install the nut.  
**Torque: 4.5 N\*m (46 kgf\*cm, 40 in\*lbf)**
11. Confirm repair and proper operation.

Figure 5.

