



SI B41 03 16
Body

May 2017
Technical Service

EDGE CORROSION IN THE INNER DOOR JAMB AREA

MODEL

F22 (2 Series Coupe)	F23 (2 Series Convertible)	F25 (X3)	F26 (X4)
F30 (3 Series Sedan)	F31 (3 Series Sport Wagon)	F32 (4 Series Coupe)	F33 (4 Series Convertible)
F34 (3 Series Gran Turismo)	F36 (4 Series Gran Coupe)	F48 (X1)	

SITUATION

Corrosion on inner door panels at the following holes and cavity openings:

- Door brake (1).
- Door wiring harness pass-thru (2).
- Window Cavity Seal (3).

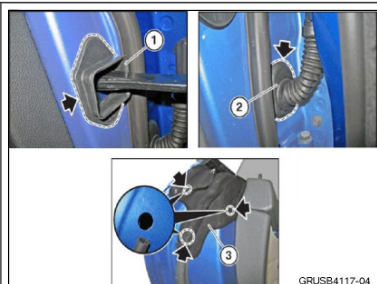

AFFECTED VEHICLES

Applicability of this bulletin is determined by the location of the corrosion and the vehicle production date, on a model-by-model basis.

The chart below details which vehicles are affected.

Model	Applicable Production dates for each affected area		
Door Brake	Wire Harness	Window Cavity Seal	
F22 (2 Series Coupe)	N/A	thru 11/2015	All
F23 (2 Series Convertible)	N/A	thru 11/2015	All
F25 (X3)	N/A	thru 3/2016	N/A
F26 (X4)	N/A	thru 3/2016	N/A
F30 (3 Series Sedan)	thru 5/2015	thru 11/2015	N/A

F31 (3 Series Sport Wagon)	thru 5/2015	thru 11/2015	N/A
F32 (4 Series Coupe)	N/A	thru 11/2015	N/A
F33 (4 Series Convertible)	N/A	thru 11/2015	All
F34 (3 Series Gran Turismo)	thru 5/2015	thru 11/2015	All
F36 (4 Series Gran Coupe)	thru 5/2015	thru 11/2015	All
F48 (X1)	thru 11/2016	thru 3/2016	thru 9/2016

N/A = Not Applicable to any vehicles produced for this model

All = all vehicles produced since model introduction

CAUSE

Friction between materials over time.

CORRECTION

Refinish corroded areas.

PROCEDURE

For conditions that are similar to the situation described on applicable vehicles:

Refer to the repair attachment (Repair Attachment A - 41 03 16).



Note: Door replacement is not acceptable as a remedy for this situation.

WARRANTY INFORMATION

Limited Warranty - Rust Perforation

Under the terms of the BMW New Vehicle Limited Warranty for Passenger Cars and Light Trucks, BMW of North America, LLC warrants the vehicle's original sheet metal body components against defects in materials or workmanship that would result in rust perforation.

The "Limited Warranty - Rust Perforation" coverage period applies to the first 12 years, as determined by the vehicle's original in-service date, without mileage limitation.

Prior Area Aftersales Manager (AAM) inspection and two competitive repair estimates are required.

Competitive estimates are not required if the work is performed at a BMW Certified Collision Repair Center (CCRC).

While there may have been a decision to use non-genuine BMW (Original) Parts (sheet metal body component) to perform **prior** repair services, BMW NA is not obligated to pay for repairs of the non-genuine BMW Parts or for repairs of any damage resulting from the use of non-genuine parts.

In addition to other reasons, this warranty shall be null and void for those sheet metal body components that were previously repaired improperly and/or replaced with used or salvaged automobile parts.

Repairs to address minor cosmetic issues on affected doors and/or blend-in panels are claimable in conjunction with performing the repair procedure to correct the issue described in this bulletin. However, repairs that are required to address moderate to severe accident or any other unrelated damage (affected door and/or blend-in panels) are not claimable.

Repairing One or Both Front Doors

Defect Code:	4151007500	Front door - corroded
--------------	------------	-----------------------

And:

Sublet – Front Door(s) Sheet Metal Repair and Refinishing

Sublet Code “3”	Sublet amount, see below	Reimbursement for the sheet metal repair and paint work (Certified Collision Center or third-party body shop)
------------------------	--------------------------	---

And/or:

Repairing One or Both Rear Doors

Defect Code:	4152007500	Rear door - corroded
---------------------	-------------------	-----------------------------

And:

Sublet – Sheet Metal Repair and Refinishing

Sublet Code “3”	Sublet amount, see below	Reimbursement for the sheet metal repair and paint work (Certified Collision Center or third-party body shop)
------------------------	--------------------------	---

Sheet Metal Repair and Refinishing

Invoice eligible sheet metal repair and refinishing work on the repair order at the actual cost charged with no handling or markup. The sublet amount must also include any discounts or allowances.

The appropriate charge for “necessary repair-related paint work procedures” is determined by comparing the charged amount against the corresponding amount that is based on your warranty rates.

Prior to performing the repair, calculate your center’s repair cost and then obtain outside two competitive repair estimates for price comparison purposes (CCRC’s are excluded).

It is your center’s responsibility to review the estimate to ensure the amount requested to perform the sheet metal repair and refinishing is customary*, fair and reasonable.

Explain the scope of the repair performed and Itemize the sublet amount(s) on the repair order and in claim comment section.

***Aftermarket (non-BMW) body shop labor time guide together with the “customary reimbursement rates” for mechanical, body/sheet metal and paint/refinish.**

ATTACHMENTS

View PDF attachment [Repair Attachment A B41 03 16 V3](#).

[Copyright ©2017 BMW of North America, Inc.]