

**TECHNICAL INSTRUCTIONS**

**FOR**

**SPECIAL SERVICE CAMPAIGN H0P**

**YARIS INSTRUMENT PANEL WIRE HARNESS**

**CERTAIN 2017 MY YARIS M/T (Without Immobilizer)**

The repair quality of covered vehicles is extremely important to Toyota. All dealership technicians performing this recall are required to successfully complete the most current version of the E-Learning course "Safety Recall and Service Campaign Essentials". To ensure that all vehicles have the repair performed correctly; technicians performing this recall repair are required to currently hold at least one of the following certification levels:

- Certified Technician (Electrical)
- Expert Technician (Any Specialty)
- Master Technician
- Master Diagnostic Technician

It is the dealership's responsibility to select technicians with the above certification level or greater to perform this recall repair. Carefully review your resources, the technician skill level, and ability before assigning technicians to this repair. It is important to consider technician days off and vacation schedules to ensure there are properly trained technicians available to perform this repair at all times.

## I. OPERATION FLOW CHART

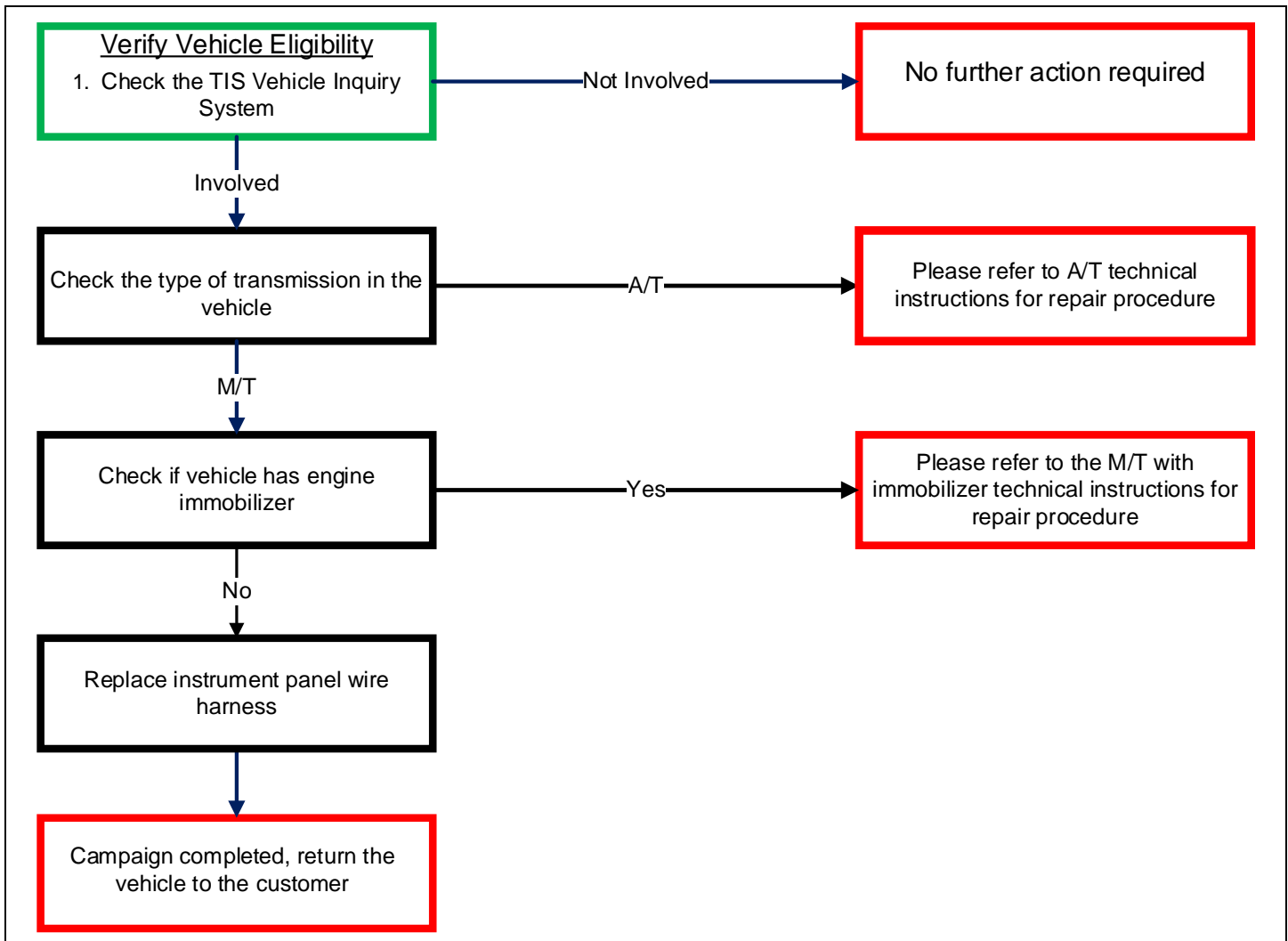

## II. IDENTIFICATION OF AFFECTED VEHICLES

- Check the TIS Vehicle Inquiry System to confirm the VIN is involved in this Safety Recall, and that the Campaign has not already been completed prior to dealer shipment or by another dealer.
- TMS warranty will not reimburse dealers for repairs completed on vehicles that are not affected or were completed by another dealer.

### III. PREPARATION

#### A. PARTS

VIN		Applicable P/N (Instrument Panel Wire Harness)	Quantity
VNKJTUD36HA072244	VNKJTUD38HA072469	04007-5910D	1pc per VIN
VNKJTUD37HA072270	VNKJTUD32HA072497		
VNKJTUD38HA072195	VNKJTUD36HA074088		
VNKJTUD33HA072234	VNKJTUD34HA074302		
VNKJTUD30HA072255	VNKJTUD32HA074329		
VNKJTUD33HA072315	VNKJTUD35HA074518		
VNKJTUD32HA072404	VNKJTUD3XHA074580		
VNKJTUD34HA072159	VNKKTUD36HA072815		
VNKJTUD39HA072206	VNKKTUD31HA072852		
VNKKTUD38HA072332	VNKKTUD39HA072999		
VNKJTUD36HA072454	VNKJTUD39HA073050		
VNKJTUD32HA072466	VNKKTUD33HA073100		
VNKKTUD3XHA072607	VNKJTUD38HA073136		
VNKKTUD33HA072691	VNKJTUD38HA073234		
VNKKTUD35HA072725	VNKJTUD38HA073279		
VNKKTUD31HA072771	VNKJTUD38HA073301		
VNKKTUD33HA074439	VNKKTUD35HA074376		

#### B. TOOLS & EQUIPMENT

- Techstream
- Protective Gloves
- Standard Hand Tools
- Torque Wrench

#### C. MATERIALS

- Protective Tape
- Marker Pen

#### IV. BACKGROUND

In the subject vehicles, an incorrect instrument panel wire harness may have been installed during the vehicle assembly process. The incorrect instrument panel wire harness may not be compatible with the Pre-Collision system front sensor. As a result, the Automatic High Beam and Pre-Collision system may be inoperative

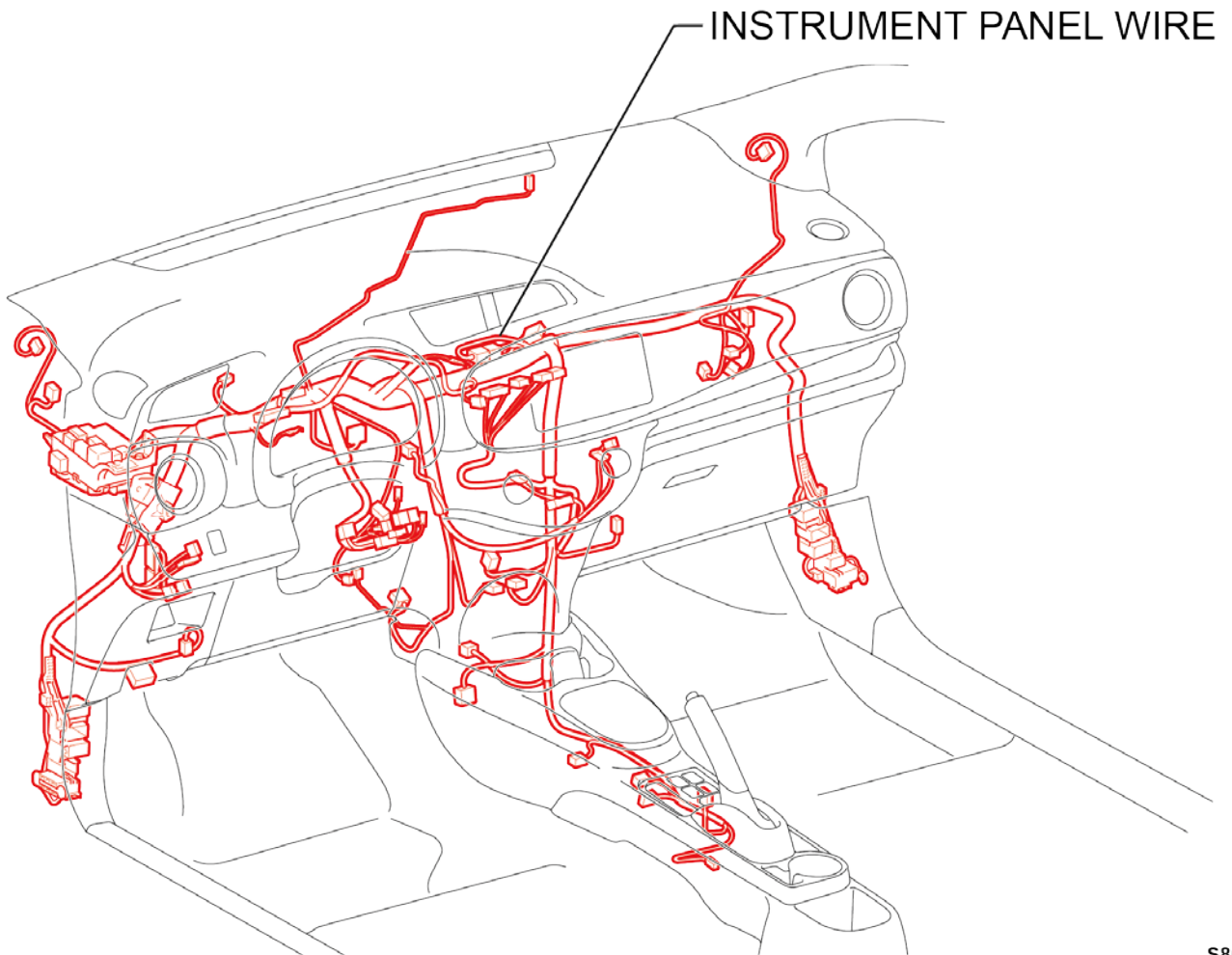

S86

# V. WORK PROCEDURE

## A. COMPONENTS

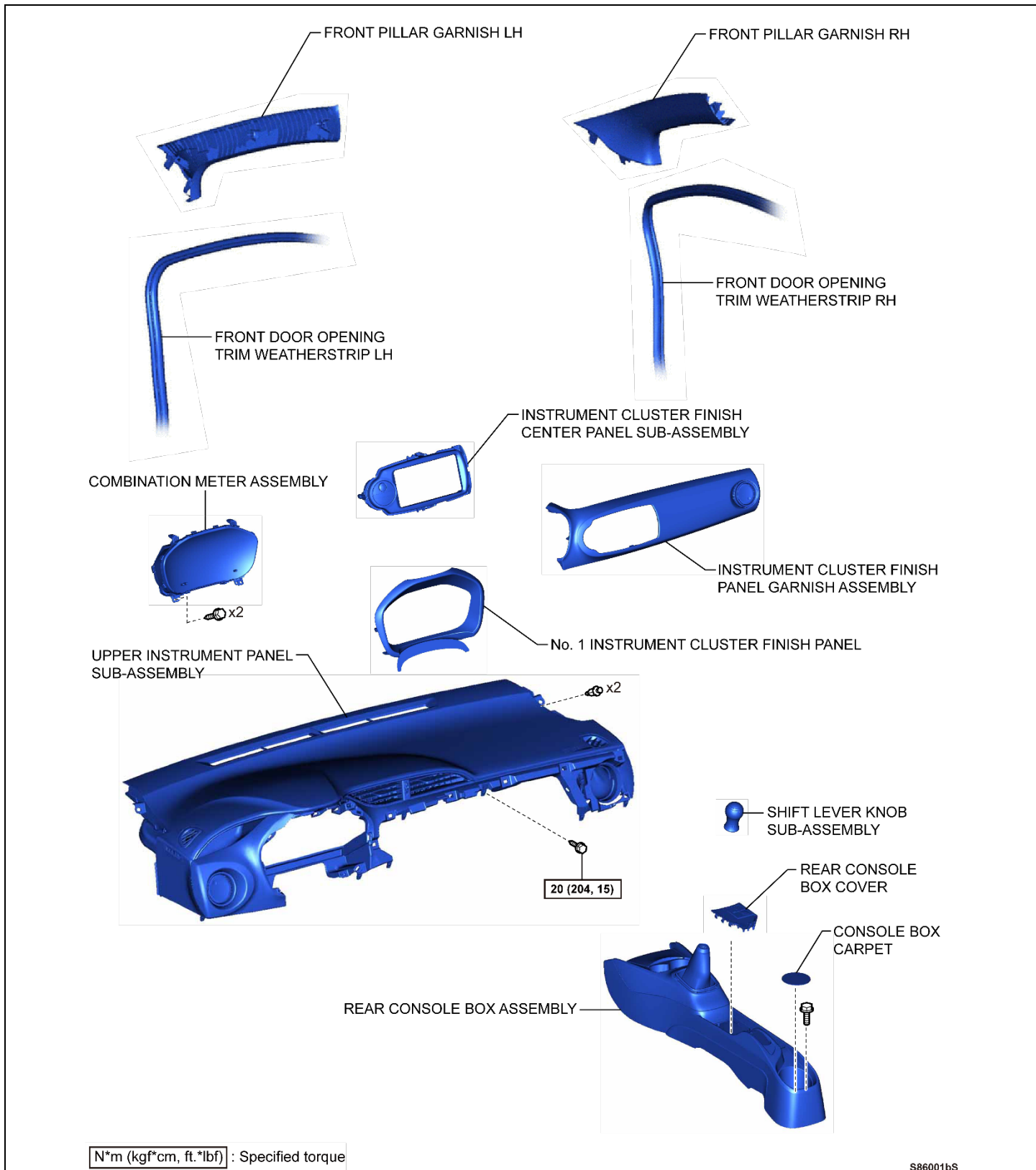

STEREO OPENING COVER WITH BRACKET



LOWER INSTRUMENT PANEL SUB-ASSEMBLY

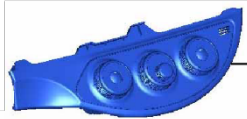

AIR CONDITIONING PANEL ASSEMBLY

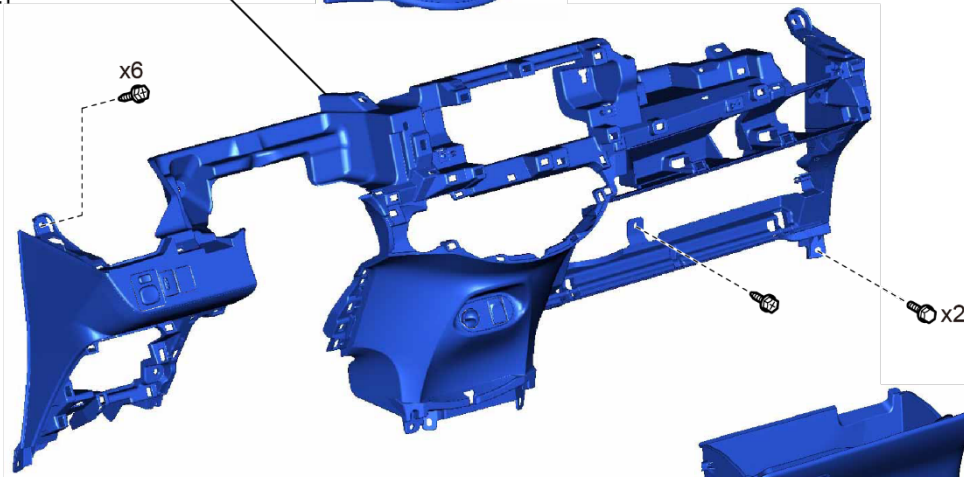

HOOD LOCK CONTROL LEVER SUB-ASSEMBLY



LOWER STEERING COLUMN COVER

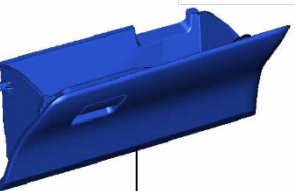
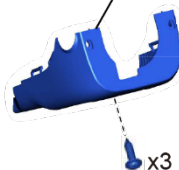

GLOVE COMPARTMENT DOOR ASSEMBLY

LOWER No. 2 INSTRUMENT PANEL FINISH PANEL



No. 2 INSTRUMENT PANEL UNDER COVER SUB-ASSEMBLY

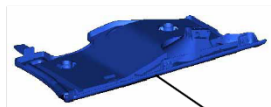

10 (102, 7)

x4

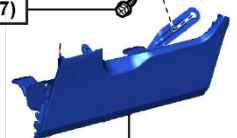

LOWER No. 1 INSTRUMENT PANEL AIRBAG ASSEMBLY

COWL SIDE TRIM BOARD RH



COWL SIDE TRIM BOARD LH



FRONT DOOR SCUFF PLATE RH



FRONT DOOR SCUFF PLATE LH



No. 1 INSTRUMENT PANEL UNDER COVER SUB-ASSEMBLY

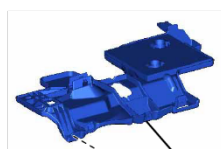

N\*m (kgf\*cm, ft.\*lbf) : Specified torque

S86002aS

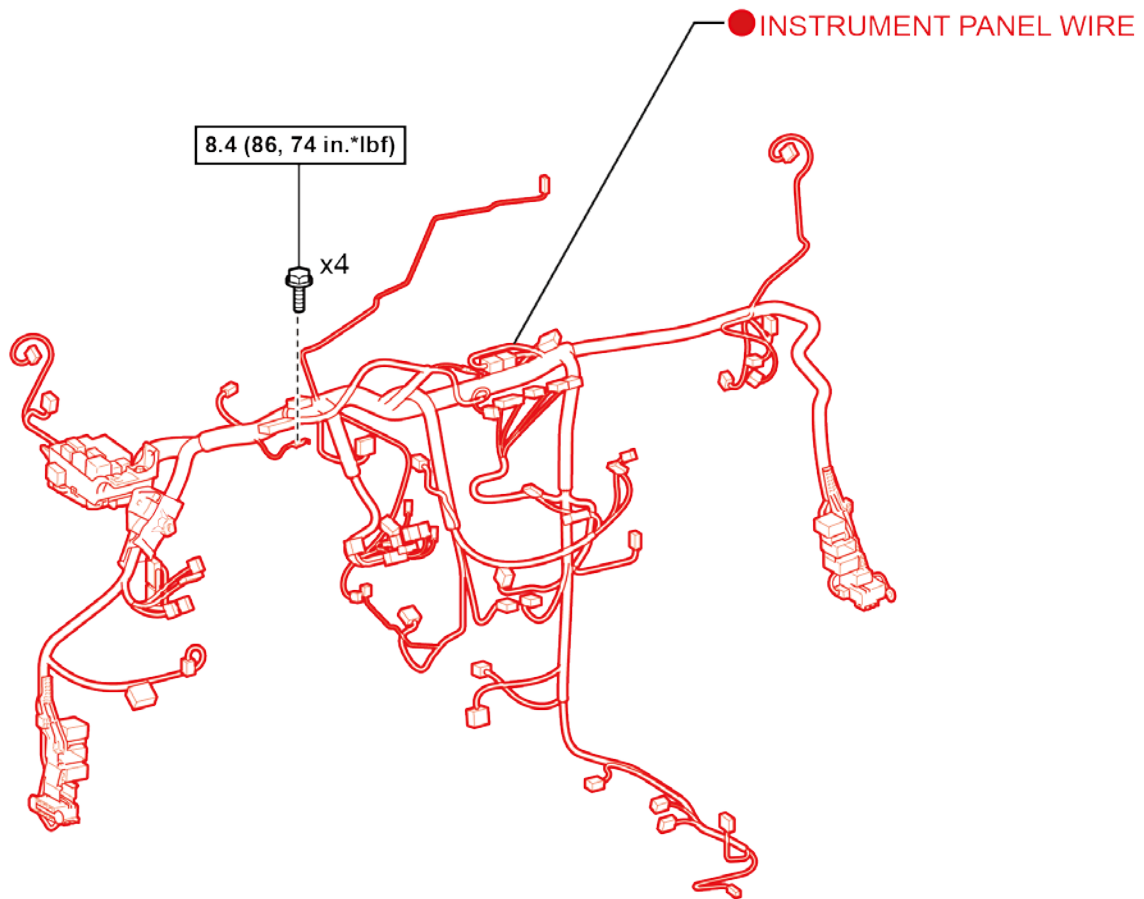

● : Component to be replaced

**N\*m (kgf\*cm, ft.\*lbf)** : Specified torque

S86008aS

## VI. REMOVE INSTRUMENT PANEL WIRE HARNESS

### 1. CHECK FOR DTC's

- If a DTC(s) is displayed, record the DTC(s) and the freeze frame data and perform the repairs as necessary

### 2. RECORD AUDIO AND AIR CONDITIONING SETTINGS

- When the battery cable is disconnected, the settings for the audio, air conditioning, etc. may be reset. Therefore, make a note of the settings before disconnecting the cable from the negative (-) battery terminal

### 3. DISCONNECT CABLE FROM NEGATIVE BATTERY TERMINAL



**For models with a navigation system, wait at least 6 minutes before disconnecting the battery. It takes approximately 6 minutes for the system to save information and settings after the ignition switch is turned off.**



### 4. WEAR PROTECTIVE GLOVES



**Be sure to wear protective gloves. Sharp edges on components such as burrs may injure your hands.**

### 5. SEPARATE FRONT DOOR OPENING TRIM WEATHERSTRIP RH AND LH

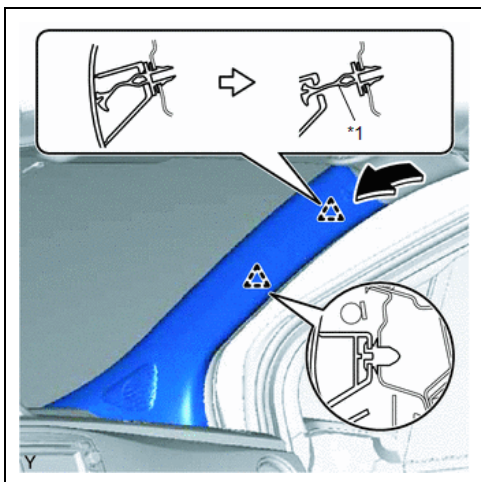

### 6. REMOVE FRONT PILLAR GARNISH RH

- Disengage the front pillar garnish clips

**NOTE: The front pillar garnish clip should remain between the front pillar garnish and the pillar**

*1	Front Pillar Garnish Clip
----	---------------------------



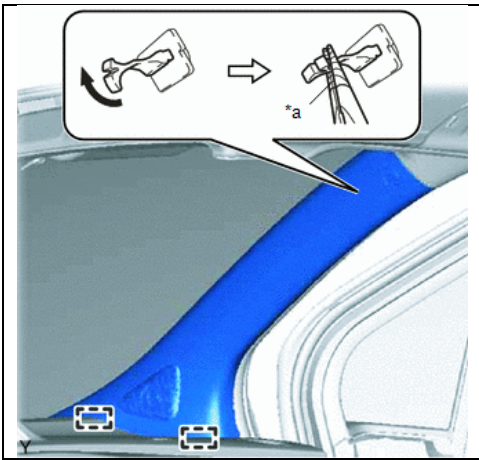

- b. Using needle nose pliers with its tip wrapped in tape, turn the front pillar garnish clip 90° and disengage it from the front pillar garnish

*a	Protective Tape
----	-----------------

**NOTE: Do NOT remove the front pillar garnish clip from the vehicle as long as it is not damaged. If removed, the front pillar garnish clip will require replacement.**

- c. Disengage the 2 guides to remove the front pillar garnish

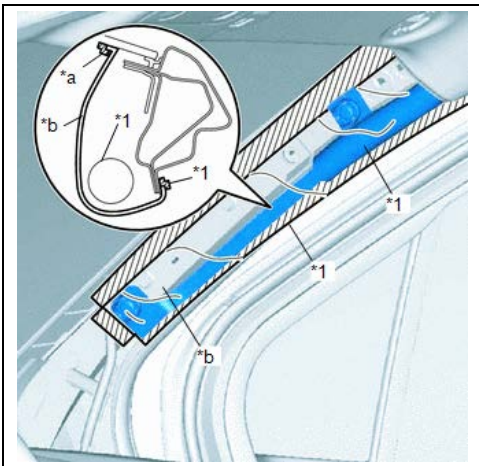

- d. Disconnect the connector for the speaker (w / 6 speakers)  
 e. Protect the curtain shield airbag assembly by covering it with a cloth or piece of nylon and secure the ends of the cover with tape as shown in the illustration.

*1	Curtain Shield Airbag Assembly
*a	Adhesive Tape
*b	Protective Cover

## 7. REMOVE THE FRONT PILLAR GARNISH LH

- a. Use the same procedure as the RH side

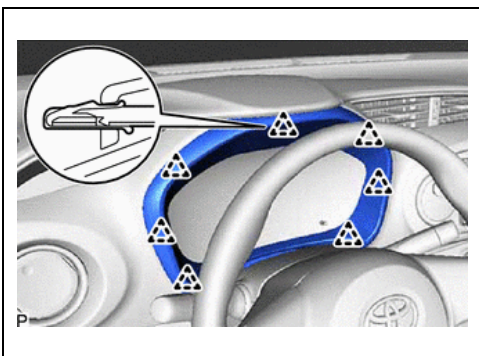

## 8. REMOVE NO. 1 INSTRUMENT CLUSTER FINISH PANEL

- a. Disengage the 7 clips to remove the No.1 instrument cluster finish panel

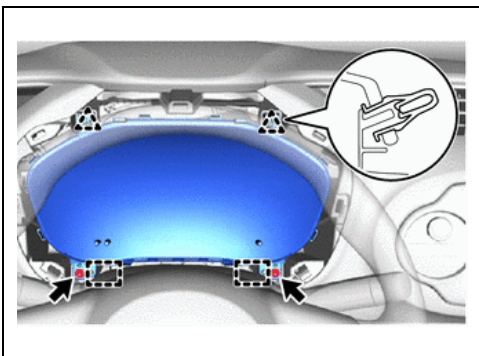

## 9. REMOVE THE COMBINATION METER ASSEMBLY

- a. Remove the 2 screws  
 b. Disengage the 2 clips and 2 guides  
 c. Disconnect the 2 connectors to remove the combination meter assembly

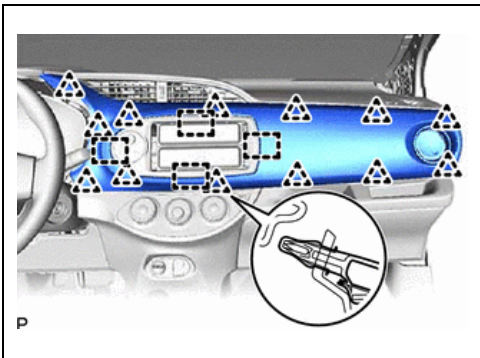

**10. REMOVE THE INSTRUMENT CLUSTER FINISH PANEL GARNISH ASSEMBLY**

- a. Disengage the 13 clips and 4 guides to remove the instrument cluster finish panel garnish assembly

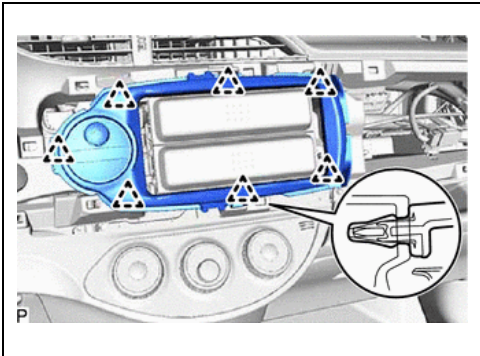

**11. REMOVE INSTRUMENT CLUSTER FINISH CENTER PANEL SUB-ASSEMBLY**

- a. Disengage the 7 clips
- b. Disconnect the connector to remove the instrument cluster finish center panel sub-assembly

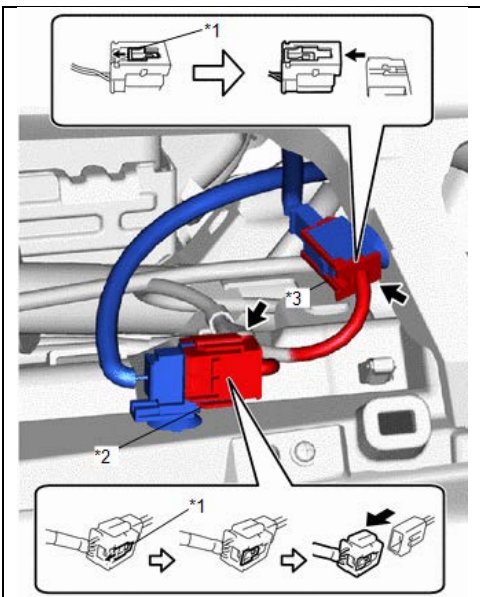

**12. REMOVE INSTRUMENT PANEL SUB-ASSEMBLY**

- a. Slide the slider and disconnect the front passenger airbag connector
- b. Slide the slider and disconnect the vent hole connector

*1	Slider
*2	Airbag Connector
*3	Vent Hole Connector

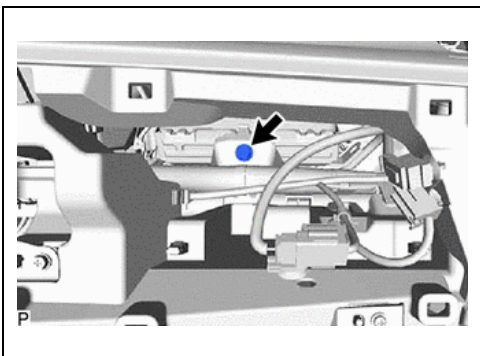

- c. Remove the <B> bolt

- d. Disengage the clamps
- e. Disconnect the connectors
- f. Remove the 2 clips
- g. Disengage the 8 clips while lifting the rear instrument panel up
- h. While lifting the instrument panel, slide it toward the rear of the vehicle. Disengage the 5 guides of the front side of the instrument panel to remove the upper instrument panel
- i. Detach the lower steering column cover

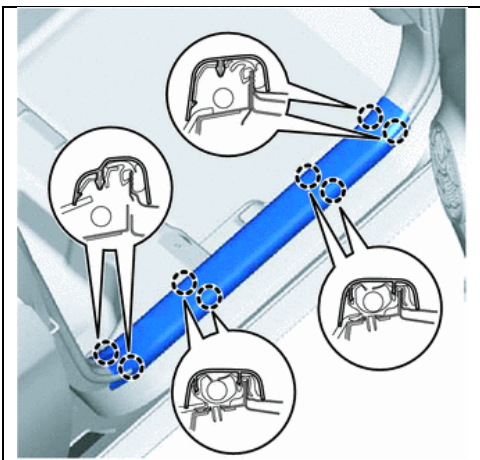
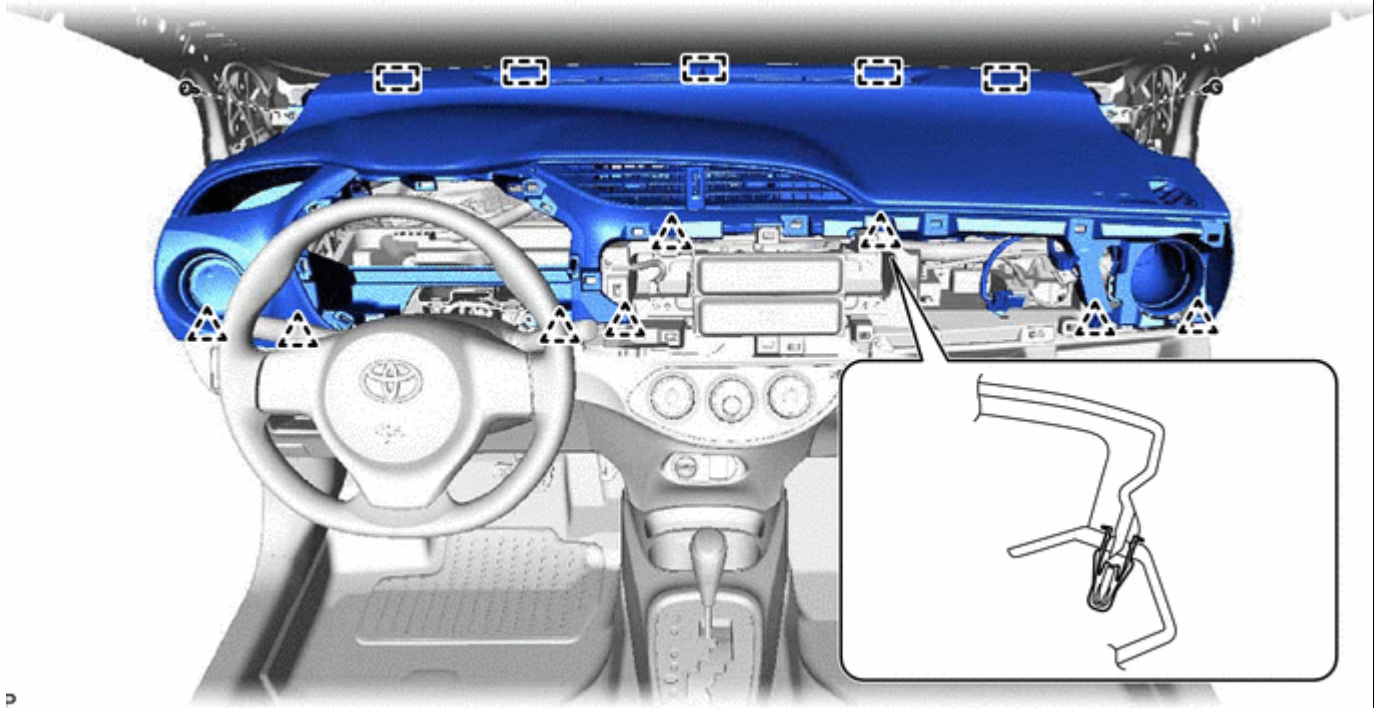

**13. REMOVE FRONT DOOR SCUFF PLATE RH**

- a. Disengage the 8 claws to remove the front door scuff plate RH

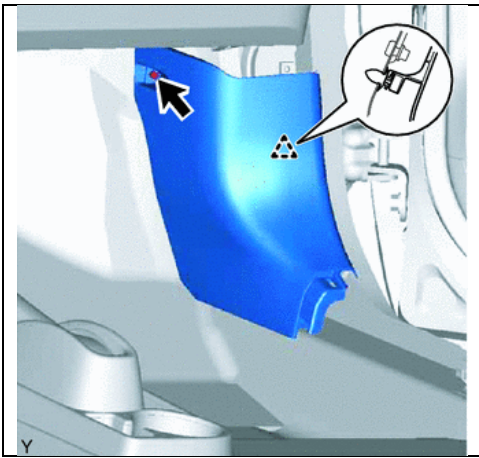

**14. REMOVE COWL SIDE TRIM BOARD RH**

- a. Remove the clip
- b. Disengage the clip to remove the cowl side trim board RH

**15. REMOVE FRONT DOOR SCUFF PLATE LH**

- a. Use same procedure as RH side

**16. REMOVE COWL SIDE TRIM BOARD LH**

- a. Use the same procedure as RH side

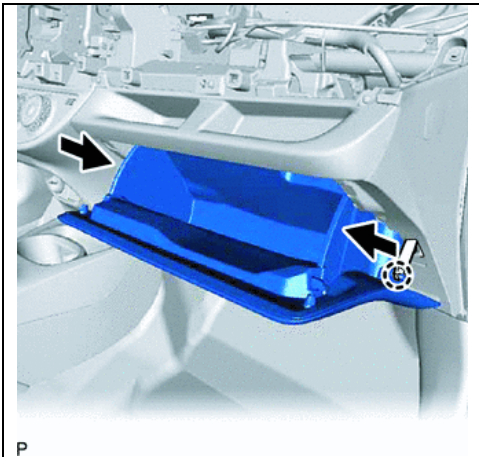

**17. REMOVE GLOVE COMPARTMENT DOOR ASSEMBLY**

- a. Disengage the claw to separate the glove compartment door stopper from the glove compartment door
- b. Slightly flex the upper part of the glove compartment door to release the 2 stoppers and open the glove compartment door until it is horizontal

- c. Pull the glove compartment door out horizontally to disengage the 2 hinges and 3 guides to remove the glove compartment door

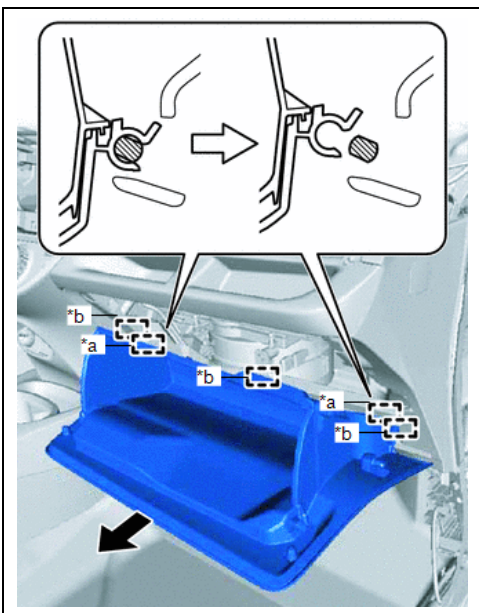

*a	Hold
*b	Turn

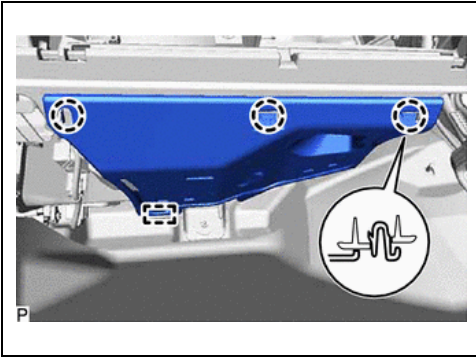

**18. REMOVE NO.2 INSTRUMENT PANEL UNDER COVER SUB-ASSEMBLY**

- a. Disengage the 3 claws and guide to remove the No. 2 instrument panel under cover
- b. (w/ Footwell Light) Disconnect the connector

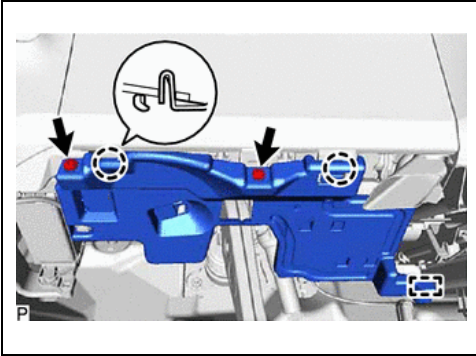

**19. REMOVE THE NO.1 INSTRUMENT PANEL UNDER COVER SUB-ASSEMBLY**

- a. Remove the 2 <A> screws
- b. Disengage the 2 claws and guide to remove the No. 1 instrument panel under cover sub-assembly
- c. (w/ Footwell Light) Disconnect the connector

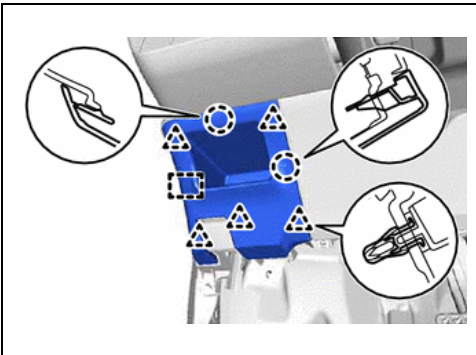

**20. REMOVE THE LOWER NO.2 INSTRUMENT PANEL FINISH PANEL**

- a. Disengage the 5 clips, 2 claws and guide to remove the No.2 instrument panel finish panel

**NOTE: The number of clips varies depending on vehicle options**

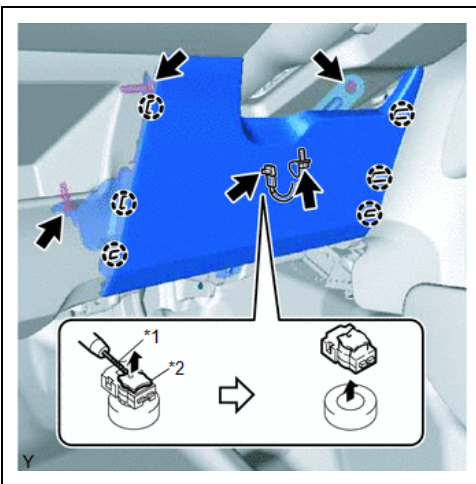

**21. REMOVE THE LOWER NO.1 INSTRUMENT PANEL AIRBAG ASSEMBLY**

- a. Remove the 4 bolts
- b. Disengage the 6 claws to separate the lower No.1 instrument panel airbag assembly
- c. Using a screwdriver with its tip wrapped in protective tape, release the locking button
- d. Disconnect the airbag connector to remove the lower No.1 instrument panel airbag assembly

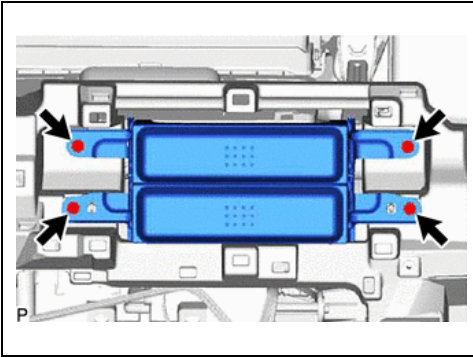

## 22. REMOVE THE STEREO

- a. Remove the 4 screws and stereo
- b. Disconnect the connectors behind the stereo

**NOTE:** Depending on the vehicle options there will be a various number of connectors located behind the stereo

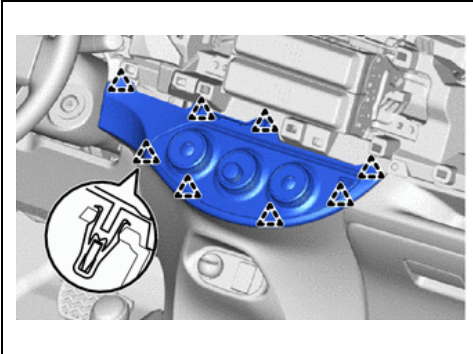

## 23. SEPARATE THE AIR CONDITIONING PANEL ASSEMBLY

- a. Disengage the 8 clips
- b. Disconnect the connector to separate the air conditioning panel assembly

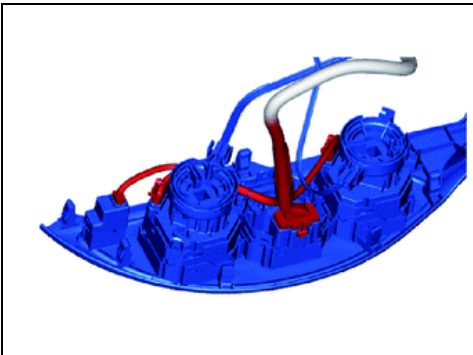

- c. Disconnect the connector to separate the air conditioning panel assembly

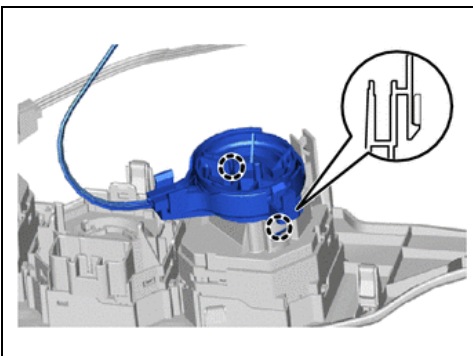

## 24. DISCONNECT THE DEFROSTER DAMPER CONTROL CABLE SUB-ASSEMBLY

- a. Disengage the 2 claws to disconnect the defroster damper control cable sub-assembly

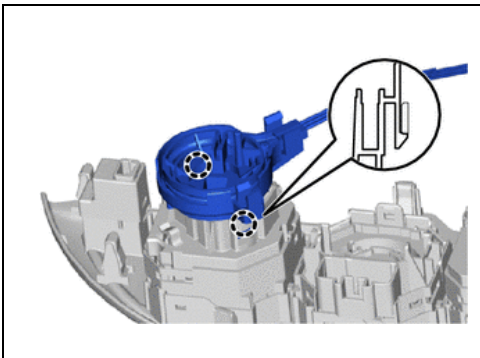

**25. DISCONNECT THE AIR MIX DAMPER CONTROL CABLE SUB-ASSEMBLY**

- a. Disengage the 2 claws to disconnect the air mix damper control cable sub-assembly

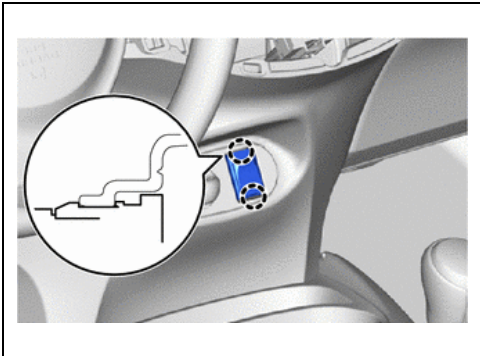

**26. REMOVE NO.1 STEREO JACK ADAPTER ASSEMBLY**

- a. Disconnect the connector
- b. Disengage the 2 claws to remove the No.1 Stereo jack adapter assembly

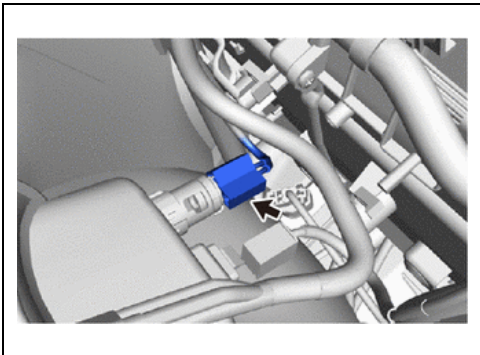

**27. REMOVE NO.1 POWER OUTLET SOCKET ASSEMBLY**

- a. Disconnect the connector

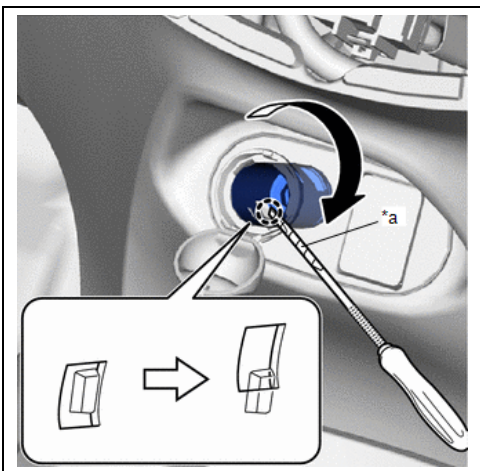

- b. Using a screwdriver wrapped in protective tape, disengage the claw, then turn the No.1 power outlet socket clockwise and pull the power outlet socket half way out.

*a	Protective Tape
----	-----------------

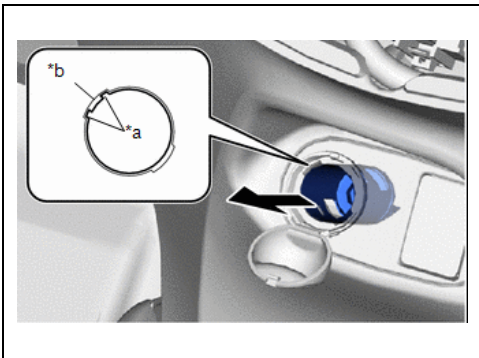

c. Align the protrusion of the No.1 power outlet socket cover with the cutout of the No.1 power outlet socket cover and then pull the No.1 power outlet socket assembly out

*b	Protrusion
*a	Cutout

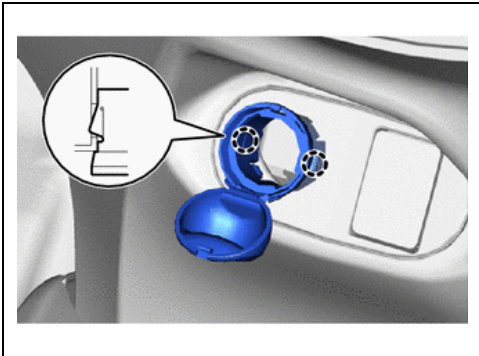

**28. REMOVE NO.1 POWER OUTLET SOCKET COVER**

a. Disengage the 2 claws to remove the No. 1 power outlet socket cover

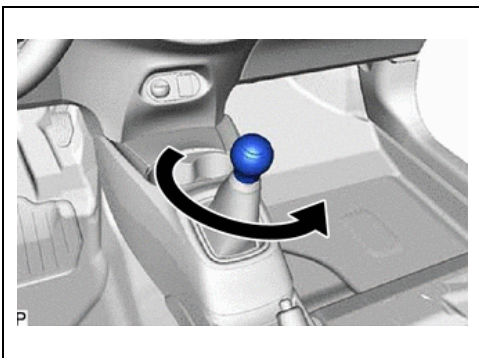

**29. REMOVE SHIFT LEVER KNOB SUB-ASSEMBLY**

a. Turn the shift lever knob sub-assembly counterclockwise and remove the shift lever knob sub-assembly

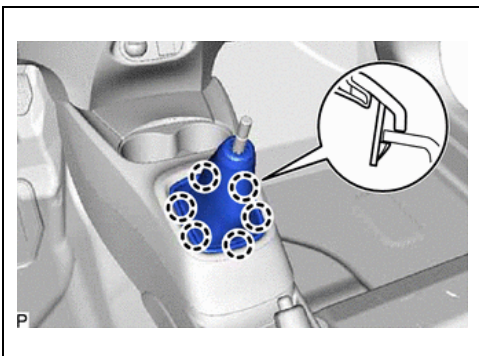

**30. REMOVE THE SHIFTING HOLE COVER SUB-ASSEMBLY**

a. Disengage the 6 claws to remove the shifting hole cover sub-assembly

**NOTE: Do not remove the cover. It is not necessary for repair**



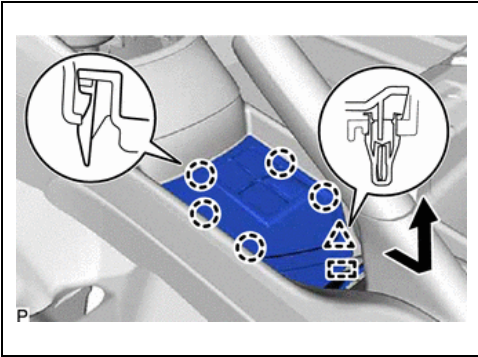

### 31. REMOVE THE REAR CONSOLE BOX COVER

- a. Disengage the 5 claws and clip
- b. Disengage the guide and pull out the rear console box cover as shown in the illustration
- c. Disconnect the connectors to remove the rear console box cover

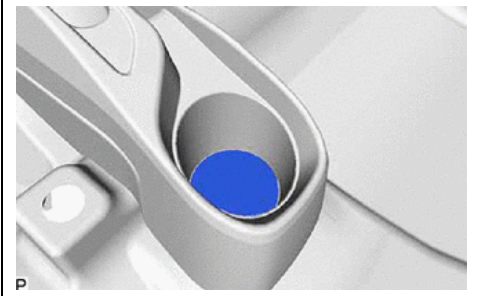

### 32. REMOVE CONSOLE BOX CARPET

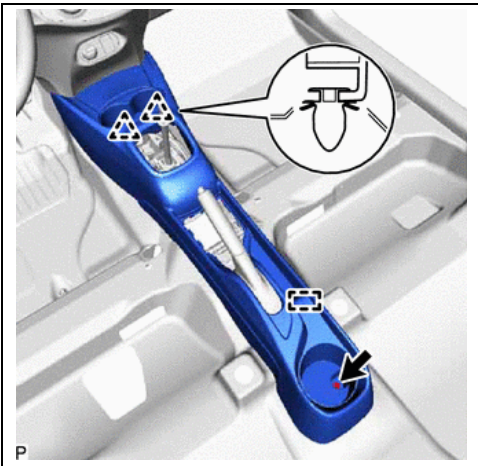

### 33. REMOVE REAR CONSOLE BOX ASSEMBLY

- a. Remove the bolt
- b. Disengage the 2 clips and guide to remove the rear console box assembly

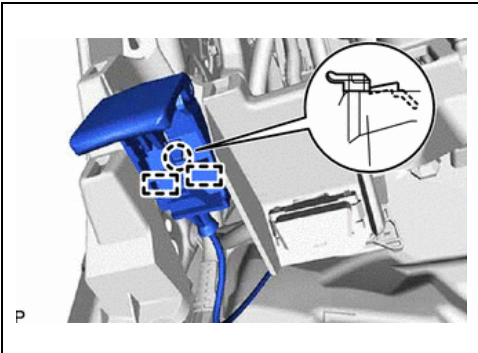

### 34. SEPARATE HOOD LOCK CONTROL LEVER SUB-ASSEMBLY

- a. Disengage the claw and 2 guides to separate the hood lock control lever

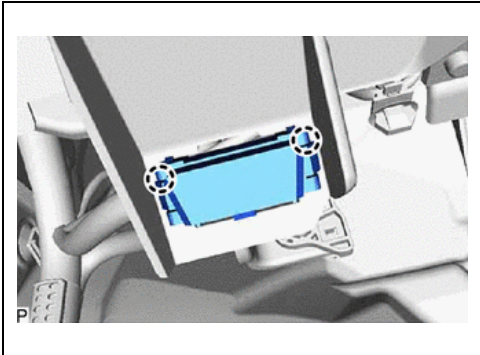

### 35. REMOVE LOWER INSTRUMENT PANEL SUB-ASSEMBLY

a. Disengage the 2 claws to disconnect the DLC3 connector

b. Disengage the clamps

c. Disconnect the connectors

d. Remove the 6 <B> or <C> bolts, <D> or <E> screw, and 2 <F> bolts from the lower instrument panel sub-assembly

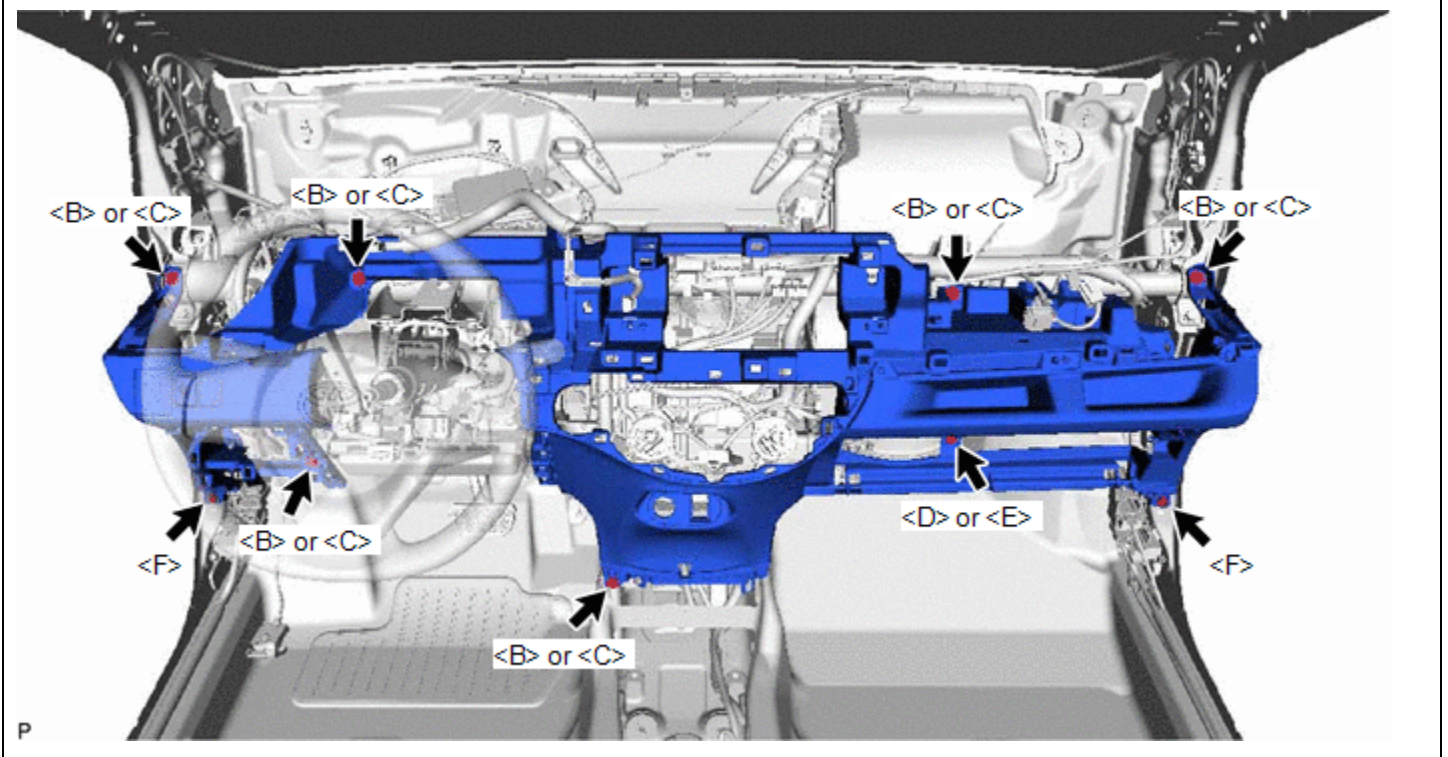

e. Disengage the 10 guides to remove the lower instrument panel sub-assembly

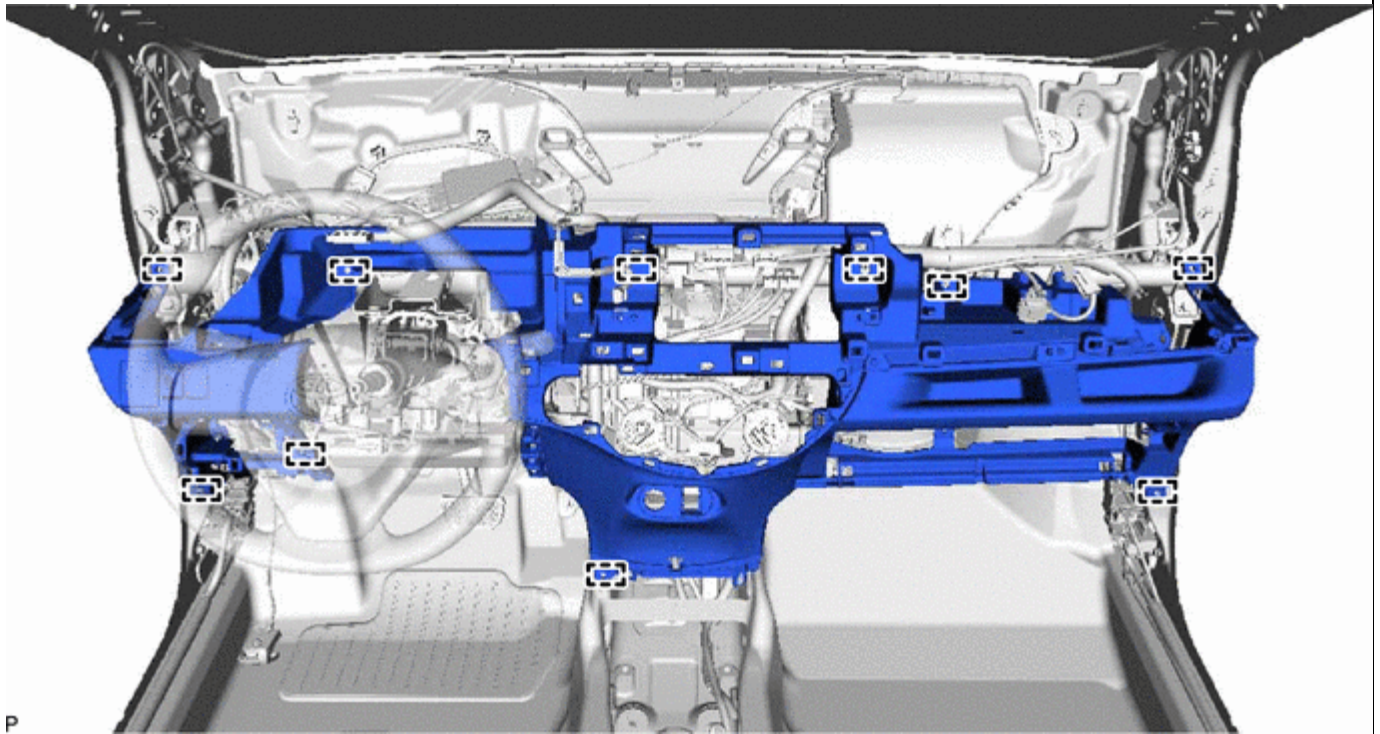

### 36. REMOVE INSTRUMENT PANEL WIRE

- a. Disconnect the connectors, disengage the clamps, and remove the screws, bolts etc. shown in the illustration

#### NOTE:

- Print this page as a check sheet, and put a mark after each disconnection or removal.
- **DO NOT** dispose of the check sheet but use it also when installing a **NEW** instrument panel wire.
- See the following pages for detailed information on sections 1) to 4) in the illustration below.

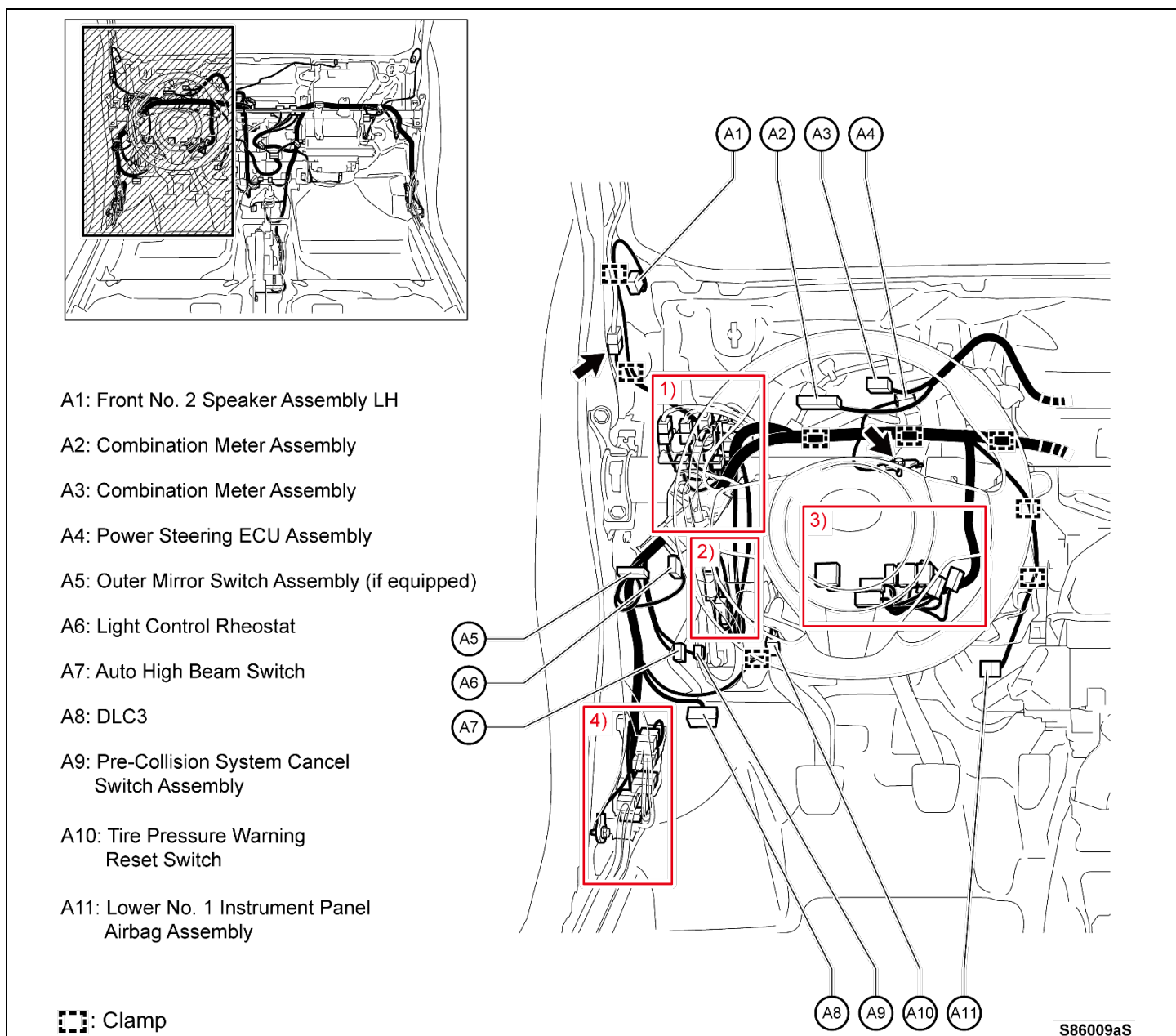

1) Instrument panel relay box

- i. Disconnect the 6 engine room main wire connectors from the instrument panel relay box
- ii. Disengage the 3 clamps
- iii. Remove the 2 screws and disengage the clamp to separate the relay box

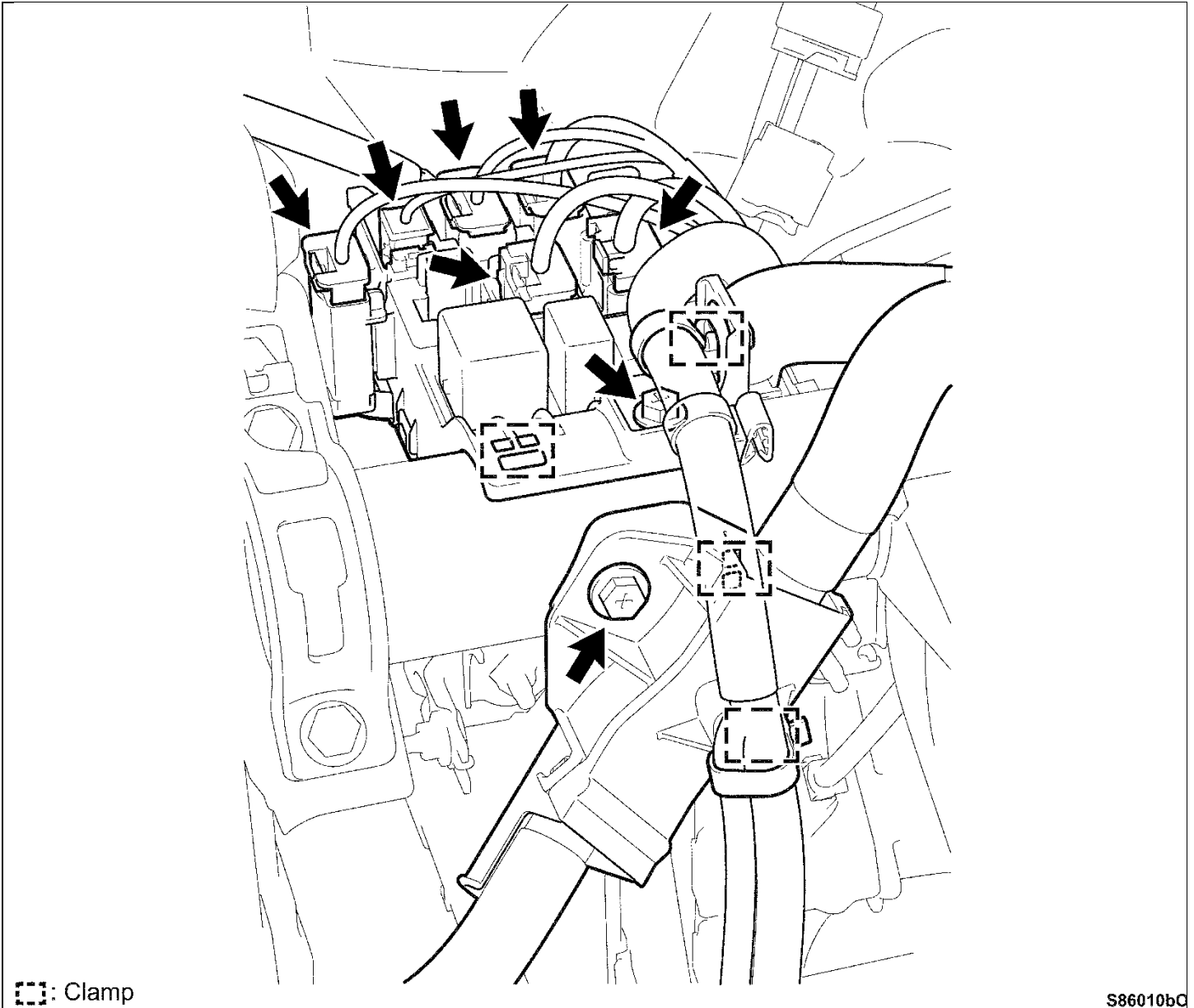

S86010bC

- iv. Remove the 3 relays from the detached instrument panel relay box, and then install them to the relay box of the **NEW** instrument panel wire as shown



**DO NOT** install the small relays in opposite positions. One is a 4 pole relay and the other is a 5 pole relay.

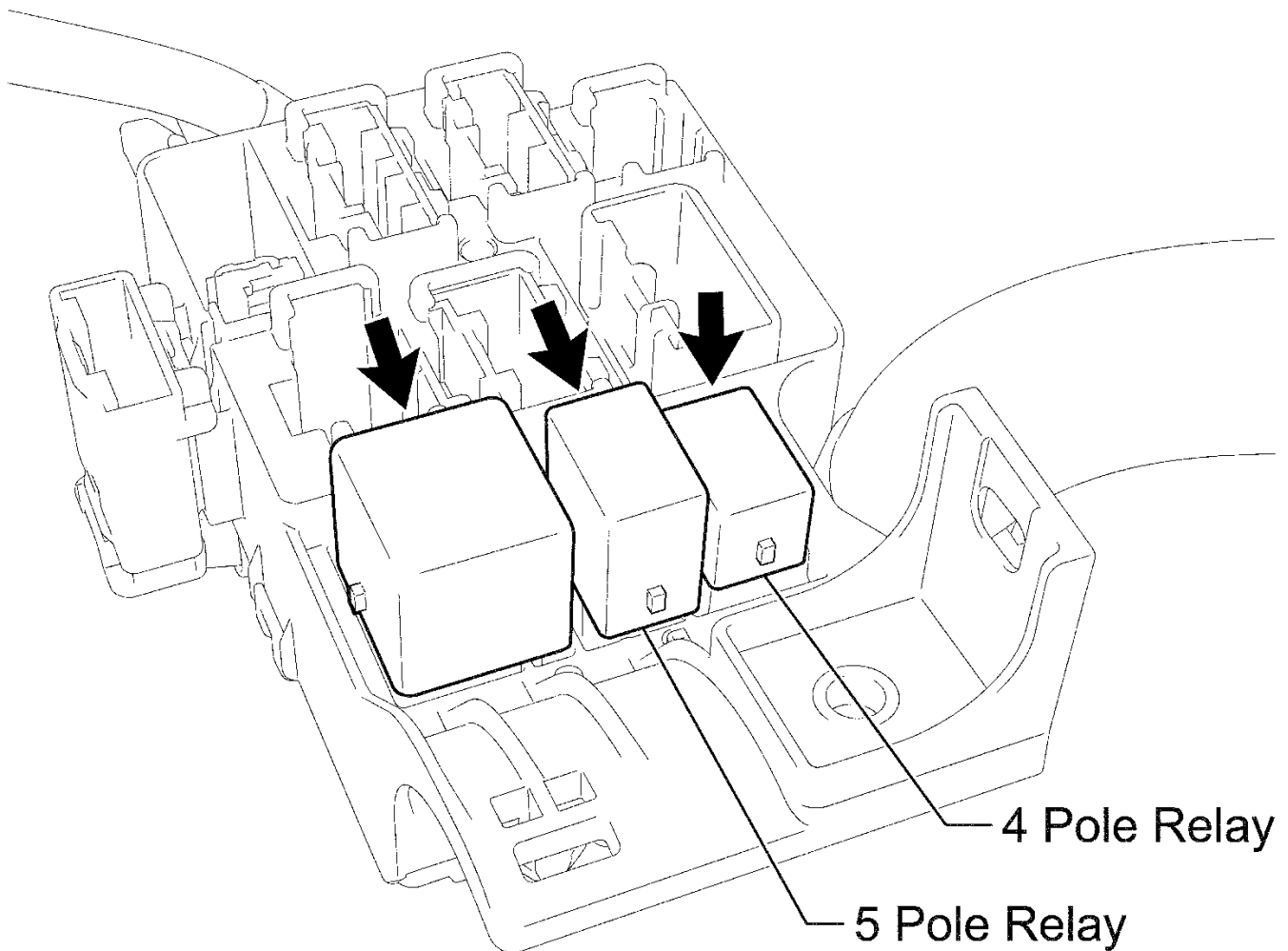

S86023b0

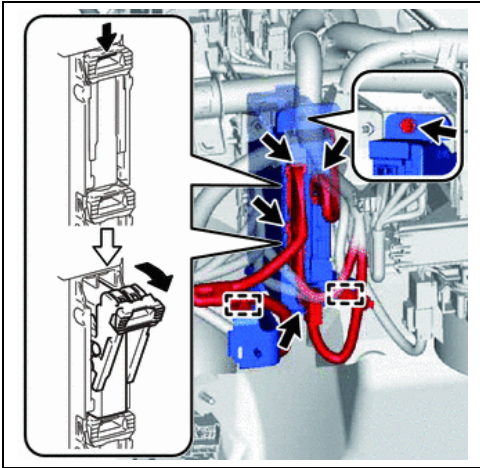

- 2) Instrument panel junction block
  - i. Disengage the clamps
  - ii. Disconnect the connectors on the front side
  - iii. Remove the bolt and separate the junction block

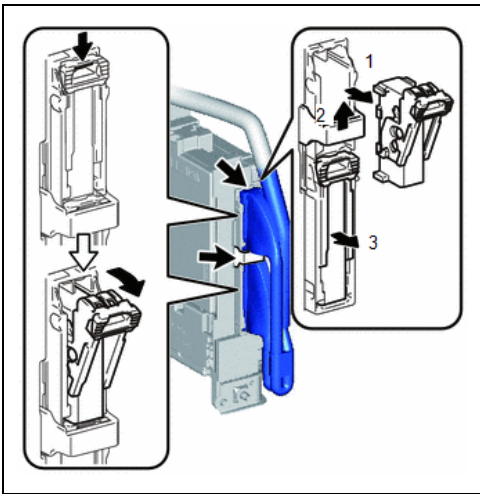

- iv. Disconnect the back-side connectors and remove the junction block as shown in the illustration

- 3) Disconnect steering column lower section connectors and clamps
  - i. Disconnect the connectors
  - ii. Disengage the 3 clamps and separate the instrument panel wire

C1: Headlight Dimmer Switch Assembly

C2: Spiral with Sensor Cable Sub-Assembly

C3: Spiral with Sensor Cable Sub-Assembly

C4: Steering Sensor (Spiral with Sensor Cable Sub-Assembly)

C5: Windshield Wiper Switch Assembly

C6: Windshield Wiper Switch Assembly

C7: Un-Lock Warning Switch Assembly

C8: Transponder Key Coil

C9: Key Interlock Solenoid

NOTE:

Connected on AT models only

C10: Ignition or Starter Switch Assembly

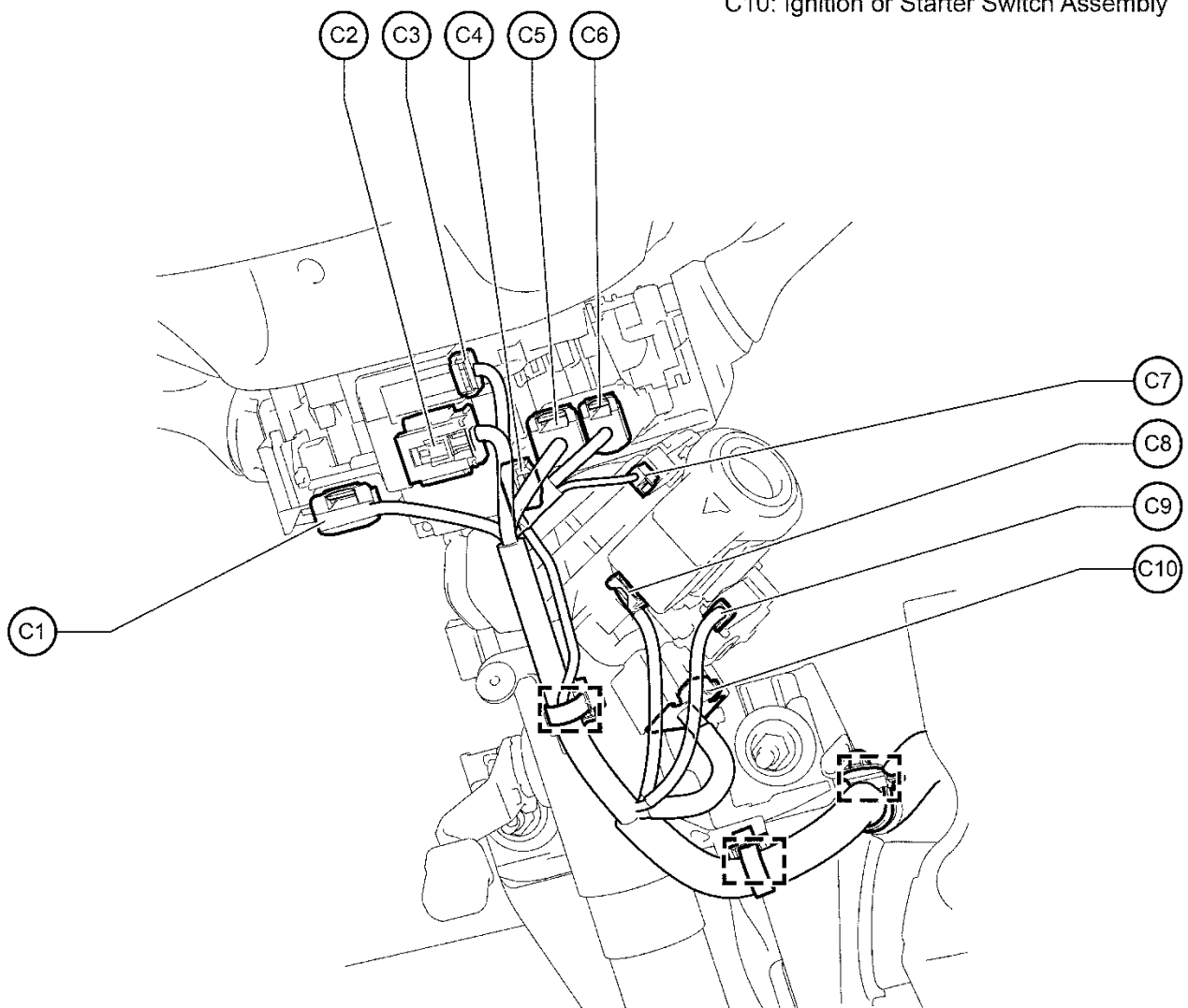

: Clamp

S86012a



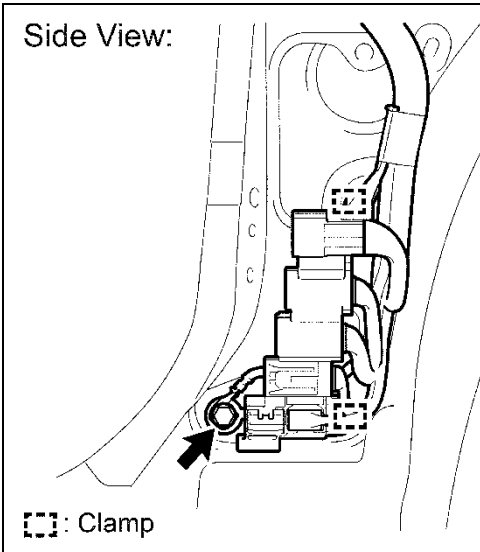
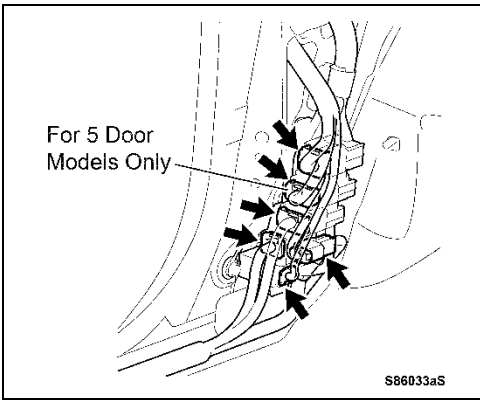

- 4) Disconnect the connectors on the RH cowl side section
  - i. Disconnect the floor wire connectors from the connector holder on the LH cowl side
    - ii. Disengage the 2 clamps
    - iii. Remove the ground bolt and separate the connector holder

b. Disconnect the connectors, disengage the clamps, and remove the bolts shown in the illustration

**NOTE:**

- Print this page as a check sheet, and put a mark after each disconnection or removal.
- **DO NOT** dispose of the check sheet but use it also when installing the **NEW** instrument panel wire.
- See the following pages for detailed information on sections 1) and 2) in the illustration below.
- For Section 1) go to the Transponder ECU section

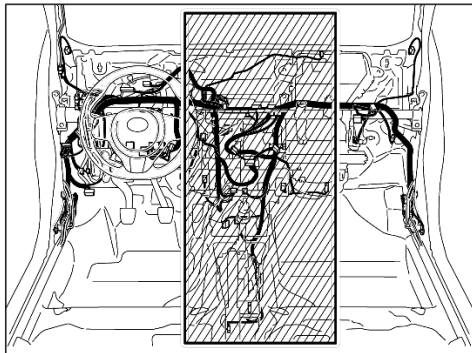

- D1: Telltale Light Assembly
- D2: Radio Receiver Assembly (if equipped)
- D3: Radio Receiver Assembly
- D4: Radio Receiver Assembly
- D5: Radio Receiver Assembly
- D6: Theft Warning Indicator Light Assembly

- D7: Pre-Collision Safety City Buzzer
- D8: No. 1 Heater Control Sub-Assembly
- D9: No. 2 Heater Control Sub-Assembly
- D10: No. 1 Cooler Thermistor
- D11: A/C Amplifier Assembly
- D12: Airbag Sensor Assembly
- D13: Oxygen Sensor (Bank 1 Sensor 2)
- D14: Shift Lock Control Unit Assembly
- D15: Shift Position Light (Indicator Light Wire Sub-Assembly)
- D16: Shift Lock Control Unit Assembly
- NOTE:**  
Connected on AT models only
- D17: VSC Off Switch
- D18: Parking Brake Switch Assembly

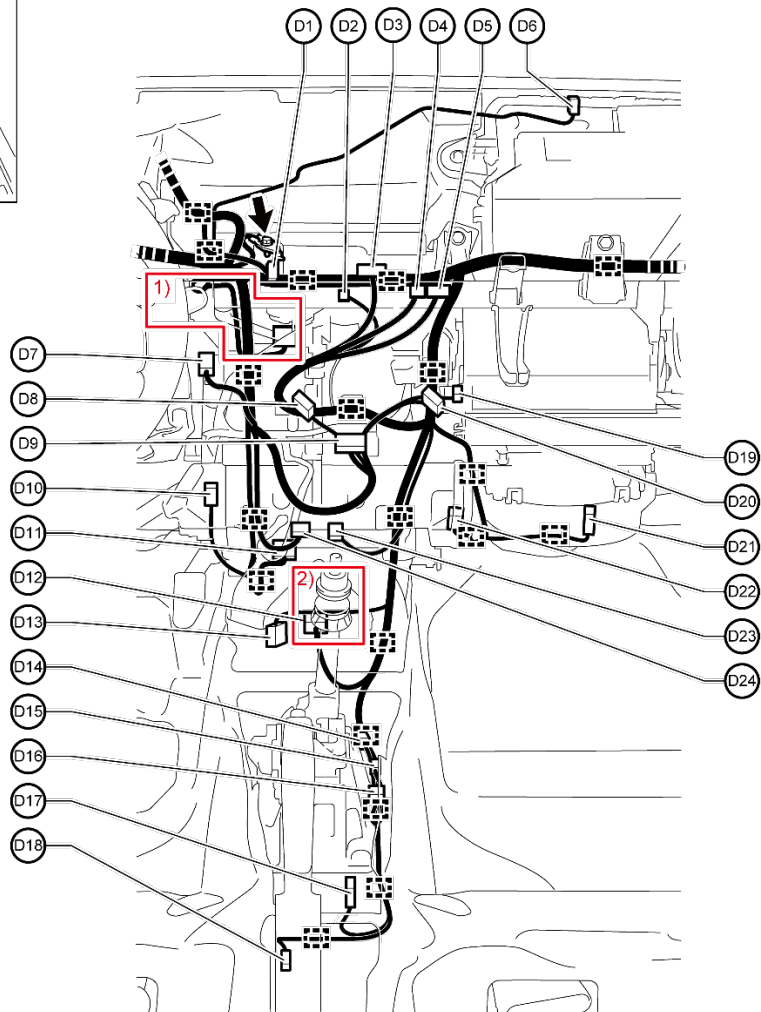

- D19: Amplifier Microphone Assembly (if equipped)
- D20: No. 3 Heater Control Sub-Assembly
- D21: Blower with Fan Motor Sub-Assembly
- D22: Blower Assembly
- D23: No. 1 Stereo Jack Adapter Assembly (if equipped)
- D24: Power Outlet Socket

 Clamp

S86014aS

2) Airbag sensor assembly connector

- i. Disconnect the connector from the airbag sensor assembly
- ii. Using a thin-bladed screwdriver, lift up the retainer to unlock the connector

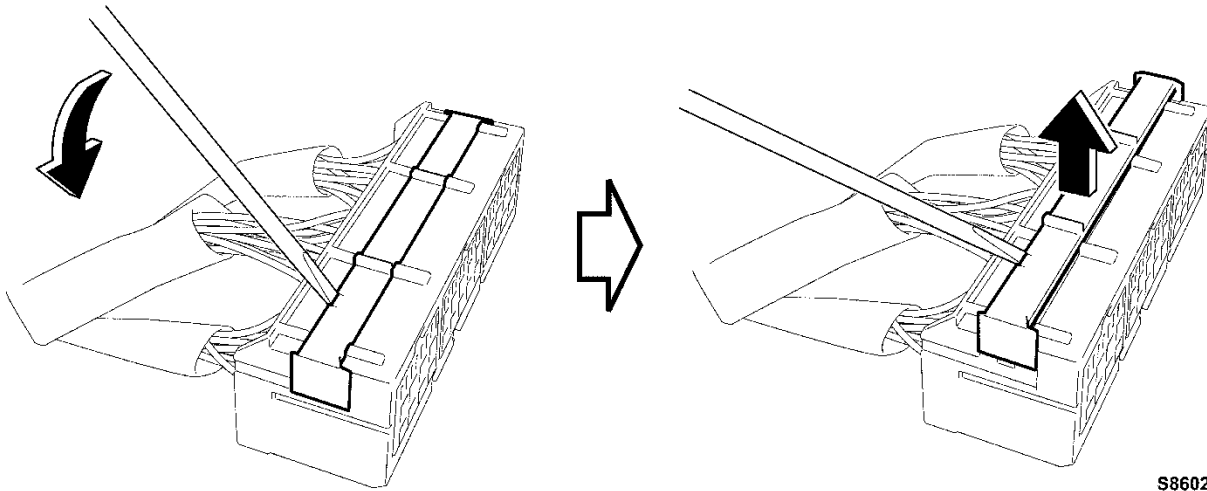

S86029aO

- iii. Insert a thin-bladed screwdriver to the location shown in the illustration below and lift up the claw inside the connector housing
- iv. While lifting up the claw, push the airbag sensor assembly connector shown in the illustration out from the connector housing

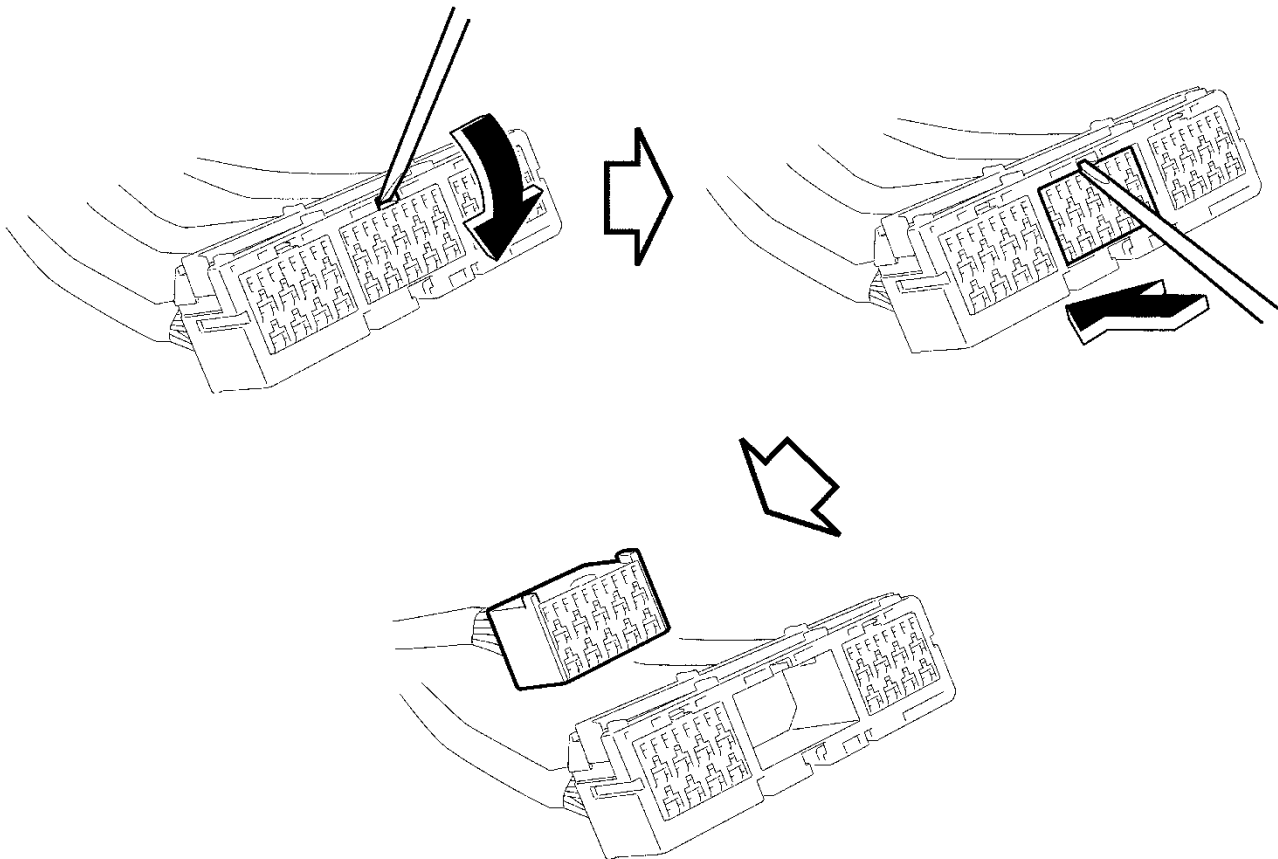

S86031aO

c. Disconnect the connectors, disengage the clamps and remove the bolt shown in the illustration

**NOTE:**

- Print this page as a check sheet, and put a mark after each disconnection or removal.
- **DO NOT** dispose of the check sheet but use it also when installing the **NEW** instrument panel wire.
- See the next page for detailed information on section 1) in the illustration below.

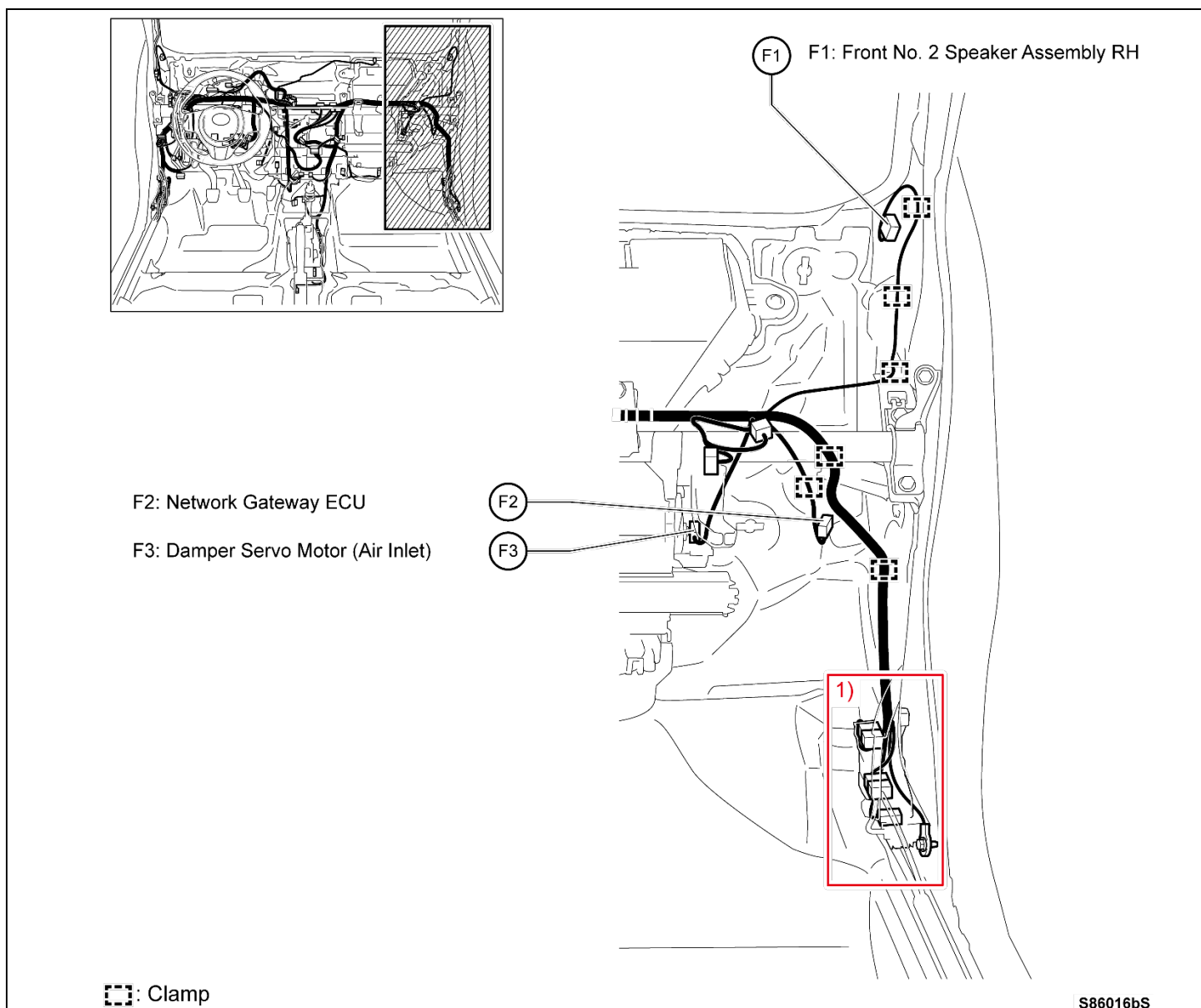

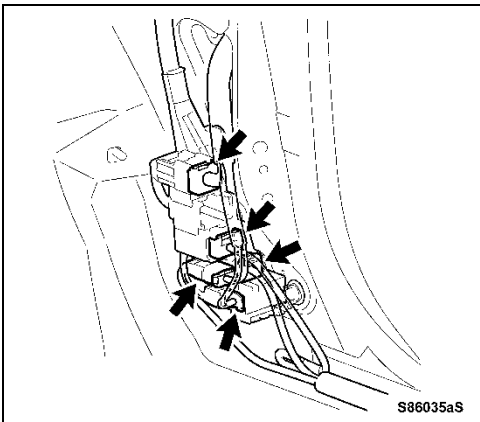

- 3) Disconnect the connectors on the RH cowl side section
  - i. Disconnect the 5 floor wire connectors from the connector holder on the RH cowl side

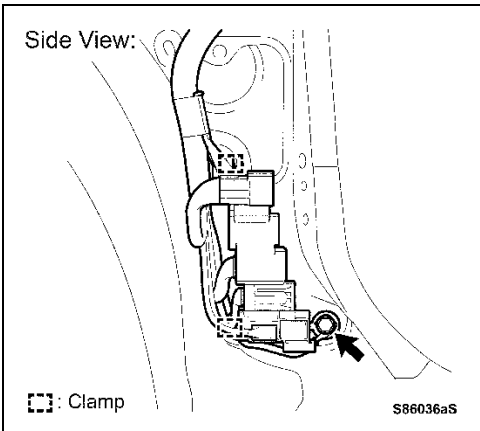

- ii. Disengage the 2 clamps
  - iii. Remove the ground bolt and separate the connector holder

## VII. INSTALL INSTRUMENT PANEL WIRE HARNESS

### 1. INSTALL NEW INSTRUMENT PANEL WIRE

a. Connect the connectors, engage the clamps and install the screws, bolt etc. shown in the illustration

**Torque:**

**74 in-lbf {8.4 N.m, 86 kgf.cm}**

**NOTE:**

- Put a mark on the check sheet after each connection or installation, to ensure that all parts are connected.
- See the following pages for detailed information on sections 1) to 4) in the illustration below.

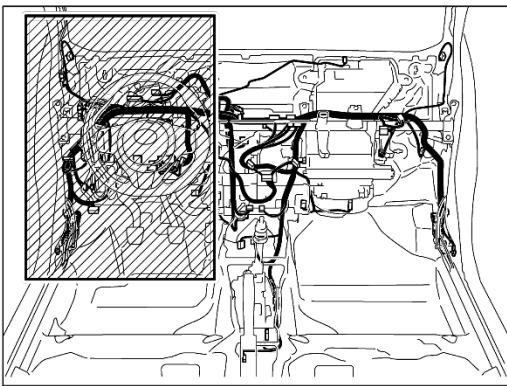

- A1: Front No. 2 Speaker Assembly LH  
 A2: Combination Meter Assembly  
 A3: Combination Meter Assembly  
 A4: Power Steering ECU Assembly  
 A5: Outer Mirror Switch Assembly (if equipped)  
 A6: Light Control Rheostat  
 A7: Auto High Beam Switch  
 A8: DLC3  
 A9: Pre-Collision System Cancel Switch Assembly  
 A10: Tire Pressure Warning Reset Switch  
 A11: Lower No. 1 Instrument Panel Airbag Assembly

 : Clamp

**N\*m (kgf\*cm, ft.\*lbf)** : Specified torque

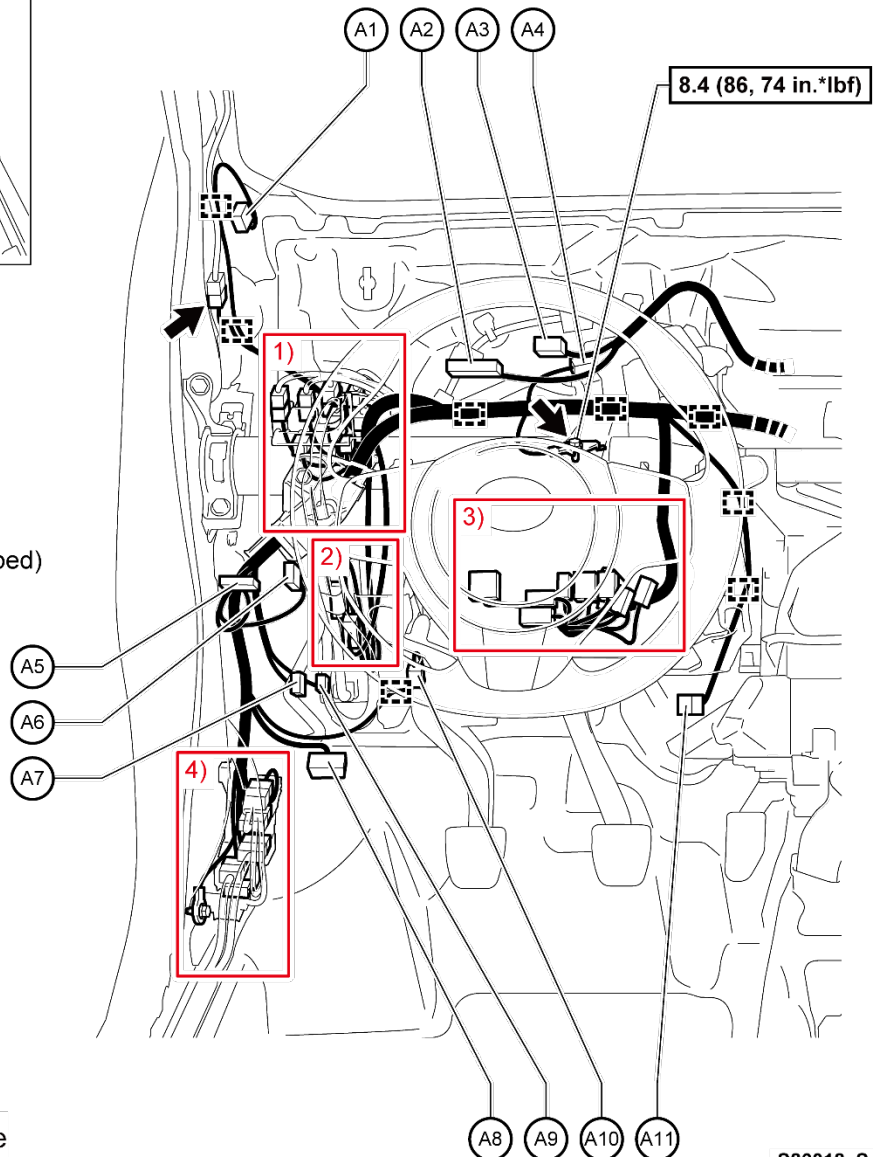

S86018aS



Confirm that the 3 relays are installed to the relay box of the *NEW* instrument panel wire.

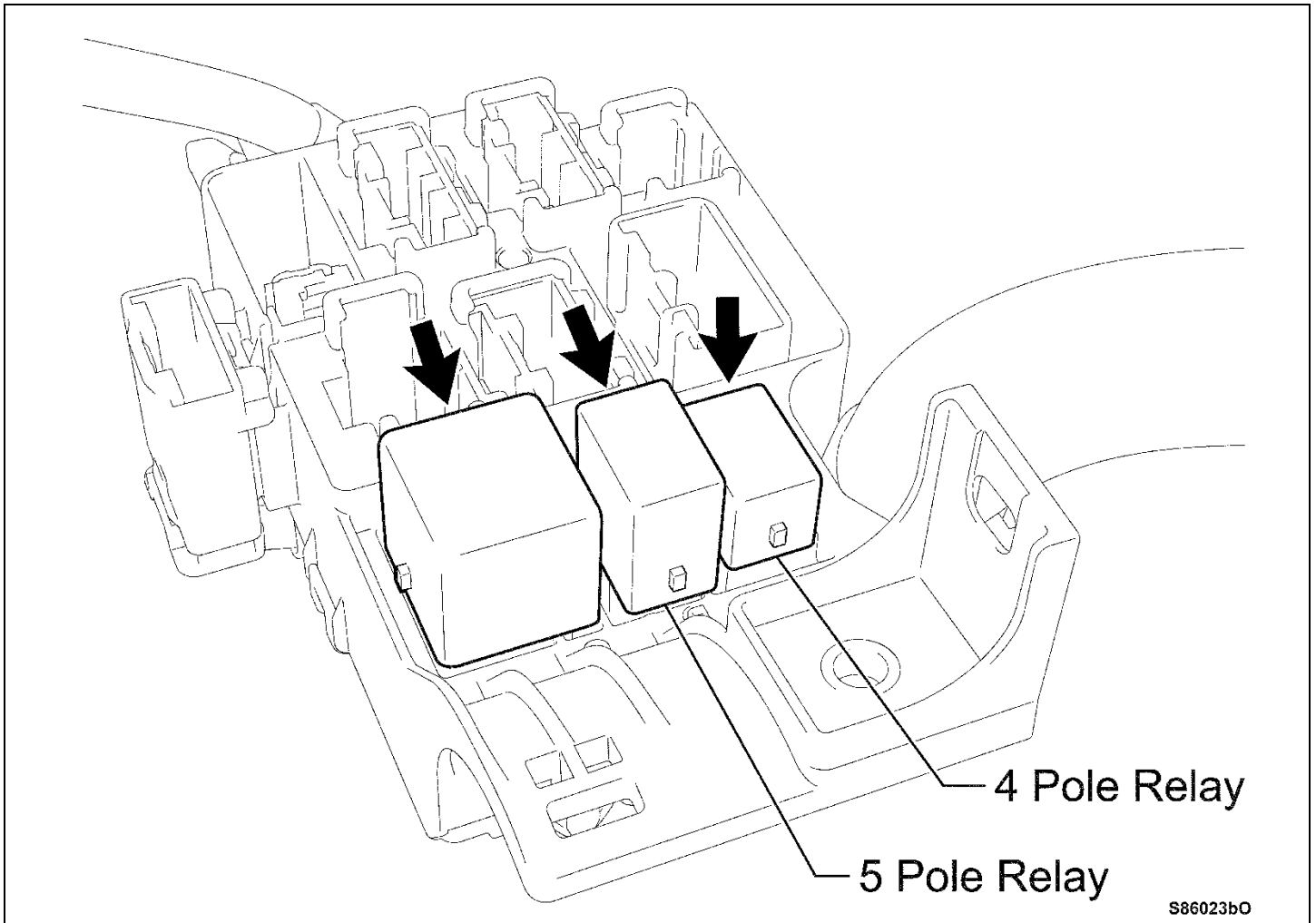

S86023b0

- 1) Instrument panel relay box
  - i. Install the 2 screws and engage the clamp

**Torque:**

**27 in-lbf {3.0 N.m, 31 kgf.cm}**

- ii. Engage the 3 clamps
- iii. Connect the 6 engine room main wire connectors to the instrument panel relay box of the **NEW** instrument panel wire.

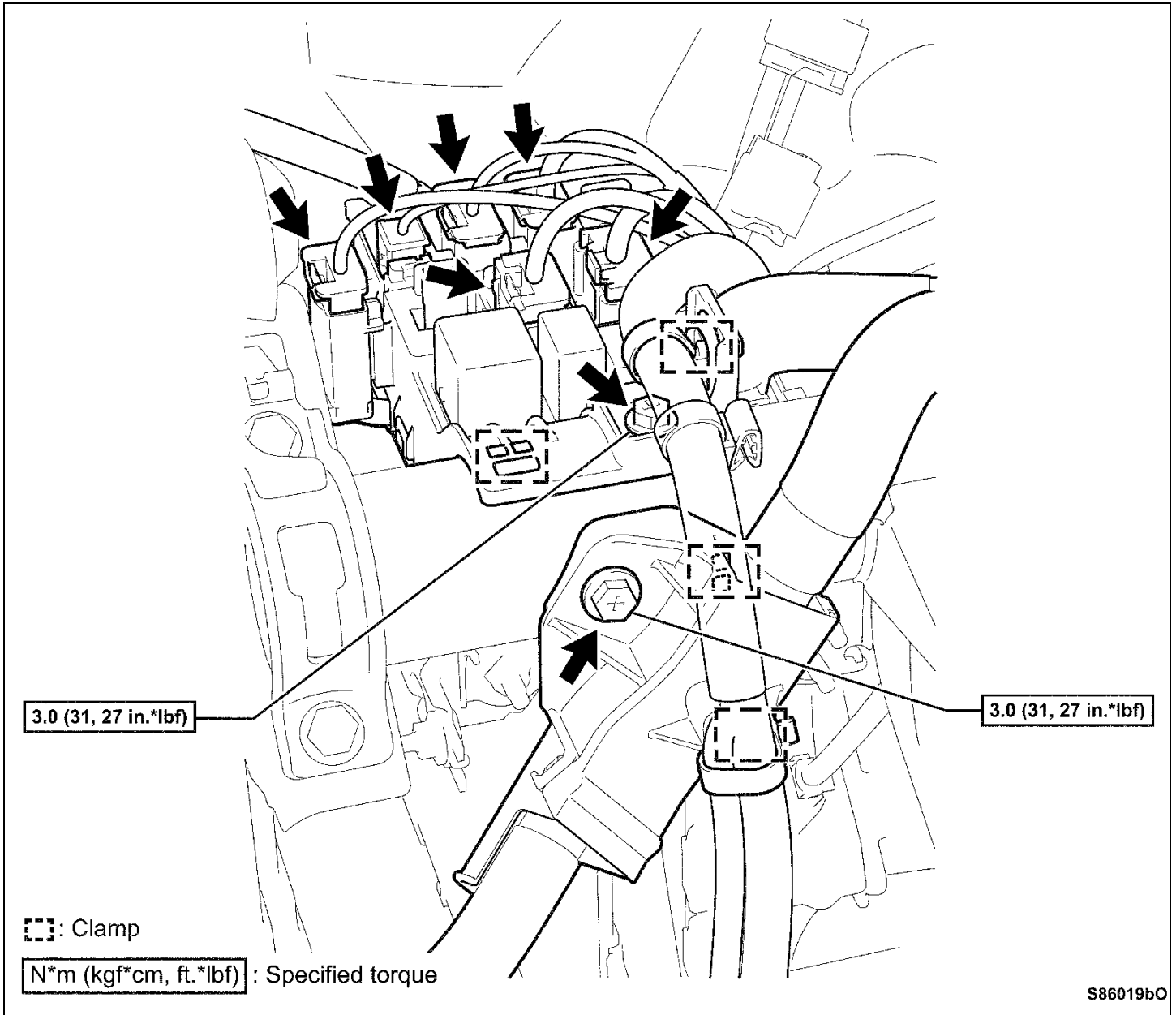

S86019b0



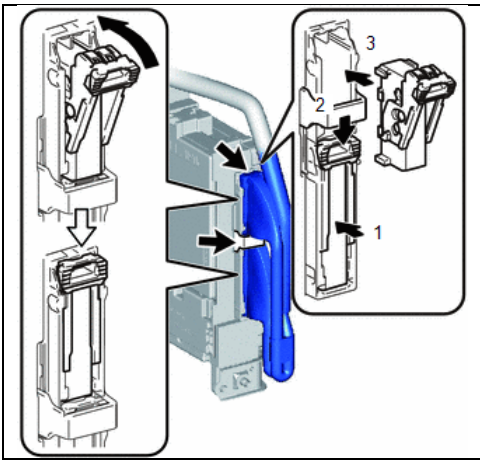

- 2) Instrument panel junction block
- i. Connect the back-side connectors and install the instrument panel junction block as shown in the illustration

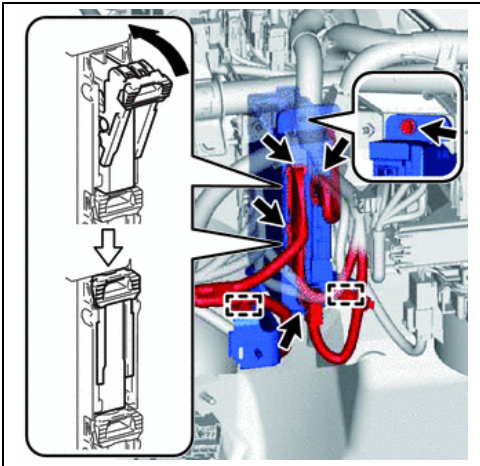

- ii. Install the instrument panel junction block with the bolt

**Torque:**  
**74 in-lbf {8.4 N.m, 86 kgf.cm}**

- iii. Connect the front side connectors as shown in the illustration
- iv. Engage the clamps

- 3) Steering column lower section
  - i. Engage the 3 clamps
  - ii. Connect the connectors

C1: Headlight Dimmer Switch Assembly

C2: Spiral with Sensor Cable Sub-Assembly

C3: Spiral with Sensor Cable Sub-Assembly

C4: Steering Sensor (Spiral with Sensor Cable Sub-Assembly)

C5: Windshield Wiper Switch Assembly

C6: Windshield Wiper Switch Assembly

C7: Un-Lock Warning Switch Assembly

C8: Transponder Key Coil

C9: Key Interlock Solenoid

NOTE:  
Connected on AT models only

C10: Ignition or Starter Switch Assembly

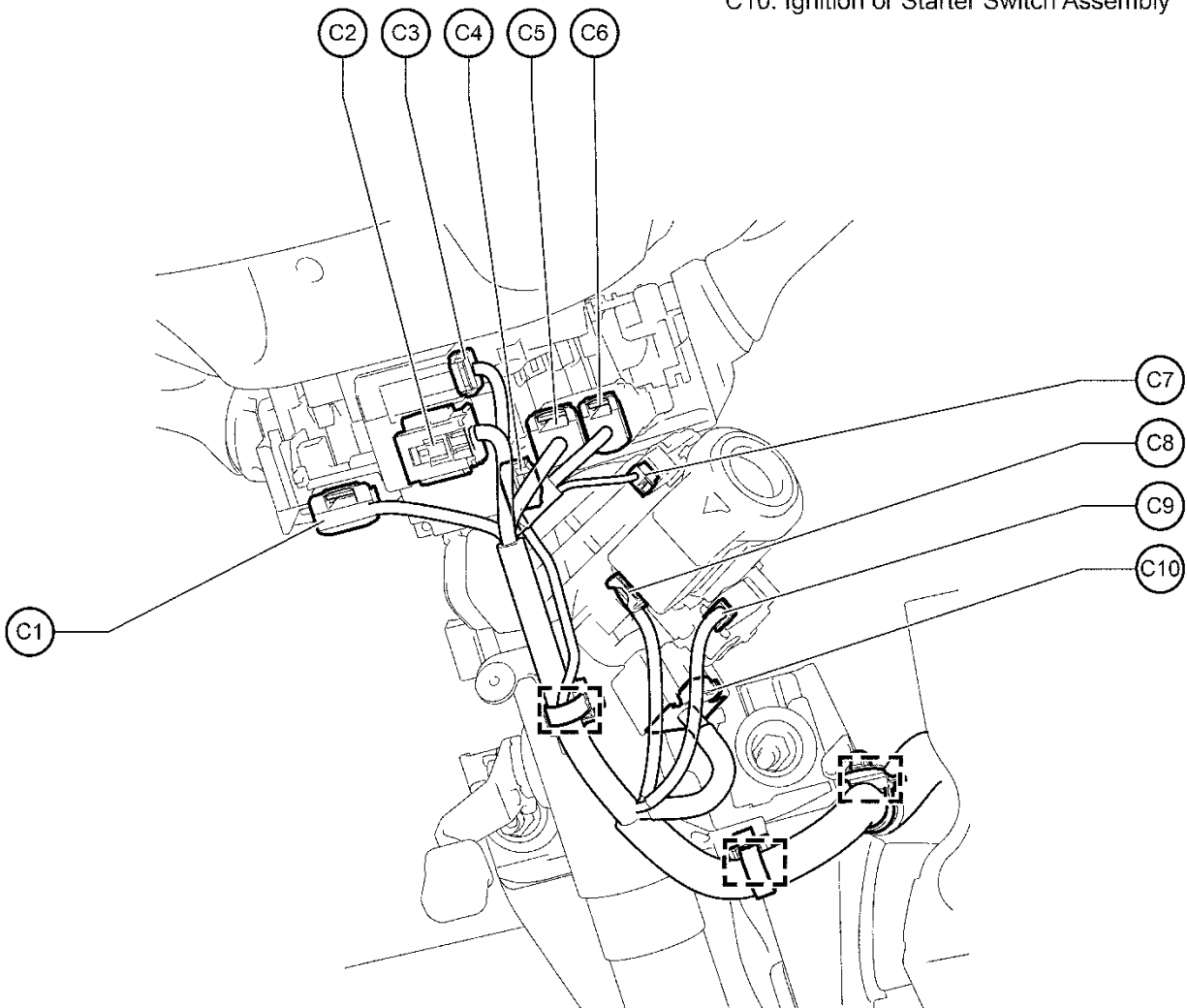

: Clamp

S86012aS

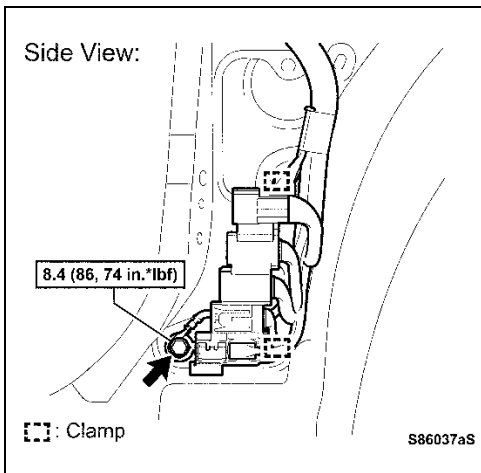

- 4) LH cowl side section
- i. Engage the 2 clamps and install the ground bolt

**Torque:**

**74 in-lbf {8.4 N.m, 86 kgf.cm}**

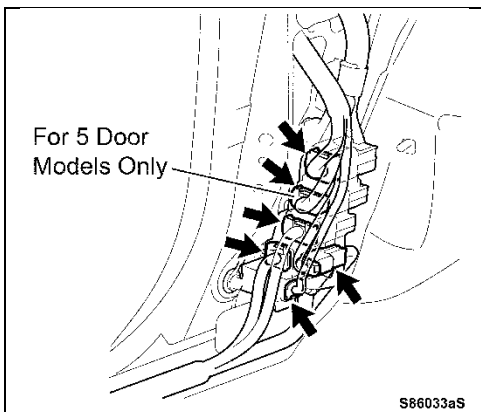

- ii. Connect the floor wire connectors to the connector holder of the **NEW** instrument panel wire on the LH cowl side

b. Connect the connectors, engage the clamps and install the bolt shown in the illustration.

**Torque:**

**74 in-lbf {8.4 N.m, 86 kgf.cm}**

**NOTE:**

- Put a mark on the check sheet after each connection or installation, to ensure that all parts are connected.
- See the following pages for detailed information on section 2) in the illustration below.

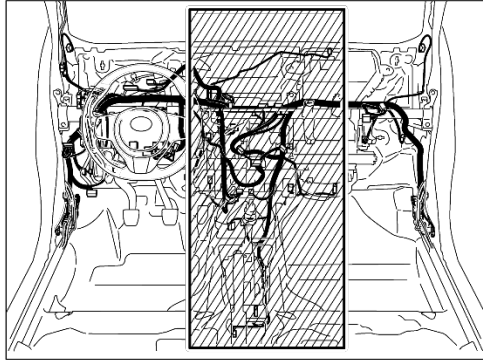

- D1: Telltale Light Assembly
- D2: Radio Receiver Assembly (if equipped)
- D3: Radio Receiver Assembly
- D4: Radio Receiver Assembly
- D5: Radio Receiver Assembly
- D6: Theft Warning Indicator Light Assembly

- D7: Pre-Collision Safety City Buzzer
- D8: No. 1 Heater Control Sub-Assembly
- D9: No. 2 Heater Control Sub-Assembly
- D10: No. 1 Cooler Thermistor
- D11: A/C Amplifier Assembly
- D12: Airbag Sensor Assembly
- D13: Oxygen Sensor (Bank 1 Sensor 2)
- D14: Shift Lock Control Unit Assembly
- D15: Shift Position Light (Indicator Light Wire Sub-Assembly)
- D16: Shift Lock Control Unit Assembly
- NOTE:  
Connected on AT models only
- D17: VSC Off Switch
- D18: Parking Brake Switch Assembly

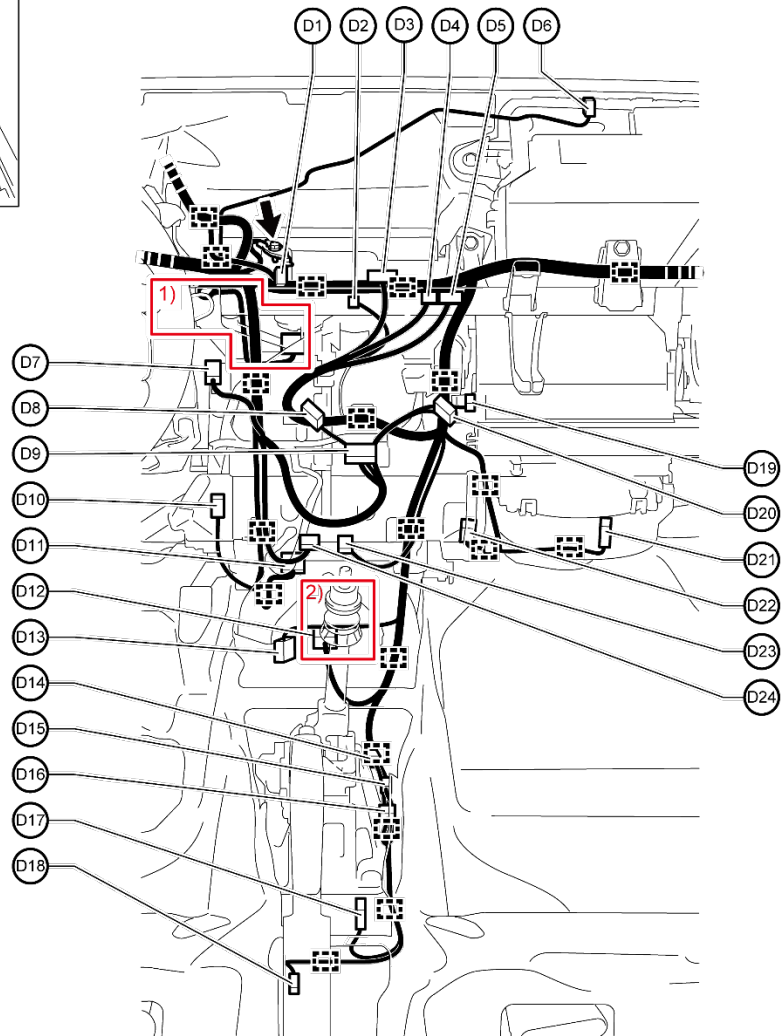

- D19: Amplifier Microphone Assembly (if equipped)
- D20: No. 3 Heater Control Sub-Assembly
- D21: Blower with Fan Motor Sub-Assembly
- D22: Blower Assembly
- D23: No. 1 Stereo Jack Adapter Assembly (if equipped)
- D24: Power Outlet Socket

 Clamp

S86014aS

1) Airbag sensor assembly connector section

- i. Push the airbag sensor assembly connector into the connector housing until it clicks

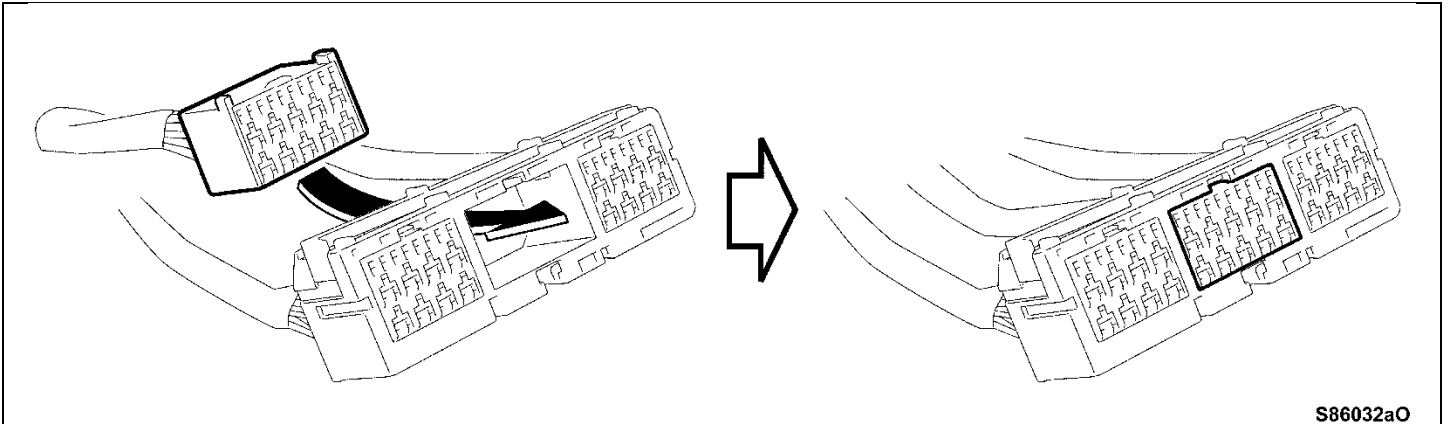

- ii. Reinstall the retainer to lock the connector

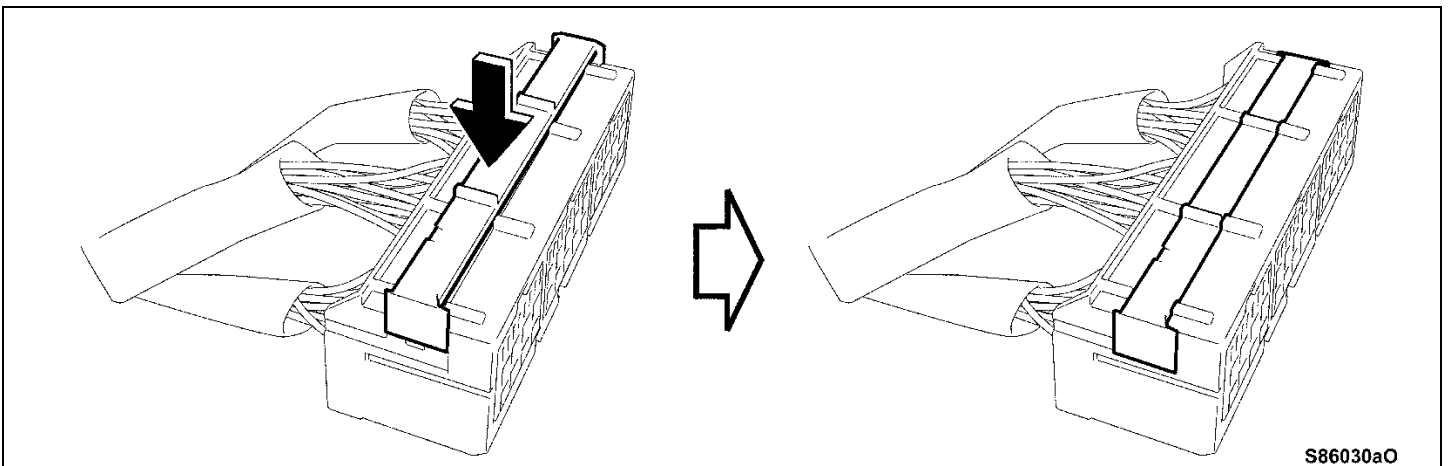

c. Connect the connectors, engage the clamps, and install the bolt shown in the illustration

**NOTE:**

- Put a mark on the check sheet after each connection or installation, to ensure that all parts are connected.
- See the following pages for detailed information on sections 1) in the illustration below.

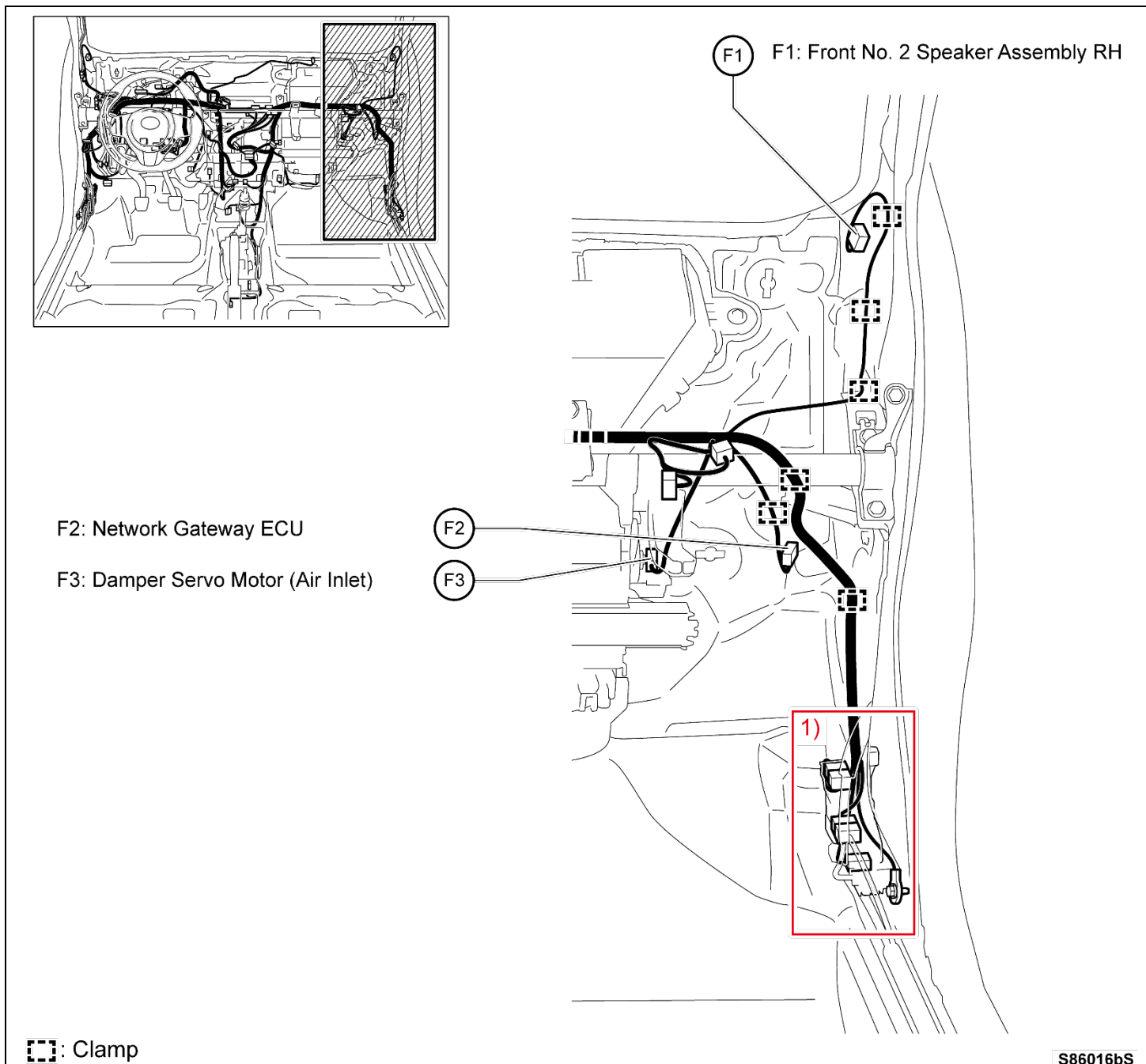

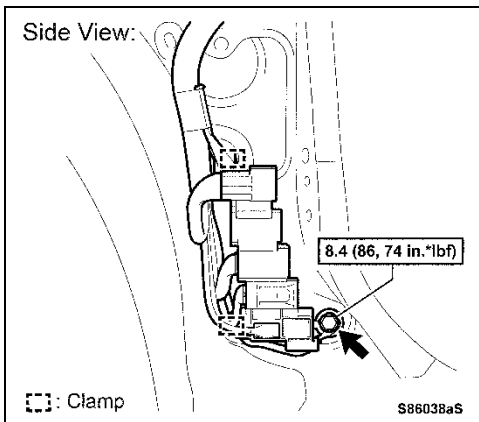

- 1) RH cowl side section
  - iii. Engage the 2 clamps and install the ground bolt

**Torque:**  
**74 in-lbf {8.4 N.m, 86 kgf.cm}**

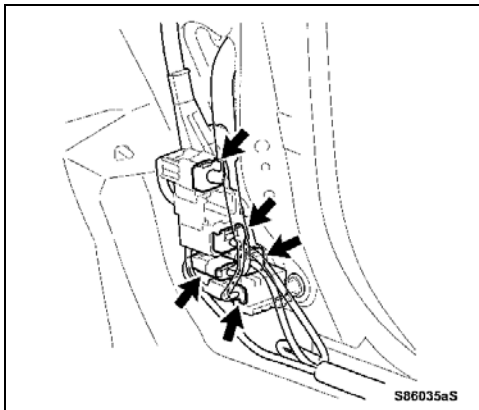

- iv. Connect the 5 floor wire connectors to the connector holder of the NEW instrument panel wire on the RH cowl side

2. REINSTALL THE LOWER INSTRUMENT PANEL SUB-ASSEMBLY  
[2017 Yaris Lower Instrument Panel](#)
3. REINSTALL THE UPPER INSTRUMENT PANEL SUB-ASSEMBLY  
[2017 Yaris Upper Instrument Panel](#)
4. RECONNECT THE CABLE TO THE NEGATIVE BATTERY TERMINAL
5. PERFORM HEALTH CHECK USING TECHSTREAM
6. INSPECT SRS WARNING LIGHT
7. RESTORE SETTINGS AFTER RECONNECTING CABLE TO NEGATIVE BATTERY TERMINAL  
[2017 Yaris Initialization](#)

## ◀ VERIFY REPAIR QUALITY ▶

Check for proper HVAC Operation  
 Check for proper operation of headlights and turn signals  
 Check for proper operation of the radio  
 Check for proper operation of the horn

If you have any questions regarding this update, please contact your regional representative.

### VIII. APPENDIX

#### A. PARTS DISPOSAL

As required by Federal Regulations, please make sure all recalled parts (original parts) removed from the vehicle are disposed of in a manner in which they will not be reused, unless requested for parts recovery return.

#### B. CAMPAIGN DESIGNATION DECORDER

