



Technical Journal

TITLE:

Gear shift lever inoperable

REF NO: TJ 32469.1.0	ISSUING DEPARTMENT: Technical Service	CAR MARKET: United States and Canada	
PARTNER: 3 US 7510 Volvo Car USA		ISSUE DATE: 2017-05-09	STATUS DATE: 2017-05-12
FUNC GROUP: 4323	FUNC DESC: Gear lever, complete	Page 1 of 6	

“Right first time in Time”

Attachment

File Name	File Size
TJI-503582-1_1_0_en-US.pdf	1.4954 MB

Vehicle Type

Type	Eng	Eng Desc	Sales	Body	Gear	Steer	Model Year	Plant	Chassis range	Struc Week Range
256							2016-2016		-	201505-201616

CSC Customer Symptom Codes

Code	Description
7G	Text window and warning symbol/Yellow symbol and text message
IV	Text window and warning symbol/Text message
MP	Automatic transmission/Possible to change gears, Shift lock does not work

VST Operation Number

VST Operation Number	Description
98677-2	Inspection Selector Lever Assembly



DTC Diagnostic Trouble Codes

Control Module	Code	Fault Type
ECM	U010387	Permanent
TCM	P086087	Permanent

Rows beginning with * are modified

Note! If using a printed copy of this Technical Journal, first check for the latest online version.

Text

DESCRIPTION:

GSM= Gear Shift Module

DTC=Diagnostic Trouble Code

If the gear shift lever is inoperable and DTC above are set by its own or in combination, then follow advise under "Service".

SERVICE:

Disconnect and reconnect connector at the GSM, according to attached method. Reset DTC's and test gear shift lever.

VEHICLE REPORT:

Yes, please submit a Vehicle Report if the service solution described in this TJ has no effect. Use concern area "Vehicle Report" and sub concern area "Support not needed", use function group 4323.

To view TJ attachment continue to next page. This TJ has one attachment.



Volvo Car Customer Service

TJ Instruction VCC-503582-1

Title	Selector Lever Assembly	Page	1 (4)
Action	Inspection	Operation number:	98677-2

Issue	Date	Reason
1	2017-04	First issue

Affected vehicles

Model year	Model	Engine	Transmission
2016	XC90 (16-)		TG-81SC TG-81SC AWD

Orientation view

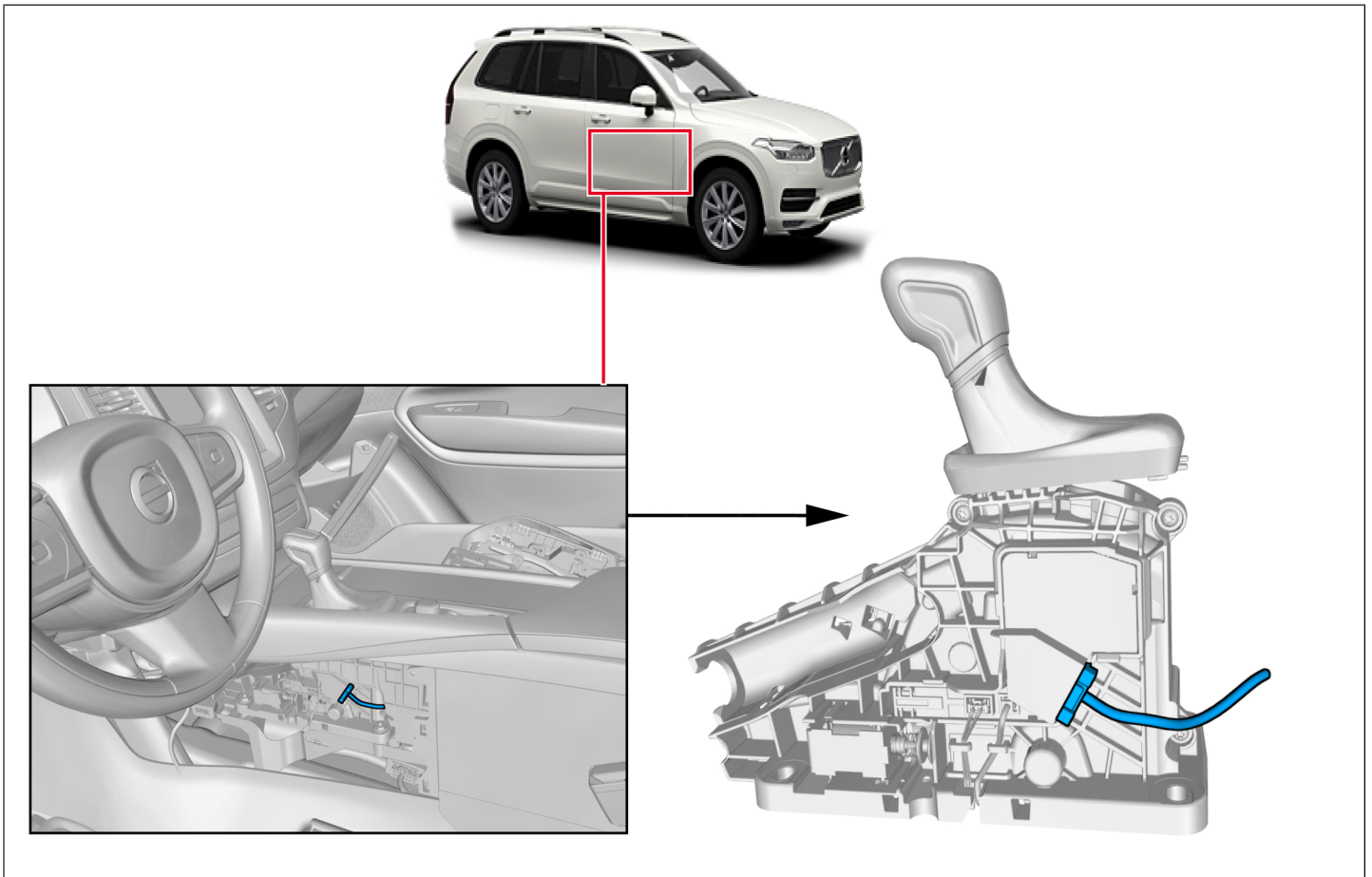

Color symbols

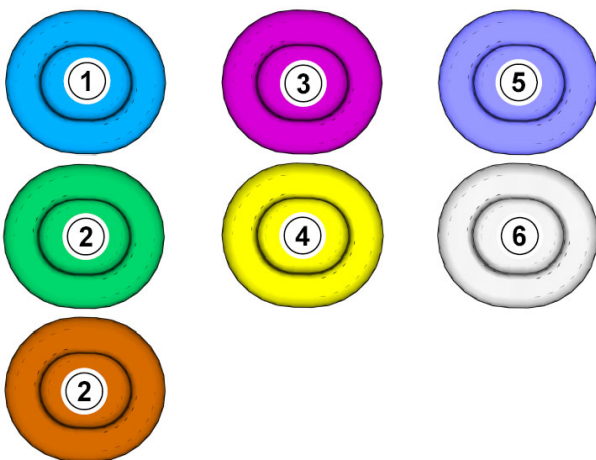

Note! This colour chart displays (in colour print and electronic version) the importance of the different colours used in the images of the method steps.

- 1 . Used for focused component, the component with which you will do something.
- 2 . Used as extra colors when you need to show or differentiate additional parts.
- 3 . Used for attachments that are to be removed/installed. May be screws, clips, connectors, etc.
- 4 . Used when the component is not fully removed from the vehicle but only hung to the side.
- 5 . Used for standard tools and special tools.
- 6 . Used as background color for vehicle components.

Removal

Note! Orientation view

The graphic shows the back of the component.

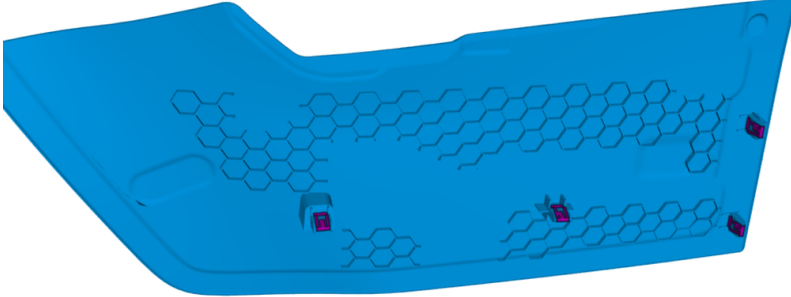

Remove the marked part.

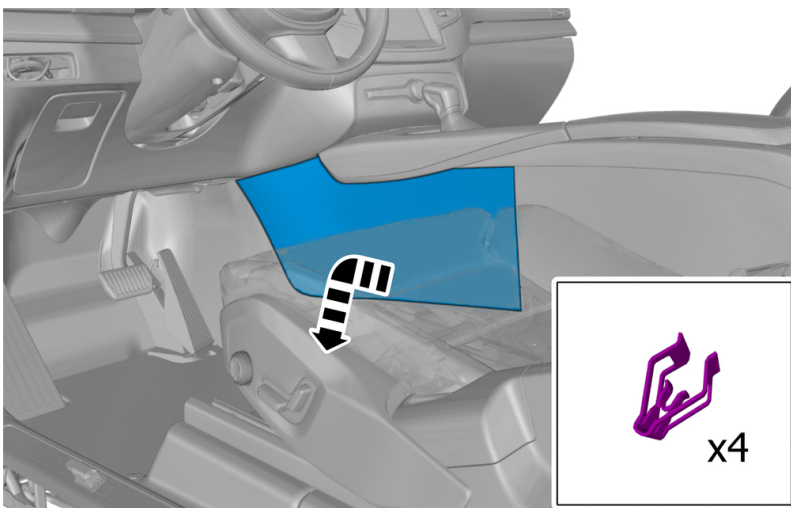

Check

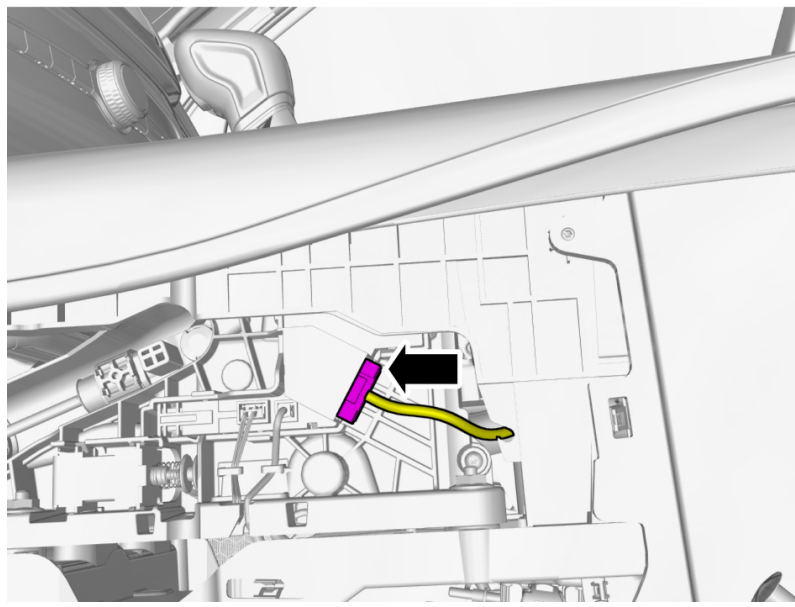

- 1 . Disconnect the connector.
- 2 . Connect the connector.
- 3 . **Caution! Check that the connector(s) is/ are properly connected.**

Installation

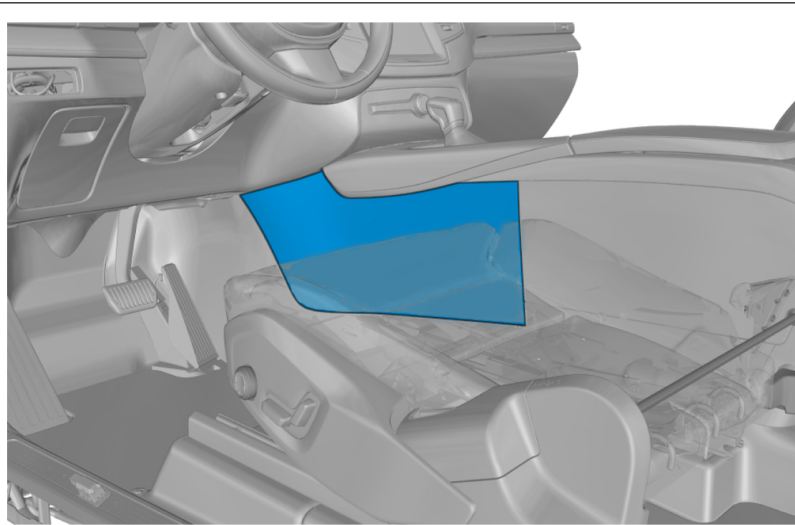

Install the marked component.