

Diesel Exhaust Fluid (DEF) Pressure Line Disconnected at the Doser Connection **49-040**

> Cascadia Cargo FLB COE	Columbia Argosy COE FLD Conventional FLA COE	Freightliner Service Bulletin
> Business Class M2	> New Cascadia	
> 108SD/114SD Century Class Conventional Business Class	> FLC 112 Conventional > 122SD and Coronado	

General Information

On some GHG14 and GHG17 vehicles equipped with a Detroit one-box aftertreatment system (ATS), the DEF pressure line may be pushed off the doser connection by frozen DEF in extreme cold climates. See Fig. 1 . Going forward, vehicles equipped with a Detroit Diesel one-box ATS will have a zip tie installed through the doser mounting bracket and around the DEF pressure line.

Installing the zip tie (part number 23-09796-509) prevents the DEF pressure line from being pushed off. The zip tie can be installed as a preventive measure or can be installed after the DEF line is disconnected, without replacing the DEF line.

Procedure

1. Park the vehicle on a level surface, shut down the engine, and set the parking brake. Chock the tires.
2. Locate the DEF pressure line on the ATS.
3. Install a zip tie through the doser mounting bracket and around the DEF pressure line as shown in Fig. 2 .



Fig. 1, Broken DEF Line

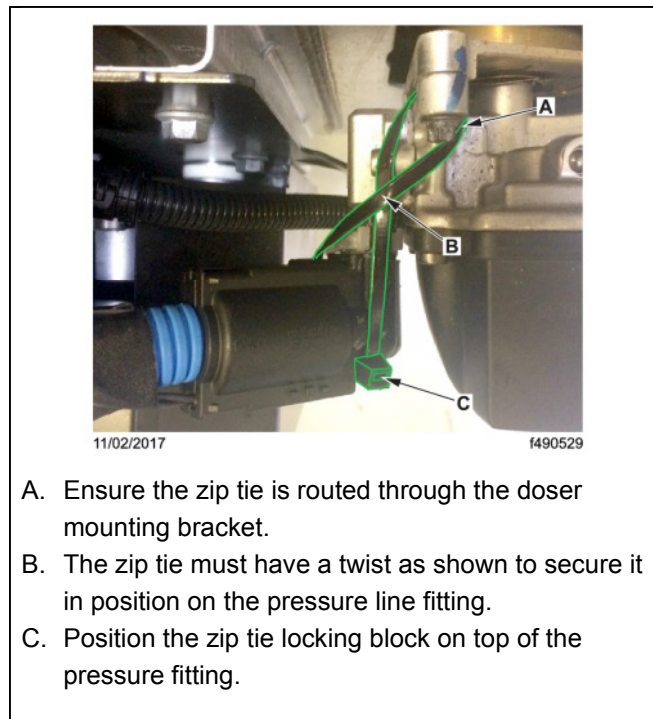

- A. Ensure the zip tie is routed through the doser mounting bracket.
- B. The zip tie must have a twist as shown to secure it in position on the pressure line fitting.
- C. Position the zip tie locking block on top of the pressure fitting.

Fig. 2, Installing a Zip Tie on the DEF Pressure Line and Doser

Warranty

This procedure is warrantable only if the described condition exists and the repair is performed within the applicable base or extended coverage warranty period. If a failure is not found, this procedure is considered preventive and warranty does not apply.

Normal warranty applies. See Table 1 for OWL VMRS codes and labor allowance information. Enter this service bulletin number in the *Service Bulletin #* field.

OWL VMRS Codes and Labor Allowance					
Primary Failed Part	Component Code	Cause Code	SRT Code	Description	Time: Hours
04-31885-220	043-007-087	24	23W-5010A	Line, DEF, Doser Connection, Repair, SB49-040	0.3

Table 1, OWL VMRS Codes and Labor Allowance

Freightliner Service Bulletin , 11/28/2017