



# 2018 PRE-DELIVERY SERVICE CHECK SHEET

Market: USA

December 2017

BEFORE INSPECTION	OK	Adjust	Repair
1 Install D/C Cut Fuse (See page 2).....	<input type="checkbox"/>		
2 Confirm that delivery mode wire harness connectors are connected (automatic transmission only) (See page 2).....	<input type="checkbox"/>		

FUNCTIONAL OPERATION	OK	Adjust	Repair
<i>Apply parking brake and cycle ignition "IG-ON," place gear selector in "R," turn on lights and rear defogger. Unlock all doors, release fuel door, release trunk hatch.</i>			
1 Check dome, courtesy, map, and sun visor lights*.....	<input type="checkbox"/>	<input type="checkbox"/>	
2 Check warning/indicator lights, gauges, and horn.....	<input type="checkbox"/>	<input type="checkbox"/>	
3 Check windshield wipers and washers.....	<input type="checkbox"/>	<input type="checkbox"/>	
4 Check headlights, instrument lights, turn signals, emergency flashers, and brake lights.....	<input type="checkbox"/>	<input type="checkbox"/>	
5 Check inside/outside rear view mirror operation/adjustment.....	<input type="checkbox"/>	<input type="checkbox"/>	
6 Check USB* and 12V power outlets.....	<input type="checkbox"/>	<input type="checkbox"/>	
7 Check audio/navigation/backup camera systems*, set vehicle settings to 86, and set clock.....	<input type="checkbox"/>	<input type="checkbox"/>	
8 Install shift-lock override button cover*.....	<input type="checkbox"/>		

WALKAROUND INSPECTION	OK	Adjust	Repair
<i>Starting at the left front door. Check window and door lock operation from master power switch, if equipped. Continue around vehicle in a counterclockwise direction checking each door and window operation, child door locks, seat belts, interior condition, all lights, luggage compartment contents. Finish by checking headlight aim.</i>			
1 Check Smart Key System.....	<input type="checkbox"/>	<input type="checkbox"/>	
2 Check door and door lock operation, including each wireless remote control/theft deterrent system*.....	<input type="checkbox"/>	<input type="checkbox"/>	
3 Check power window operation.....	<input type="checkbox"/>	<input type="checkbox"/>	
4 Check that engine starts with all keys.....	<input type="checkbox"/>	<input type="checkbox"/>	
5 Check seats and seat belt operation.....	<input type="checkbox"/>	<input type="checkbox"/>	
6 Check rear defogger.....	<input type="checkbox"/>	<input type="checkbox"/>	
7 Check side marker, tail, backup, and license plate lights.....	<input type="checkbox"/>	<input type="checkbox"/>	
8 Check rear cargo area trim appearance.....	<input type="checkbox"/>	<input type="checkbox"/>	
9 Adjust spare tire pressure, inspect for damage, and check jack and tool installation.....	<input type="checkbox"/>	<input type="checkbox"/>	
10 Check headlight aim.....	<input type="checkbox"/>	<input type="checkbox"/>	

UNDER HOOD	OK	Adjust	Repair
1 Check engine oil level.....	<input type="checkbox"/>	<input type="checkbox"/>	
2 Check brake and clutch* fluid levels.....	<input type="checkbox"/>	<input type="checkbox"/>	
3 Check engine coolant level.....	<input type="checkbox"/>	<input type="checkbox"/>	
4 Check windshield washer fluid level.....	<input type="checkbox"/>	<input type="checkbox"/>	
5 Check battery State-Of-Charge (SOC) using digital battery system analyzer (SOC reading: _____ %).....	<input type="checkbox"/>	<input type="checkbox"/>	
6 Inspect for fuel, oil, coolant, and other fluid leaks.....	<input type="checkbox"/>	<input type="checkbox"/>	

Notes:

UNDER VEHICLE (ON-HOIST)	OK	Adjust	Repair
1 Remove disc brake anti-rust covers/anti-corrosion wheel film* (remove just prior to customer delivery).....	<input type="checkbox"/>		
2 Inspect tires for defects/damage.....	<input type="checkbox"/>	<input type="checkbox"/>	
3 Perform Tire Pressure Warning System confirmation (TPWS) (See page 2).....	<input type="checkbox"/>	<input type="checkbox"/>	
4 Install rubber body plugs.....	<input type="checkbox"/>	<input type="checkbox"/>	
5 Inspect for fuel, oil, coolant, and other fluid leaks.....	<input type="checkbox"/>	<input type="checkbox"/>	
6 Visually check bolts and nuts on chassis and powertrain for looseness.....	<input type="checkbox"/>	<input type="checkbox"/>	
7 Inspect under the vehicle for damage, rust, etc.....	<input type="checkbox"/>	<input type="checkbox"/>	

ROAD TEST
<i>A complete road test helps assure customer satisfaction. Drive vehicle over a variety of road surfaces and driving conditions. Check for unusual noise and driving performance.</i>

Enter Odometer Readings
Reading Before Test: _____ Reading After Test: _____

1 Check cold engine operation.....	<input type="checkbox"/>	<input type="checkbox"/>
2 Check engine operation during warm-up.....	<input type="checkbox"/>	<input type="checkbox"/>
3 Check engine operation at normal operating temperature.....	<input type="checkbox"/>	<input type="checkbox"/>
4 Check transmission operation.....	<input type="checkbox"/>	<input type="checkbox"/>
5 Check brake and parking brake operation.....	<input type="checkbox"/>	<input type="checkbox"/>
6 Check steering operation and off-center/vehicle pull/flutter.....	<input type="checkbox"/>	<input type="checkbox"/>
7 Inspect for abnormal noise and vibration.....	<input type="checkbox"/>	<input type="checkbox"/>
8 Inspect for squeaks and rattles.....	<input type="checkbox"/>	<input type="checkbox"/>
9 Check heater and A/C operation.....	<input type="checkbox"/>	<input type="checkbox"/>
10 Check speedometer operation.....	<input type="checkbox"/>	<input type="checkbox"/>
11 Check cruise control operation*.....	<input type="checkbox"/>	<input type="checkbox"/>

FINAL INSPECTION AND CLEANING	OK	Adjust	Repair
1 Remove interior protective covers, unnecessary labels, tags, etc. (Remove just before delivery to customer).....	<input type="checkbox"/>	<input type="checkbox"/>	
2 Visually inspect all interior parts for installation, damage, fit, dirt, etc.....	<input type="checkbox"/>	<input type="checkbox"/>	
3 Verify floor mat application and install using retaining clips*.....	<input type="checkbox"/>	<input type="checkbox"/>	
4 Remove Rappard™ and clear protective bumper film*.....	<input type="checkbox"/>	<input type="checkbox"/>	
5 Wash and clean vehicle.....	<input type="checkbox"/>	<input type="checkbox"/>	
6 Inspect paint finish for scratches, chips, rust, dents, damage, etc.....	<input type="checkbox"/>	<input type="checkbox"/>	
7 Inspect exterior body parts for proper installation, damage, rust, etc.....	<input type="checkbox"/>	<input type="checkbox"/>	
8 Install front license plate and mounting bracket* (See page 2).....	<input type="checkbox"/>	<input type="checkbox"/>	
9 Place oil change sticker on inside of windshield, top left corner.....	<input type="checkbox"/>	<input type="checkbox"/>	
10 Place Owner's Manual portfolio* in glove box.....	<input type="checkbox"/>	<input type="checkbox"/>	
11 Perform Techstream Health Check.....	<input type="checkbox"/>	<input type="checkbox"/>	

\* Inspect or install when equipped/required.

Completion and retention of this form is required to comply with Toyota's Warranty Policy.		Dealer Code	Date
Technician's Signature	Service Manager's Signature	Dealer Name	
Name (Please Print)	Name (Please Print)	Vehicle Identification Number (Sticker)	
<i>We hereby certify that all items on this form have been checked and corrected for proper operation as required.</i>			

## D/C CUT FUSE INSTALLATION

To minimize battery discharge, the D/C Cut Fuse has been removed and is stored in the engine compartment Relay Block. Install the D/C Cut Fuse during Pre-Delivery Service (PDS).

### NOTE

Failure to install the D/C Cut Fuse may cause the Malfunction Indicator Lamp (MIL) to flash with no engine misfires or DTCs stored and may cause the radiator fans to cycle on and off rapidly.

- 1 Remove This D/C Cut Fuse
- 2 Install D/C Cut Fuse Here

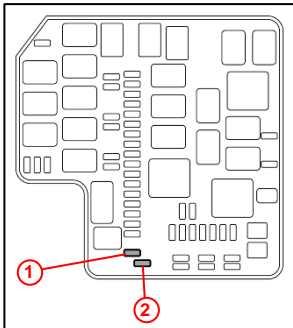

## DELIVERY MODE WIRE HARNESS CONNECTORS

Locate and confirm that the delivery mode connector is connected, and confirm proper functionality of key interlock system (automatic transmission) only.

### CAUTION

If the delivery mode connector is not connected, it is possible to remove the key in gear positions other than Park, causing the vehicle not to comply with a portion of Federal Motor Vehicle Safety Standard 114.

1. From the driver side cowl trim area, locate the delivery mode connector (white D60 connector).
2. Ensure that the connector is connected and placed out of sight. If disconnected, connect the two ends of the delivery mode connector and place it behind the cowl trim.
3. With the parking brake set and the brake pedal depressed, turn the engine on and shift to Neutral.
4. Confirm that the key cannot be turned from ACC to LOCK.

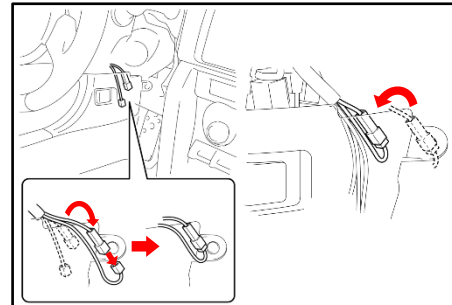

## TIRE PRESSURE WARNING SYSTEM (TPWS) CONFIRMATION

Refer to the Repair Manual for the [Confirmation procedure](#).

### NOTE

To adjust the tire pressure correctly when the outside temperature is significantly colder than shop temperature, perform a Health Check using Techstream and select the "Compensation Tire Pressure" checkbox. Compensation pressures will be displayed on the Health Check results screen. Adjust the tire pressure when the tires are cold.

## FRONT LICENSE PLATE AND MOUNTING BRACKET INSTALLATION

For states that require a front license plate, follow the installation procedure below. The front license plate mounting bracket set (front license plate mounting bracket, two flange bolts, two bolts, and two well nuts) is loaded in the luggage compartment.

1. Align the center mark on the front license plate mounting bracket with the center of the intake cover of the front bumper cover.
2. Using the front license plate mounting bracket as a guide, make marks "A" and "B" on the front bumper cover as shown, and then remove the bracket from the front bumper cover.
3. Drill 13 mm (0.51 in.) diameter holes at locations "A" and "B" in the front bumper cover.

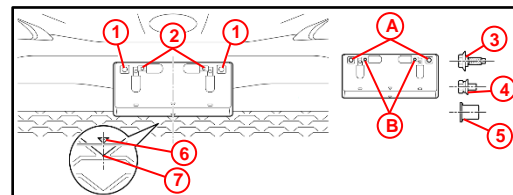

- 1 Mark A
- 2 Mark B
- 3 Flange Bolt
- 4 Bolt
- 5 Well Nut
- 6 Front License Plate Mounting Bracket Center Mark
- 7 Intake Cover Center

### NOTE

- Holes "A" are used to install the well nuts and the front license plate mounting bracket to the front bumper cover.
- Holes "B" are used to prevent interference between the front bumper cover and the bolts.

4. Install the two well nuts into holes "A" in the front bumper cover.
5. Fit the two hooks at the bottom of the front license plate mounting bracket onto the intake cover.
6. Align holes "A" in the front license plate mounting bracket with the well nuts, and then install the front license plate mounting bracket with the two flange bolts.

**Torque: 1.1 N\*m (11 kgf\*cm, 9.7 ft\*lbf)**

### NOTICE

Do not overtighten the flange bolts.

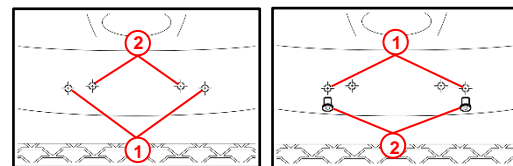

- 1 Mark A
- 2 Mark B
- 1 Hole A
- 2 Well Nut

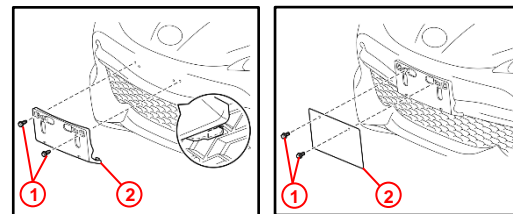

- 1 Flange Bolt
- 2 Hook
- 1 Bolt
- 2 License Plate

7. Install the front license plate onto the mounting bracket with the two bolts.