



Preliminary Information

PIP5489A DTC P0106 Caused By Snow or Water Intrusion Into The Air Cleaner

Models

Brand:	Model:	Model Years:	VIN:		Engine:	Transmissions:
			from	to		
Chevrolet	Silverado	2017 - 2018	All	All	6.6 L5P	All
GMC	Sierra	2017 - 2018	All	All	6.6 L5P	All
Involved Region or Country	North America					
Additional Options (RPO)	6.6 L5P					
Condition	A customer may comment on a Service Engine Soon Light on along with snow or ice build up on the air filter element. In addition, water getting into the air cleaner assembly under wet/rainy conditions may saturate the air filter and reduce flow to the point that the air filter is damaged/distorted. DTC P0106 may set.					
Cause	Air induction filter box may be out of position causing loss of sealing to the hood and/or the owner may not be using front end grille cover at below zero temperature conditions. Vehicle modifications may also allow water to enter the air cleaner assembly.					

Correction:

Confirm that the air filter box is in position, securely retained to the air cleaner bracket (1), that it is sealed to the inner fender (2) and to the hood (3).

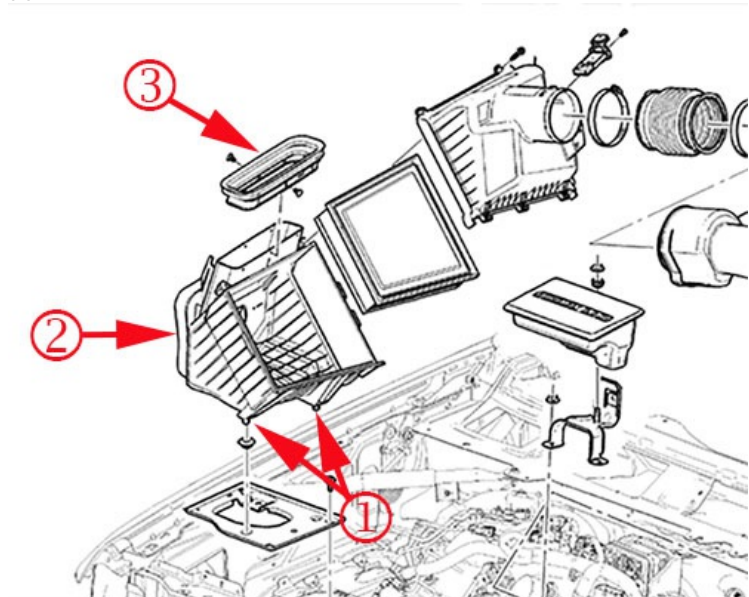

Proper sealing between the air box upper gasket (3) and hood can be checked by wetting the gasket (foaming glass cleaner was used in the photos below), closing the hood and then checking for a contact ring witness mark around the entire hood duct opening to the air cleaner assembly.



The photo below shows a lack of contact in the front edge of the air cleaner seal.



Confirm that while the vehicle is operated in temperatures below -17C (0F) that the front end grille cover is in use by the owner.

The induction system on the L5P is designed to prevent snow and water from entering through the hood duct.

If the air filter box is not positioned properly, it may compromise the sealing between the hood and the inner fender.

If sealing is compromised, snow can reach the air cleaner element along with warm air pulled from under the hood.

This can cause the snow to melt and re-freeze on the air cleaner element blocking it with ice.

In addition, if the vehicle is operated at temperatures below -17C (0F) and the front end grille cover is not used, snow can be pulled through the grill duct and over a period of time the filter may accumulate enough ice to reduce airflow.

Caution: The hood should remain closed in wet conditions. If the hood is open water may enter the open port on top of the air cleaner assembly.



Aftermarket Bumper Installed



OEM bumper with intake air box protection to help prevent moisture and other debris getting into the air cleaner box.



Aftermarket bumper without intake air box protection.

Version History

Version	2
Modified	8/30/2017 to add information about aftermarket bumpers, water intrusion and added model year 2018.



© 2016 General Motors. All Rights Reserved.