

TECHNICAL INSTRUCTIONS

FOR

SPECIAL SERVICE CAMPAIGN H0P

INSTRUMENT PANEL WIRE MODIFICATION

CERTAIN 2017 MY YARIS (A/T)

The repair quality of covered vehicles is extremely important to Toyota. All dealership technicians performing this recall are required to successfully complete the most current version of the E-Learning course “Safety Recall and Service Campaign Essentials”. To ensure that all vehicles have the repair performed correctly; technicians performing this recall repair are required to currently hold at least one of the following certification levels:

- Certified Technician (Electrical)
- Expert Technician (Any Specialty)
- Master Technician
- Master Diagnostic Technician

It is the dealership’s responsibility to select technicians with the above certification level or greater to perform this recall repair. Carefully review your resources, the technician skill level, and ability before assigning technicians to this repair. It is important to consider technician days off and vacation schedules to ensure there are properly trained technicians available to perform this repair at all times.

I. OPERATION FLOW CHART

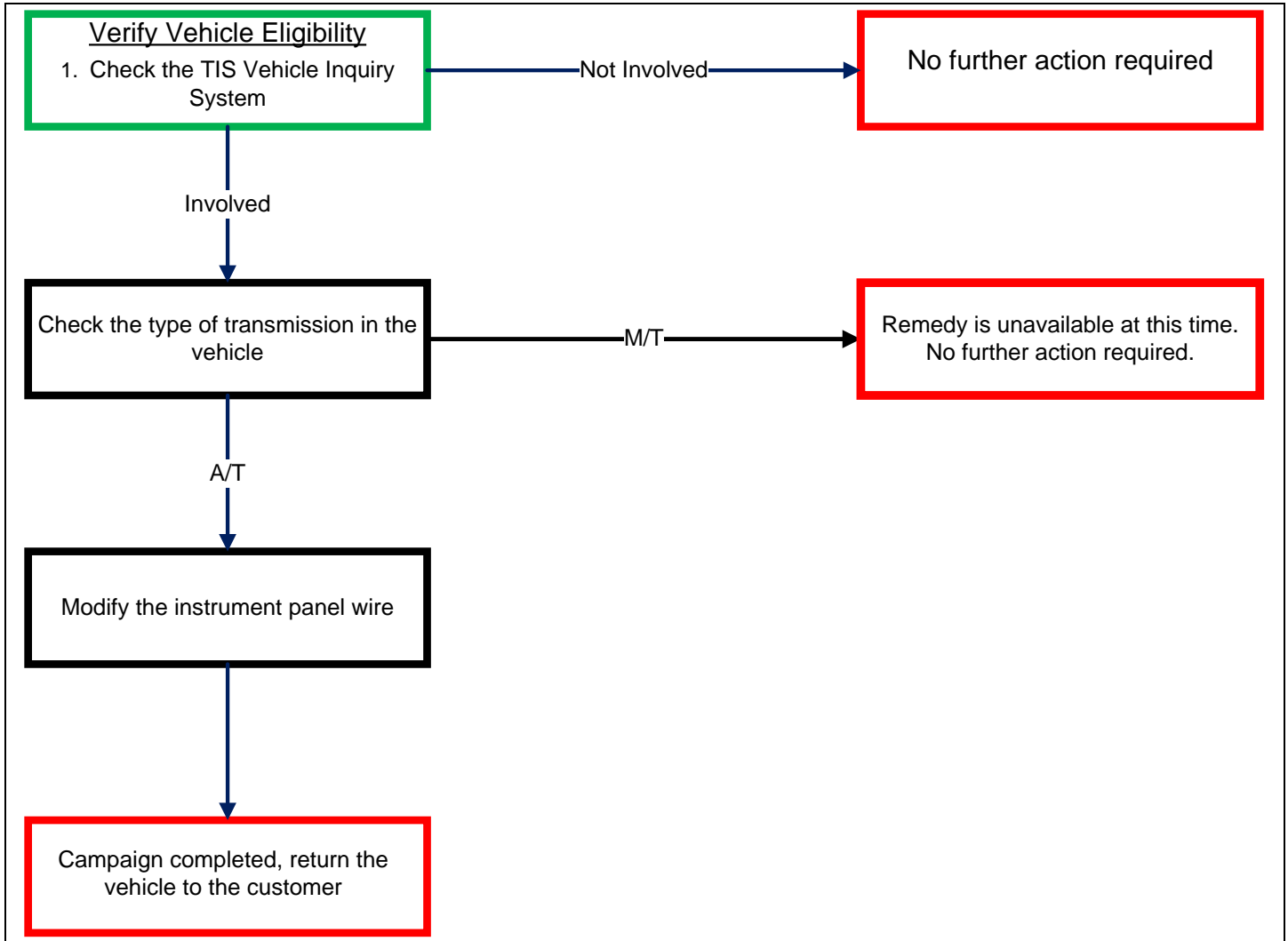

II. IDENTIFICATION OF AFFECTED VEHICLES

- Check the TIS Vehicle Inquiry System to confirm the VIN is involved in this Safety Recall, and that the Campaign has not already been completed prior to dealer shipment or by another dealer.
- TMS warranty will not reimburse dealers for repairs completed on vehicles that are not affected or were completed by another dealer.

III. PREPARATION

A. TOOLS & EQUIPMENT

- Techstream
- Standard Hand Tools
- Protective Gloves

B. MATERIALS

- Electrical Tape
- Nylon Closed-End Crimp Connector

IV. WORK PROCEDURE TABLE OF CONTENTS

WORK PROCEDURE.....	SECTION VI
INSTRUMENT PANEL WIRE MODIFICATION	SECTION VII
APPENDIX.....	SECTION VII

V. BACKGROUND

In the subject vehicles, an incorrect instrument panel wire harness may have been installed during the vehicle assembly process. The incorrect instrument panel wire harness may not be compatible with the Pre-Collision system front sensor. As a result, the Automatic High Beam and Pre-Collision system may be inoperative.

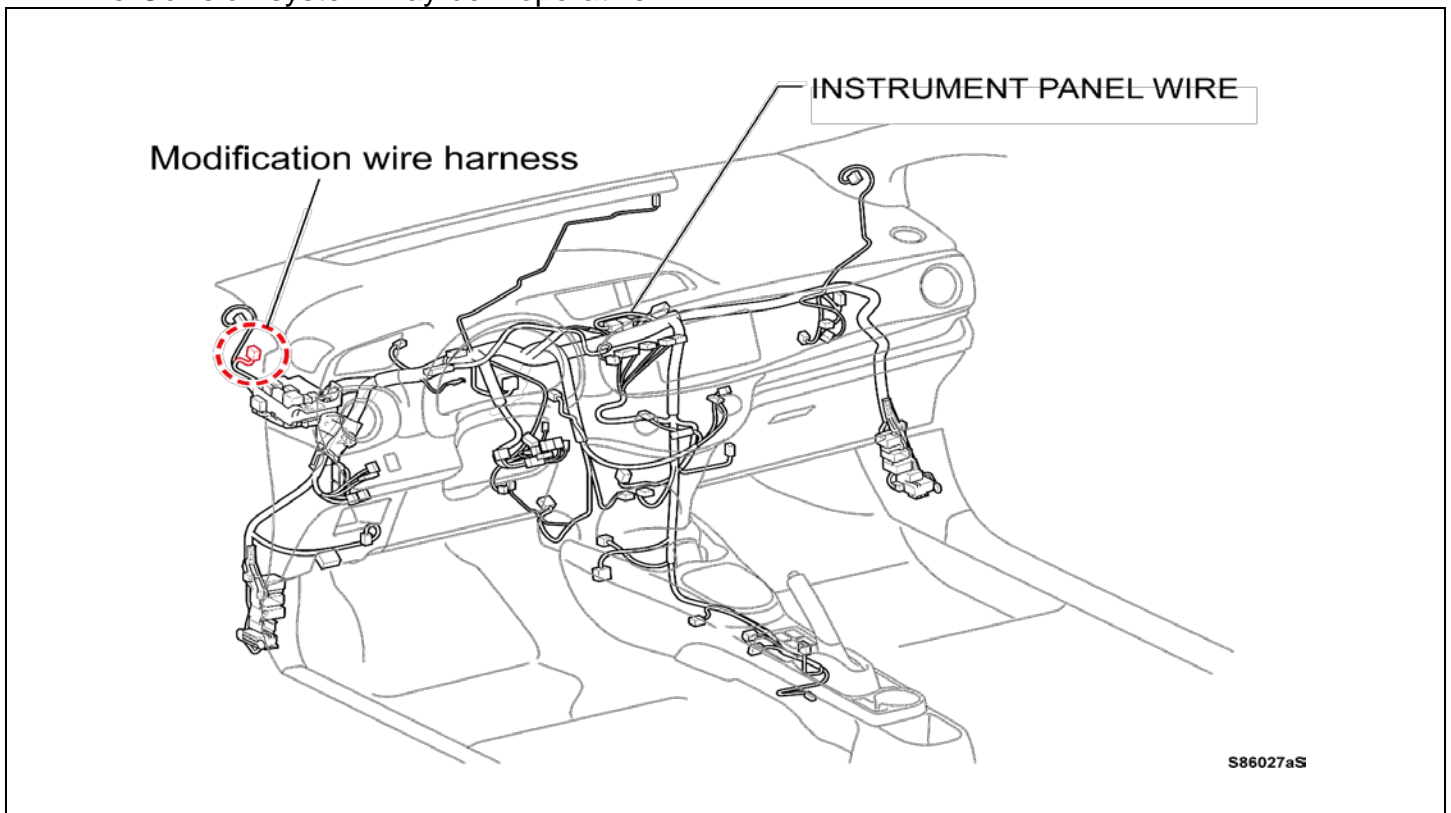

VI. WORK PROCEDURE

A. COMPONENTS

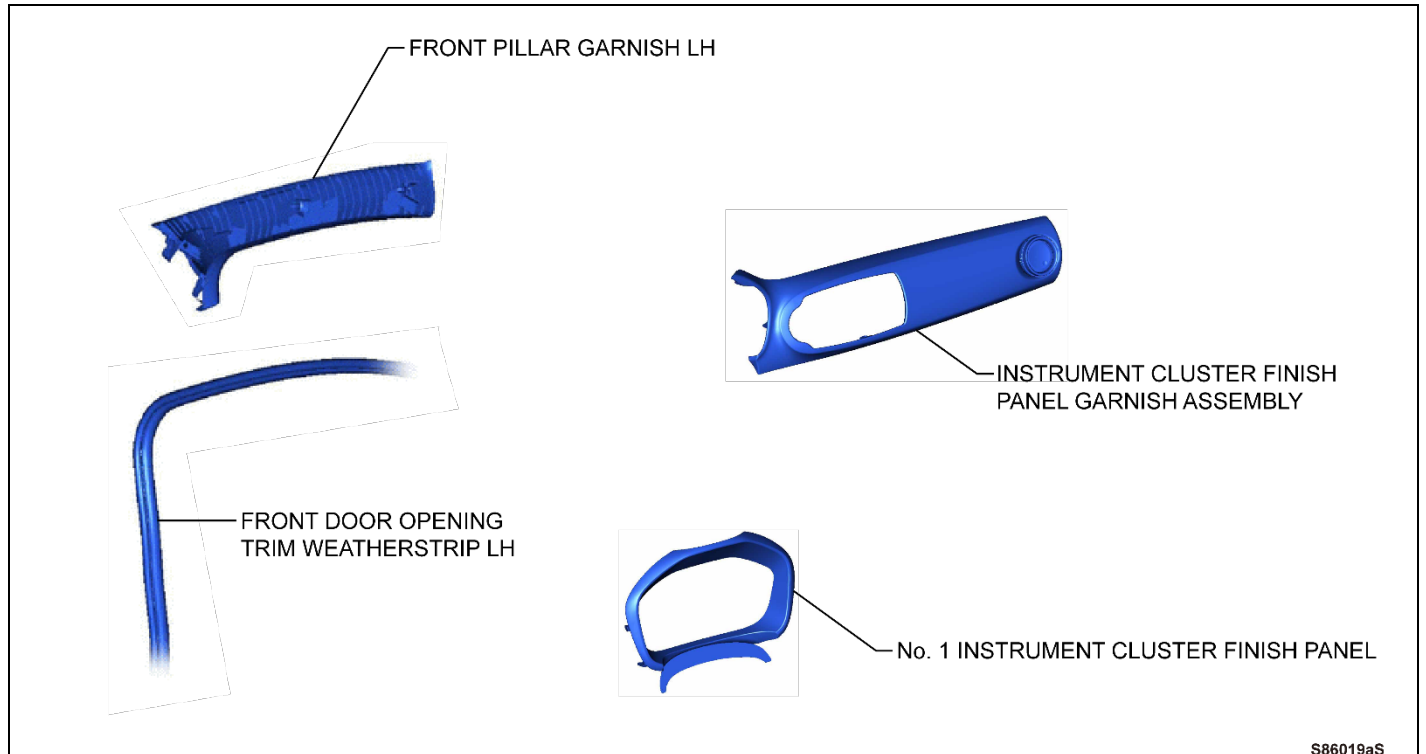

1. CHECK FOR DTC'S

- a. If a DTC(s) is displayed, record the DTC and the freeze frame data and perform the repairs as necessary

2. RECORD AUDIO AND A/C SETTINGS

- a. When the battery cable is disconnected, the settings for the audio, air conditioning, etc. may be reset. Therefore, make a note of the settings before disconnecting the cable from the negative (-) battery terminal.

3. DISCONNECT CABLE FROM NEGATIVE BATTERY TERMINAL



For models with a navigation system, wait at least 6 minutes before disconnecting the battery. It takes approximately 6 minutes for the system to save information and settings after the ignition switch is turned off.

VII. INSTRUMENT PANEL WIRE MODIFICATION

1. SEPARATE THE LEFT-HAND FRONT DOOR OPENING TRIM WEATHERSTRIP

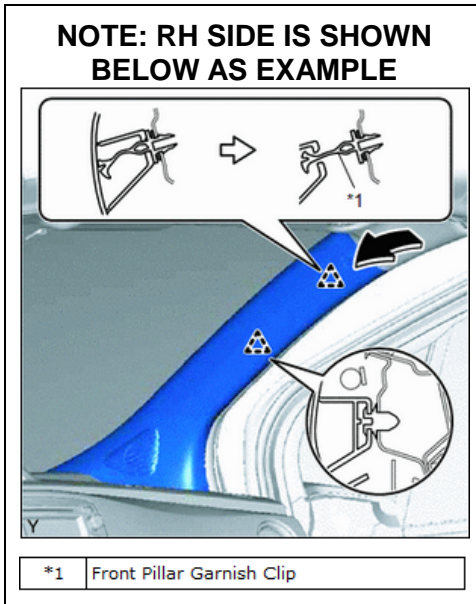

2. REMOVE FRONT PILLAR GARNISH LH

- a. Disengage the front pillar garnish clips

NOTE: The front pillar garnish clip should remain between the pillar garnish and the pillar

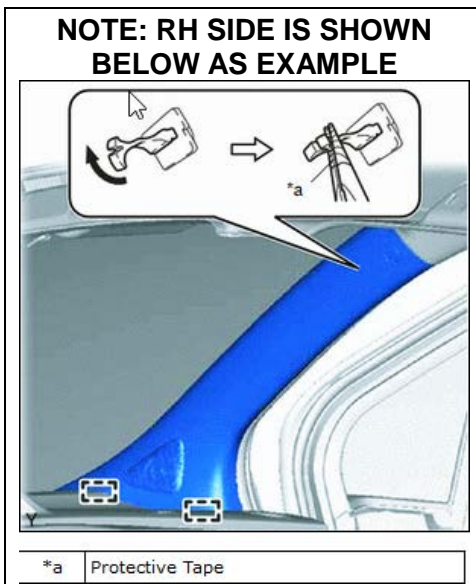

- b. Using needle nose pliers, turn the front pillar garnish 90° and disengage it from the front pillar

NOTE: Do NOT remove the garnish clip from the pillar as long as it is not damaged.

- c. Disengage the 2 guides to remove the front pillar garnish

3. DISCONNECT INSTRUMENT PANEL WIRE FROM ROOF WIRE

LH front pillar section

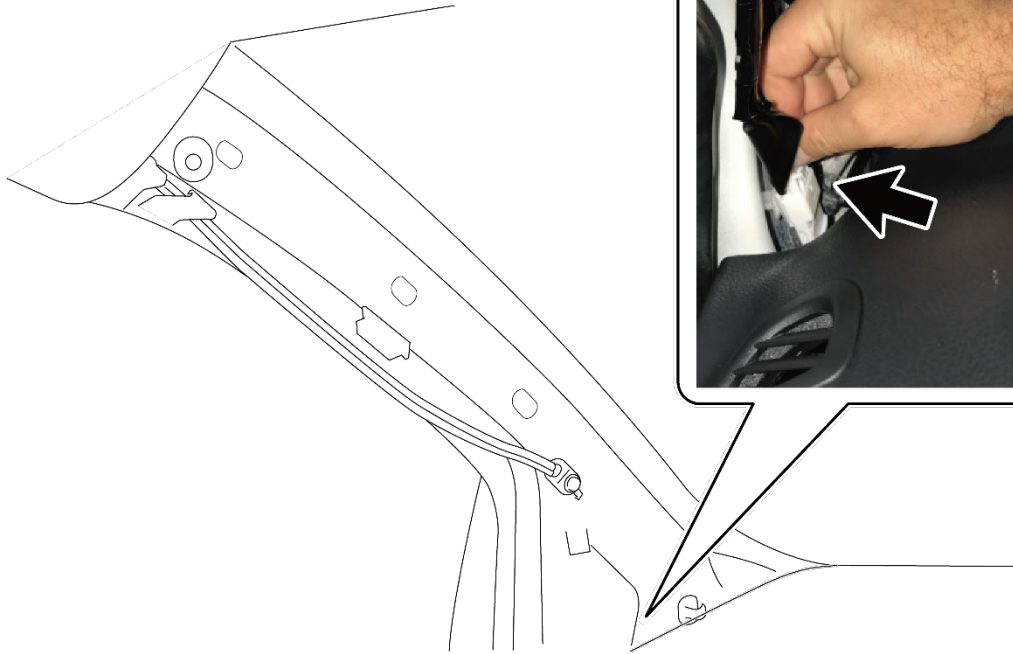

4. REMOVE INSTRUMENT PANEL WIRE CLIP AT CONNECTOR FROM BODY

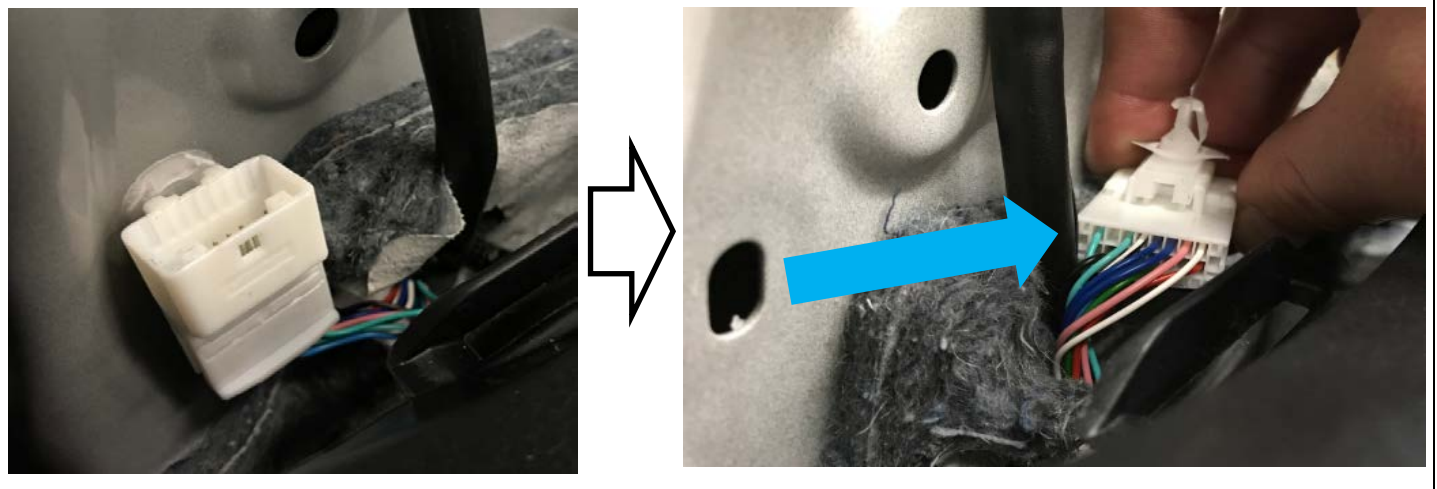

5. CUT INSTRUMENT PANEL WIRE

- a. After removal from the body, rotate the clip to expose the wires





There are 2 light green wires! Make sure to cut wire that is more toward middle of connector.

View from back of connector
once rotated to
proper orientation

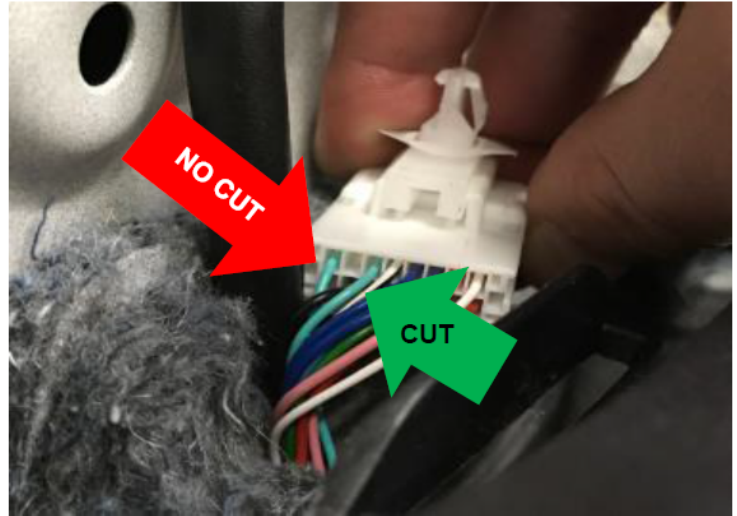
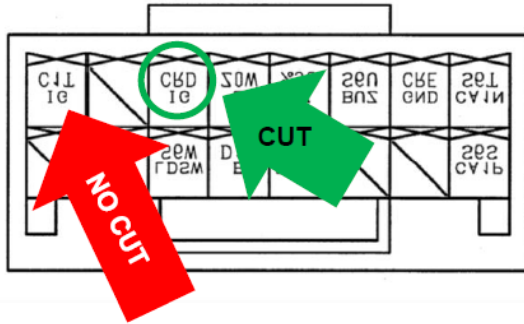

- b. Cut the light green wire if the instrument panel wire as close to the connector as possible

- c. Cap the top of the cut wire and crimp it. Securely fasten the cut wire to the instrument panel wire with the vinyl tape

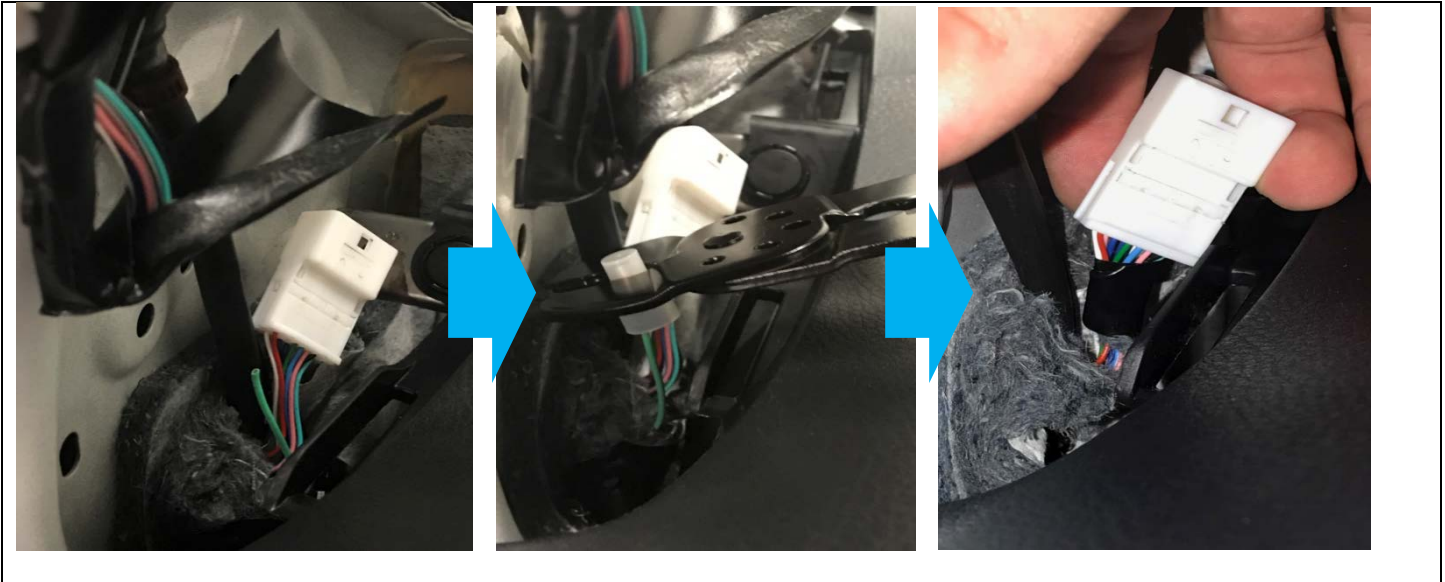

Nylon Closed-End Crimp Connector



This wire is B+ 12V supply. It must be securely capped and taped to instrument panel wire bundle to avoid shorting.

- 6. REINSTALL INSTRUMENT PANEL WIRE CLIP AT CONNECTOR FROM BODY
- 7. RECONNECT INSTRUMENT PANEL WIRE FROM ROOF WIRE

NOTE: RH SIDE IS SHOWN BELOW AS EXAMPLE

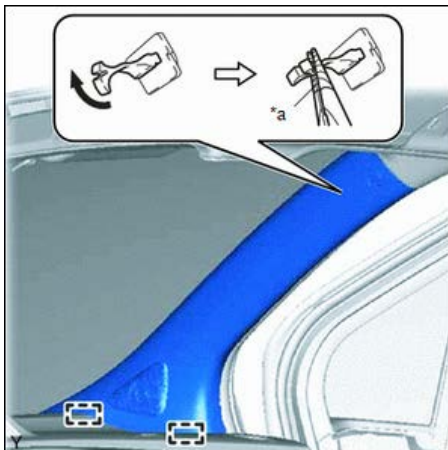

- 8. INSTALL FRONT PILLAR GARNISH LH
 - a. Engage the 2 guides
 - b. Turn the end of the front pillar garnish clip 90° with needle-nose pliers and install it into the front pillar garnish

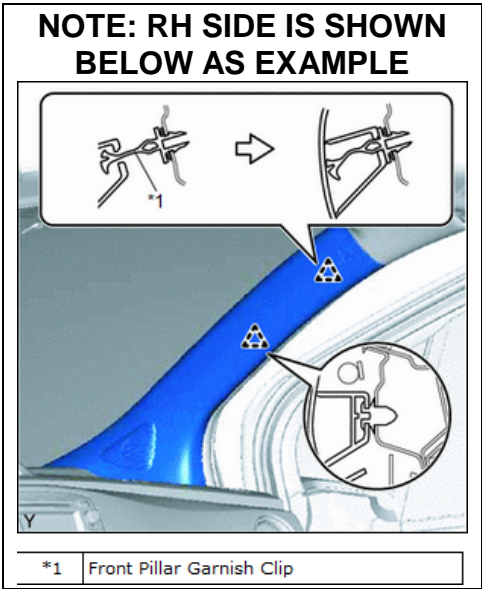

- c. Engage both the clip and the front pillar garnish clip to install the front pillar garnish

9. REINSTALL FRONT DOOR OPENING TRIM WEATHERSTRIP LH

10. RECONNECT THE CABLE TO THE NEGATIVE BATTERY TERMINAL

11. PERFORM HEALTH CHECK USING TECHSTREAM

12. REINSPECT AHB SYSTEM

13. MEMORIZE STEERING ANGLE NEUTRAL POINT

- a. Start the engine
- b. Drive the vehicle straight ahead at 22 MPH (35 km/h) or more for 5 seconds or more
- c. Turn the ignition switch off

14. RESTORE AUDIO AND AIR CONDITIONING SETTINGS

VIII. APPENDIX

A. PARTS DISPOSAL

As required by Federal Regulations, please make sure all recalled parts (original parts) removed from the vehicle are disposed of in a manner in which they will not be reused, ***unless requested for parts recovery return.***

B. CAMPAIGN DESIGNATION DECORDER

