

Front License Plate and Mounting Bracket Installation During PDS

Service Category General

Section Pre-Delivery Service

Market USA

Lexus Supports
ASE Certification 

Applicability

YEAR(S)	MODEL(S)	ADDITIONAL INFORMATION
2018	LX570	

Introduction

The 2018 model year LX 570 front license plate bracket and two self-tapping screws are stored in the luggage compartment of the vehicle at the assembly plant. For states that require a front license plate, install the bracket and bolts on the bumper cover during Pre-Delivery Service (PDS) using the following procedure.

Warranty Information

OP CODE	DESCRIPTION	TIME	OFP	T1	T2
N/A	Not Applicable to Warranty	–	–	–	–

Front License Plate and Mounting Bracket Installation During PDS

Installation Procedure

1. Remove the two radiator grille moldings by disengaging the three claws on each.

Figure 1.

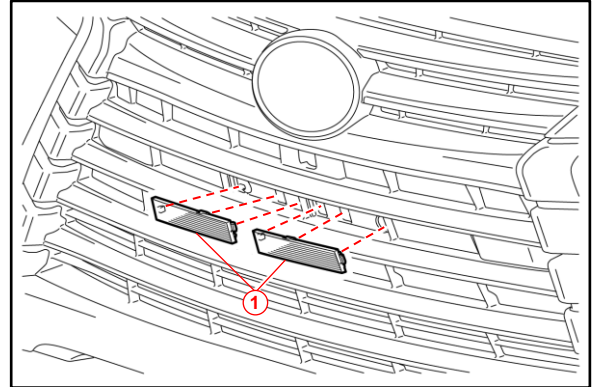

1	Radiator Grille Moldings
----------	---------------------------------

2. Attach the hooks of the front license plate mounting bracket to the air intake of the radiator grille and hold in place.
3. Align holes "A" of the mounting bracket with the installation holes on the radiator grille.

NOTE

- Holes "A" are used to install the mounting bracket to the bumper cover.
- Holes "B" are used to install the front license plate to the mounting bracket.

Figure 2.

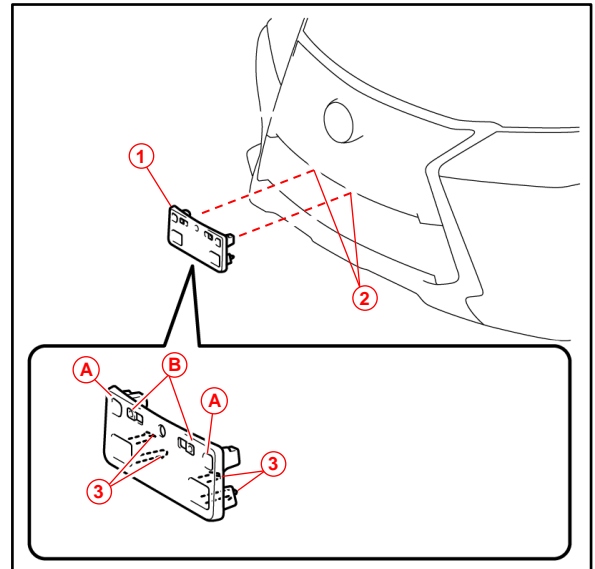

1	Mounting Bracket
2	Installation Holes
3	Hooks

Front License Plate and Mounting Bracket Installation During PDS

Installation Procedure (Continued)

4. Install the mounting bracket to the radiator grille using the two self-tapping screws provided.

NOTE

Do NOT over-tighten the self-tapping screws.

Figure 3.

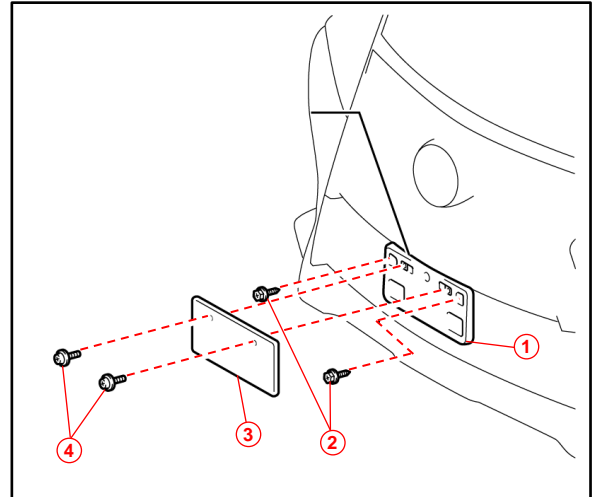

1	Mounting Bracket
2	Self-tapping Screws
3	License Plate
4	Bolts

5. Install the front license plate using two non-corroding bolts with the following dimensions:

Nominal Length: 15.0 mm (0.59 in.)

Diameter: 6.0 mm (0.24 in.)

Figure 4.

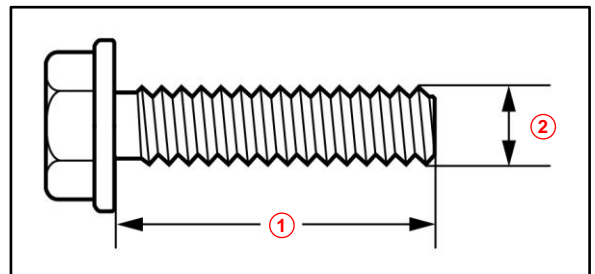

1	Nominal Length
2	Diameter