

2018 PRE-DELIVERY SERVICE CHECK SHEET

Market: USA

March 2017

| BEFORE INSPECTION | OK | Adjust/Repair |
|---|--------------------------|--------------------------|
| 1 Install D/C Cut Fuse* (See page 2)..... | <input type="checkbox"/> | <input type="checkbox"/> |
| FUNCTIONAL OPERATION | | |
| <i>Apply parking brake and cycle ignition "IG-ON"; place gear selector in reverse; turn on lights and rear defogger. Unlock all doors, release fuel door, release trunk hatch.</i> | | |
| 1 Check dome, courtesy, map, and sun visor lights*..... | <input type="checkbox"/> | <input type="checkbox"/> |
| 2 Check warning/indicator lights, gauges, and horn..... | <input type="checkbox"/> | <input type="checkbox"/> |
| 3 Check windshield wipers and washers..... | <input type="checkbox"/> | <input type="checkbox"/> |
| 4 Check headlights, instrument lights, turn signals, emergency flashers, and brake lights | <input type="checkbox"/> | <input type="checkbox"/> |
| 5 Check inside/outside rear view mirror operation/adjustment*..... | <input type="checkbox"/> | <input type="checkbox"/> |
| 6 Check USB and 12V power outlets..... | <input type="checkbox"/> | <input type="checkbox"/> |
| 7 Check audio/navigation*/backup camera systems and set clock..... | <input type="checkbox"/> | <input type="checkbox"/> |
| 8 Install shift-lock override button cover (key slot oriented along LEFT side cover, at 9 o'clock position) | <input type="checkbox"/> | <input type="checkbox"/> |
| 9 Check sliding roof* | <input type="checkbox"/> | <input type="checkbox"/> |
| WALKAROUND INSPECTION | | |
| <i>Start at left front door. Check window and door lock operation (from master power switch, if equipped). Continue around vehicle in a counterclockwise direction checking each door and window operation, child door locks, seat belts, interior condition, all lights, luggage compartment contents. Finish by checking headlight aim and continue into UNDER HOOD checks.</i> | | |
| 1 Check Smart Key System*..... | <input type="checkbox"/> | <input type="checkbox"/> |
| 2 Check door and door lock operation, including each wireless remote control/theft deterrent system*..... | <input type="checkbox"/> | <input type="checkbox"/> |
| 3 Check window operation..... | <input type="checkbox"/> | <input type="checkbox"/> |
| 4 Check that engine starts with all keys | <input type="checkbox"/> | <input type="checkbox"/> |
| 5 Check that child safety door locks are in normal (unlocked) position..... | <input type="checkbox"/> | <input type="checkbox"/> |
| 6 Check seats and seat belt operation..... | <input type="checkbox"/> | <input type="checkbox"/> |
| 7 Check rear defogger/rear view mirror defogger*..... | <input type="checkbox"/> | <input type="checkbox"/> |
| 8 Check side marker, tail, backup, and license plate lights.... | <input type="checkbox"/> | <input type="checkbox"/> |
| 9 Check luggage compartment light* and trim appearance.... | <input type="checkbox"/> | <input type="checkbox"/> |
| 10 Adjust spare tire pressure, inspect for damage, and check jack and tool installation..... | <input type="checkbox"/> | <input type="checkbox"/> |
| 11 Check headlight aim..... | <input type="checkbox"/> | <input type="checkbox"/> |
| UNDER HOOD | | |
| 1 Check engine oil level..... | <input type="checkbox"/> | <input type="checkbox"/> |
| 2 Check brake fluid level..... | <input type="checkbox"/> | <input type="checkbox"/> |
| 3 Check engine coolant level | <input type="checkbox"/> | <input type="checkbox"/> |
| 4 Check inverter coolant level*..... | <input type="checkbox"/> | <input type="checkbox"/> |
| 5 Check windshield washer fluid level..... | <input type="checkbox"/> | <input type="checkbox"/> |
| 6 Check battery State-Of-Charge using Digital Battery System Analyzer (SOC Reading: _____%) | <input type="checkbox"/> | <input type="checkbox"/> |
| 7 Inspect for fuel, oil, coolant, and other fluid leaks..... | <input type="checkbox"/> | <input type="checkbox"/> |
| BATTERY MAINTENANCE* | | |
| 1 Perform HV battery check and maintenance..... | <input type="checkbox"/> | <input type="checkbox"/> |
| * Inspect or install when equipped/required. | | |
| Notes: | | |

| UNDER VEHICLE (ON HOIST) | OK | Adjust/Repair |
|--|--------------------------|--------------------------|
| 1 Remove disc brake anti-rust covers/anti-corrosion wheel film* (remove just prior to customer delivery)..... | <input type="checkbox"/> | <input type="checkbox"/> |
| 2 Inspect tires for defects/damage..... | <input type="checkbox"/> | <input type="checkbox"/> |
| 3 Initialize or verify Tire Pressure Warning System (TPWS) (See page 2)..... | <input type="checkbox"/> | <input type="checkbox"/> |
| 4 Install wheel covers/caps/spare tire wheel covers*..... | <input type="checkbox"/> | <input type="checkbox"/> |
| 5 Check hybrid transmission fluid level*..... | <input type="checkbox"/> | <input type="checkbox"/> |
| 6 Inspect for fuel, oil, coolant, and other fluid leaks..... | <input type="checkbox"/> | <input type="checkbox"/> |
| 7 Inspect under the vehicle for damage, rust, etc..... | <input type="checkbox"/> | <input type="checkbox"/> |
| 8 Visually check bolts and nuts on chassis and powertrain for looseness..... | <input type="checkbox"/> | <input type="checkbox"/> |
| 9 Install rubber body plugs (stored in glove box or center console)*..... | <input type="checkbox"/> | <input type="checkbox"/> |
| 10 Install front wheel opening extension pads (See page 2).... | <input type="checkbox"/> | <input type="checkbox"/> |
| ROAD TEST | | |
| <i>A complete road test helps assure customer satisfaction. Drive vehicle over a variety of road surfaces and driving conditions. Check for unusual noise and driving performance.</i> | | |
| Enter Odometer Readings | | |
| Reading Before Test: _____ Reading After Test: _____ | | |
| 1 Check cold engine operation..... | <input type="checkbox"/> | <input type="checkbox"/> |
| 2 Check engine operation during warm-up..... | <input type="checkbox"/> | <input type="checkbox"/> |
| 3 Check engine operation at normal operating temperature.. | <input type="checkbox"/> | <input type="checkbox"/> |
| 4 Check transmission operation..... | <input type="checkbox"/> | <input type="checkbox"/> |
| 5 Check brake and parking brake operation | <input type="checkbox"/> | <input type="checkbox"/> |
| 6 Check steering operation and off-center/vehicle pull/flutter | <input type="checkbox"/> | <input type="checkbox"/> |
| 7 Inspect for abnormal noise and vibration | <input type="checkbox"/> | <input type="checkbox"/> |
| 8 Inspect for squeaks and rattles | <input type="checkbox"/> | <input type="checkbox"/> |
| 9 Check Blind Spot Monitor System* | <input type="checkbox"/> | <input type="checkbox"/> |
| 10 Check front and rear* heater and A/C operation..... | <input type="checkbox"/> | <input type="checkbox"/> |
| 11 Check cruise control operation* | <input type="checkbox"/> | <input type="checkbox"/> |
| 12 Check front seat heater/ventilation operation*..... | <input type="checkbox"/> | <input type="checkbox"/> |
| 13 Set/calibrate compass* (See page 2)..... | <input type="checkbox"/> | <input type="checkbox"/> |
| 14 Initialize Parking Assist Monitor System* (See Repair Manual: Camry / Camry HV)..... | <input type="checkbox"/> | <input type="checkbox"/> |
| 15 Calibrate Intelligent Clearance Sonar System* (See page 2)..... | <input type="checkbox"/> | <input type="checkbox"/> |
| FINAL INSPECTION AND CLEANING | | |
| 1 Remove interior protective covers, unnecessary labels, tags, etc. (Remove just before delivery to customer)..... | <input type="checkbox"/> | <input type="checkbox"/> |
| 2 Visually inspect all interior parts for installation, damage, fit, dirt, etc..... | <input type="checkbox"/> | <input type="checkbox"/> |
| 3 Verify floor mat application and install using retaining clips*..... | <input type="checkbox"/> | <input type="checkbox"/> |
| 4 Verify green light is illuminated on SOS (Safety Connect) button*..... | <input type="checkbox"/> | <input type="checkbox"/> |
| 5 Remove Raggard™ and clear protective bumper film*..... | <input type="checkbox"/> | <input type="checkbox"/> |
| 6 Wash and clean vehicle..... | <input type="checkbox"/> | <input type="checkbox"/> |
| 7 Inspect paint finish for scratches, chips, rust, dents, damage, etc..... | <input type="checkbox"/> | <input type="checkbox"/> |
| 8 Inspect exterior body parts for proper installation, damage, rust, etc..... | <input type="checkbox"/> | <input type="checkbox"/> |
| 9 Place oil change sticker on inside of windshield, top left corner..... | <input type="checkbox"/> | <input type="checkbox"/> |
| 10 Place Owner's Manual portfolio* in glove box..... | <input type="checkbox"/> | <input type="checkbox"/> |
| 11 Install front license plate and mounting bracket (See page 2)..... | <input type="checkbox"/> | <input type="checkbox"/> |
| 12 Perform Techstream Health Check..... | <input type="checkbox"/> | <input type="checkbox"/> |

Completion and retention of this form is required to comply with Toyota's Warranty Policy.

TECHNICIAN'S SIGNATURE

SERVICE MANAGER'S SIGNATURE

NAME (PLEASE PRINT)

NAME (PLEASE PRINT)

We hereby certify that all items on this form have been checked and corrected for proper operation as required.

Date

Dealer Name

Dealer Code

Vehicle Identification Number (Sticker)

D/C CUT FUSE INSTALLATION

The D/C CUT FUSE (25A) has been removed at the assembly plant to reduce parasitic current draw in transit and storage.

1. The removed D/C CUT FUSE (25A) is stored in the blank space of the relay block in the engine compartment.
2. The D/C CUT FUSE (25A) MUST be reinstalled to the original location during PDS (Pre-Delivery Service) at the dealership.

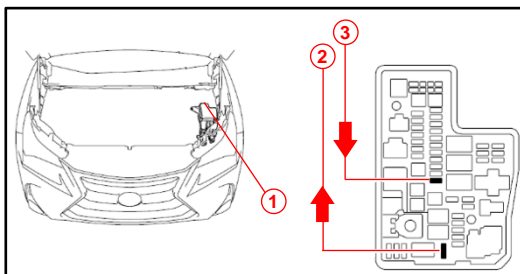

- 1 Relay Block
- 2 Remove This D/C CUT FUSE (25A)
- 3 Install D/C CUT FUSE (25A) Here (Original Location)

TPWS INITIALIZATION (for models equipped with a RESET switch)

Refer to the Repair Manual for the initialization procedure ([Camry / Camry HV](#)). Note the spare tire does NOT have a TPWS sensor.

NOTE

To adjust the tire pressure correctly when the outside temperature is significantly colder than shop temperature, perform a Health Check using Techstream and select the "Compensation Tire Pressure" checkbox. Compensation pressures will be displayed on the Health Check results screen. Adjust the tire pressure when the tires are cold.

CALIBRATION OF INTELLIGENT CLEARANCE SONAR SYSTEM

As the D/C CUT FUSE is removed, the steering angle sensor power source is cut OFF. It is necessary to calibrate the intelligent clearance sonar system because the steering angle sensor center position may NOT be stored correctly.

1. Start the engine (hybrid system).
2. Drive the vehicle straight ahead at 35km/h (22mph) or more for 5 seconds or more.

NOTE

When the ICS OFF indicator light changes from blinking to OFF, calibration of the intelligent clearance sonar system is complete.

3. Turn the engine switch (power switch) OFF.

FRONT WHEEL OPENING EXTENSION PAD INSTALLATION

The front wheel opening extension pad set (right and left front wheel opening extension pads) is loaded in the luggage compartment at the assembly plant to avoid damage in transit.

1. Remove the 3 tapping screws from the engine under cover (the screws will be reused for installation).
2. Place the left front wheel opening extension pad on the installation position as shown and tighten the 3 tapping screws.

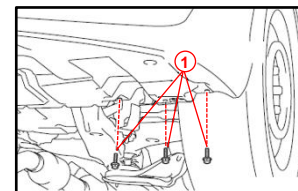
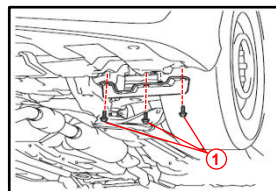

1 Tapping Screw

NOTE

There is a distinguishable mark indicating left and right on each pad.

3. Repeat steps 1 and 2 for the right side.

COMPASS CALIBRATION

Refer to pg. 408 of the Owner's Manual for the [Calibration procedure](#) for vehicles equipped with a compass in the rear view mirror.

NOTE

- Do NOT perform calibration of the compass in a place where the Earth's magnetic field is subject to interference (underground parking, under a steel tower, between buildings, roof parking, near a railroad crossing, near a large vehicle, etc.).
- During calibration, do NOT operate electric systems (moon roof, power windows, etc.) as they may interfere with the calibration.

FRONT LICENSE PLATE & MOUNTING BRACKET INSTALLATION

1. Position the front license plate mounting bracket over the lower grille.
2. Align the installation holes on the mounting bracket with the dimples on the front of the lower grille.
3. Screw in the 2 long self-tapping screws through the slotted and round holes of the mounting bracket, directly into the dimples on the lower grille.
4. Insert license plate into tabs on the bracket.
5. Align the top holes of the license plate with the rounded holes of the mounting bracket.
6. Screw in 2 short self-tapping screws through the license plate holes into the mounting bracket.

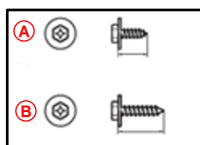

- A Short Self-tapping Screw
16 mm (0.630 in.)
- B Long Self-tapping Screw
37 mm (1.456 in.)

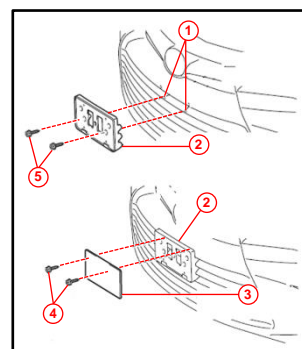

- 1 Dimples
- 2 Front License Plate Mounting Bracket
- 3 License Plate
- 4 Short Self-tapping Screw
- 5 Long Self-tapping Screw