



Countries: CANADA, UNITED STATES, MEXICO
Availability: FleetSIS, IsSIR
Major System: ENGINES
Current Language: English
Other Languages: NONE
Viewed: 31

Document ID: IK1201383
Revision: 0
Created: 7/27/2017
Last Modified: 7/28/2017
Author: Caleb Iverson

[Less Info](#)

Hide Details

Coding Information

Copy Link 	Copy Relative Link 	Bookmark View My Bookmarks	Add to Favorites 	Print 	Provide Feedback 	Helpful 0	Not Helpful 0
----------------------	-------------------------------	--	-----------------------------	------------------	-----------------------------	-------------------------	-----------------------------

Title: LoneStar Air Filter Service Procedure

Applies To: LoneStar

CHANGE LOG

Please refer to the change log text box below for recent changes to this article:

07/28/2017 - Initial Article Release

DESCRIPTION

This document will guide the user through servicing/replacing the air filter on LoneStar trucks. LoneStar air filters are to be service from the bottom of the filter housing.

This documentation can also be found in the Operation and Maintenance Manual: [0000076370](#)

SYMPTOM(s)

Diagnostic Trouble Code(s) & Dashboard Indicator Light(s):

DTC/Light	Description
N/A	

Customer Observations or Concerns:

Malfunction Indicator Lamp, Stop Engine Light, Amber Warning Light, Engine Warning Light
 Low-power

SPECIAL TOOL(s) / SOFTWARE

Tool Description	Tool Number	Comments	Instructions
N/A			

SERVICE PARTS INFORMATION

Kit Description	Part Number	Quantity Required	Notes
Air Filter Left Side	3673668C1	1	
Air Filter Right Side	3673669C1	1	

REPAIR STEP(s)

WARNING:

To prevent personal injury and / or death, always wear safe eye protection when performing vehicle maintenance.

WARNING:

To prevent property damage, personal injury, and / or death, park vehicle on a hard, flat surface, turn the engine off, set the parking brake, and install wheel chocks to prevent the vehicle from moving in either direction.

If the service condition of the pipes, hoses, or clamps is questionable, replace those parts.

- Check for loose hoses and clamps.
- Check for ruptured, bulging, or collapsed hoses.
- Check air cleaner housing for cracks.

Air Restriction Gauge

The air restriction gauge indicates how much engine air cleaner filter capacity has been used and how much filter capacity remains. It measures maximum restriction of the filter element when the engine is operated at full load and locks at that point. This feature gives the operator the capability of reading maximum restriction with the engine shutdown. The air restriction gauge is mounted on the right side air intake pipe and visible from the right side of the engine. It is recommended that the operator not reset the gauge until it has been determined if air cleaner service is required.

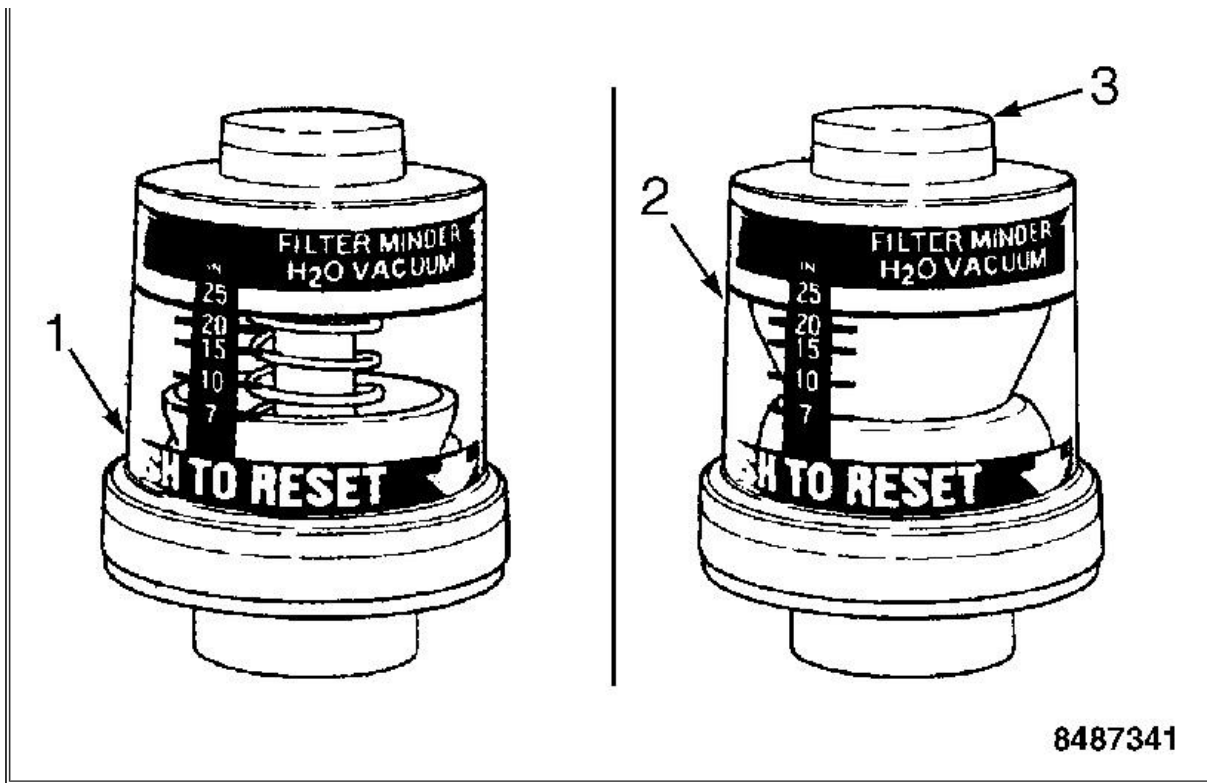

Figure #1: Filter Minder

- Item 1: Low Restriction
- Item 2: High Restriction
- Item 3: Reset Button

The initial restriction with a new air filter element will vary with air cleaner design and installation. After servicing the filter element, reset the yellow indicator by pushing the reset button and releasing it. The yellow indicator will drop to near or below the window so the air restriction gauge can be reused.

NOTE: After starting engine, indicator may be seen in lower part of window. This is normal and should not be mistaken as a signal for element service.

The LoneStar® is equipped with two air cleaner housings, one on each side of the cowl. The filter element can easily be changed without the use of any tools.



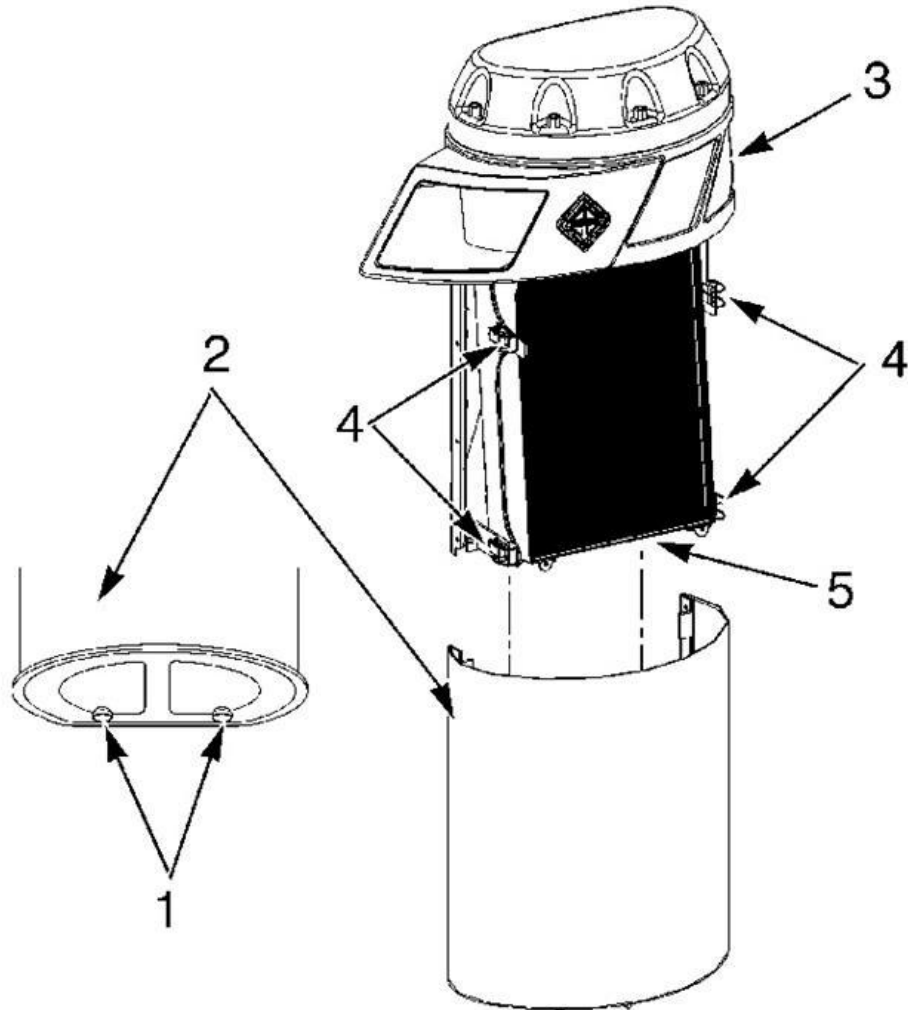

3817038

Figure #2: Air Filter Element Service

- Item 1: Thumb Screws
- Item 2: Filter Element Cover
- Item 3: Air Cleaner Housing
- Item 4: Latches
- Item 5: Filter Element

1. Inspect the filter restriction gauge. Do not change the filter unless the gauge is at or near 25 inches H₂O.

2. Locate two thumb screws on the bottom of the filter element cover. Loosen both thumb screws until they disengage from the air cleaner housing. The thumb screws are attached to the filter element cover with retainer washers so they cannot be removed from the filter element cover.

NOTE: The air cleaner housing electrical connector that supplies the air cleaner housing marker lights will automatically disengage from the filter element cover when the filter element cover is removed.

3. Remove the filter element cover by sliding the filter element cover down and off the air cleaner housing. If the filter element cover will not come loose, it may be necessary to tap on the sides of the filter element cover in a downward motion with the palm of our hand to free the filter element cover from the air cleaner housing.

NOTE: Be careful not to bump the filter when removing it from the housing; this can raise a cloud of dust that can enter the clean side piping to the turbocharger.

4. Unhook four latches from the filter element. Remove the filter element by pulling the bottom of the filter element away from the air cleaner housing and down.
5. Wipe the inside of the air cleaner housing and the port going to the engine with a clean damp cloth. **Do not** use compressed air to clean the air cleaner housing.
6. Visually inspect the air cleaner housing for damage or distortion, which could allow unfiltered air to enter the engine.
7. Inspect the new filter element for a damaged or non-resilient rubber gasket. Inspect the filter element body for dents or excessive pleat-bunching. If any of the mentioned conditions exist, obtain and install a new filter element from your International dealer.
8. Install the filter element into air cleaner housing, making sure that filter element seats squarely in housing. Secure the filter element using the four latches while making sure not to catch the filter pleats with the latches.
9. Install the filter element cover onto the air cleaner housing by starting at the bottom of the air cleaner housing and sliding the notched sides of the filter element cover up onto the air cleaner housing. Secure the filter element cover with two thumb screws.
10. When servicing is completed, reset air restriction gauge by pushing and holding the reset button and releasing it. The yellow indicator will drop near or below the window. Now the air restriction gauge is ready for the next operating cycle.
11. If the air cleaner housing is equipped with marker lights, test the marker lights to ensure they are functioning properly.

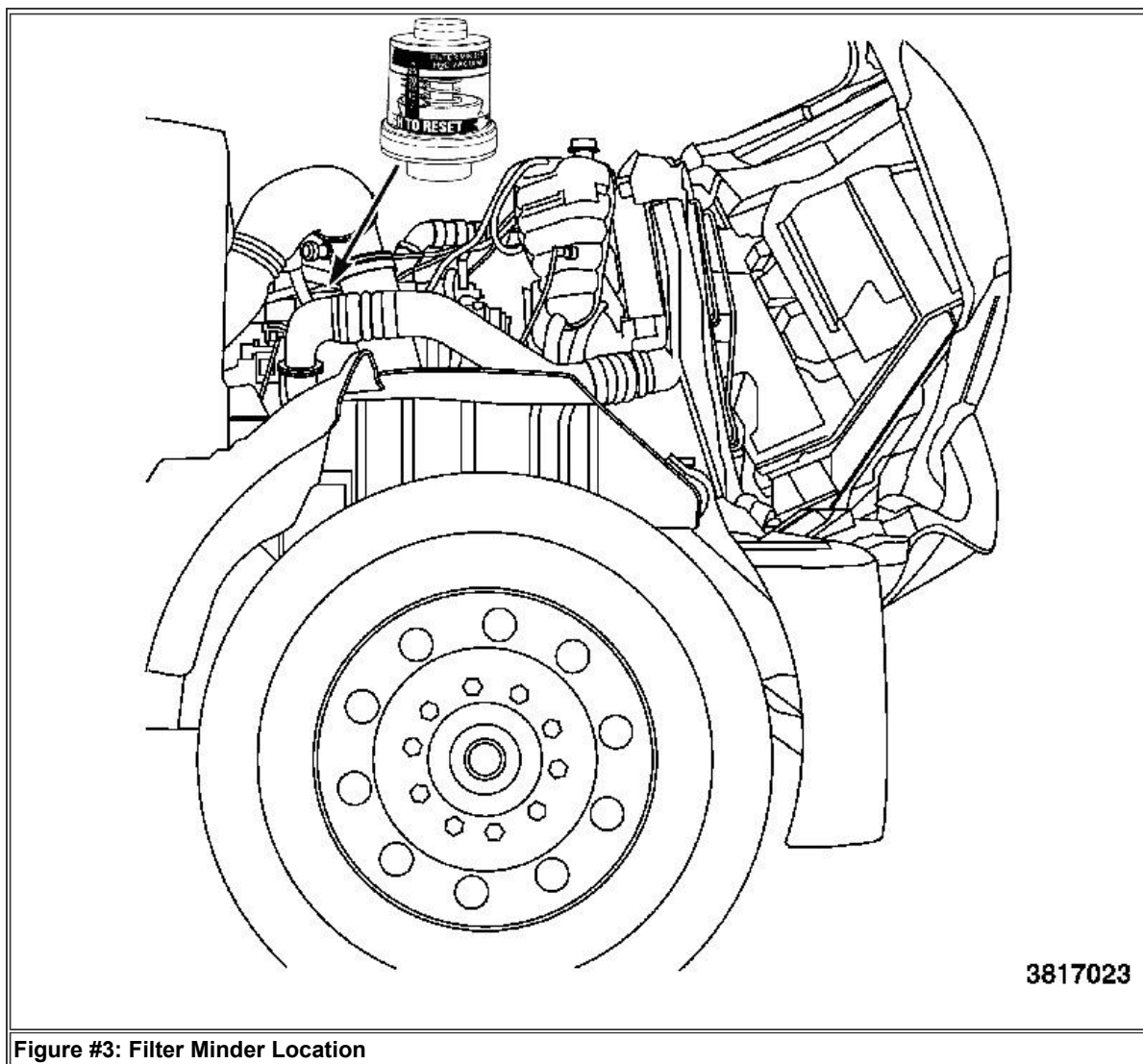

Figure #3: Filter Minder Location

NOTE: After starting engine, the indicator may be seen in the lower part of the window. This is normal and should not be mistaken as a signal for element service.

DIAGNOSTIC STEP(s)

N/A

WARRANTY INFORMATION

Warranty Claim Coding:

Refer to the [Warranty Coding Manual](#) for Group and Noun Codes.

Standard Repair Time(s):

Refer to the [SRT Manual](#) for Repair Times

OTHER RESOURCES

[Master Service Information Site](#)

 Hide Details

Feedback Information

Viewed: 30
Helpful: 0
Not Helpful: 0

No Feedback Found

Copyright © 2017 Navistar, Inc.