

December 16, 2017

07433 Version 1

Front Brakes Squealing Noise

AFFECTED VEHICLES

Year	Model	Trim	VIN range
2014	RLX Sport Hybrid	ALL	ALL
2016–17	RLX Sport Hybrid	ALL	ALL
2018	RLX Sport Hybrid	ALL	JH4KC2...JC000000 thru JH4KC2...JC000257

SYMPTOM

The front brakes squeal when the brake is released and the vehicle creeps forward, or when the vehicle is moving forward slowly and the vehicle is stopped.

POSSIBLE CAUSES

The shape of the front brake pads friction material.

CORRECTIVE ACTION

Resurface the rotors and replace the front brake pads, shims, and springs.

TOOL INFORMATION

Part Name	Part Number	Quantity
Brake Caliper Piston Compressor Tool	07AAE-SEPA101	1

PARTS INFORMATION

Part Name	Part Number	Quantity
Front Brake Pad Set	45022-TY3-A03	1

WARRANTY CLAIM INFORMATION

The normal warranty applies.

Operation Number	Description	Flat Rate Time	Defect Code	Symptom Code	Template ID	Failed Part Number
410150	Replace the front brake pads, shims, and springs.	0.4 hr	01401	04212	B17042B	45251-TY3-A00
A	Resurface rotors.	0.5 hr				

Skill Level: Repair Technician

CLIENT INFORMATION: The information in this bulletin is intended for use only by skilled technicians who have the proper tools, equipment, and training to correctly and safely maintain your vehicle. These procedures should not be attempted by "do-it-yourselfers," and you should not assume this bulletin applies to your vehicle, or that your vehicle has the condition described. To determine whether this information applies, contact an authorized Acura automobile dealer.

REPAIR PROCEDURE

1. Remove some brake fluid from the master cylinder reservoir.
2. Raise the vehicle on a lift.
3. Remove both front wheels.
4. Remove the brake hose mounting bolt.
5. Remove the flange bolt and lift the caliper body up out of the way.

NOTE:

- Be careful not to damage the pin boot.
- Be careful when pivoting the caliper body up, because the spring may pop out of position.
- Check the hose and pin boots for damage and deterioration.

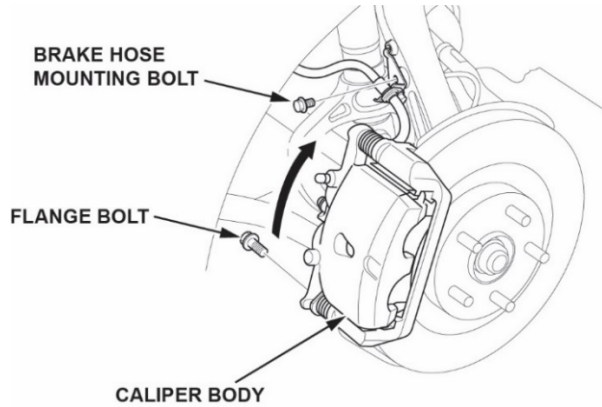

6. Remove the pad return springs.

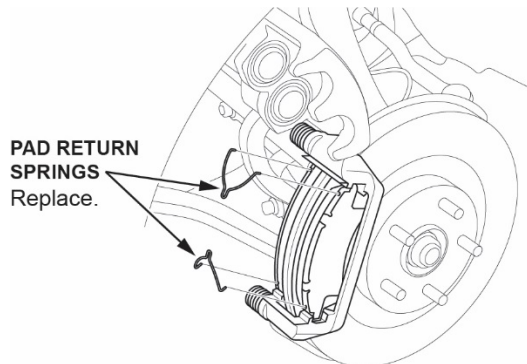

7. Remove the pad shims and the brake pads.

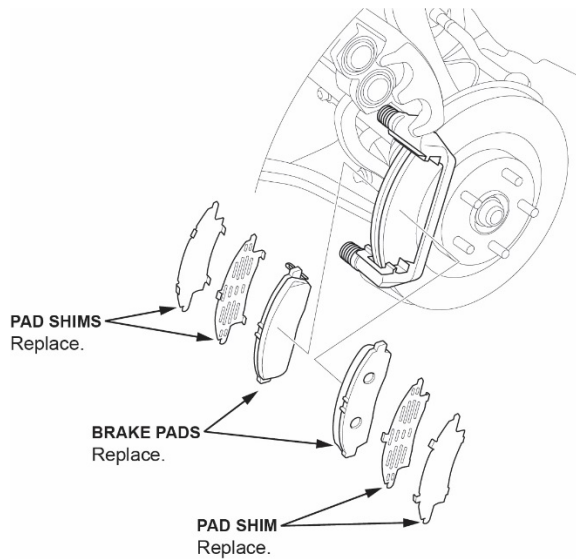

8. Remove the pad retainers.

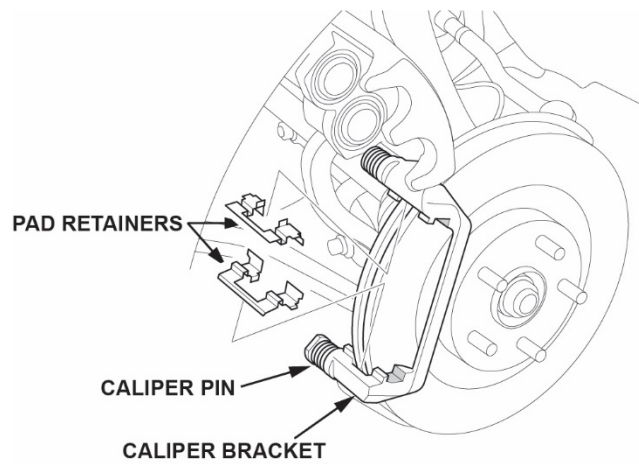

9. Clean the caliper bracket and verify that the caliper pins move in and out smoothly. Clean and lube if needed.
10. Resurface the rotors. Refer to the service information.
11. Apply a thin coat of M-77 assembly paste to the retainer mating surface of the caliper bracket, and install the pad retainers.

NOTE: Wipe off any excess assembly paste and keep the assembly paste away from the brake disc and brake pad surfaces.

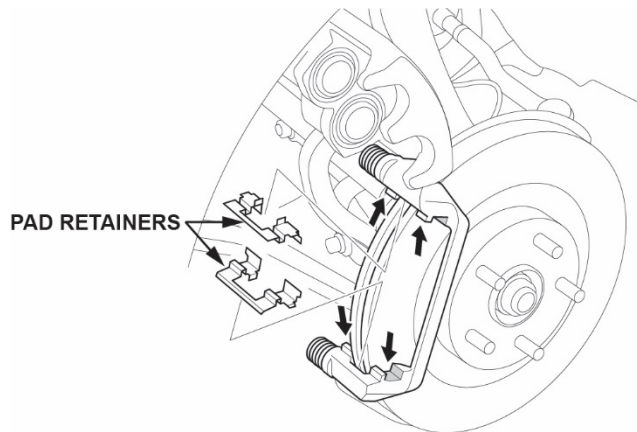

12. Install the brake caliper piston compressor tool (T/N 07AAE-SEPA101) on the caliper body.

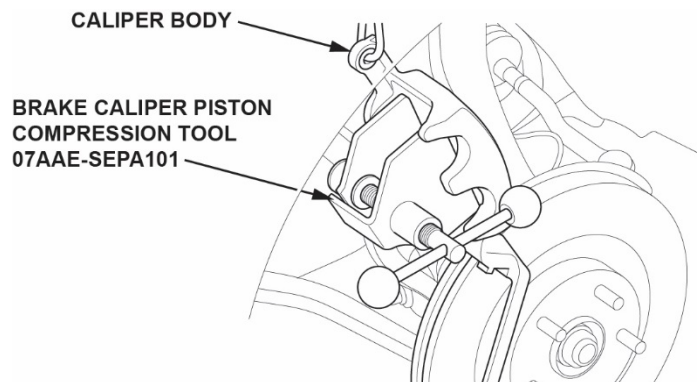

13. Press in the piston with the brake caliper piston compressor tool.

NOTE: Be careful when pressing in the piston, brake fluid may overflow from the master cylinder's reservoir. If brake fluid gets on any painted surface, wash it off immediately with water.

14. Remove the brake caliper piston compressor tool.

15. Make sure the correct countermeasure pad is being installed. The countermeasure pad is chamfered on both ends.



16. Apply a thin coat of M-77 Assembly paste to the **new** pad side of the shims, the back of the **new** brake pads, and the other areas indicated by the arrows shown in the picture below.

NOTE: Wipe off any excess assembly paste and keep the assembly paste away from the brake disc and brake pad surfaces.

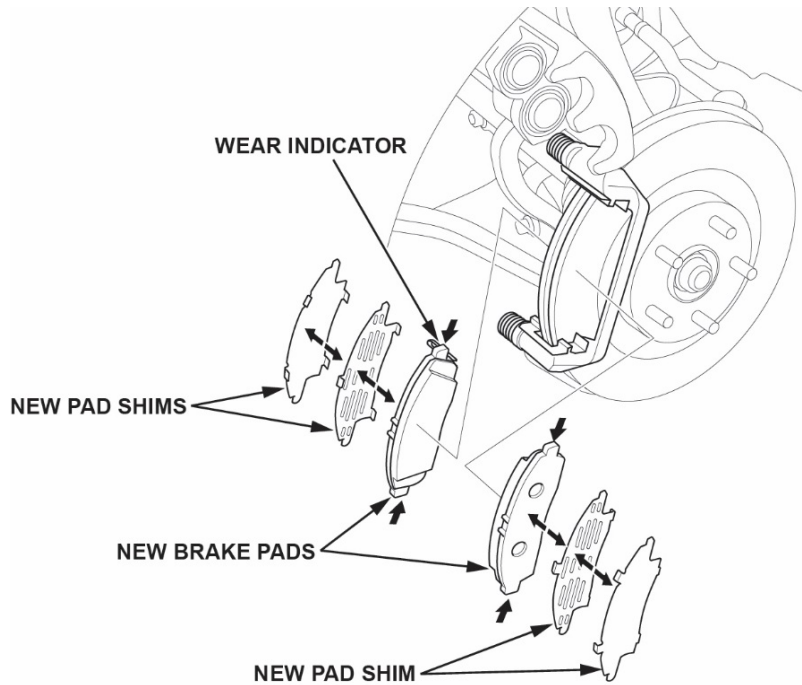

17. Install the new brake pads, make sure the brake pad wear indicator is facing up.

18. Install the **new** pad return springs.

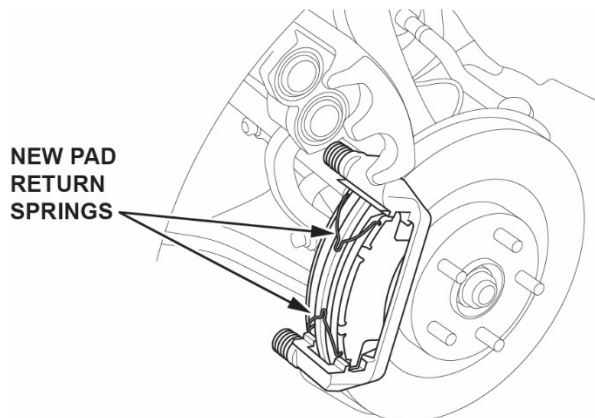

19. Pull the caliper body down into position.
20. Install the flange bolt and torque it to **72 N·m (53 lb-ft)** while holding the caliper pin in place.

NOTE Be careful not to damage the pin boot.

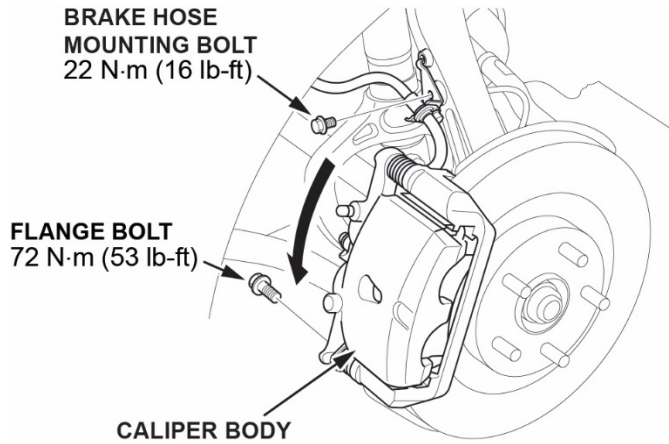

21. Install the brake hose mounting bolt and torque it to **22 N·m (16 lb-ft)**.
22. Press the brake pedal several times to make sure the brakes work properly.
23. Install the front wheels.
24. Add brake fluid as needed.

END