



Service Bulletin

File in Section: -

Bulletin No.: 17-NA-233

Date: July, 2017

TECHNICAL

Subject: Malfunction Indicator Lamp (MIL) Illuminated - DTC P0446 Set

Brand:	Model:	Model Year:		VIN:		Engine:	Transmission:
		from	to	from	to		
Chevrolet	Cruze	2016	2017			LE2	

Involved Region or Country	North America, South America, Israel
Condition	Some customers may comment that the MIL is illuminated. The technician may find DTC P0446 set.
Cause	This condition may be caused by water trapped in the evaporative emission canister filter pipe.
Correction	Installation of a boot on the evaporative emission canister filter pipe connector must be performed to seal the line from water intrusion.

Parts Information

Description	Part Number	Qty
Boot, Vent Line	84344135	1

Warranty Information

For vehicles repaired under the Emission coverage, use the following labor operation. Reference the Applicable Warranties section of Investigate Vehicle History (IVH) for coverage information.

Labor Operation	Description	Labor Time
4081708*	Evaporative Emission Canister Filter Pipe Connector Boot Installation	0.4 hr

*This is a unique Labor Operation for Bulletin use only.

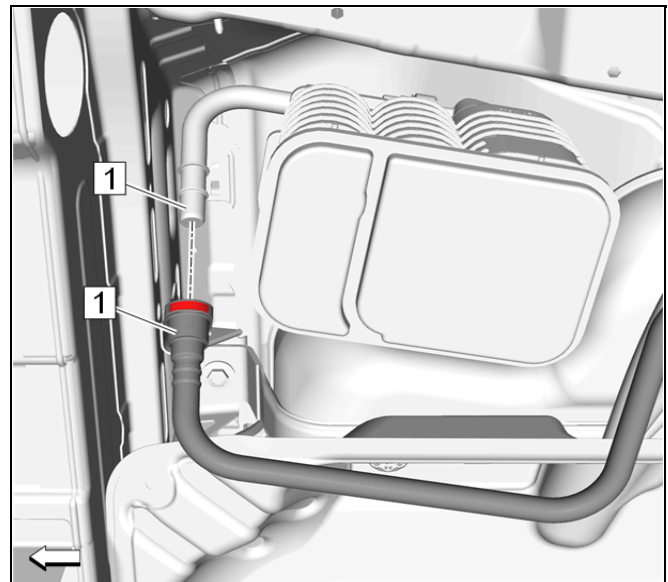

4743901

Service Procedure

Warning: Fuel Vapors in Evaporative Emission Components Warning

Warning: Safety Goggles and Fuel Warning

1. Disconnect the negative battery cable. Refer to *Battery Negative Cable Disconnection and Connection* in SI.
2. Raise and support the vehicle. Refer to *Lifting and Jacking the Vehicle* in SI.

3. Using care, disconnect the evaporative emission canister filter pipe (2) from the evaporative emission canister (1). Refer to *Plastic Collar Quick Connect Fitting Service* in SI.



4799118

Note: The boot must be positioned onto the pipe up to the pipe nozzle crimp location so that it can seal the filter pipe nozzle and connector.

4. Install the boot (2) onto the filter pipe (1).
 - Validate the boot has not rolled on itself when installed.
 - Allow time for water to drain or melt, if frozen, from the pipe.
5. Connect the evaporative emission canister filter pipe to the evaporative emission canister. Refer to *Plastic Collar Quick Connect Service* in SI.

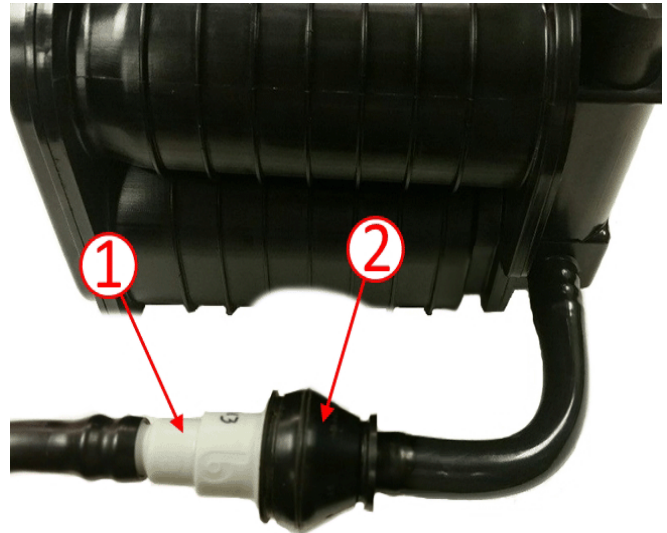

4799348

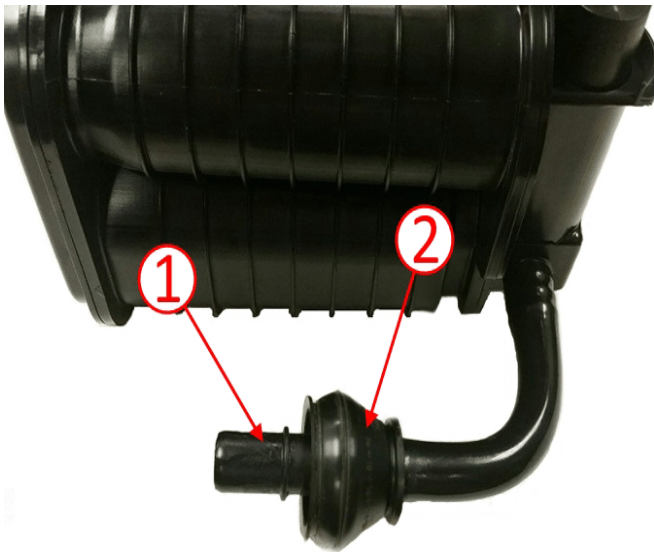

4799141

6. Using care, position the boot (2) around the pipes connector (1) so that it forms a seal.
7. Lower the vehicle.
8. Connect the negative battery cable.

Version	1
Modified	

