



GROUP
BODY ELECTRICAL

NUMBER
17-BE-002-G

DATE
NOVEMBER, 2017

MODEL(S)
G80

Technical Service Bulletin

SUBJECT: 2017MY-2018MY GENESIS G80 STANDARD NAVIGATION
VARIANT CODING

★ IMPORTANT

Use this information bulletin to variant code the standard navigation system after replacement.

Description: This bulletin describes the procedure to variant code the Genesis G80 (DH) navigation system. A black/blank screen or black and white image may be displayed from the rear view camera after the navigation unit is replaced without performing this variant coding procedure.



Applicable Vehicles: All 2017~2018MY Genesis G80 (DH) vehicles equipped with the standard navigation system.

SYMPTOM(S)

Black or Blank Screen



Black and White Image



Parts Information:

Parts Name	Part Number	Image	Remark
<ul style="list-style-type: none">• GDS-Mobile Complete Kit• GDS-Mobile Lit Kit (includes VCI II Module)	<ul style="list-style-type: none">• GDSM-CPKITH• GDSM-LTKITH		<ul style="list-style-type: none">• Tablet with GDS software• Scan tool needed to interface with vehicle

NOTE 1: GDS Mobile Kits have been sent to each dealership. Additional kits can be purchased through Bosch (1-866-539-4248).

WARRANTY INFORMATION: Normal warranty applies where applicable.

Service Procedure:

1. Press the **START STOP BUTTON (A)** to turn "ACC" ON.



2. Plug the VCI II Module into the vehicle's DLC port located in the lower left kick panel area (B).



3. Open the GDS software and tap the VCI button (C) at the top right corner to initiate a connection between the tablet and module.

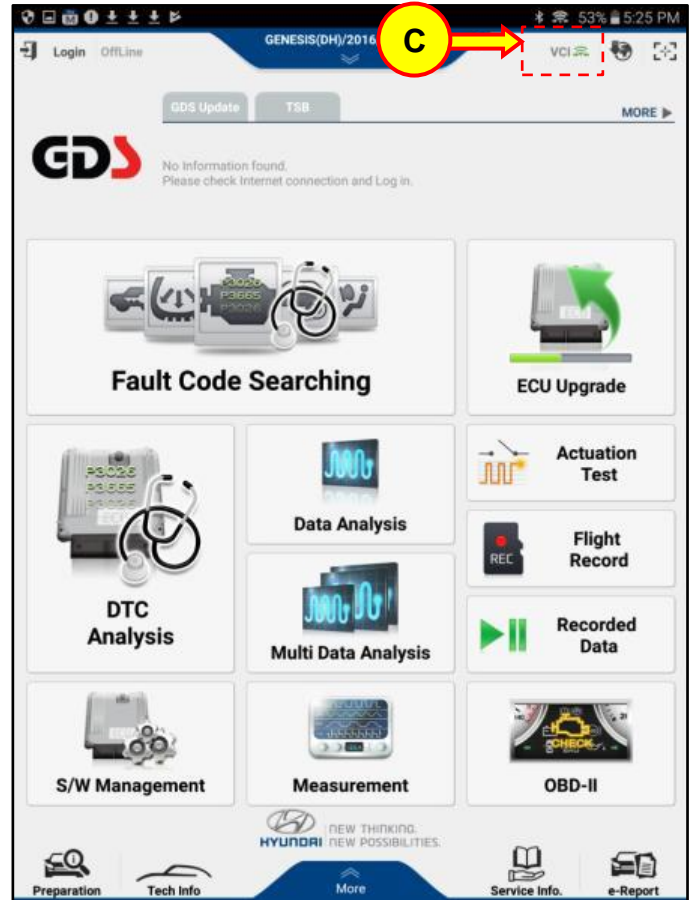

4. Once a connection has been established, tap the top of the screen (D) to enter the vehicle selection page.

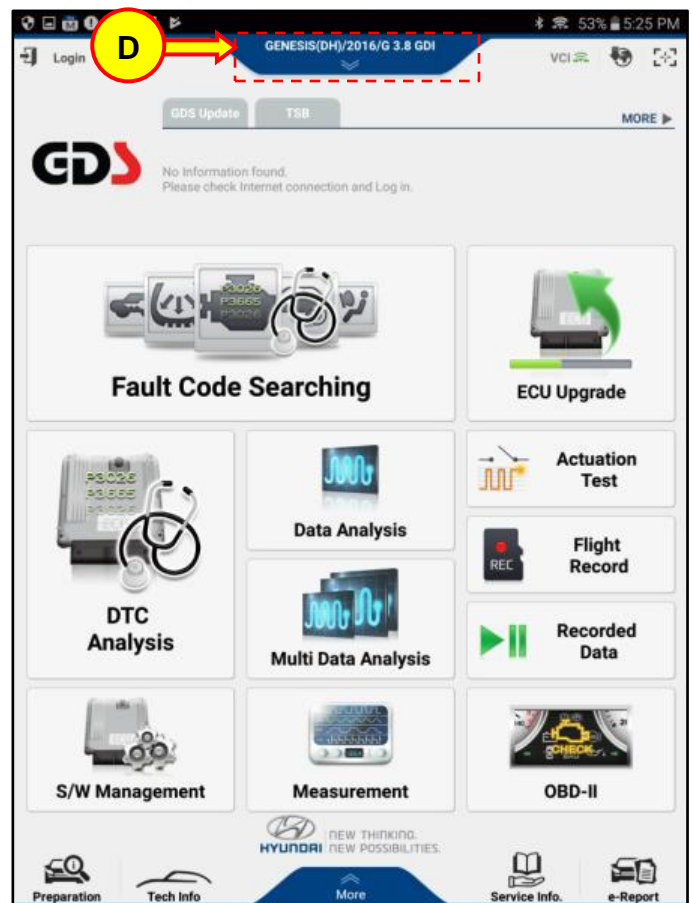

- 5. Tap the AUTO VIN button (E). The vehicle VIN, model, model year, and engine size will automatically populate. Then tap the OK button (F) to confirm the populated information.

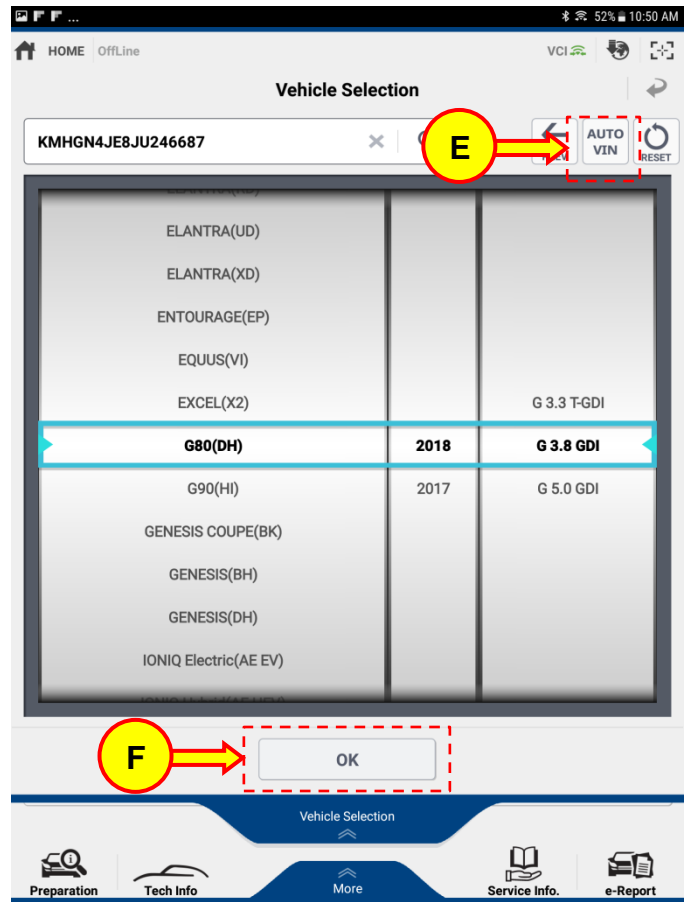

- 6. Upon Vehicle Selection confirmation, screen will load to the GDS Home page. Select the S/W Management button (G).

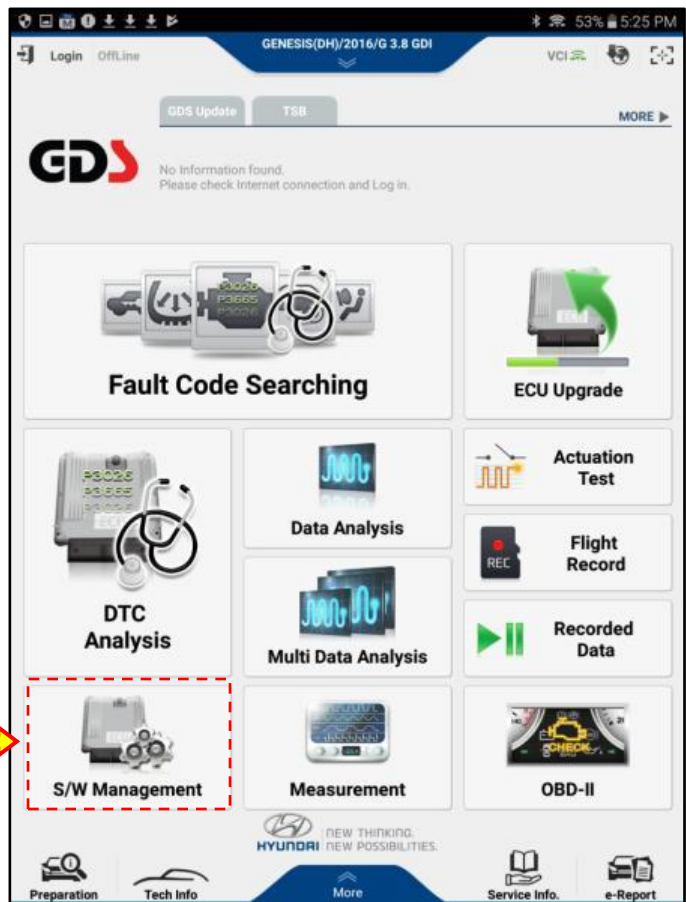

7. In the S/W management page, select Audio Video Navigation (Standard) (H). Then select Variant Coding (I).

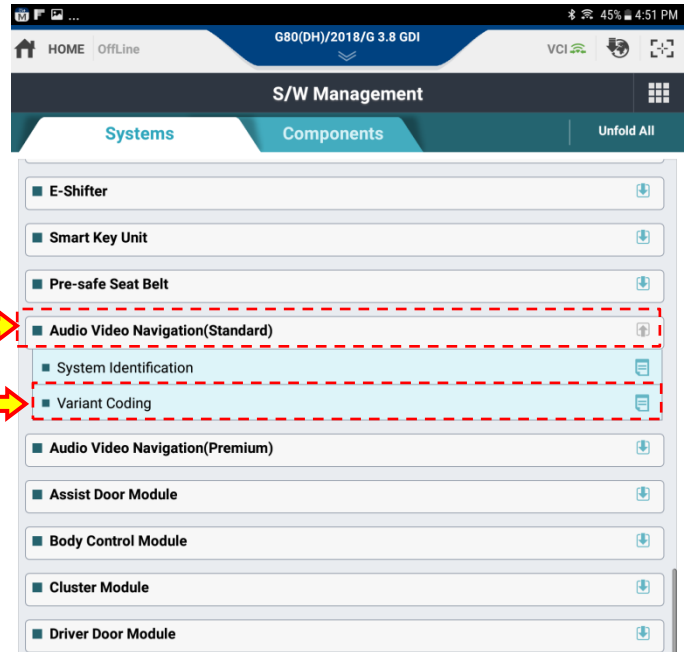

8. Upon selection of Variant Coding, you will be prompted with a warning not to touch any of the system buttons as interruption could damage the ECU. Tap "OK" to continue (J).

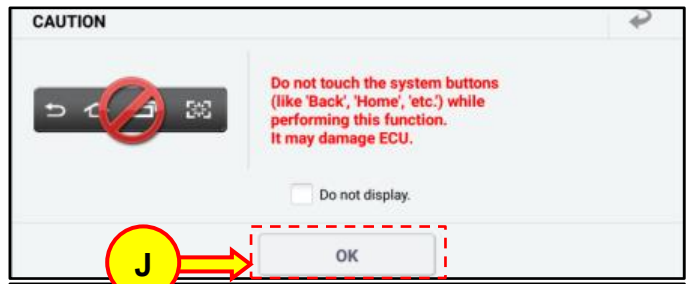

GDS-M will then display a set of preconditions which have been met in Step 1. Select "OK" to continue (K).

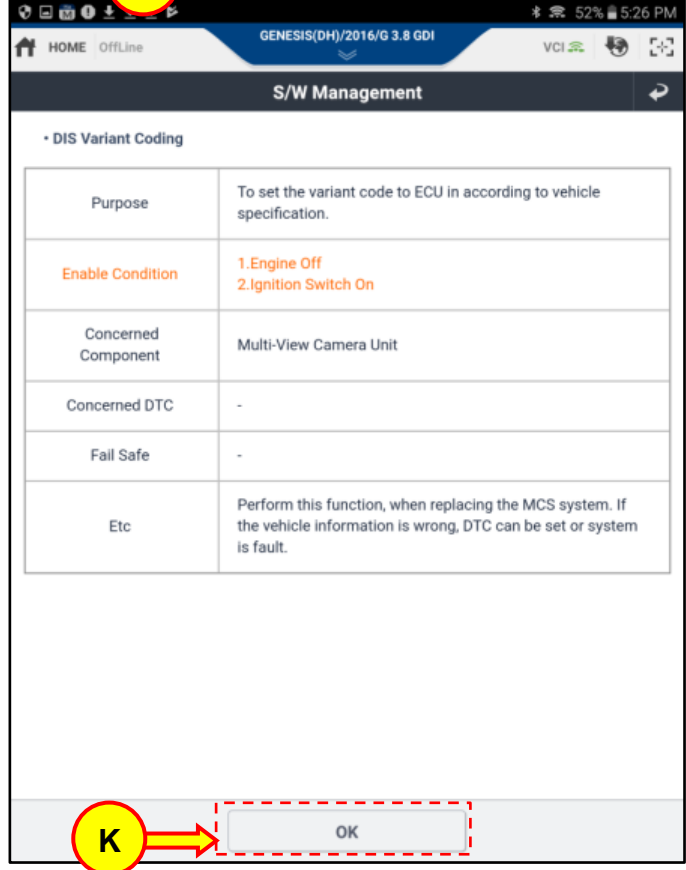

9. Select “Skip” (L) to change variant coding options manually. Then select “OK” (M) to continue with the procedure.

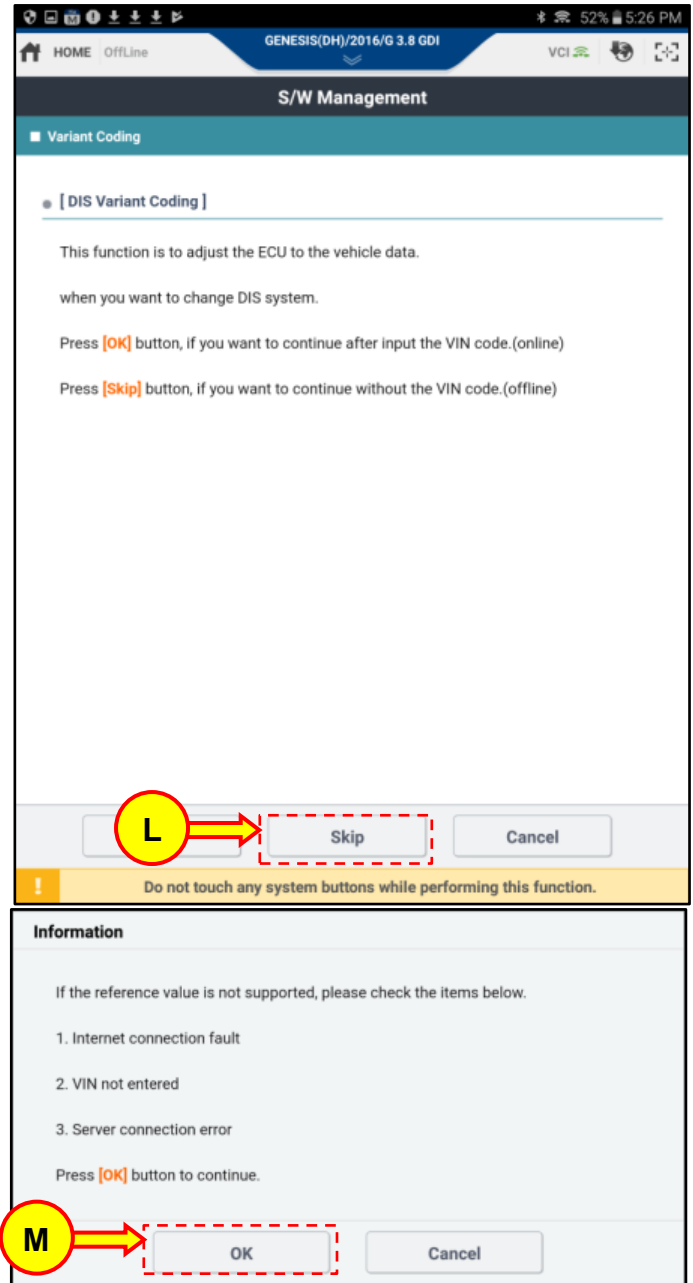

10. Proceed with the Variant Coding procedure:

- Select the item which you would like to change. The Applied Values should be as follows:

Items	Applied Value
VEHICLE VARIANT	DH PE
COUNTRY VARIANT	NORTH AMERICA
NAVIGATION	ENABLE
MODEM	ENABLE
MOST AMP	DISABLE
REAR SEAT ENTERTAINMENT	DISABLE
RADIO REGION CODE	10k/200k
STEERING WHEEL	LHD
LIMOUSINE	SEDAN
AMP VARIANT	ACTUNE
PARKING ASSIST	Front/Rear Camera
ADVANCED CLUSTER	DISABLE
HUD	DISABLE
REAR SEAT USB	DISABLE
REAR CONTROLLER	DISABLE
CDC	DISABLE
REAR MIC	DISABLE
DVD REGION CODE	WORLDWIDE
DVD MENU LANGUAGE	00

- Scroll down to Parking Assist, then select PGS (N).

Tap "OK" (O) to save the changes.

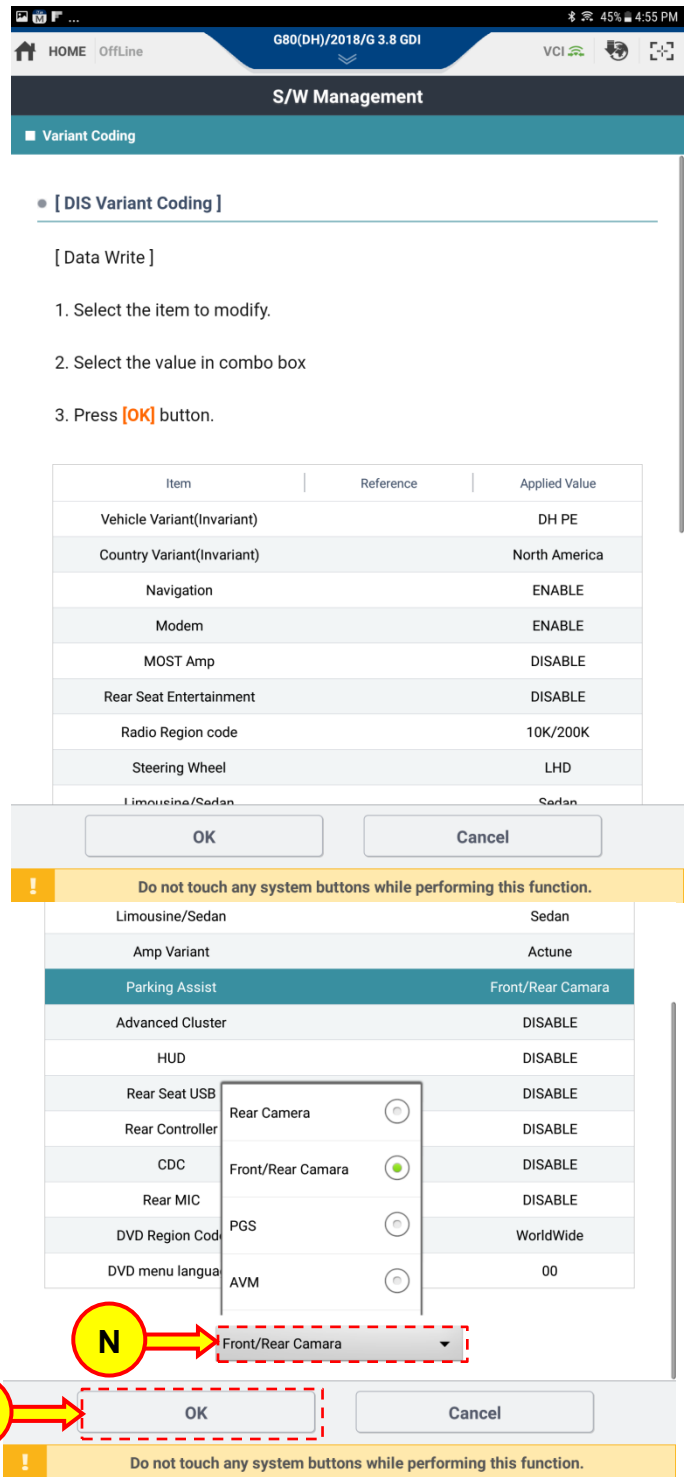

11. Once the changes have been submitted, you will receive a notification confirming the save completed. Select “OK” (P).

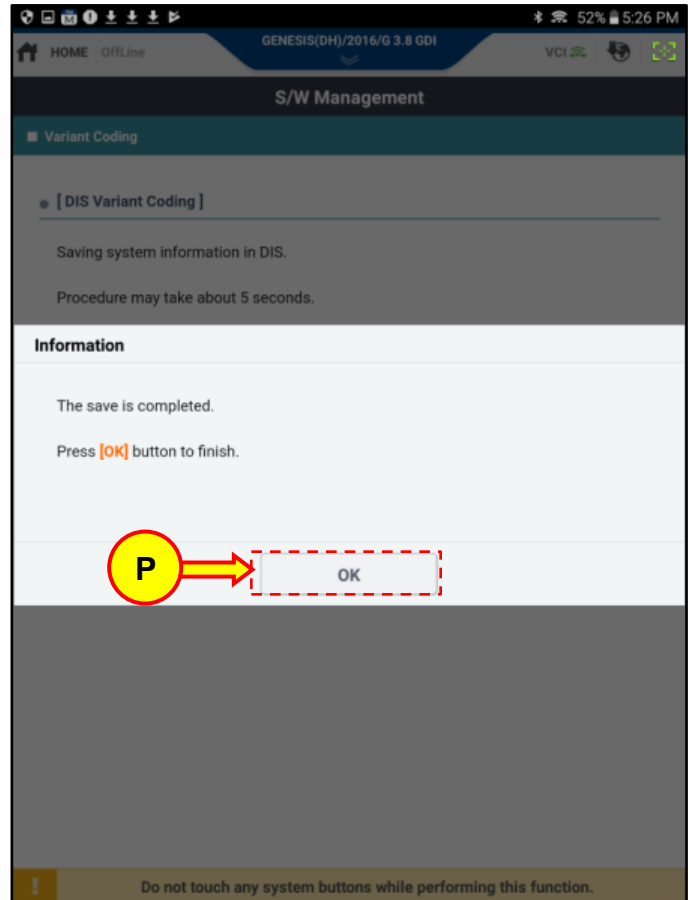

12. Upon Completion of the procedure:
- Disconnect the VCI module from the vehicle.
 - Shut the vehicle off
 - Remove keys
 - Lock all the doors (ARM the vehicle)
 - Wait 3-5 minutes

13. Confirm the rear view camera operation.

Depress the brake pedal and press the **START STOP BUTTON (Q)** to start the vehicle.

Depress the brake pedal then put the gearshift lever in the Reverse gear. Confirm that the rear view image appears on the display.



NOTICE

Repeat steps 1-12 if the condition is not resolved.